

Lenox Deck Mounted Vanity Sink Hand Painted with Matching Waterfall Faucet Set



INSTALLATION INSTRUCTIONS

Waterfall Faucet Installation

Please remember to turn off the hot and cold valves prior to installation.

STEP 1. Check to see that your set contains the following parts:

- The faucet
- Hot and cold water lines
- One rubber washer
- One brass washer
- Two mounting screws

STEP 2. While holding the faucet facing you, locate the two larger openings at the base of the faucet.

STEP 3. The left opening is for the hot water supply line and the right opening is for the cold water supply line.

STEP 4. Gently screw in the hot and the cold water lines. Make sure the waterlines are tightly screwed in place.

STEP 5. Insert the waterlines through the faucet opening in the countertop and place the faucet on the countertop. Make sure the faucet is facing forward and is aligned properly.

STEP 6. From underneath the countertop, place the rubber washer first so that it sits on top of the metal washer. Be sure to align the openings on the washers with the openings on the faucet.

STEP 7. Screw in the mounting screws through the washers and into the faucet from underneath the countertop.

STEP 8. Tighten the brass nuts (located on the mounting screws) until the faucet is held tightly in place.

STEP 9. Connect the hot and cold water supply lines to the corresponding waters supply valves.

- 1. Decorative Ring
- 2. Rubber O-ring
- 3. Glass Disc
- 4. Lever
- 5. Brass Nut
- 6. Rubber O-ring
- 7. Cartridge
- 8. Rubber Gasket
- 9. Base
- 10. Hot and Cold Water Supply Lines
- 11. Rubber Gasket
- 12. Rubber Washer
- 13. Metal Washer
- 14. Mounting Screw
- 15. Brass Nut

STEP 3

STEP 3

Glass Vessel Sink and Waterfall Faucet Combo

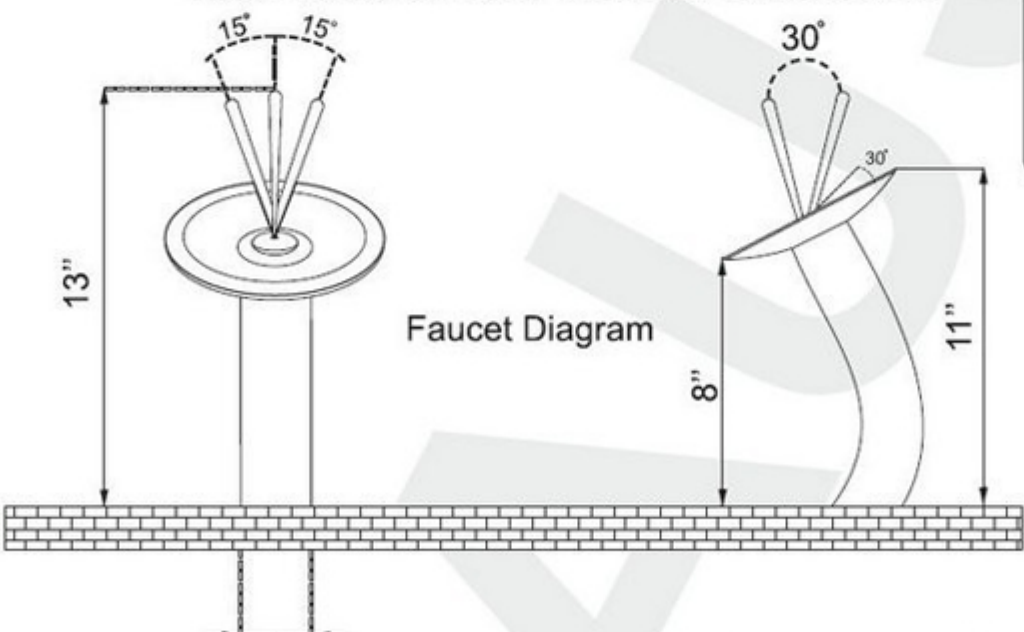

STEP 1

Installation Instructions

STEP 1

Tempered Glass Vessel

Prepare the counter top by drilling a 1 3/4" diameter drain hole at the desired location. Prepare the counter top by drilling a 1 3/8" diameter faucet hole. Place the vessel on counter top as shown below.

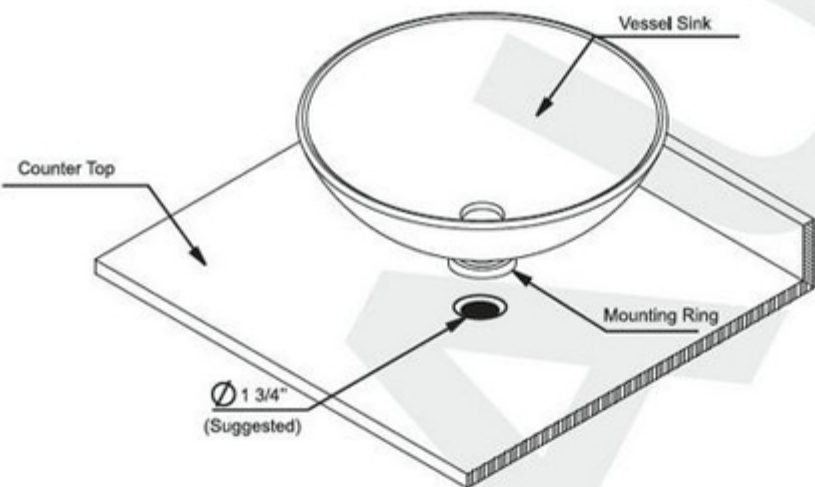

STEP 2

Pop Up Drain & Mounting Ring Installation (ONLY IF INCLUDED)

STEP 2

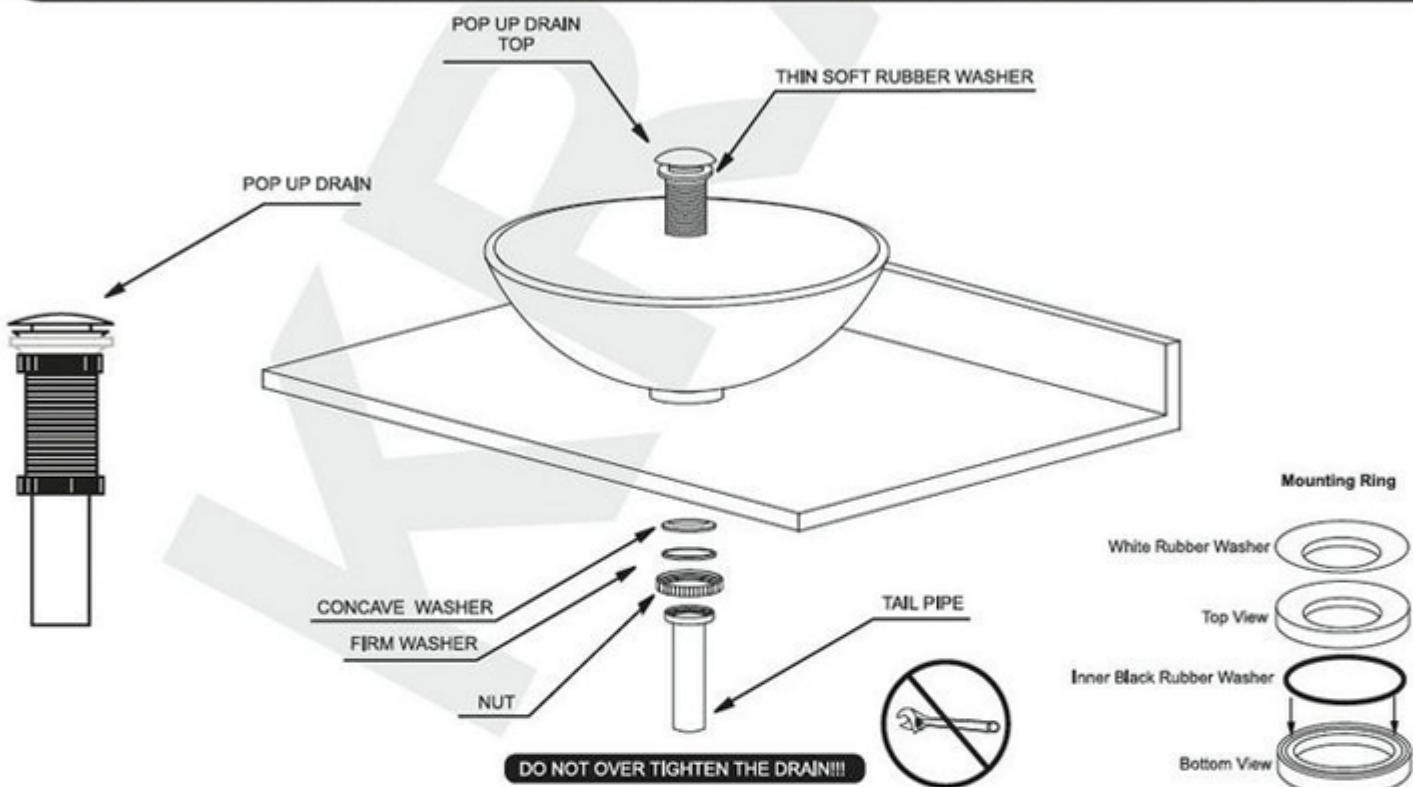

Glass Vessel Sink and Waterfall Faucet Combo

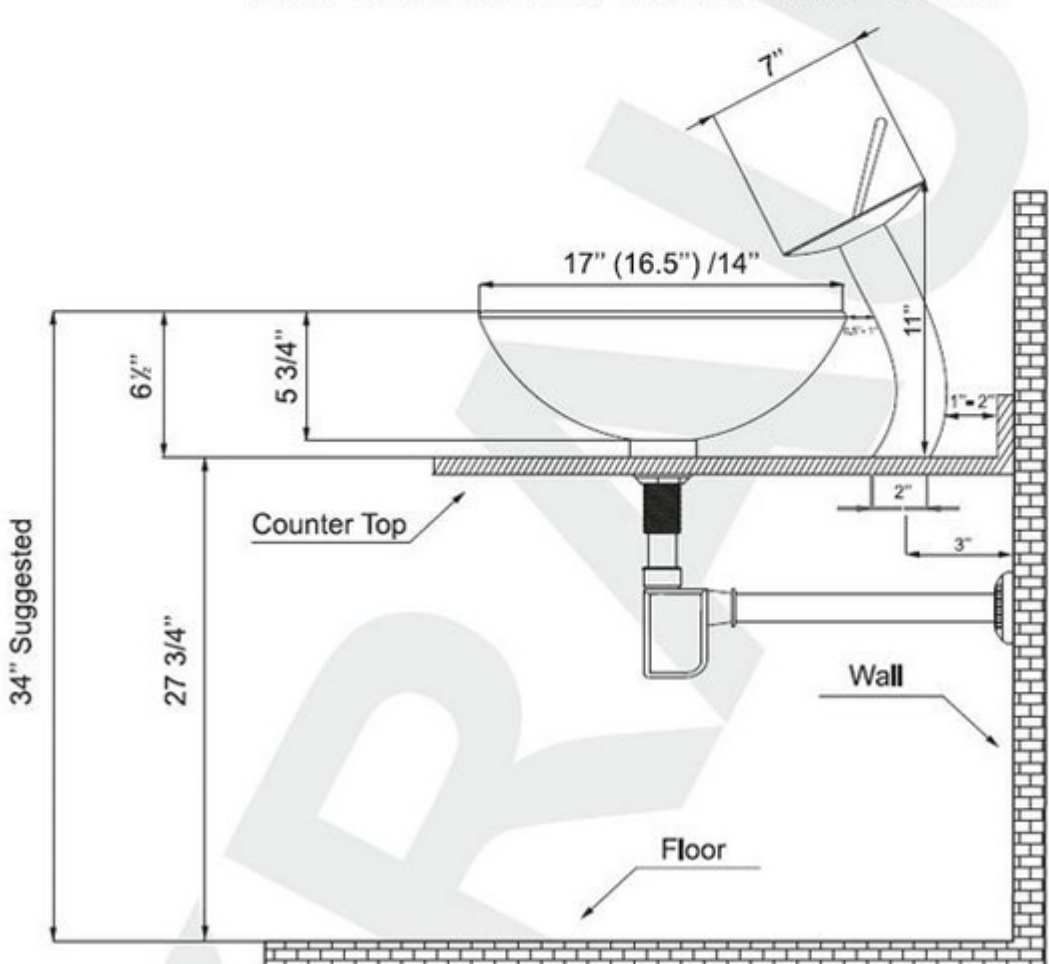

This General diagram and installation instructions are not intended for any specific model, but is presented as a general guideline for Installations!