

PARTS LIST

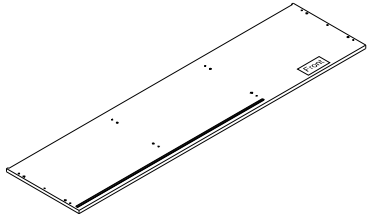

NAME: TOP PANEL
CODE: 1
QTY: 1Pc

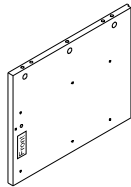

NAME: SIDE PANEL(LEFT)
CODE: 2
QTY: 1Pc

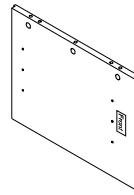

NAME: SIDE PANEL(RIGHT)
CODE: 3
QTY: 1Pc

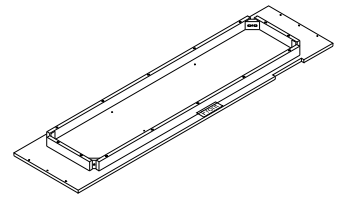

NAME: BOTTOM PANEL
CODE: 4
QTY: 1Pc

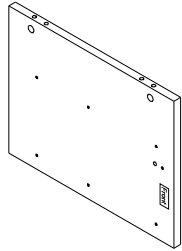

NAME: PARTITION(LEFT)
CODE: 5
QTY: 1Pc

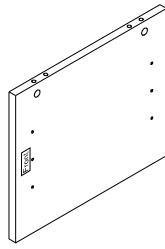

NAME: PARTITION(RIGHT)
CODE: 6
QTY: 1Pc



NAME: LEG
CODE: 7
QTY: 4Pcs

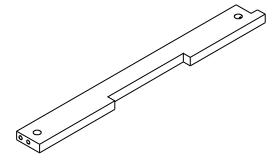

NAME: CENTER BAR
CODE: 8
QTY: 1Pc

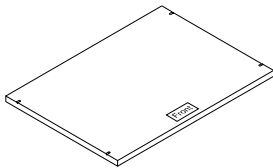

NAME: SHELVING
CODE: 9
QTY: 2Pcs

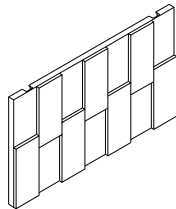

NAME: DOOR
CODE: 10
QTY: 1Pc

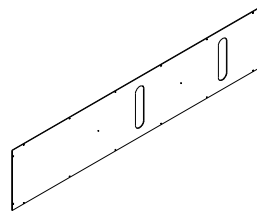

NAME: BACK PLY
CODE: 11
QTY: 1Pc

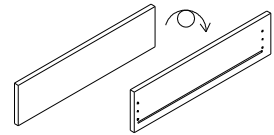

NAME: DRAWER FRONT
CODE: 101
QTY: 2Pcs

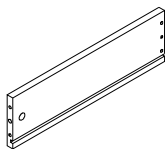

NAME: DRAWER SIDE(LEFT)
CODE: 102
QTY: 2Pcs

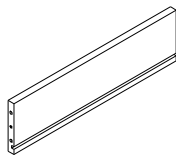

NAME: DRAWER BACK
CODE: 103
QTY: 2Pcs

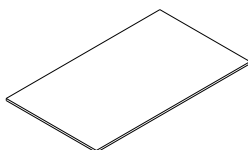

NAME: DRAWER BASE
CODE: 104
QTY: 2Pcs

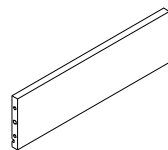

NAME: DRAWER SIDE(RIGHT)
CODE: 105
QTY: 2Pcs

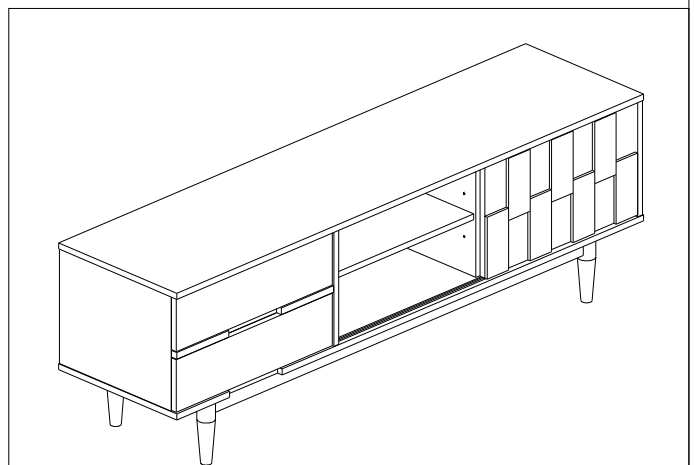

70"W TV STAND

—THE UNIT SHOULD BE ASSEMBLED BY 2 OR MORE PEOPLE
—EXTRA HARDWARE INCLUDED

HARDWARE LIST



NAME: CHIPBOARD SCREW M3X16mm
CODE: A
QTY: 40Pcs



NAME: CHIPBOARD SCREW M4X38mm
CODE: B
QTY: 10Pcs

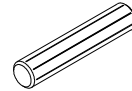

NAME: WOOD DOWEL M8X35mm
CODE: C
QTY: 18Pcs

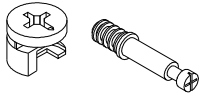

NAME: CAM LOCK & CAM BOLT
CODE: D
QTY: 20Sets



NAME: WOOD DOWEL M6X30mm
CODE: E
QTY: 16Pcs

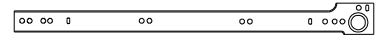

NAME: RUNNER 400mm
CODE: F
QTY: 2Set



NAME: CAM LOCK COVER
CODE: G
QTY: 20Pcs



NAME: ALLEN KEY M4
CODE: H
QTY: 1Pc



NAME: FLAT WASHER M6
CODE: I
QTY: 4Pcs



NAME: SPRING WASHER M6
CODE: J
QTY: 4Pcs

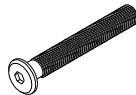

NAME: JCBC M6x45mm
CODE: K
QTY: 4Pcs



NAME: SHELVING SUPPORT
CODE: L
QTY: 8Pcs



NAME: PANHEAD CHIPBOARD SCREW M4X16mm(BLACK)
CODE: M
QTY: 18Pcs

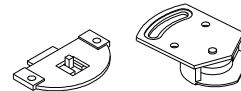

NAME: LD SLIDING ROLLER
CODE: N
QTY: 4Sets

STEP 1

- A) Insert Cam Bolt(D) to Top Panel(1)

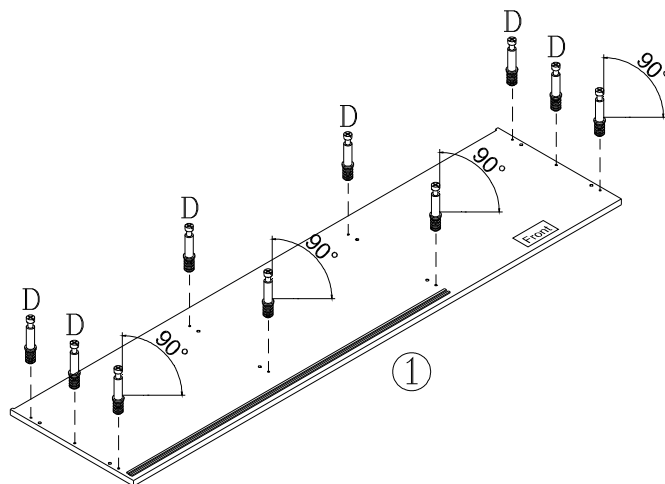
STEP 2

- A) Insert Wood Dowel(C) to Left&Right Side Panel(2&3)
 B) Attach Cam Lock(D) to Left&Right Side Panel(2&3)
 C) Attach Cam Bolt(D) to Left Side Panel(2)

NOTE : Make sure arrows on each Cam Lock point towards nearest edge with holes

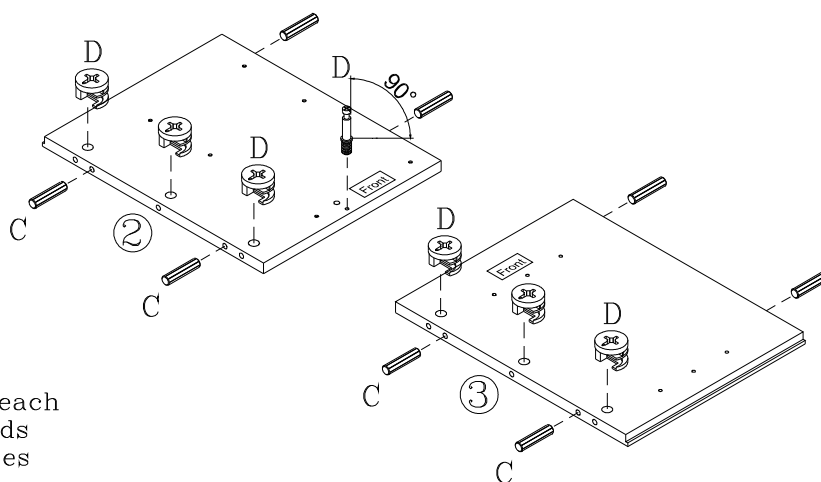
STEP 3

- A) Attach Runner(F) to Left Side Panel(2) using Chipboard Screw(A) to secure

NOTE : Do not over tighten the screw

NOTE : Runner roller should be towards the front of the panel

NOTE : Chipboard Screw(A) should be assembled from the front of the runner. Start from A¹, A² then A³

NOTE : Make sure the screws are installed vertically without slant to ensure screw sits properly in the hole

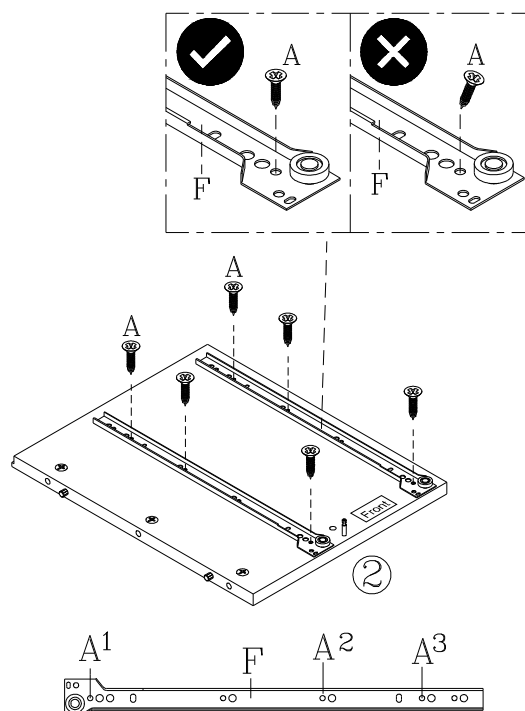

STEP 4

- A) Insert Wood Dowel(C) to Left&Right Partition(5&6)
- B) Attach Cam Lock(D) to Left&Right Partition(5&6)

NOTE : Make sure arrows on each Cam Lock point towards nearest edge with holes

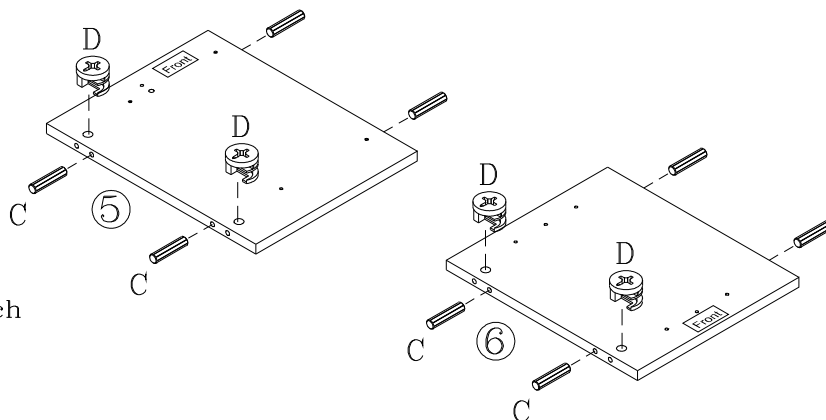
STEP 5

- A) Attach Runner(F) to Left Partition(5) using Chipboard Screw(A) to secure
- B) Attach Cam Bolt(D) to Left Partition(5)

NOTE : Do not over tighten the screw

NOTE : Runner roller should be towards the front of the panel

NOTE : Chipboard Screw(A) should be assembled from the front of the runner. Start from A¹, A² then A³

NOTE : Make sure the screws are installed vertically without slant to ensure screw sits properly in the hole

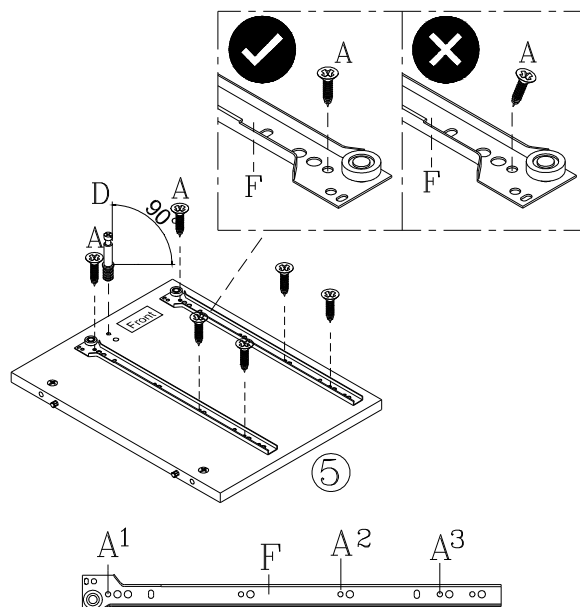
STEP 6

- A) Attach Wood Dowel(C) to Center Bar(8)
- B) Attach Cam Lock(D) to Center Bar(8)

NOTE : Make sure arrows on each Cam Lock point towards nearest edge with holes

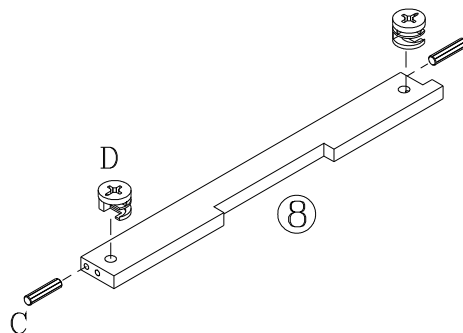
STEP 7

- A) Attach Roller (N) to Door(10) using Chipboard Screw(A) to secure

NOTE: Do not over tighten the Screw

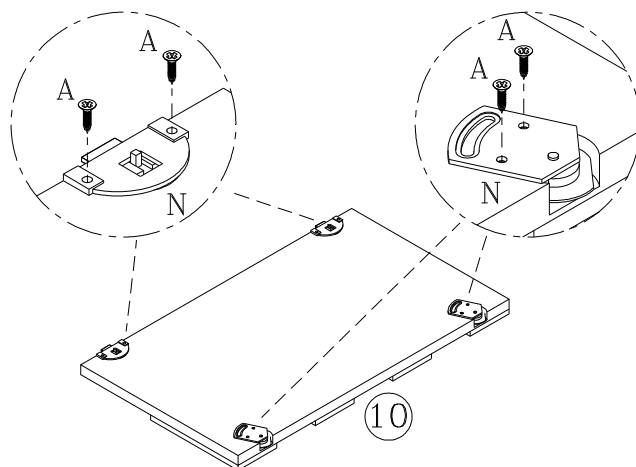

STEP 8

- A) Attach Leg(7) to Bottom Panel(4) and secure with JCBC Screw(K), Spring Washer(J)&Flat Washer(I) tighten with Allen Key(H) clockwise

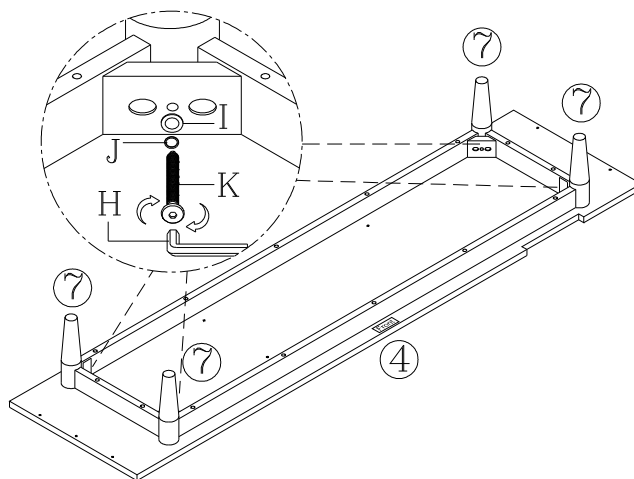
STEP 9

- A) Attach Center Bar(8) to Left Side Panel&Left Partiton(2&5) and secure with Cam Lock(D)
- B) Cover Cam Lock with Cam Lock Cover(G)

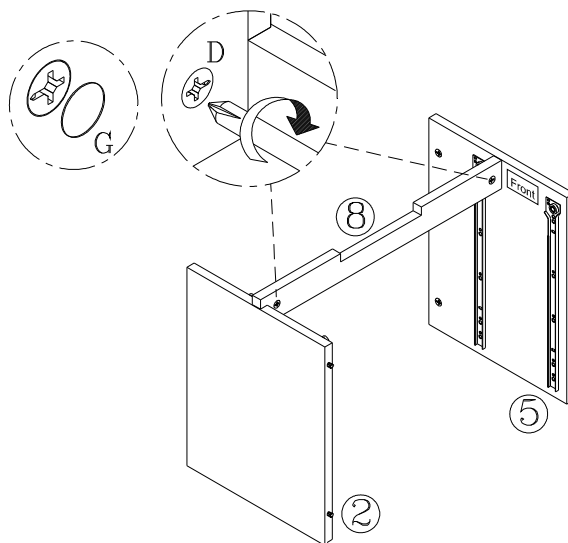
STEP 10

- A) Attach Left Side Panel&Left Partition(2&5) to Bottom Panel(4) secure with Chipboard Screw(B)

NOTE: Do not over tighten the Screw

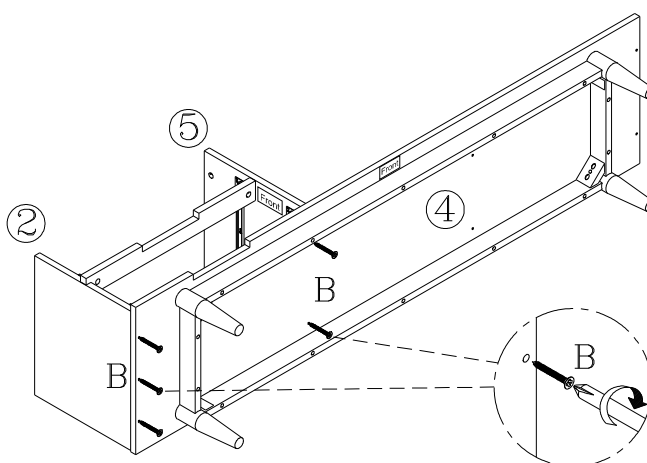
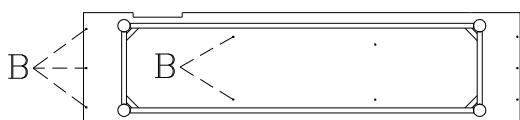

STEP 11

- A) Attach Right Side Panel&Right Partition(3&6) to Bottom Panel(4) secure with Chipboard Screw(B)

NOTE: Do not over tighten the Screw

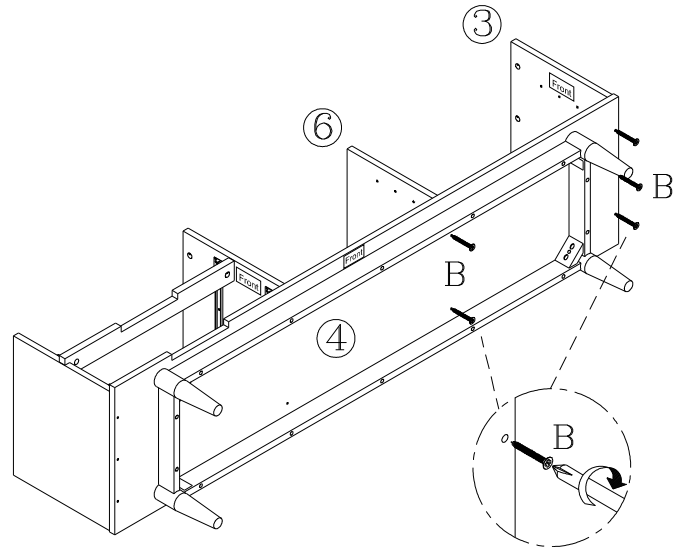
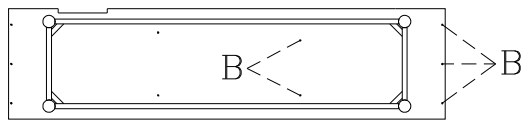
STEP 12

- A) Attach Top Panel(1) to Left&Right Side Panel (2&3) & Left&Right Partition(5&6) secure with Cam Lock(D).
- B) Cover Cam Lock with Cam Lock Cover(G)

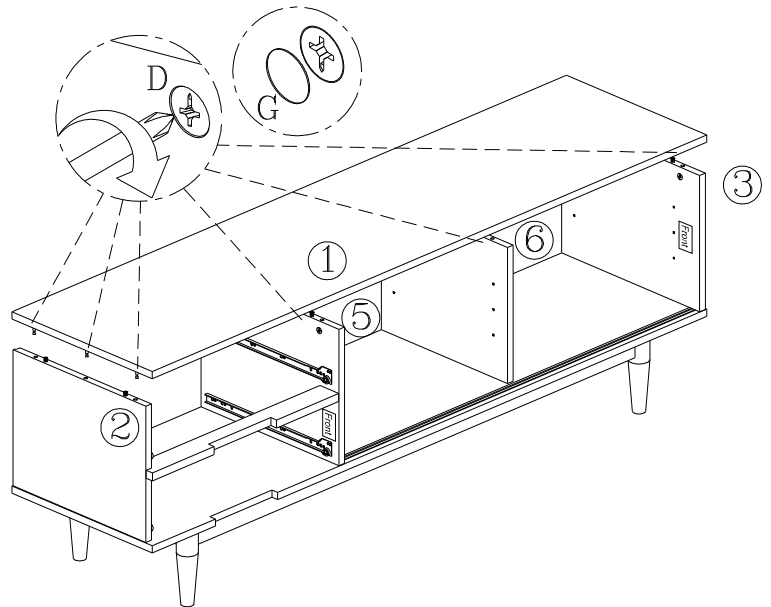
STEP 13

- A) Attach Back Plywood(11) to assembled unit using Panhead Chipboard Screw(Black)(M) to secure

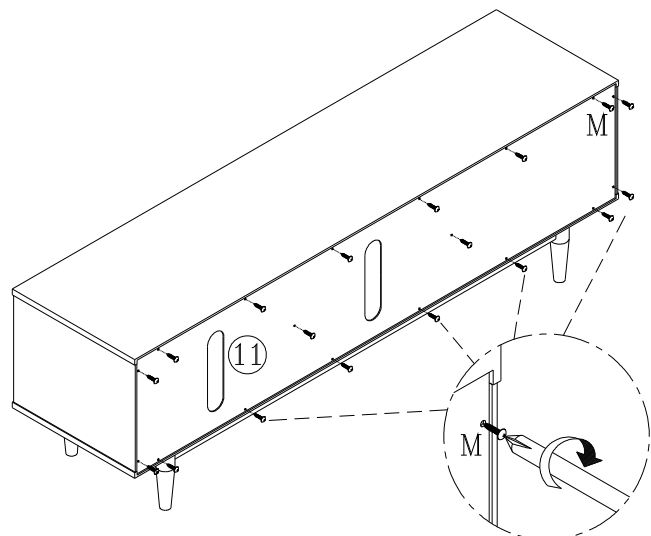

STEP 14

- A) Insert Shelving Support(L) into Right Side Panel(3) & Left&Right Partition(5&6) at desired shelf heights
- B) Slot in Shelving(9) into assembled unit

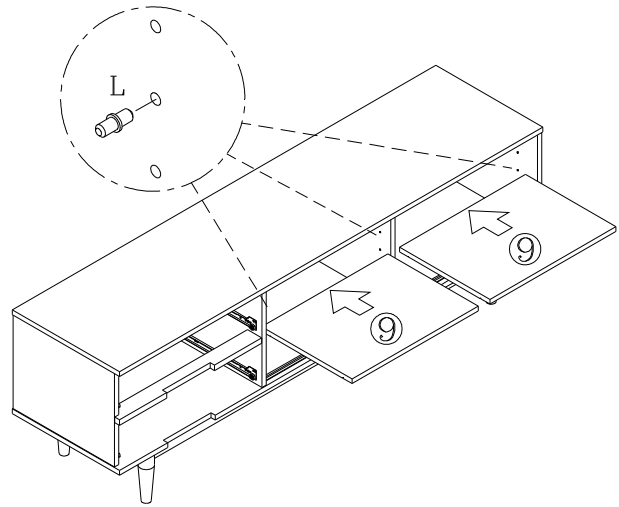
STEP 15

- A) Attach Door(10) to assembled unit
 - i) Sit door on Bottom Panel(4). Make sure wheels sit onto the track
 - ii) Push pin to unlocked position to allow door to align with track at the top. Release pin, catch will spring back and falls into the track

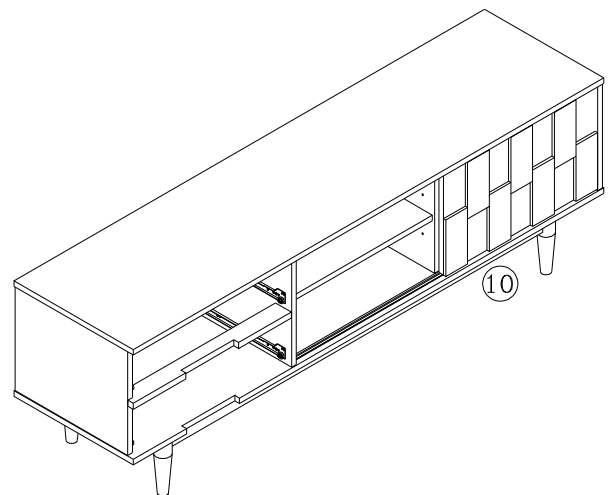

(i)Bottom of Door

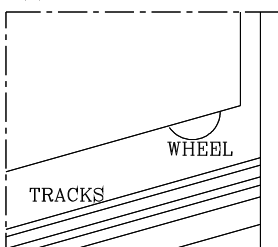

LOCKED POSITION

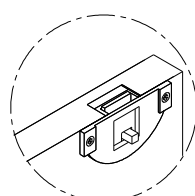

UNLOCKED POSITION

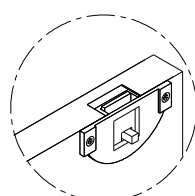

(ii)Top of Door

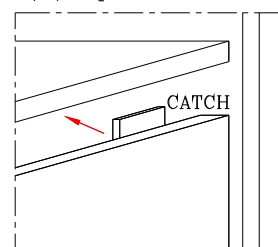

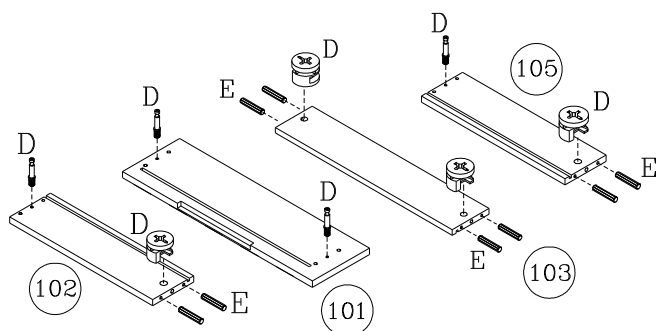
STEP 16

- A) Insert Wood Dowel(E) to Left&Right Drawer Side(102&105) & Drawer Back(103)
- B) Attach Cam Lock(D) to Left&Right Drawer Side(102&105) & Drawer Back(103)
- C) Attach Cam Bolt(D) to Drawer Front(101) & Left&Right Drawer Side(102&105)

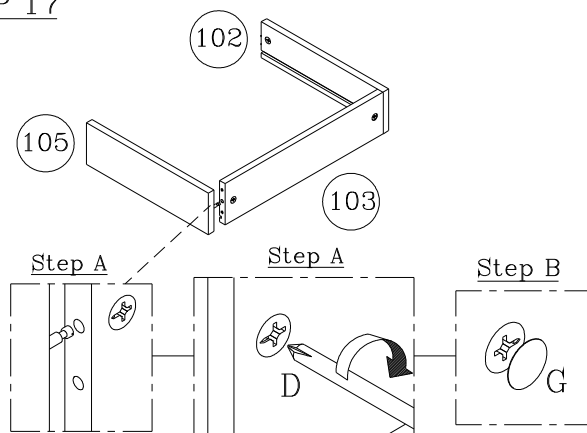
STEP 17

- A) Attach Left&Right Drawer Side(102&105) to Drawer Back(103) secure with Cam Lock(D)
- B) Using Cam Lock Cover(G) to cover Cam Lock(D)

NOTE : Make sure arrows on each Cam Lock point towards nearest edge with holes

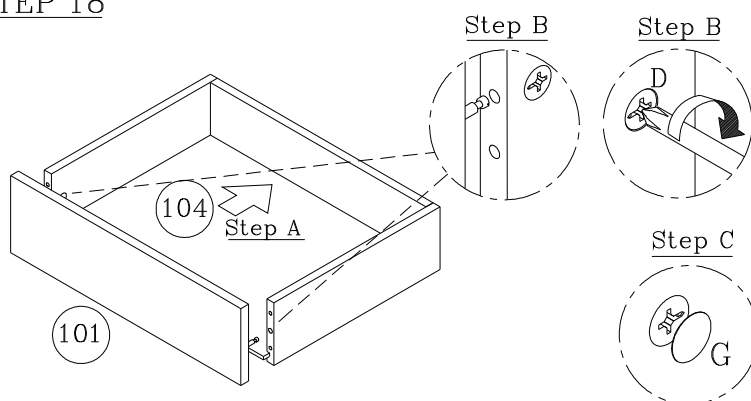
STEP 18

- A) Slot in Drawer Base(104) in corresponding grooves
- B) Attach Drawer Front(101) to Drawer Box secure with Cam Lock(D)
- C) Using Cam Lock Cover(G) to Cover Cam Lock(D)

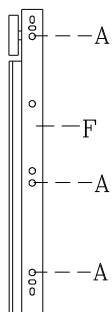
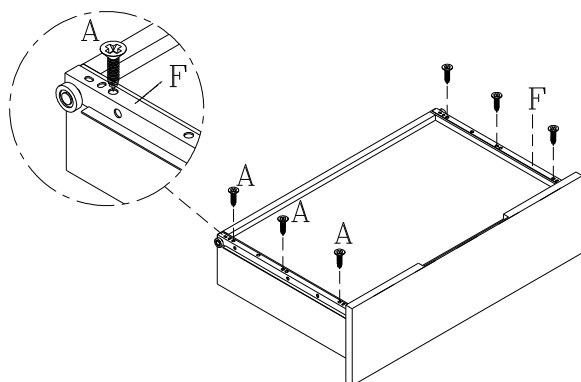
STEP 19

- A) Turn over the Drawer box, Attach Runner(F) to Drawer Side(102&105) using Chipboard Screw(A) to secure

NOTE: Runner roller should be flush and towards the back of the Drawer Box