

# CONVENIENCE CONCEPTS

## BAJA CONSOLE TABLE

7103099

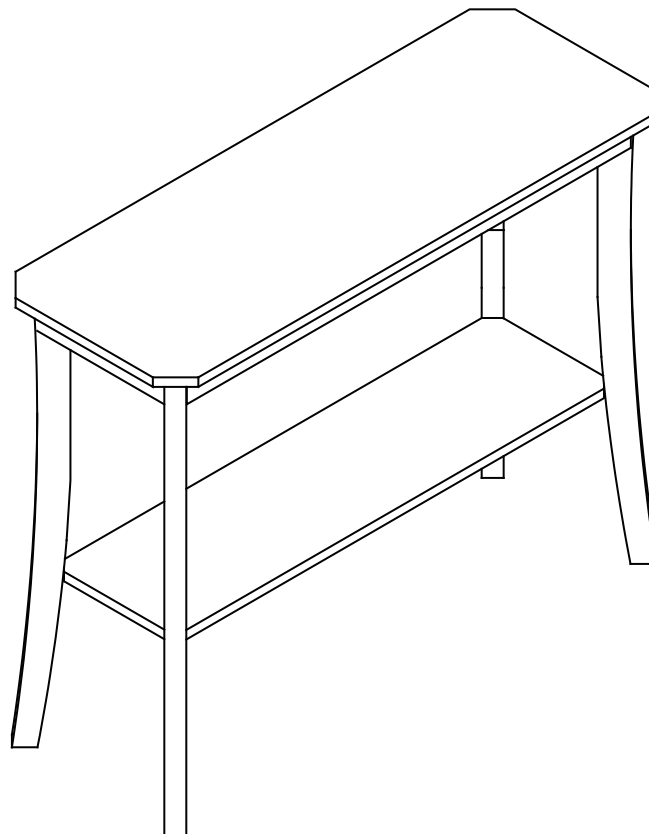

### ASSEMBLY INSTRUCTIONS

---

We have designed our furniture with you , the customer in mind . Our clear , easy to follow , step by step instructions will guide you through the project from start to finish . Feel confident that this will be a fun and rewarding project . The final product will be a quality piece of furniture that will go together smoothly and give years of enjoyment .

---



Please do not return to the store

Broken or missing parts?

Need help with assembly?

If you have any questions just call 1-800-468-6447 or email us at [parts@convenience-concepts.com](mailto:parts@convenience-concepts.com)

## Hardware List

### Part List

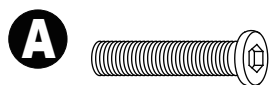

Allen screw(8pcs)



Spring washer (8pcs)

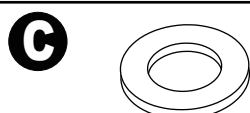

Flat washer (9pcs)

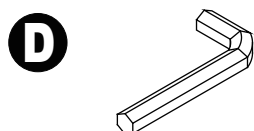

Allen wrench(1pc)

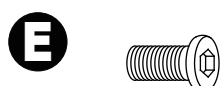

Allen screw(4pcs)

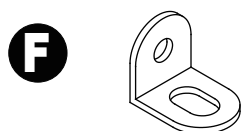

Angle bracket (4pcs)



Screw(5pcs)

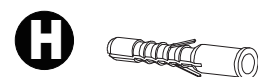

Plastic anchor (1pcs)

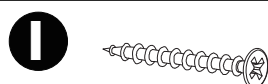

Mounting screw (1pcs)



Safety wall strap (1pcs)

①

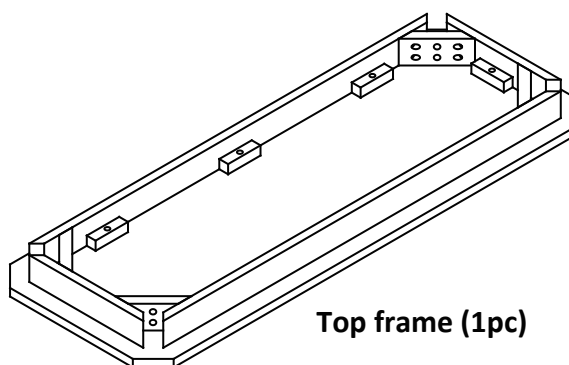

Top frame (1pc)

②

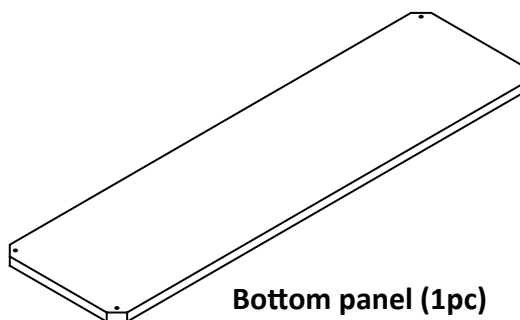

Bottom panel (1pc)

③

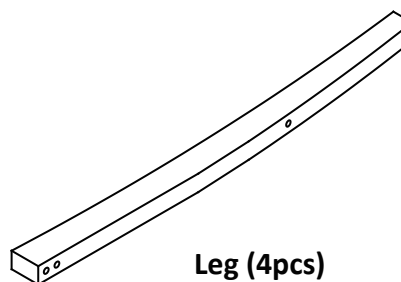

Leg (4pcs)

## step1

1. Place two legs **3** onto top frame **1** and fasten together using allen screws (A) ,spring washers (B) and flat washers (C) as shown.
2. Tighten allen screws with allen wrench (D) .

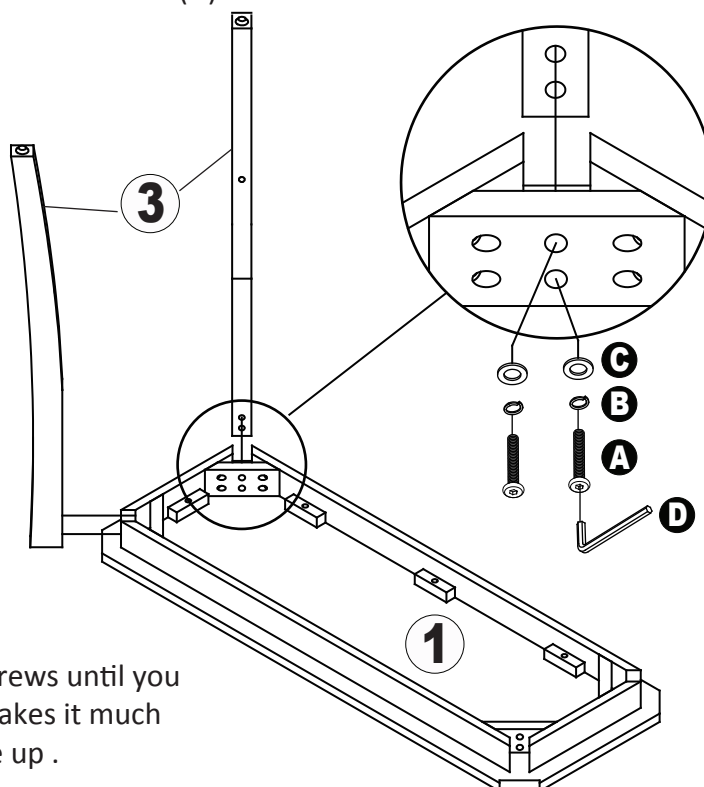

NOTE: do not tightening the screws until you finish the whole assembly – makes it much easier to get everything to line up .

## step2

Use screws (G) to fix angle brackets (F) as shown .

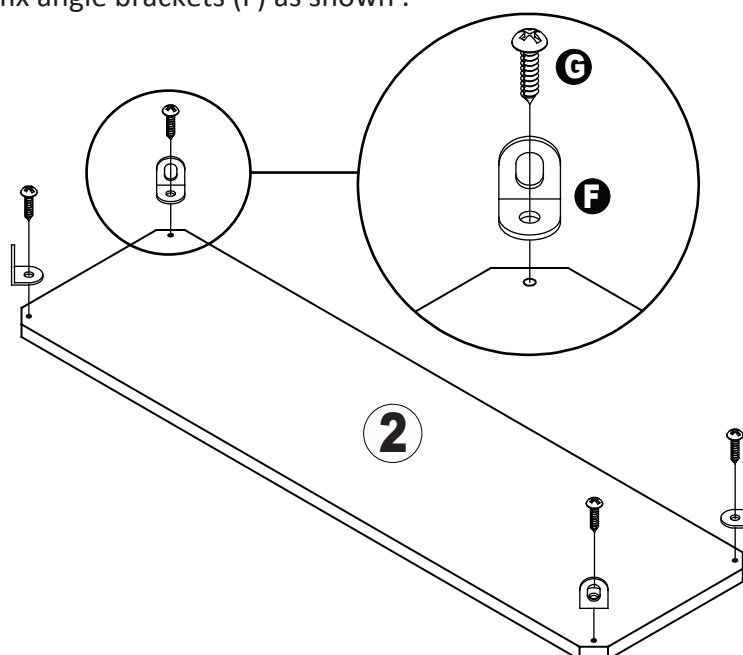

### step3

- 1.Align the holes of angle brackets (F) in bottom panel ② with the holes in legs ③.
- 2.Fasten angle brackets (F) with allen screws (E), tighten with allen wrench (D) as shown .

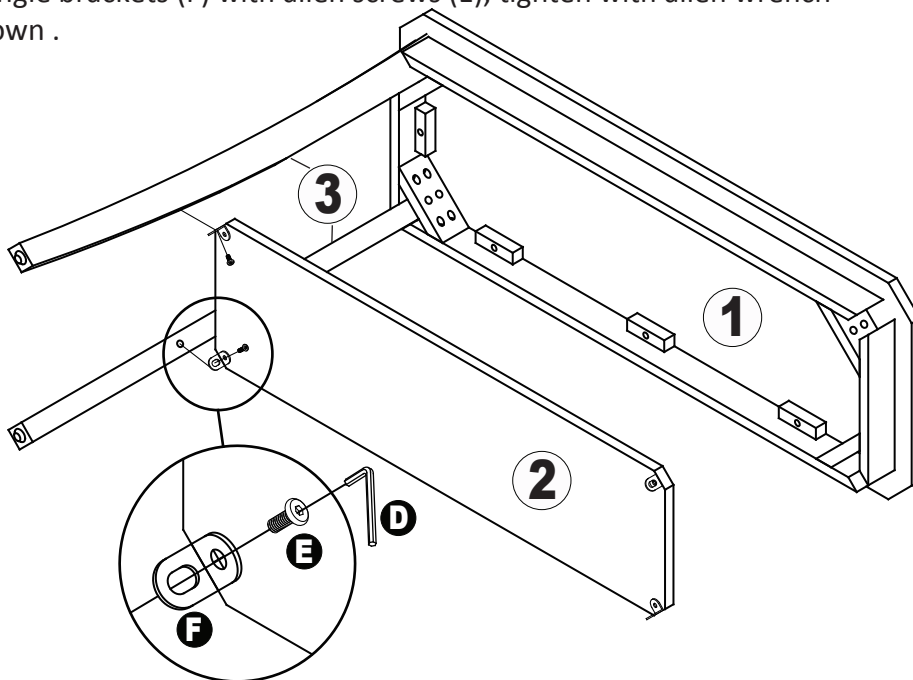

### step4

Repeat step1 and step3 for remaining legs ③.

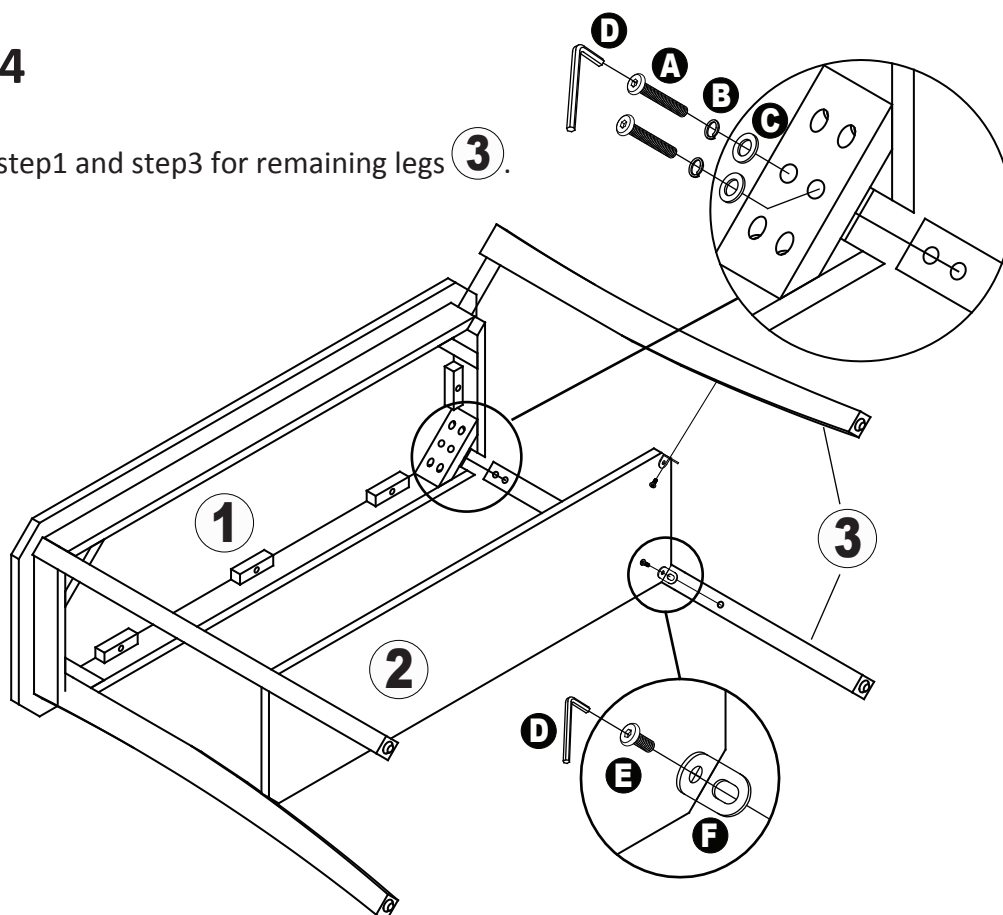

**step5**

1. Connect the safety wall strap (J) into unit as shown.
2. Drill hole slightly smaller than plastic anchor (H) into drywall and gently tap plastic anchor into hole.
3. Insert safety wall strap (J) into plastic anchor (H) as shown using mounting screw (I) and washer (C).

