

**Central Brass Company, Inc.**

3325 S. Garfield Ave.  
Commerce, CA 90040  
(800) 321-8630  
www.centralbrass.com

# INSTALLATION

**Tools:**



Adjustable Wrench



Plumbers Putty



Teflon Tape



Rags

## Model Number: 1555, 1655, 1665 Series

**Warnings and Notes:**

Check with local plumbing code requirements before installation.  
This product should be installed by a local listed plumber.

**Do not use plumbers putty on threads.**



## Installation Steps:

Multi Tub Trip Lever Bath Drain

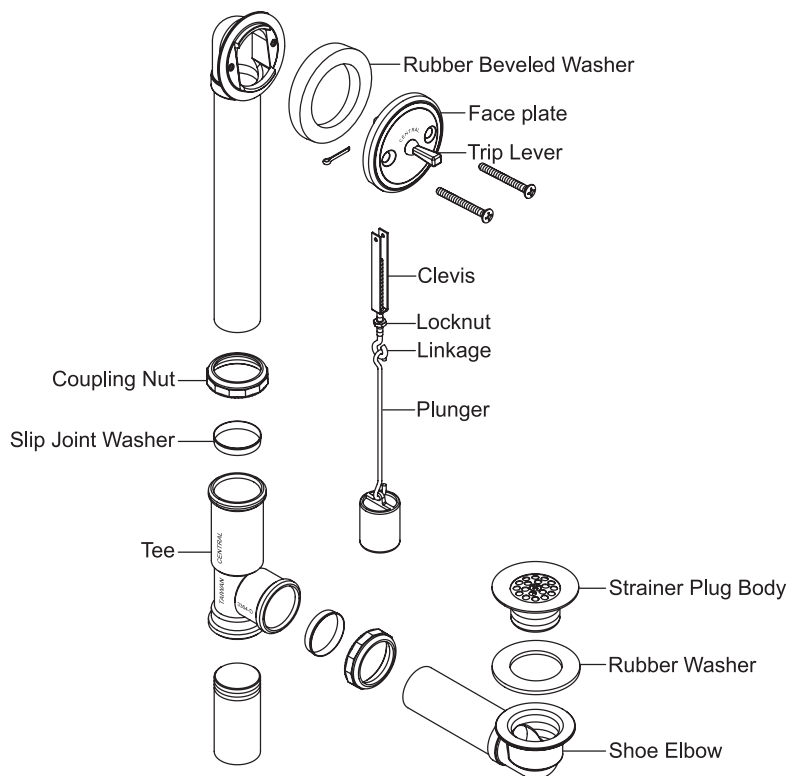

- (1) Apply a layer of plumbers putty to underside of strainer plug body, assemble in bathtub drain hole and screw tightly into shoe elbow as shown.
- (2) Assemble tubes with slip joint washers into tee as shown and screw on coupling nuts finger tight. Rotate rubber beveled washer on top ell to match angle of tub.
- (3) With the trip lever in the down position, insert the plunger and linkage down through the top elbow as shown. Linkage can be screwed in and out of clevis to obtain the desired lift of plunger. When proper lift is adjusted, tighten locknut and screw in the two screws to hold face plate secure.
- (4) Tighten coupling nuts on tee with wrench to pull tapered slip joint washers securely into tee.
- (5) Assembly of a threaded tailpiece require the use of a thread sealant to prevent leakage.

**Central Brass**  
C O M P A N Y, Inc.

For more care information or trouble shooting inquiries  
about your Central Brass product, please call:  
**Central Brass Company, Inc.** (800) 321-8630  
Monday-Friday 8 AM to 8 PM EST (5 AM to 5 PM PST)  
www.centralbrass.com