

Read this instruction carefully. See hardware and furniture part list for guidance.  
Be sure all parts are complete before assembly. Place all wooden furniture parts on a clean and flat soft surface to prevent from being scratched.  
Follow the figure to start assembling.

CAUTION : 1. Do not FULLY - TIGHTEN the nuts or nut bolts until they are ready for assembly.  
2. Do not OVER - TIGHTEN the nuts or bolts to avoid causing damages to the thread.  
3. Keep all hardware parts out of reach of children.

NOTE : THE LIST AND QUANTITY SHOWN ARE FOR 1 UNIT ASSEMBLY.  
Tools needed : Screwdriver (not provided).

PART LIST		
ITEM	DESCRIPTION	QTY
A	LEG SUPPORT	2 PCS
B	LEG SUPPORT	2 PCS
C	LEG	2 PCS
D	METAL PLATE	1 PC
E	SEAT	1 PC

HARDWARE LIST		
ITEM	DESCRIPTION	QTY
1	JCBC BOLT M6 x 40mm	1 PC
2	JCBC BOLT M6 x 20mm	4 PCS
3	M6 FLAT WASHER	4 PCS
4	M6 SPRING WASHER	5 PCS
5	WOOD SCREW M4 x 45mm	8 PCS
6	M4 ALLEN KEY (BALL SHAPE)	1 PC

METAL PLATE (D) HARDWARE		
7	JCBC BOLT M6 x 20mm	4 PCS
8	M6 FLAT WASHER	4 PCS
9	M6 SPRING WASHER	4 PCS

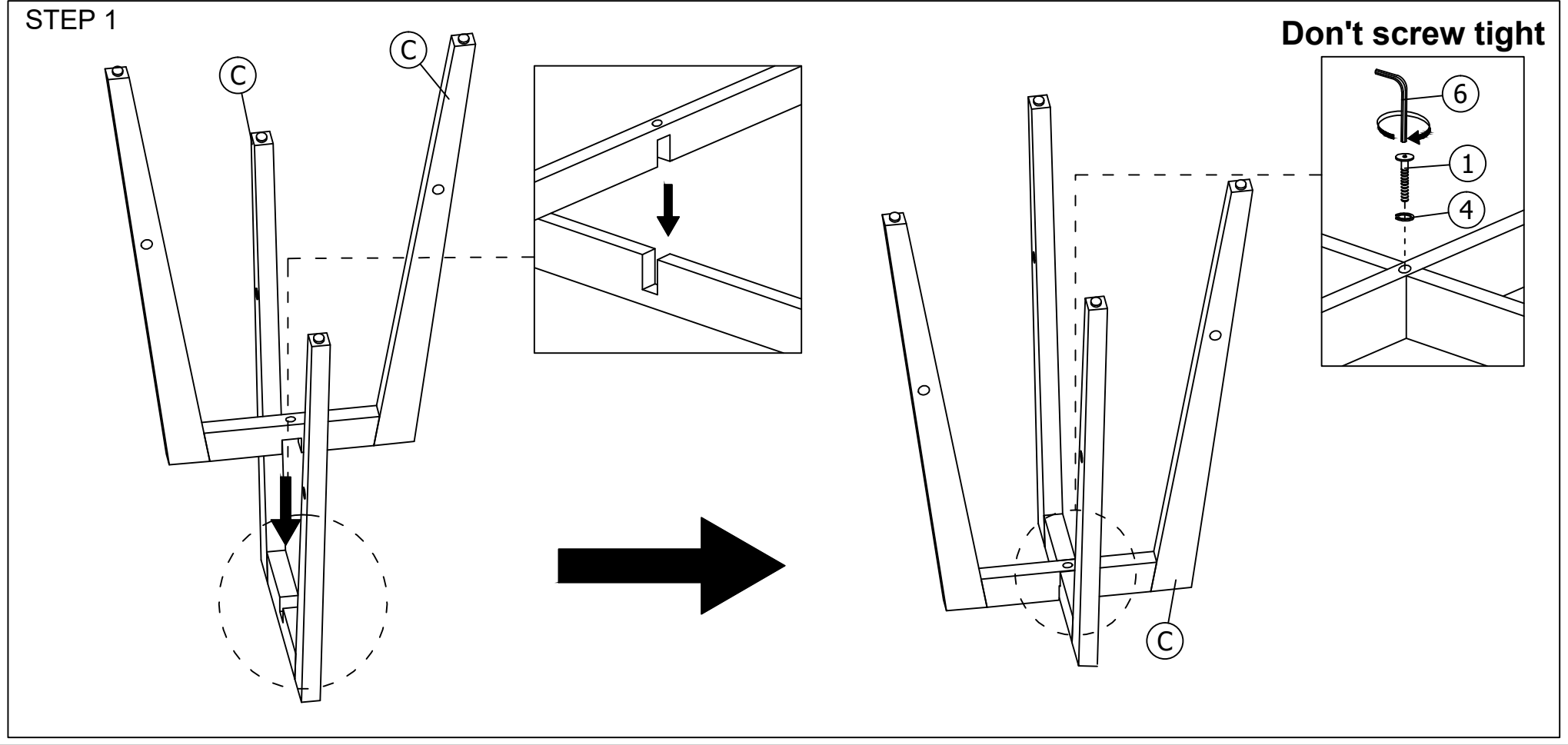

# ASSEMBLY INSTRUCTIONS

2 OF 5

## STEP 2

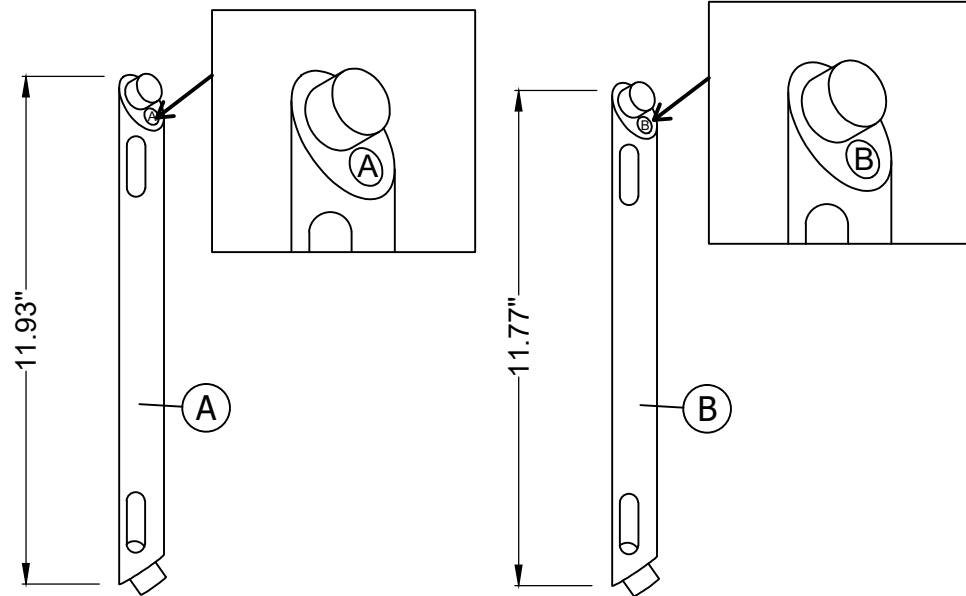

## STEP 3

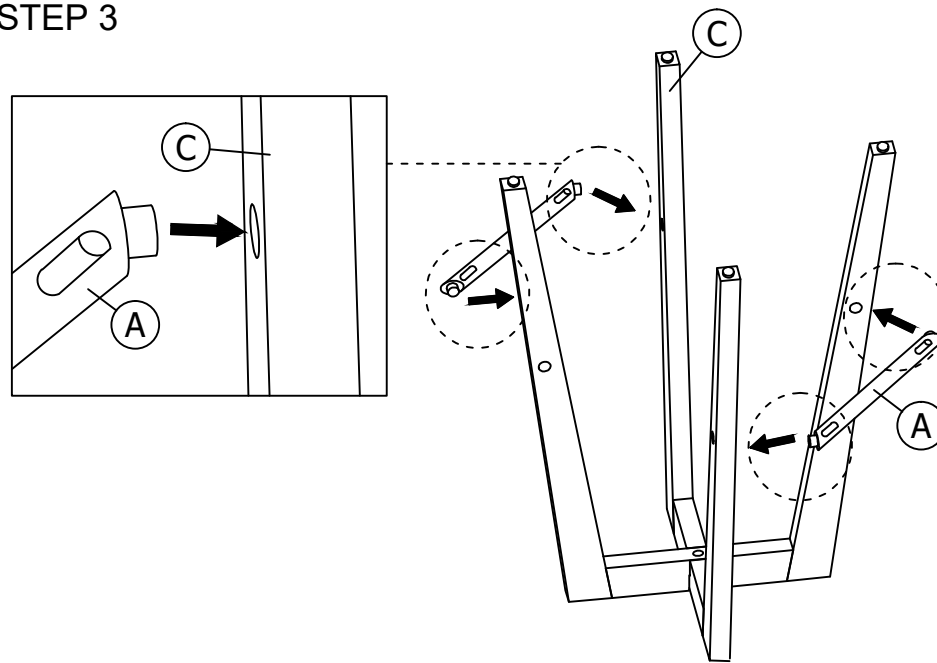

## STEP 4

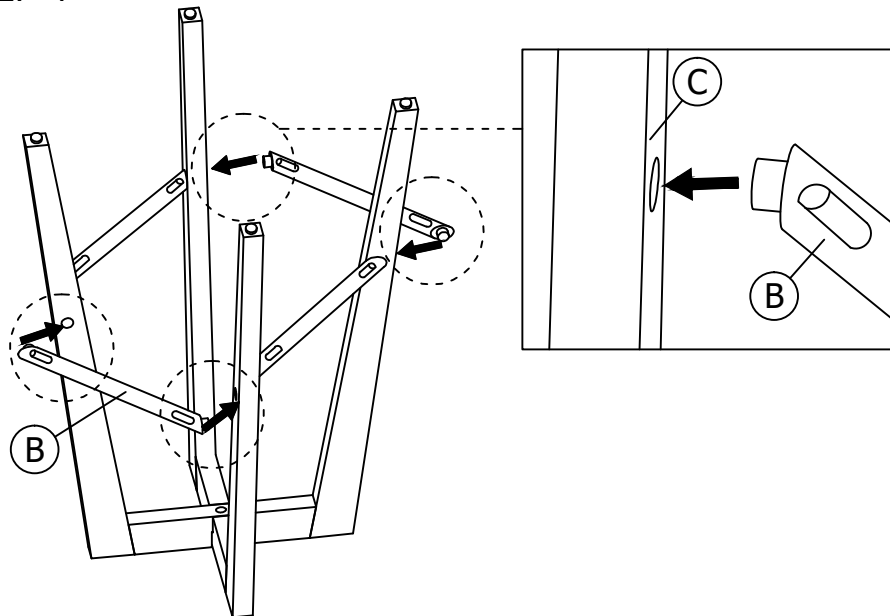

## STEP 5

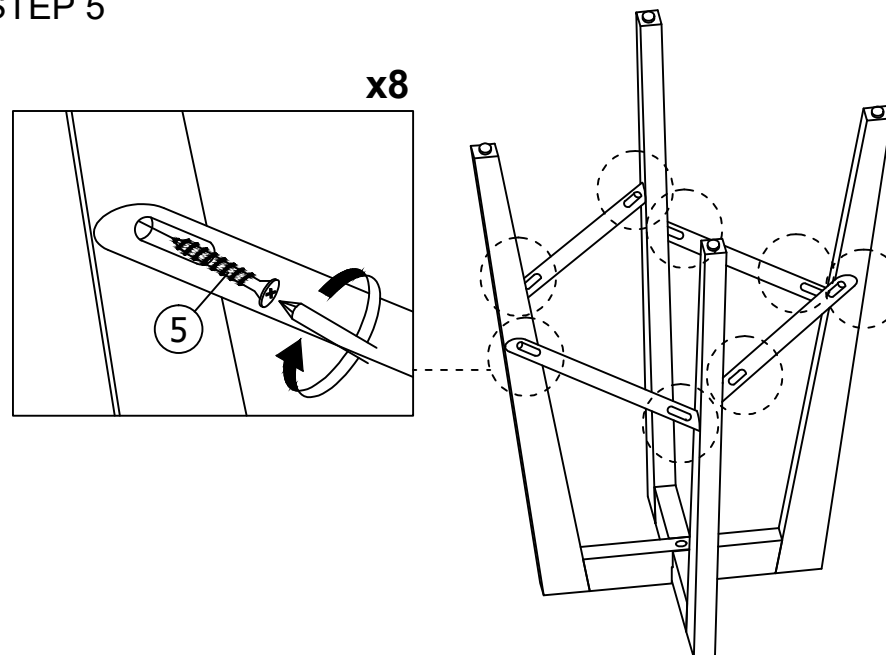

## STEP 6

**\*\*ITEM (D) DETACH FROM THE ITEM (E)**

### STEP 6.1

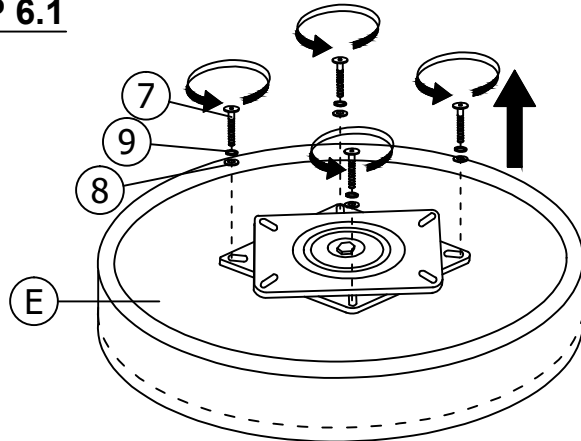

### STEP 6.2

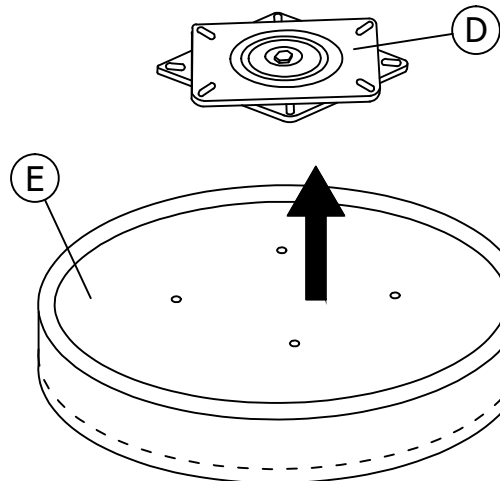

## STEP 7

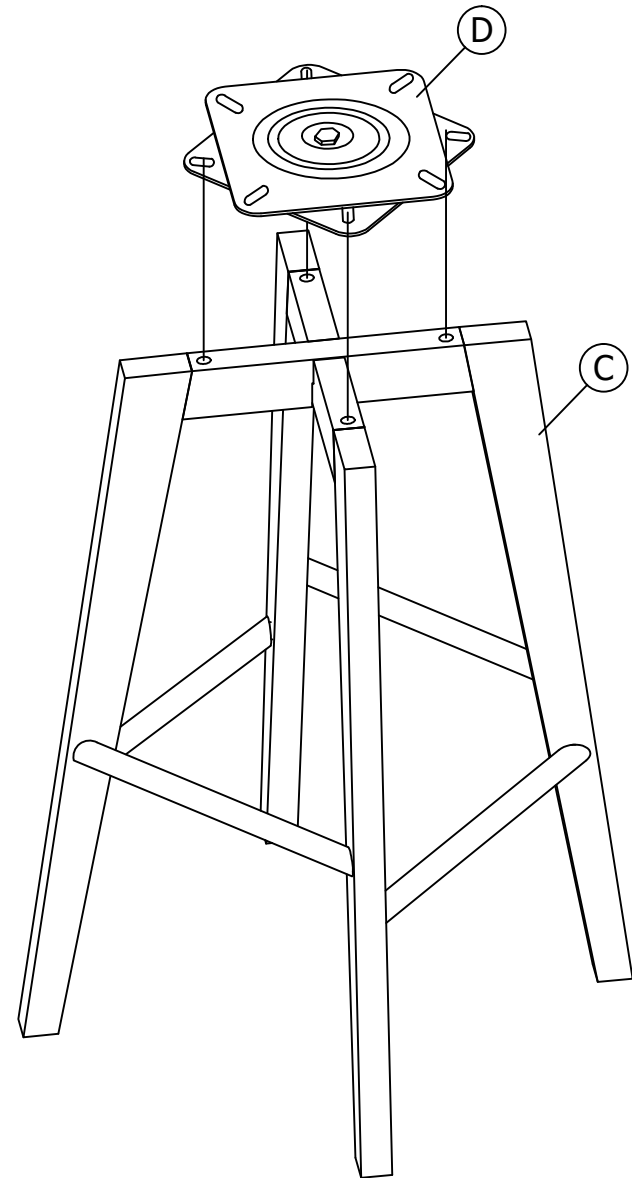

# ASSEMBLY INSTRUCTIONS

4 OF 5

## STEP 8

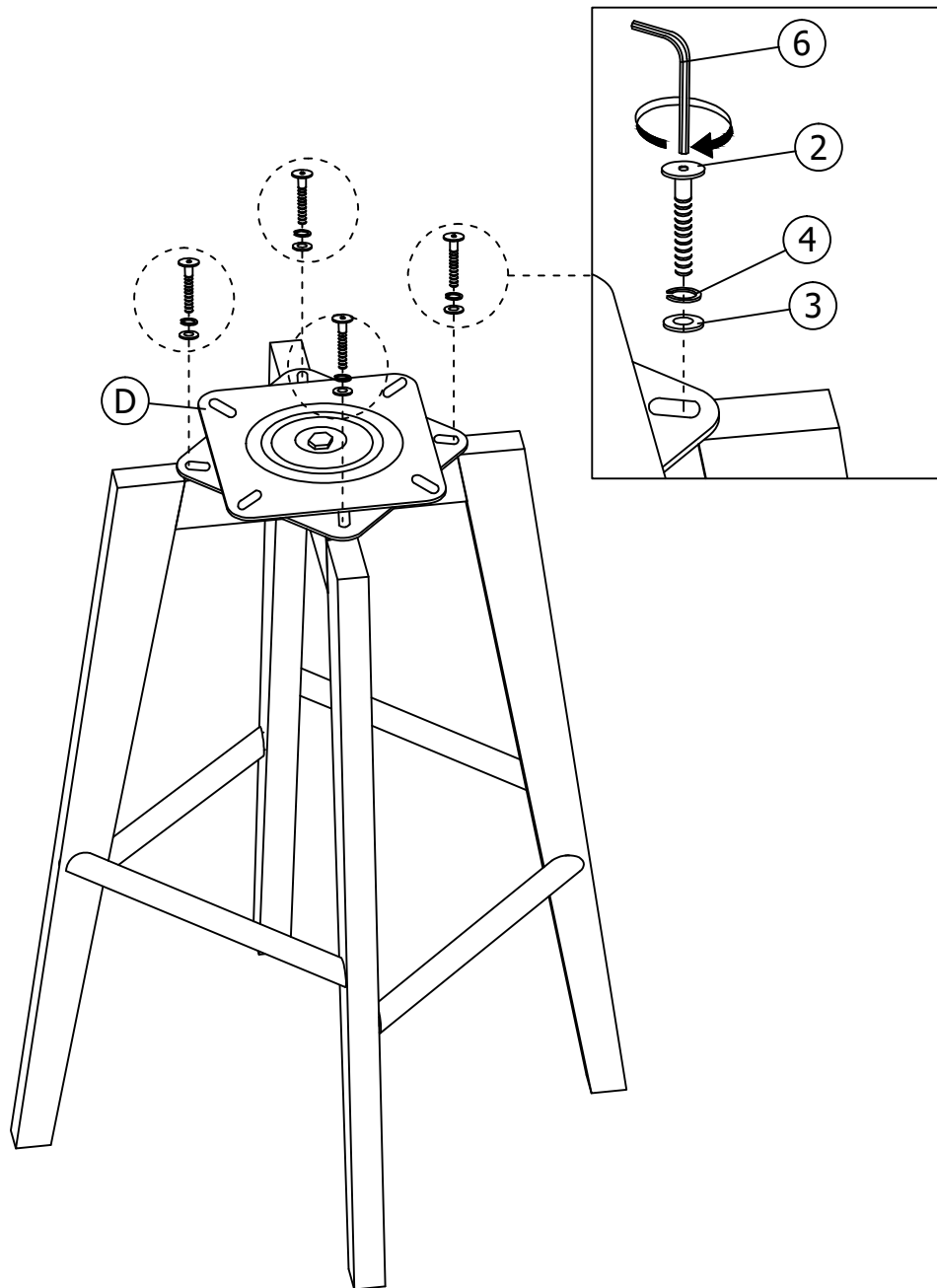

## STEP 9

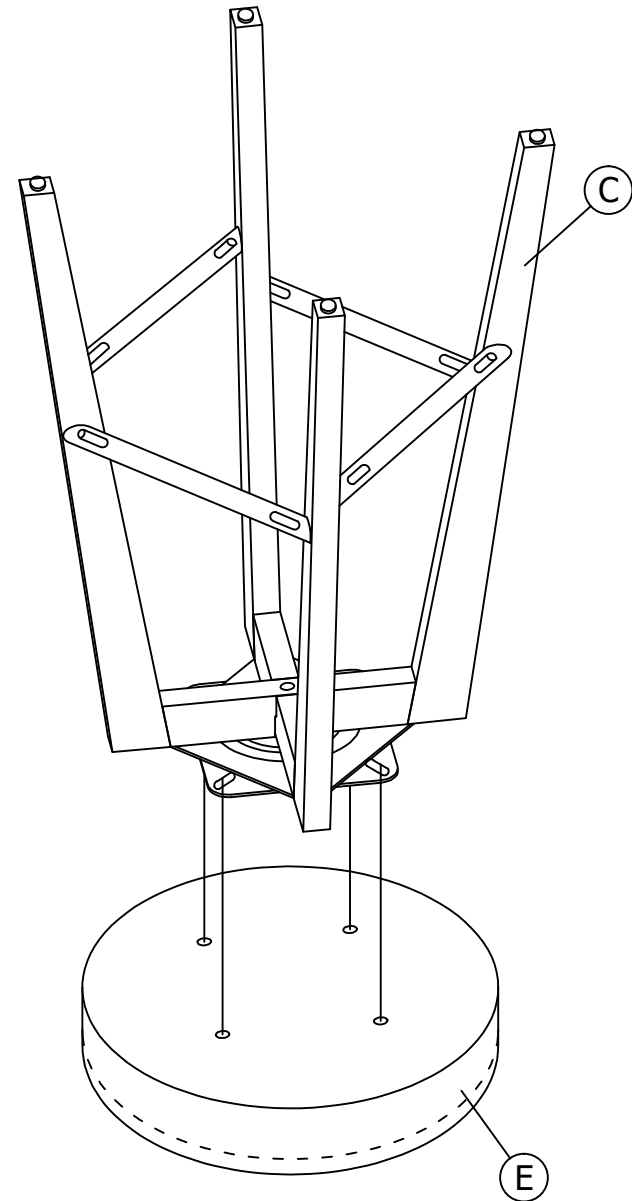

## STEP 10

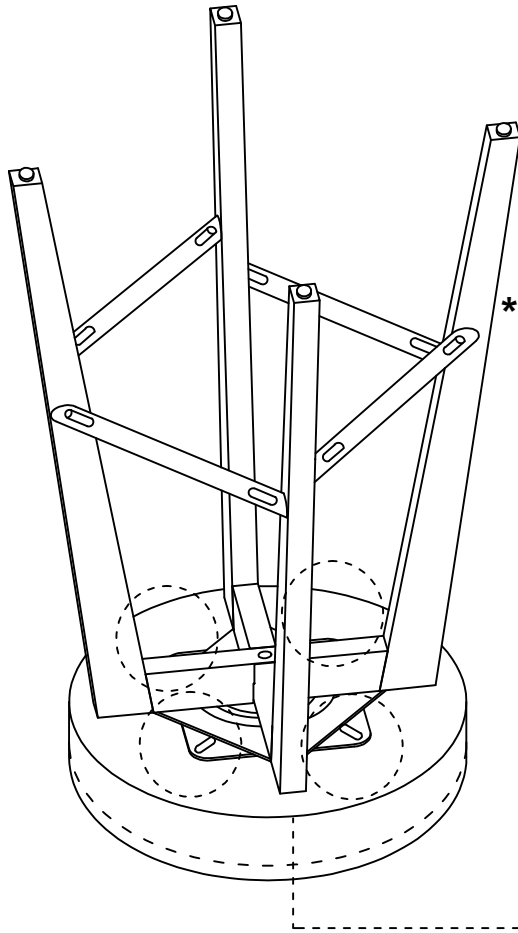

**\*\*Finish step 10,  
Please screw tight the  
step 1 bolts.**

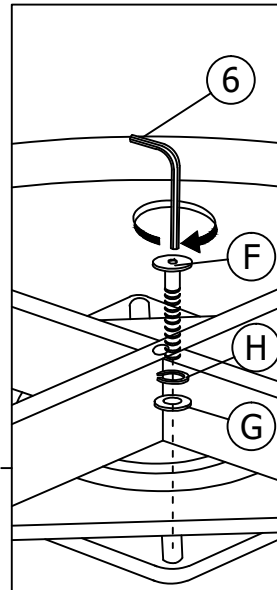

## STEP 11

