

# ASSEMBLY INSTRUCTION FOR ACME FURNITURE

Model #BD00601CKEK1

## DESCRIPTION: EASTERN KING BED HEADBOARD

Thank you for purchasing this quality product. Be sure to check all packing materials carefully for small parts, which may have come loose inside the carton during shipment. Identify and count all parts and compare with the parts list below.

**\*\* Do not fully tighten screws until fully assembled \*\***

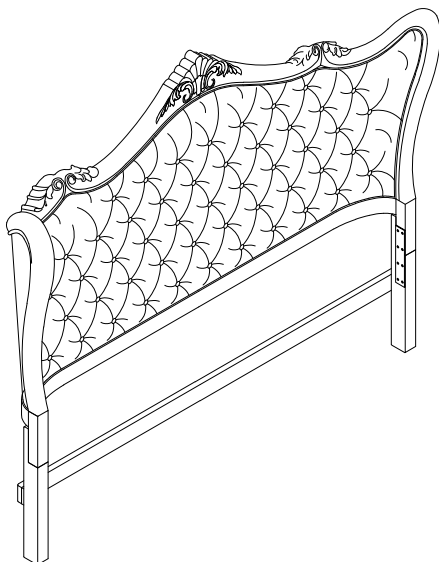

### PARTS LIST:

①		②		③	
HEADBOARD: 1PC		LEGS: 2PCS		HEADBOARD SLAT: 1PC	

### HARDWARE LIST

NO.	Drawing	Description	Q'ty
A		Bolt (Φ5/16"×2-1/2")	2pcs
B		Flat washer (Ø5/16"×19mm)	6pcs
C		Spring washer (Ø5/16")	6pcs
D		Ø5/16" Wrench(12mm)	1pc
E		Bolt (Φ5/16"×1-3/4")	4pcs
F		Screw Ø8x1-1/2"	8pcs

### STEP 1

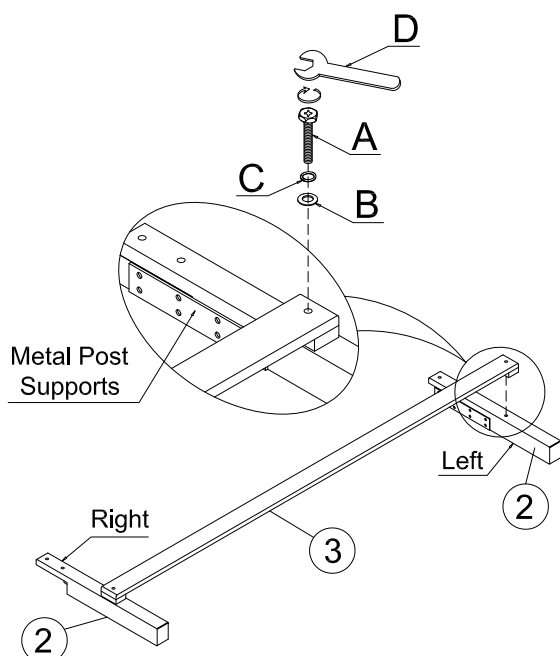

### STEP 2

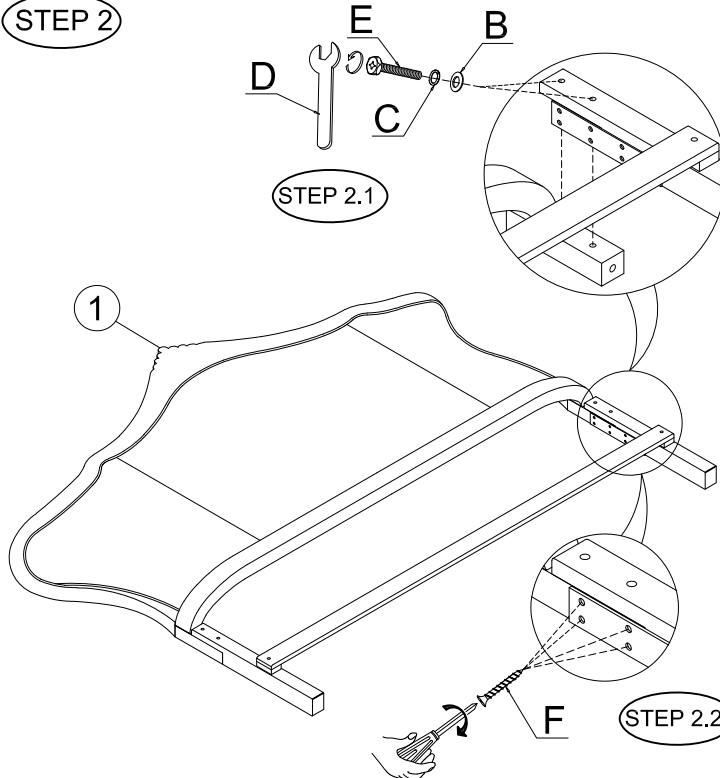

## CLEANING INSTRUCTION

Clean the surface of the King Poster Headboard with furniture polish and a soft cloth.  
Attention

\*\*\* Some number parts listed on the instruction sheet may not be in parts bag as they may be assembled. Carefully check parts and packing materials prior to ordering replacements.\*\*\*

# ASSEMBLY INSTRUCTION FOR ACME FURNITURE

Model #BD00601CKEK1-BD00601CKEK2-BD00602EKQ3

## DESCRIPTION: E.KING BED

Thank you for purchasing this quality product. Be sure to check all packing materials carefully for small parts, which may have come loose inside the carton during shipment. Identify and count all parts and compare with the parts list below.

**\*\* Do not fully tighten screws until fully assembled \*\***

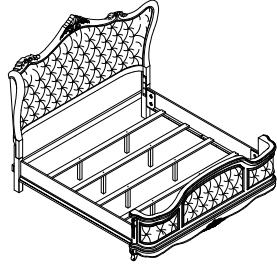

### PARTS LIST:

HARDWARE LIST				
NO.	Drawing	Description	Q'ty	
A		Threaded Bolt (Ø5/16"x3-1/2")	8pcs	
B		Flat washer (Ø28x14.5x7.5)	8pcs	
C		Hex Nut (Ø5/16")	8pcs	
D		Ø5/16" Wrench(12mm)	1pc	
E		Wood screw Ø8x1"	8pcs	

HEADBOARD: 1PC	FOOTBOARD: 1PC	SIDE RAIL: 2PCS	SLATS : 4PCS	SUPPORT LEGS: 8PCS

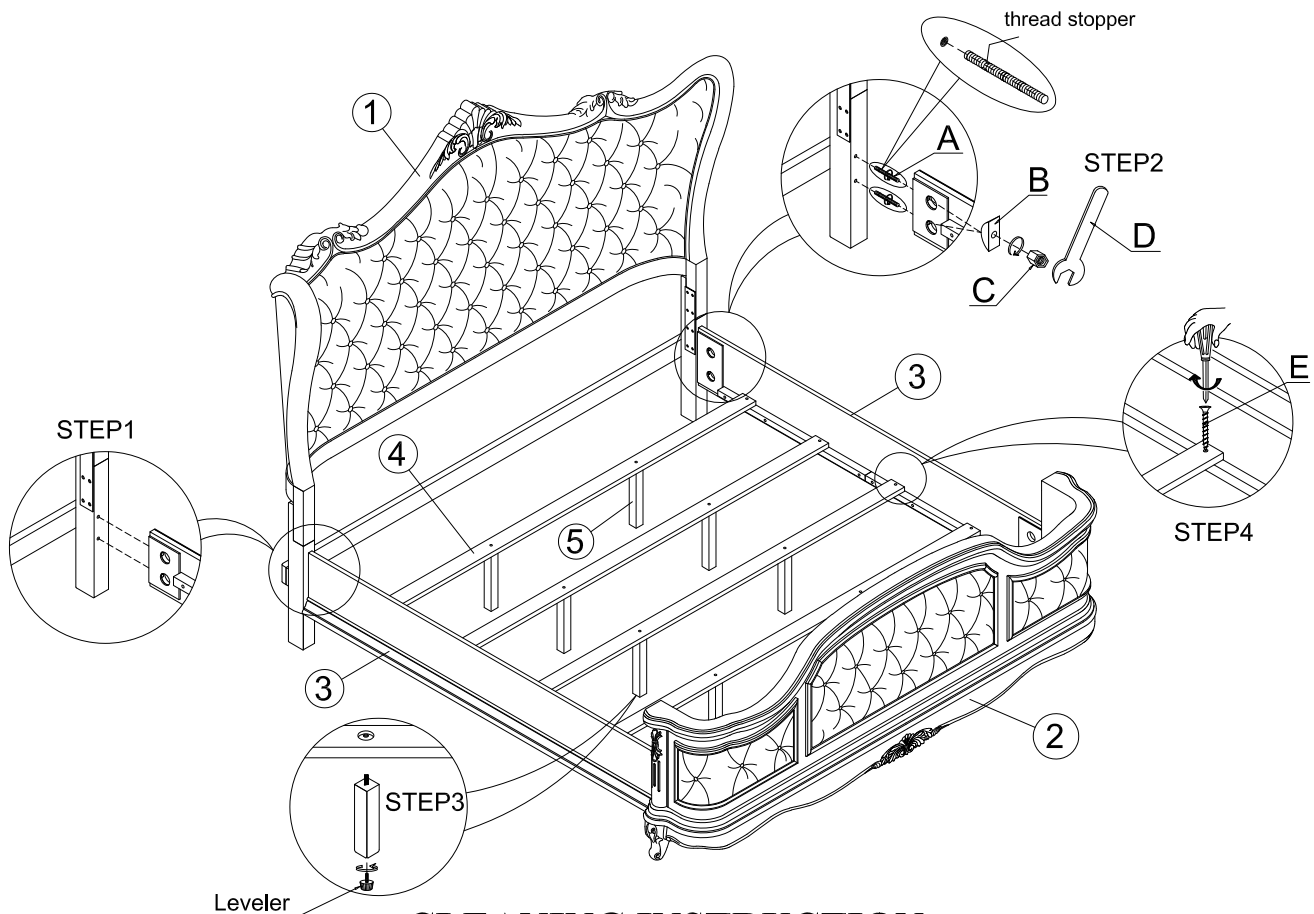

### CLEANING INSTRUCTION

Clean the surface of the King Bed with furniture polish and a soft cloth.

#### Attention

\*\*\* Some number parts listed on the instruction sheet may not be in parts bag as they may be assembled. Carefully check parts and packing materials prior to ordering replacements.\*\*\*

# ASSEMBLY INSTRUCTION FOR ACME FURNITURE

Model #BD00603Q1

## DESCRIPTION: QUEEN POSTER HEADBOARD

Thank you for purchasing this quality product. Be sure to check all packing materials carefully for small parts, which may have come loose inside the carton during shipment. Identify and count all parts and compare with the parts list below.

**\*\* Do not fully tighten screws until fully assembled \*\***

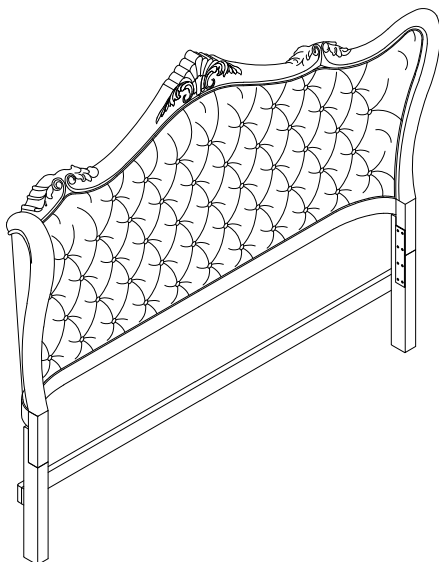

### PARTS LIST:

①		②	 Left  Right	③	
HEADBOARD: 1PC		LEGS: 2PCS		HEADBOARD SLAT: 1PC	

### HARDWARE LIST

NO.	Drawing	Description	Q'ty
A		Bolt (Φ5/16"×2-1/2")	2pcs
B		Flat washer (Ø5/16"×19mm)	6pcs
C		Spring washer (Ø5/16")	6pcs
D		Ø5/16" Wrench(12mm)	1pc
E		Bolt (Φ5/16"×1-3/4")	4pcs
F		Screw Ø8x1-1/2"	8pcs

### STEP 1

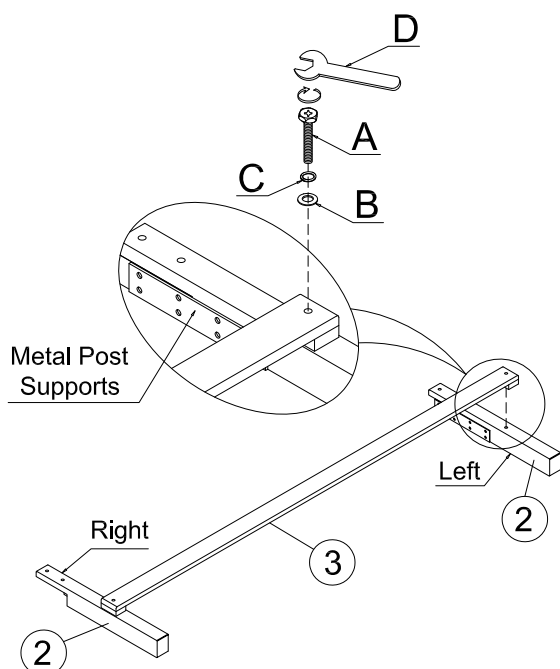

### STEP 2

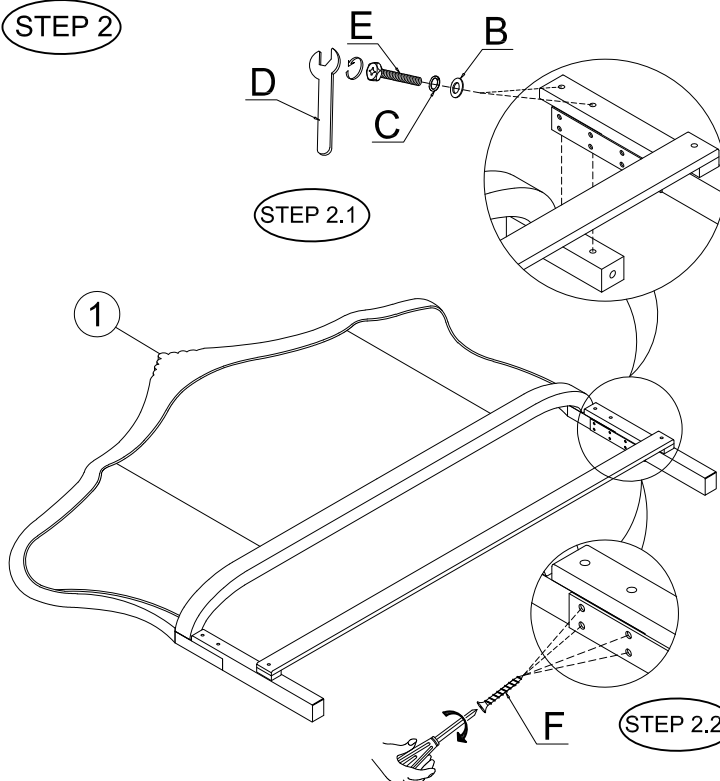

## CLEANING INSTRUCTION

Clean the surface of the Queen Poster Headboard with furniture polish and a soft cloth.  
Attention

\*\*\* Some number parts listed on the instruction sheet may not be in parts bag as they may be assembled. Carefully check parts and packing materials prior to ordering replacements.\*\*\*

# ASSEMBLY INSTRUCTION FOR ACME FURNITURE

Model #BD00603Q1-BD00603Q2-BD00602EKQ3

## DESCRIPTION: QUEEN BED

Thank you for purchasing this quality product. Be sure to check all packing materials carefully for small parts, which may have come loose inside the carton during shipment. Identify and count all parts and compare with the parts list below.

**\*\* Do not fully tighten screws until fully assembled \*\***

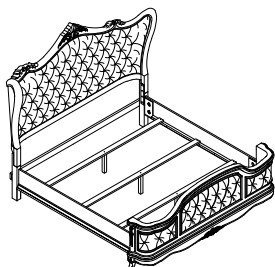

### PARTS LIST:

HARDWARE LIST				
NO.	Drawing	Description	Q'ty	
A		Threaded Bolt (Ø5/16"x3-1/2")	8pcs	
B		Flat washer (Ø28x14.5x7.5)	8pcs	
C		Hex Nut (Ø5/16")	8pcs	
D		Ø5/16" Wrench(12mm)	1pc	
E		Wood screw Ø8x1"	8pcs	

HEADBOARD: 1PC	FOOTBOARD: 1PC	SIDE RAIL: 2PCS	SLATS : 3PCS	SUPPORT LEGS: 3PCS

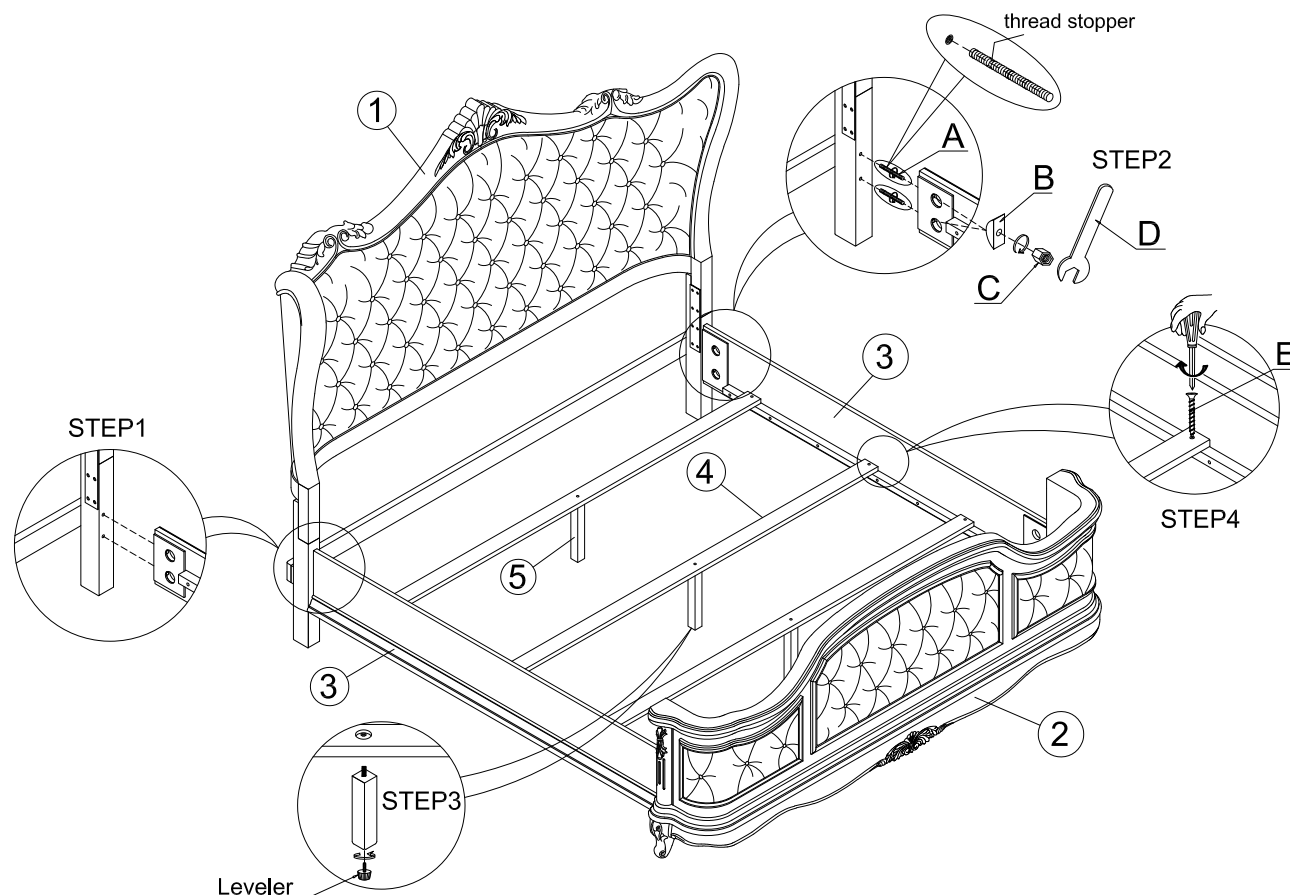

### CLEANING INSTRUCTION

Clean the surface of the Queen Bed with furniture polish and a soft cloth.

#### Attention

\*\*\* Some number parts listed on the instruction sheet may not be in parts bag as they may be assembled. Carefully check parts and packing materials prior to ordering replacements.\*\*\*

# ASSEMBLY INSTRUCTION FOR ACME FURNITURE

Model #BD00601CKEK1-BD00601CKEK2-BD00601CK3

## DESCRIPTION: CAL.KING BED

Thank you for purchasing this quality product. Be sure to check all packing materials carefully for small parts, which may have come loose inside the carton during shipment. Identify and count all parts and compare with the parts list below.

**\*\* Do not fully tighten screws until fully assembled \*\***

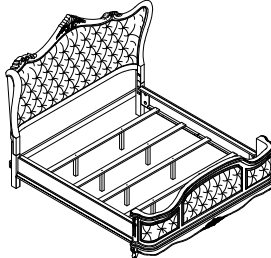

### PARTS LIST:

HARDWARE LIST				
NO.	Drawing	Description	Q'ty	
A		Threaded Bolt (Ø5/16"x3-1/2")	8pcs	
B		Flat washer (Ø28x14.5x7.5)	8pcs	
C		Hex Nut (Ø5/16")	8pcs	
D		Ø5/16" Wrench(12mm)	1pc	
E		Wood screw Ø8x1"	8pcs	

HEADBOARD: 1PC	FOOTBOARD: 1PC	SIDE RAIL: 2PCS	SLATS : 4PCS	SUPPORT LEGS: 8PCS

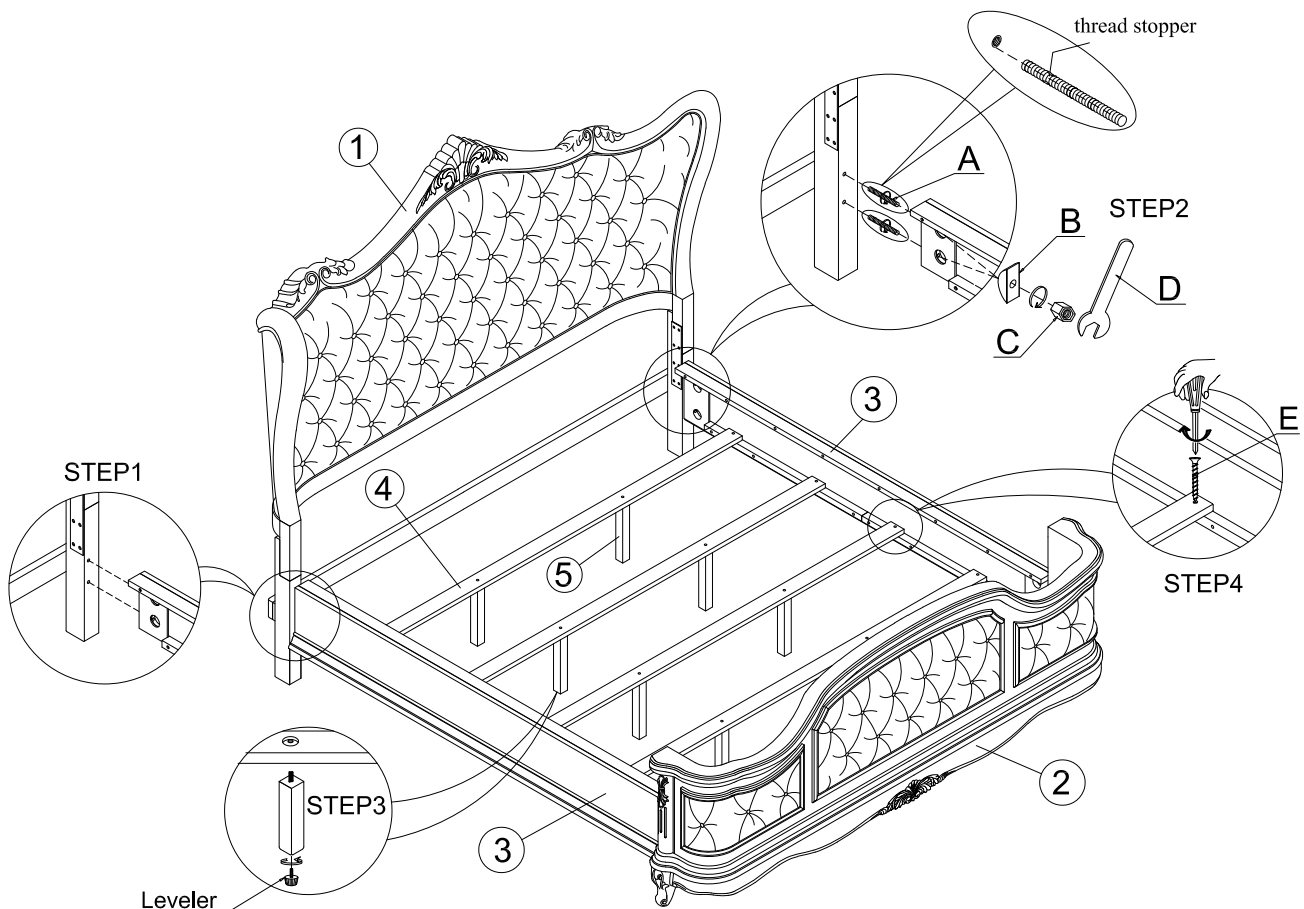

### CLEANING INSTRUCTION

Clean the surface of the Cal King Bed with furniture polish and a soft cloth.

#### Attention

\*\*\* Some number parts listed on the instruction sheet may not be in parts bag as they may be assembled. Carefully check parts and packing materials prior to ordering replacements.\*\*\*