

Contemporary Design Brass Luxury Gold Color Kitchen Faucet



INSTALLATION INSTRUCTIONS

You may need



For easy installation of your Delta faucet you will need:

- To **READ ALL** the instructions completely before beginning.
- To **READ ALL** warnings, care and maintenance information.
- To purchase the correct **water supply hook-up**.

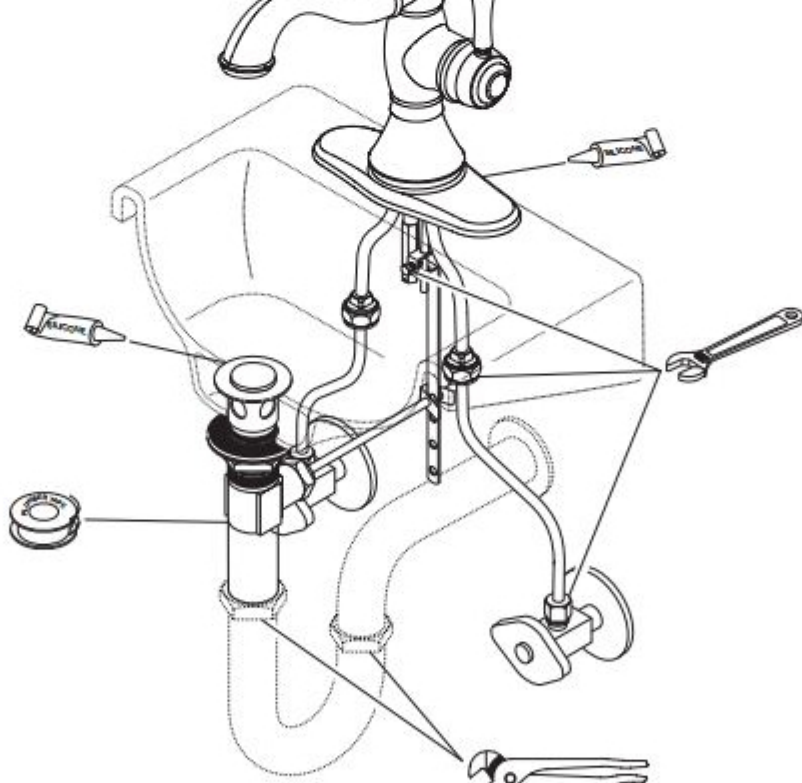

1

**Faucet Installation**

Position faucet (1) with gasket (2) or three hole escutcheon & gasket (2) on sink. **Note:** If sink is uneven, use silicone under the gasket. Place metal bracket (3) over mounting stud (4) under sink. Secure with mounting nut (5). Tighten mounting nut securely.

2

A.

B.

**Supply Line Connections**

**A.** Turn on hot and cold water supplies and flush water lines into a container for one minute. **Important: This flushes away any debris that could cause damage to internal parts.**

**B.** Make connections to water lines: Use 1/2" IPS faucet connections (1), or use coupling nuts (3) (not supplied) with 3/8" O.D. ball-nose risers (2). Use two wrenches when tightening. Do not over-tighten. **Note: Be careful when bending the copper tubing-Kinked tubes will void the warranty.**

3

A.

B.

C.

D.

E.

F.

G.

H.

**Metal Pop-up**

**A.** Remove stopper (1) and flange (2).

**B.** Screw nut (1) all the way down. Push washer (2) and gasket (3) down.

**C.** Remove tailpiece (1) from body (2), add plumber tape (3), replace tailpiece.

**D.** Apply silicone to underside of flange (1). Insert body (2) into sink. Screw flange (1) into body (2).

**E.** Pivot (1) must face faucet. Pull assembly (2) down firmly and hold in place. **DO NOT TWIST.**

**F.** Tighten nut/washer/gasket (1), clean off excess silicone (2). **DO NOT TWIST.**

**G.** Remove pivot nut (1). Install horizontal rod (2) and stopper (3) as removable (4) or non-removable (5). Hand tighten pivot nut (1).

**H.** Attach horizontal rod (1) to strap (2) using clip (3). Insert lift rod (4) into strap and tighten screw (5). Connect assembly to drain (6).

4

A.

B.

C.

D.

**Grid Strainer Installation**

**A.** Remove grid flange (1). Screw nut and washer (2) down as far as possible. Push gasket (3) down to nut and washer.

**B.** Remove tailpiece (1) and apply plumber tape (2) to threads. Replace tailpiece.

**C.** Apply silicone sealant to underside of grid flange (1). Insert grid strainer assembly (2) up through bottom of lavatory. Screw grid flange back on and secure.

**D.** Pull grid strainer straight down into drain hole and secure gasket nut and washer (1). **DO NOT TURN GRID STRAINER WHILE TIGHTENING NUT OR SEALANT MAY NOT SEAL DRAIN. REMOVE EXCESS SEALANT. Connect assembly to drain.**

5

**Check for Leaks**

Check all connections at arrows for leaks. Retighten if necessary, but do not over-tighten.

▲ Specify Finish  
Especifique el Acabado  
Précisez le Fini

**CLEANING AND CARE**

Care should be given to the cleaning of this product. Although its finish is extremely durable, it can be damaged by harsh abrasives or polish. To clean, simply wipe gently with a damp cloth and blot dry with a soft towel.

**Limited Warranty on Delta® Faucets**

Parts and Finish: All parts (other than electronic parts and batteries) and finishes of this Delta® faucet are warranted to the original consumer purchaser for 5 years from the date of purchase or, for commercial users, for 5 years from the date of purchase. Electronic parts (other than batteries) and finishes of this Delta® faucet are warranted to the original consumer purchaser for 5 years from the date of purchase or, for commercial users, for 5 years from the date of purchase. Delta Faucet Company will replace, FREE OF CHARGE, during the applicable warranty period, any part or finish that proves defective in material and/or workmanship under normal installation, use and service. If repair or replacement is not practical, Delta Faucet Company may elect to refund the purchase price in exchange for the return of the product. These are your exclusive remedies. Delta Faucet Company recommends using a professional plumber for all installation and repair. We also recommend that you use only genuine Delta® replacement parts. Delta Faucet Company shall not be liable for any damage to the faucet resulting from misuse, abuse, neglect or improper or incorrectly performed installation, maintenance or repair, including failure to follow the applicable care and cleaning instructions.

Replacement parts may be obtained by calling the applicable number below or by writing to: In the United States and Mexico: Delta Faucet Company, Product Service, 50 E. 111th Street, Indianapolis, IN 46280, 1-800-545-DELTA (3328), customerservice@deltafaucet.com. In Canada: Masco Canada Limited, Plumbing Group, Technical Service Centre, 200 South Edgeware Road, St. Thomas, Ontario, Canada N5P 4L1, 1-800-345-DELTA (3328), customerservice@mascoincanada.com.

Proof of purchase (original sales receipt) from the original purchaser must be made available to Delta Faucet Company for all warranty claims unless the purchaser has registered the product with Delta Faucet Company. This warranty applies only to Delta® faucets manufactured after January 1, 1995 and installed in the United States of America, Canada and Mexico. DELTA FAUCET COMPANY SHALL NOT BE LIABLE FOR ANY SPECIAL, INCIDENTAL OR CONSEQUENTIAL DAMAGES (INCLUDING LABOR CHARGES) FOR BREACH OF ANY EXPRESS OR IMPLIED WARRANTY ON THE FAUCET. Some states/provinces do not allow the exclusion or limitation of special, incidental or consequential damages, so these limitations and exclusions may not apply to you. This warranty gives you special legal rights. You may also have other rights which vary from state/province to state/province.

This is Delta Faucet Company's exclusive written warranty and the warranty is not transferable. If you have any questions or concerns regarding our warranty, please view our Warranty FAQs at www.deltafaucet.com, email us at customerservice@deltafaucet.com or call us at the applicable number above.

This General diagram and installation instructions are not intended for any specific model, but is presented as a general guideline for Installations!