

Central Brass Company, Inc.

3325 S. Garfield Ave.
Commerce, CA 90040
(800) 321-8630
www.centralbrass.com

INSTALLATION

Tools:



Adjustable Wrench



Plumbers Putty



Teflon Tape



Rags

Model Number: 1675 Series

Warnings and Notes:

Check with local plumbing code requirements before installation.
This product should be installed by a local listed plumber.

Do not use plumbers putty on threads.



Installation Steps:

Multi-Tub Pop-Up Bath Drain

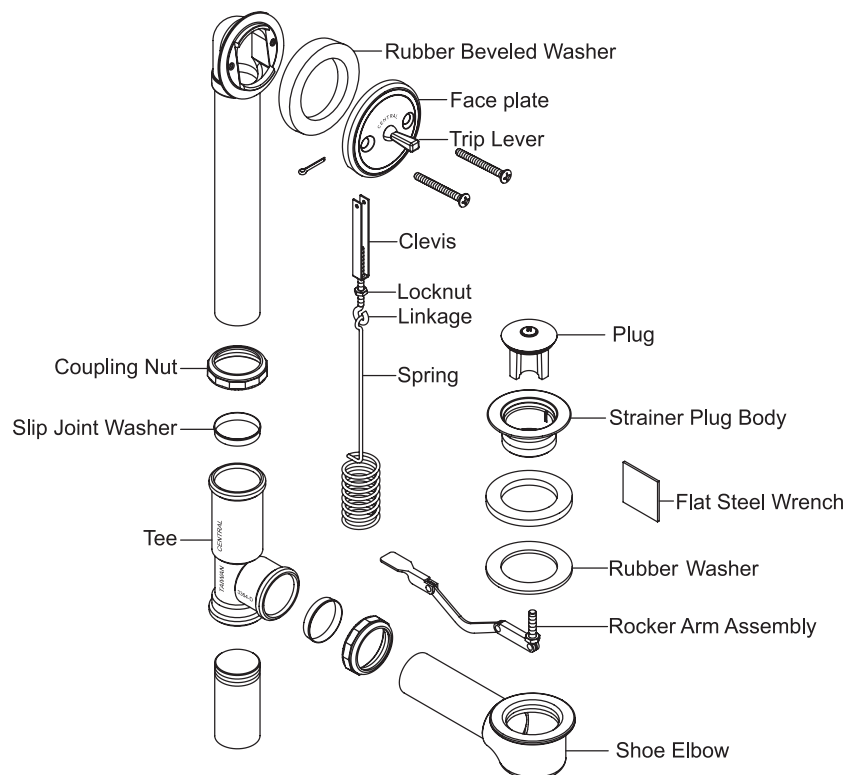

- (1) Apply a layer of plumbers putty to underside of strainer plug body, assemble in bathtub drain hole and screw tightly into shoe elbow as shown.
- (2) Assemble tubes with slip joint washers into tee as shown and screw on coupling nuts finger tight. Rotate rubber beveled washer on top ell to match angle of tub.
- (3) With the trip lever in the down position, insert the spring and linkage down through the top elbow as shown. Linkage can be screwed in and out of clevis to obtain the desired travel of the spring link. When the proper travel is adjusted, tighten linkage locknut to lock linkage in place. Screw in the two screws to hold face plate secure.
- (4) Tighten coupling nuts on tee with wrench to pull tapered slip joint washers securely into tee.
- (5) Assembly of a threaded tailpiece require the use of a thread sealant to prevent leakage.

Central Brass
COMPANY, Inc.

For more care information or trouble shooting inquiries
about your Central Brass product, please call:
Central Brass Company, Inc. (800) 321-8630
Monday-Friday 8 AM to 8 PM EST (5 AM to 5 PM PST)
www.centralbrass.com