

Stock Code: **20338LEDDMGLP-BL/FST**

Collection: WeeGo Dual Mount

PRODUCT INFORMATION

Base: 20338 Parent: 20338LEDDMG
Mounting Type: Ceiling or Wall UPC: 641594248685
Finish: Black
Diffuser: Frosted

PRODUCT MEASUREMENTS

FIXTURE	BACKPLATE / CANOPY
Length:	Length
Width: 4.75"	Width:
Diameter	Diameter: 4.75"
Height: 5.25"	Height:
Extension: 7"	
Overall Height:	

TECHNICAL SPECIFICATIONS

SPECIFICATIONS

Frame Material: N/A
Diffuser Material: N/A
Lamping Type: GU-10 (Replaceable LE Jbox: Standard
Lamping Base: GU-10 Lamp Wattage: 5.5 W
Lamp Quantity: 1 Total Wattage: 5.5 W
Voltage: 120v Lamps Included: Yes

QUALIFICATIONS

Location Rating Wet
Certification: ETL (US/Canada) Listed
ADA Compliant: No Energy Star: No
JA8 Compliant: No Emergency Lighting: No
Marine Grade: Yes Warranty: 5 Year

PHOTOMETRICS

Dimmable: Yes Nominal Lumens 500 Lm
CRI: 90 Delivered Lumens: N/A
CCT: 3000K
Recommended Dimmers:
(TRIAC)LEGRAND Titan CD703-PW; (MLV)COOPER Aspire
9530SW; (TRIAC)LUTRON Diva DVCL-153P; (ELV)LUTRON
Diva DVELV-300P; (ELV)LUTRON Skylark SELV-300P

Additional Notes:

Project Name: _____

Location: _____

Type: _____

Quantity: _____

Notes: _____



LINE DRAWING

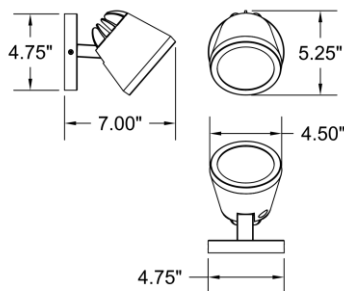

IES FILE

In addition to Access Lighting's purchase and warranty terms and conditions, by signing below or placing an order, you agree that you are authorized to bind the entity placing any order and acknowledge the following: All of sizes and measurements are approximate and all images are for illustrative purposes only. In the event of an inconsistency, the "Product Measurements" section controls. There also may be slight differences in the colors and designs compared to the displayed and printed images.

Signature: _____

Print Name _____ Date: _____

Toll Free 800-828-5483 www.AccessLighting.com

14410 Myford Road, Irvine, CA 92606

The information is subject to change without notice.

11/2/2022

20338LEDDMGLP-BL_FST.pdf

