

Central Brass Company, Inc.

3325 S. Garfield Ave.
Commerce, CA 90040
(800) 321-8630
www.centralbrass.com

INSTALLATION

Tools:



Adjustable Wrench



Teflon Tape



Rags

Model Number: 0050, 0051, 0054 Series

Warnings and Notes:

Check with local plumbing code requirements before installation.

This product should be installed by a local listed plumber.

Do not use plumbers putty on threads.



Installation Steps:

Service Sink Faucet

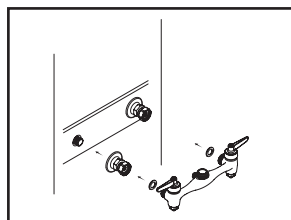

(1) Shut off main water supply. Confirm the distance between the centers of inlet pipe nipples. For "U" suffix is between 7-7/8" to 8-1/8" maximum apart. For "Y" suffix is between 3" to 13" maximum apart. Apply Teflon tape on the thread end of the nipples stretch out from the wall. Screw and tighten flange assemblies to the nipples with the help of a wrench. Adjust Hex nut of the flange assemblies to the proper position to connect the faucet body. With the washer inside the Hex nut of the flange assembly, tighten Hex nuts to the faucet body hand-tight then tighten both Hex nuts with the help of a wrench.

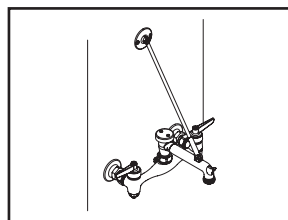

(5) Screw in the two screws to hold wall bracket secure.

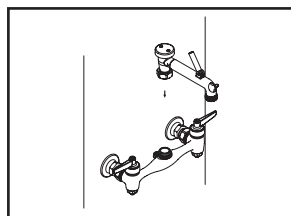

(2) Install spout to the faucet body. Make sure the spout is installed straight to avoid damaging the O-ring.

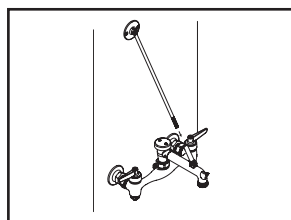

(3) For 0054 series, attach rod of wall bracket to faucet spout, measure the proper place to mount the wall bracket.

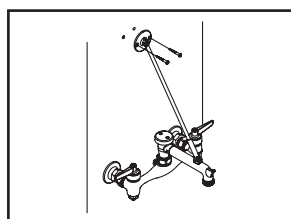

(4) Drill two 3/32" holes as shown in the drawing.

Central Brass

COMPANY, Inc.

For more care information or trouble shooting inquiries about your Central Brass product, please call:

Central Brass Company, Inc. (800) 321-8630

Monday-Friday 8 AM to 8 PM EST (5 AM to 5 PM PST)

www.centralbrass.com