

**Model: 6943XXXXL, 6943XXXXR**



(Items other than the mirror shown in the picture above are not included)

### FEATURES

- Recessed Mounting
- Energy Efficient and Long-Lasting LED Lighting
- Aluminum Frame
- Double-Side Mirror Door with Built-in 6" Dia. LED Lit Cosmetic Mirror
- 170° Soft-Closing Hinges
- Two Adjustable Tempered Glass Shelves
- Rocker Switch
- 3-prong 120V Electrical Outlet (x2)
- USB High-Speed Charger w/4.8A Charging Capability (x2)
- Mirrored Interior
- Copper-Free Mirror

### LIGHTING

- Lighting in Front & Back of Mirror Door
- Average Bulb Life of 50,000 hours
- CRI: 85+
- Color Temperature: 6000K (Daylight)
- Brightness & Power Consumption: see page 2
- Power Requirements: 110-130V AC, 60Hz

### SAFETY

- IP44 Rated
- Safety Backed Mirror

### OVERVIEW

**innoci-usa** does not cut corners and only uses the highest quality components and bulbs to make sure that the mirror will be maintenance free and function like the day you purchased for average 50,000 hours of use. **innoci-usa** prides itself on providing unmatched price vs quality for all of our products. All mirrors come with a 5-year limited warranty.

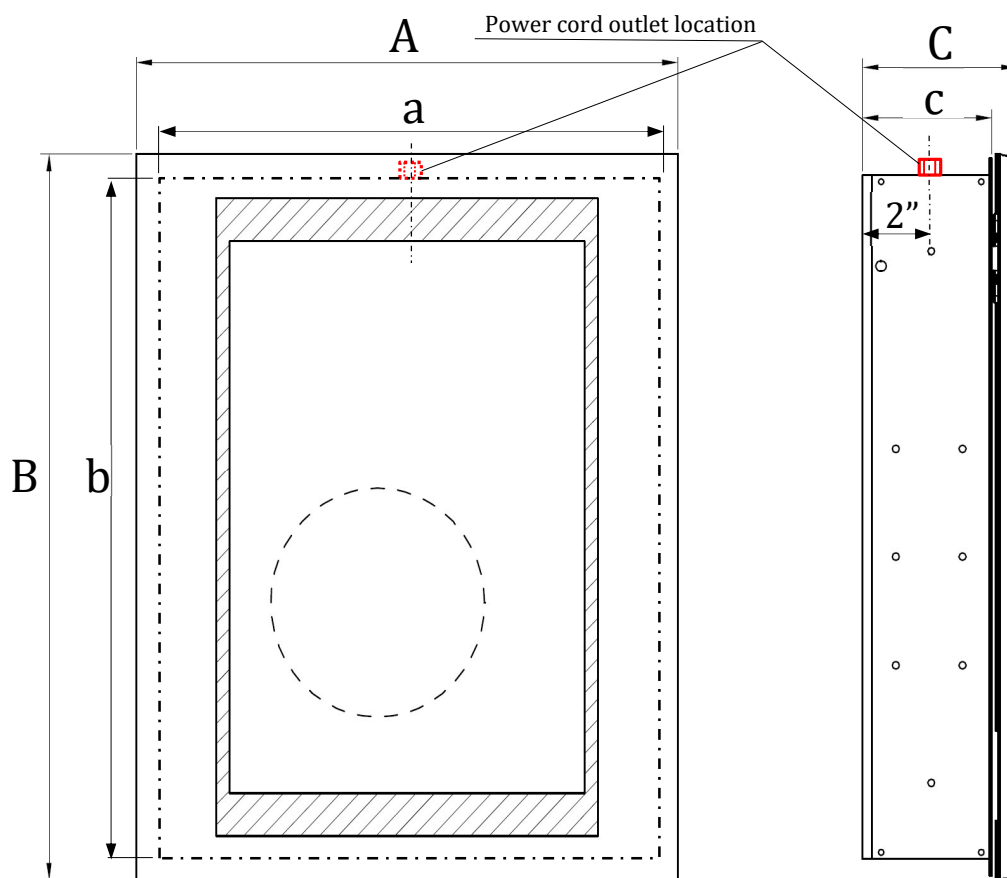

Model #	Overall Dimensions			Rough in Dimensions			Brightness (Lumen)	Power Consumption (Watt)
	A	B	C	a	b	c		
69431620L	16	20	4-1/2	15	19	4	1065	17
69431620R	16	20	4-1/2	15	19	4	1065	17
69432026L	20	26	4-1/2	19	25	4	1365	22
69432026R	20	26	4-1/2	19	25	4	1365	22

© innoci usa, Inc. All rights reserved.

innoci-usa Inc.  
Santa Fe Springs, CA 90670

[www.innoci-usa.com](http://www.innoci-usa.com)  
(866) 479-8076

[customerservice@innoci-usa.com](mailto:customerservice@innoci-usa.com)

**innociusa**  
LIFESTYLE

rev1.8