

FIXED RECTANGLE CURVED SHOWER ROD

CLEAN MODERN LINES

sales@preferredbathinc.com

www.preferredbathinc.com

(336) 904-6248



SAG FREE STAINLESS STEEL CURVED SHOWER ROD

- STAINLESS STEEL RECTANGLE CURVED SHOWER ROD WITH SIX INCH BOW - 1
- STAINLESS STEEL MOUNTING SCREWS - 4
- STAINLESS STEEL SET SCREWS - 2
- ZINC DIE-CAST WALL BRACKETS AND ROD RECEIVERS - 2

PART NUMBERS

FINISH

112-5BP

BRIGHT POLISHED

112-5BN

BRUSHED NICKEL

112-5MB

MATTE BLACK

PATENTED T-PLUG DESIGN

- PATENTED DESIGN #USD752421S
- SAG FREE CURVED SHOWER ROD
- EASY ONE PERSON INSTALLATION

MAY BE CUT DOWN TO FIT ANY SIZE OPENING

- TOTAL INSTALLED LENGTH OF CURVED SHOWER ROD IS 60 INCHES
- TOTAL BOW OF CURVED SHOWER ROD IS 6 INCHES

To cut the shower rod down please follow these instructions: Measure the total opening of the shower/tub enclosure and subtract that number from 60 inches. The remaining number is what will need to be cut from the shower rod. Example: 58 inch opening minus 60 inches leaves 2 inches to cut. It is best to cut equal amounts off both ends, this insures a proper fit.

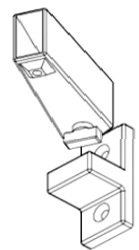
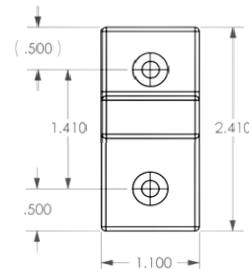

INSTALLATION:

Screw the wall brackets onto the wall first. Be sure to measure and level each wall bracket. Once complete attach the bar receivers to the wall brackets via the patented T-Plug and insert the shower rod approximately 2 inches in one mounted bar receiver, then rotate the shower rod towards the second empty bar receiver mounted on the adjacent wall. When the shower rod and the empty bar receiver line up slide the shower rod approximately 1 inch into the second mounted bar receiver. Use the provided set screws to lock everything in place.

WOOD BLOCKING IS THE PREFERRED METHOD OF INSTALLATION

Limited Warranty:

Preferred Bath Accessories Inc. warrants to the purchaser that the product will be free from defects in material and workmanship. If the product does not comply with this warranty, Preferred Bath Accessories Inc. will repair or replace the product or, at Preferred Bath Accessories Inc's. option, refund the purchase price. The limited warranty period is for the lifetime of the product. Limitations on the Warranty: The warranty does not cover, normal wear and tear, product abuse, neglect, improper installation or maintenance. Purchaser Requirements: If this product does not meet Preferred Bath Accessories Inc's. warranty, return the product (postage prepaid) to the place of purchase with proof of purchase and a written claim briefly describing the defect. You may be required to provide other information or evidence of the defect.