

Read this instruction carefully. See hardware and furniture part list for guidance. Be sure all parts are complete, before you assemble. Place all wooden furniture parts on a clean and flat soft surface to prevent from being scratched. Follow the figure to start assembling.

CAUTIONS : 1. Do not FULLY - TIGHTEN the nut or nut bolt until all nut or bolt is ready assembled.
2. Do not OVER - TIGHTEN the nut or bolt to avoid causing damages to the thread.
3. Keep all hardware parts out of reach of children.

NOTE : THE LIST AND QUANTITY SHOWN ARE FOR 1 UNIT ASSEMBLY.

Tool needed : Screwdriver (not provided).

PART LIST		
ITEM	DESCRIPTION	QTY
A	BACK	1PC
B	SEAT	1 PC
C	FRONT LEG	2 PCS
D	FRONT LEG SUPPORT (METAL)	1 PC
E	SIDE RAIL	2 PCS

HARDWARE LIST		
ITEM	DESCRIPTION	QTY
1	JCBC BOLT M6 x 80mm	4 PCS
2	JCBC BOLT M6 x 50mm	5 PCS
3	WOOD SCREW M4 x 20mm	2 PCS
4	WOOD SCREW M3.5 x 12mm	8 PCS
5	WOOD SCREW M3.5 x 16mm	12 PCS
6	M6 FLAT WASHER	9 PCS
7	M6 SPRING WASHER	9 PCS
8	M4 ALLEN KEY (BALL SHAPE)	1 PC
9	5005 2 HOLE L BRACKET (BLACK)	2 PCS
10	5003 2 HOLE L BRACKET (BLACK)	8 PCS
11	WOOD SCREW M4 x 45mm	4 PCS

STEP 1

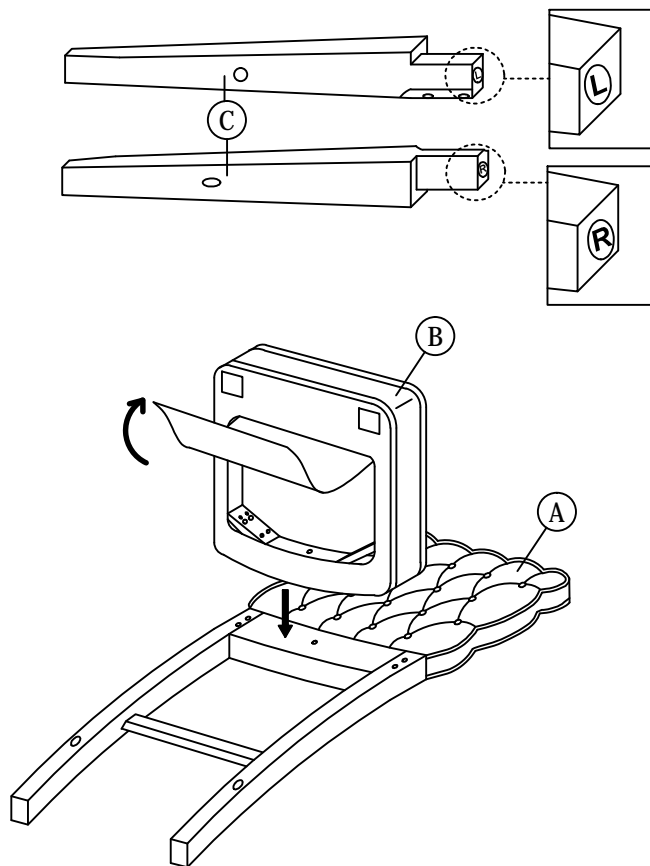

STEP 2

STEP 2.2

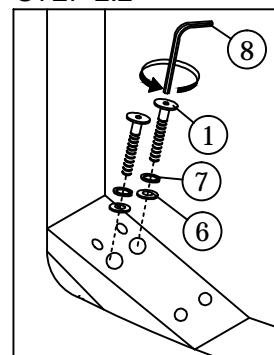

Don't screw tied

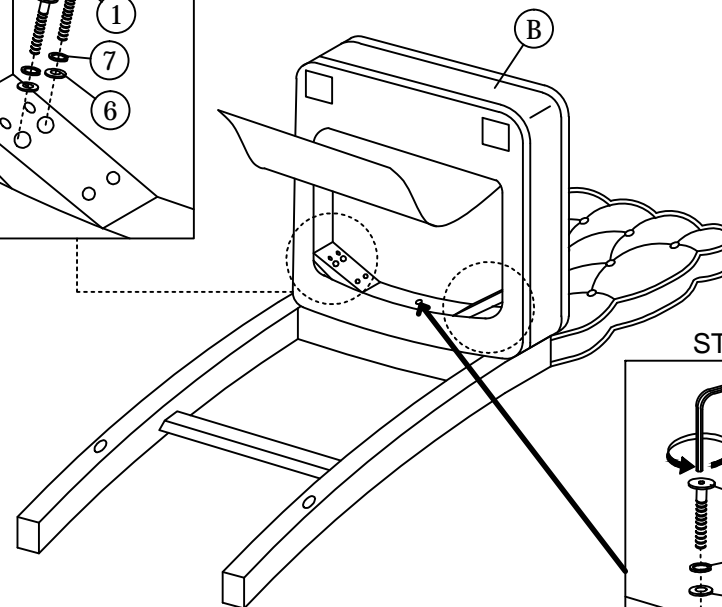

STEP 2.1

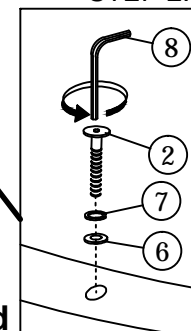

Don't screw tied

ASSEMBLY INSTRUCTIONS

2 OF 4

STEP 3

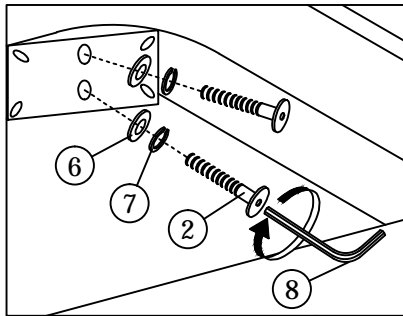

Don't screw tied

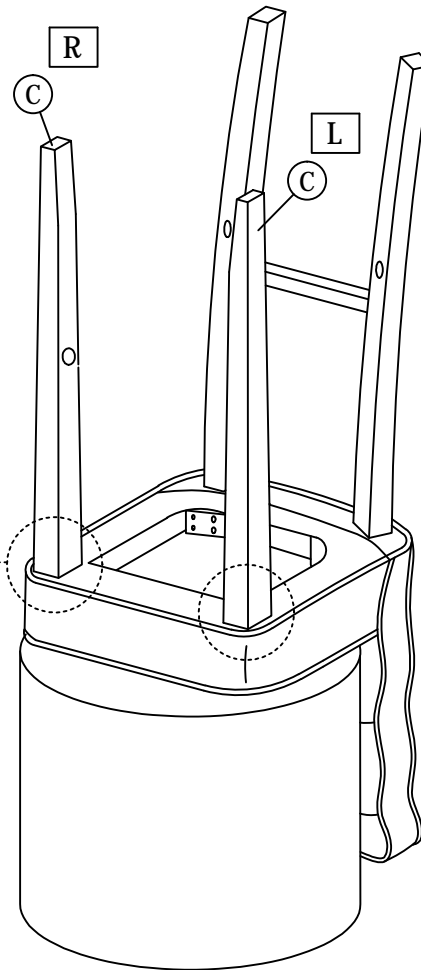

STEP 4

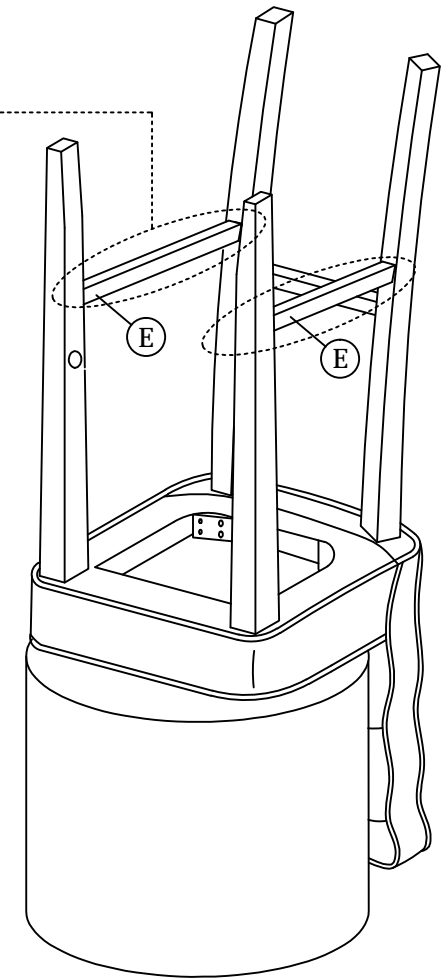
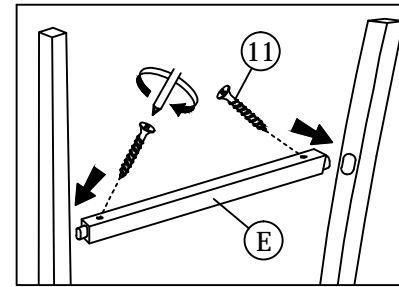

ASSEMBLY INSTRUCTIONS

3 OF 4

STEP 5

****Finish step 5,
Please screw tied the
step 2 & 3 bolt.**

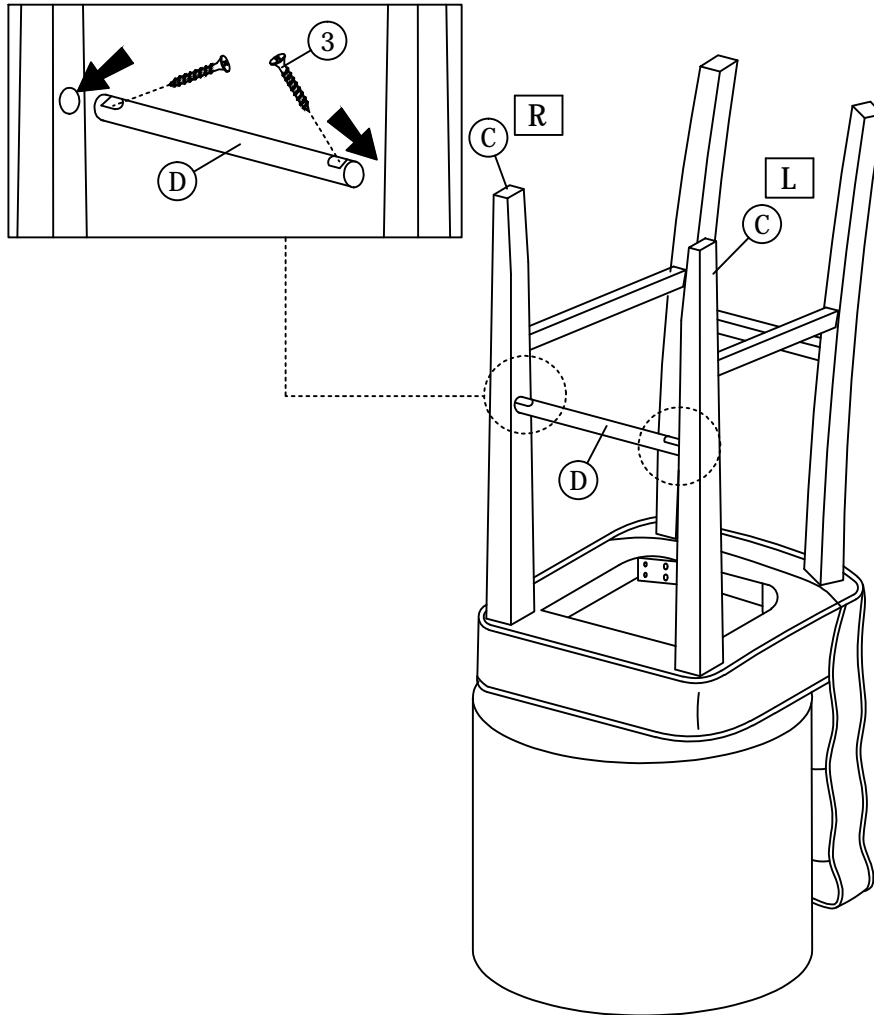

STEP 6

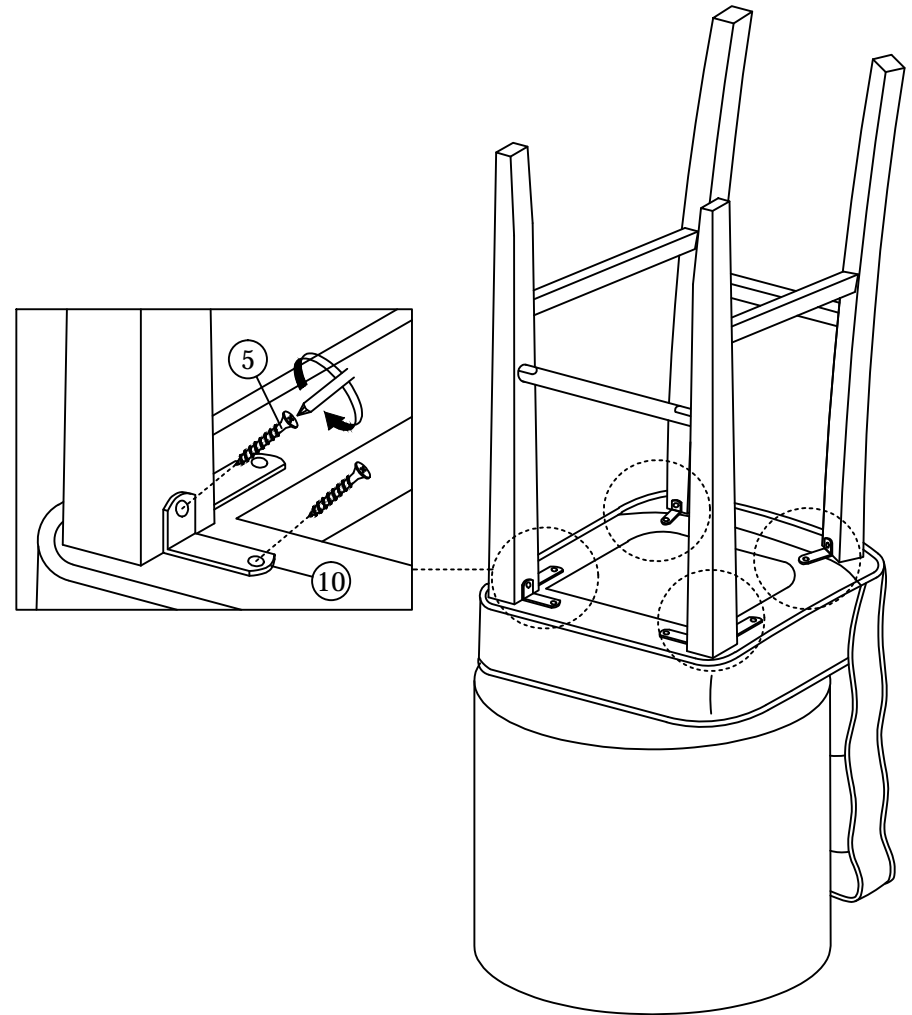

ASSEMBLY INSTRUCTIONS

4 OF 4

STEP 7

STEP 7.1

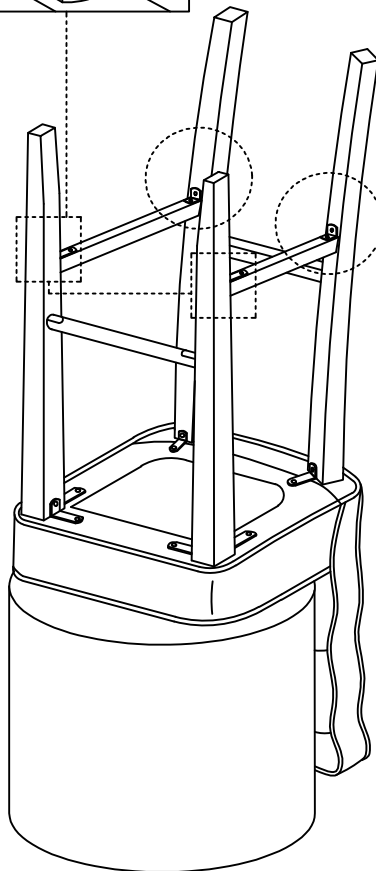
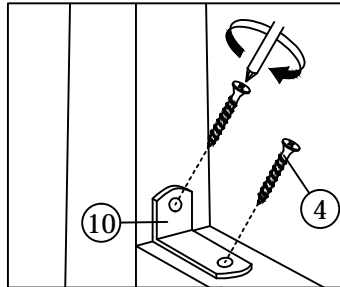

STEP 7.2

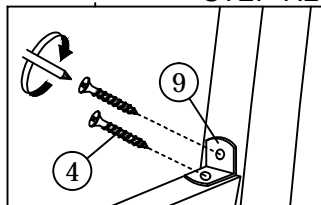

STEP 8

