

Fontana 16" Oil Rubbed Bronze Square Color Changing LED Rain Shower Head (Solid Brass)

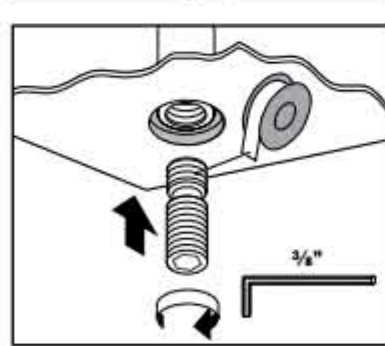
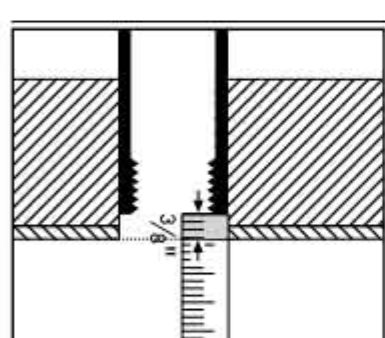
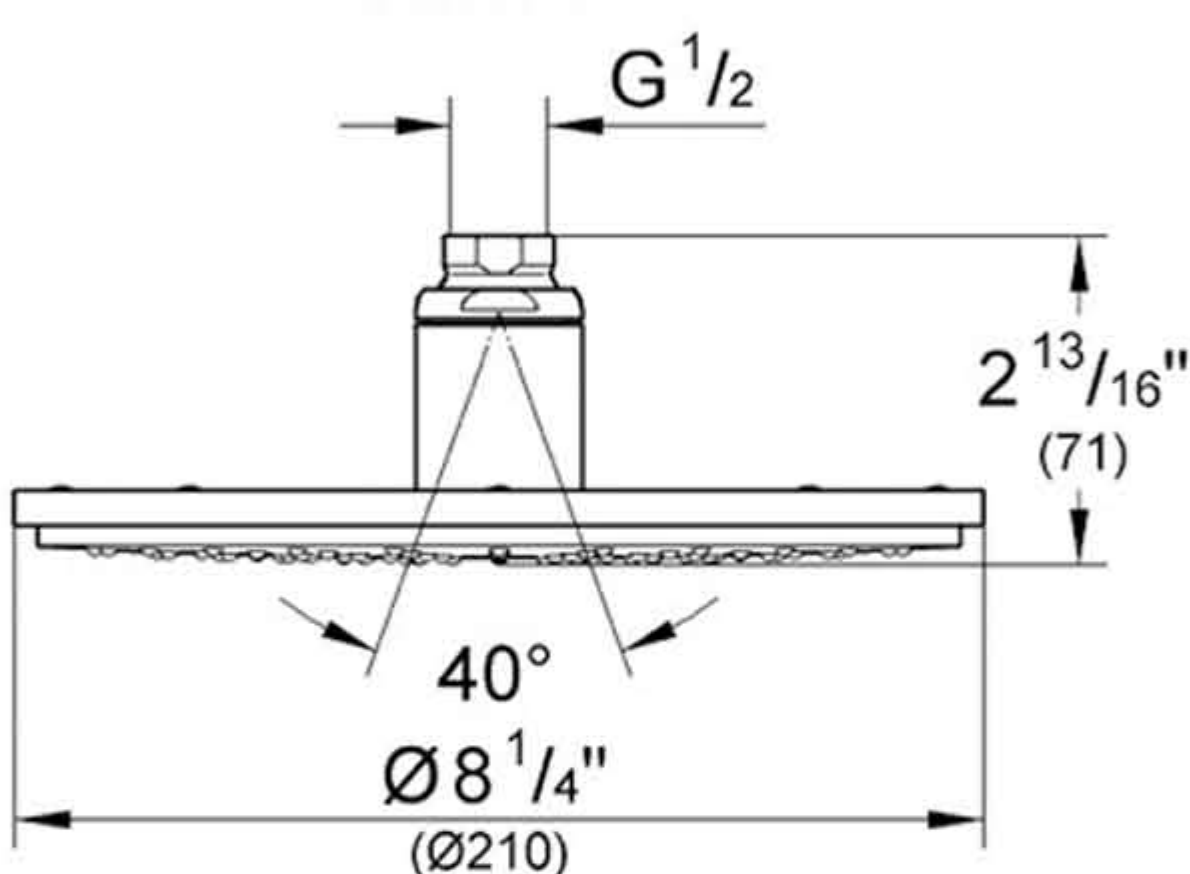

27390XX1 Installation

Rough-in: install a 1/2" NPT female fitting, recessed 3/8" inside the surface of the finished ceiling.

Wrap the threads on 1/2" NPT part of the nipple with Teflon tape.

Install the mounting nipple using a 3/8" Allen wrench (not included).

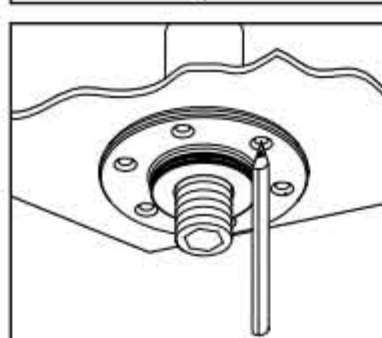
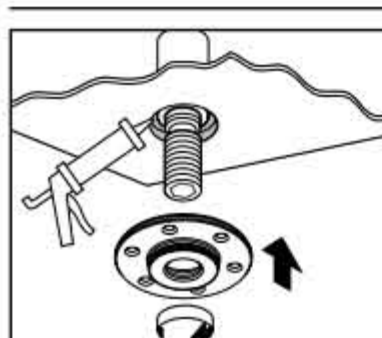
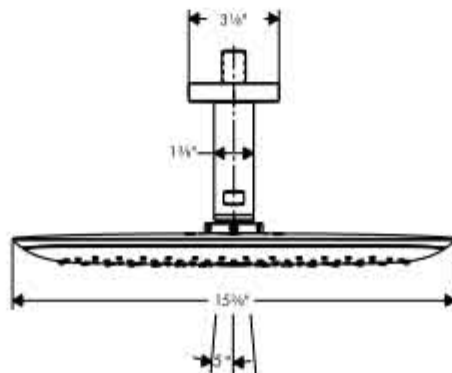
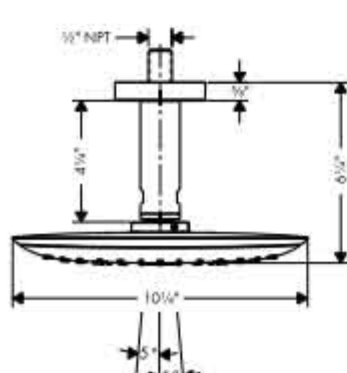

Seal the ceiling around the nipple using waterproof sealant.

Install the mounting ring.

Mark the positions of four screw holes.

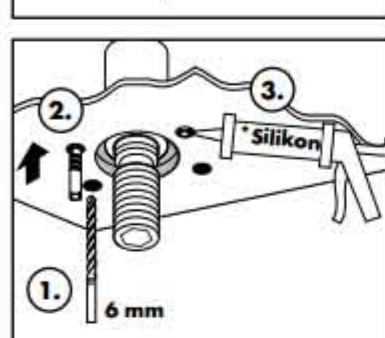
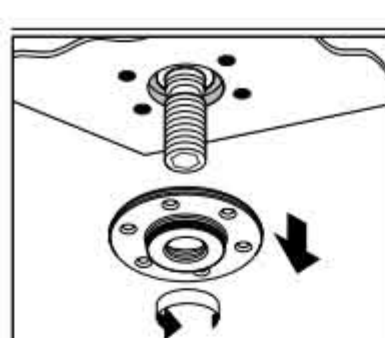

Remove the mounting ring.

Drill the screw holes using a 6 mm bit (1).

Install the anchors (2).

Seal the ceiling around the anchors using waterproof sealant (3).

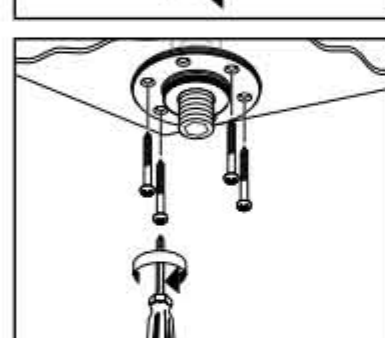
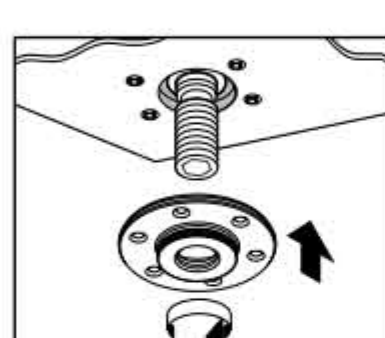

Install the mounting ring.

Install the screws.

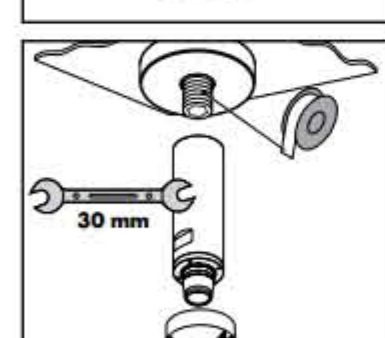
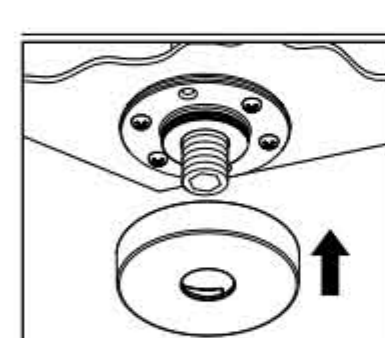

Install the escutcheon.

Wrap the threads on the nipple using Teflon tape.

Install the extension pipe.

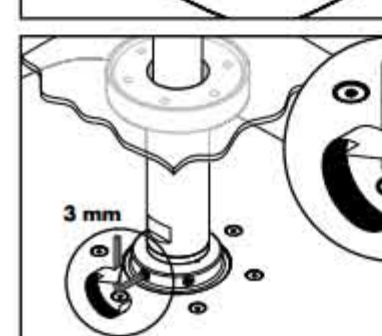
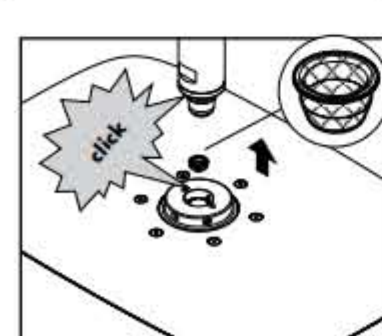

Tighten the safety screw using a 3 mm Allen wrench.



Failure to tighten the safety screw may result in injury or product damage.

This General diagram and installation instructions are not intended for any specific model, but is presented as a general guideline for Installations!