

MADISONPARK®

ASSEMBLY INSTRUCTIONS

Description: Glenwood Swivel Counter Stool

Important safety instructions:

- Please read carefully all instructions before assembly.
- For your safety and ease, assembly by two or more adults is recommended.
- Keep instructions for future use.

Pre-assembly:

- Do not discard any content until assembly is complete to avoid accidentally discarding small parts or hardware.
- Take out all parts and hardware from box.

Parts List

Item	Description	QTY
P1	Chair Top	1
P2	Chair Base	1

Hardware List

Item	Description	QTY
H1	Bolts Ø1/4"*1-1/4"L	8
H2	Lock Washers 1/4"	8
H3	Flat Washers 1/4"	8
H4	Allen Wrench 1/4"	1
H5	Swivel 180°	1

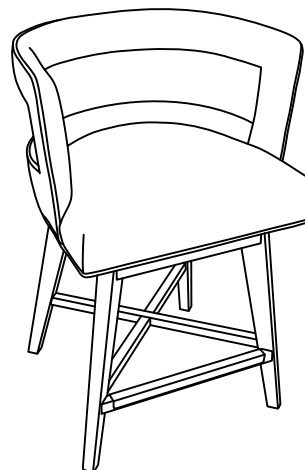

DISCLAIMER:

WHEN PROPERLY ASSEMBLED, THIS ITEM IS SAFE FOR INTENDED USE. SELLER IS NOT LIABLE FOR ANY DAMAGES RESULTING FROM ITEM BEING IMPROPERLY ASSEMBLED AFTER PURCHASE.

Assembly Procedures:

Step 1. Assemble the stool on a flat, soft surface such as a carpet or cloth to prevent scratching the finish. Take the swivel out from the box, then insert four bolts (H1) to the swivel (H6) as shown below. Loosely attach the swivel (H5) to the top of chair base (P2) as shown below. Securely tighten the bolts with Allen wrench (H4).

- (H1)x4 Bolts Ø1/4"*1-1/4"L
- (H2)x4 Lock Washers Ø1/4"
- (H3)x4 Flat Washers Ø1/4"
- (H4)x1 Allen Wrench 1/4"

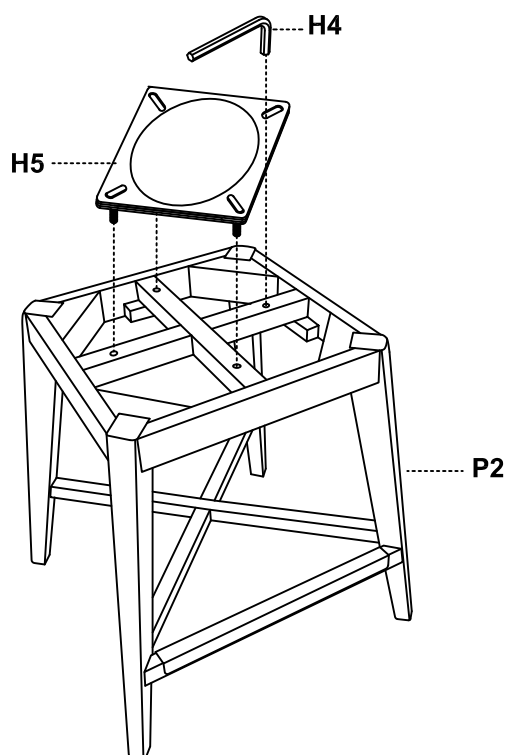
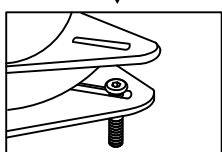
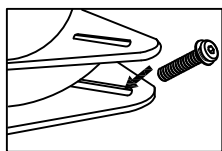
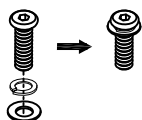
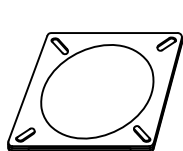

Step 2. Turn the assembled chair base to an upside down position, repeat insert the other four bolts to the swivel, then loosely attach the assembled chair base (P2) to the bottom of chair top (P1) as shown below, securely tighten the bolts with Allen wrench (H4).

- | | | |
|--------|-----------------------------------|---|
| (H1)x4 | Bolts $\varnothing 1/4"$ *1-1/4"L |  |
| (H2)x4 | Lock Washers 1/4" |  |
| (H3)x4 | Flat Washers 1/4" |  |
| (H4)x1 | Allen Wrench 1/4" |  |

Caution:

There are three steps in this step.

- 1) An adult must help to hold the chair base and then insert the bolts into the hole at the bottom of the chair top.
- 2) Rotate the swivel to a specific position so that all the holes in the swivel are exposed.
- 3) Securely tighten the bolts.

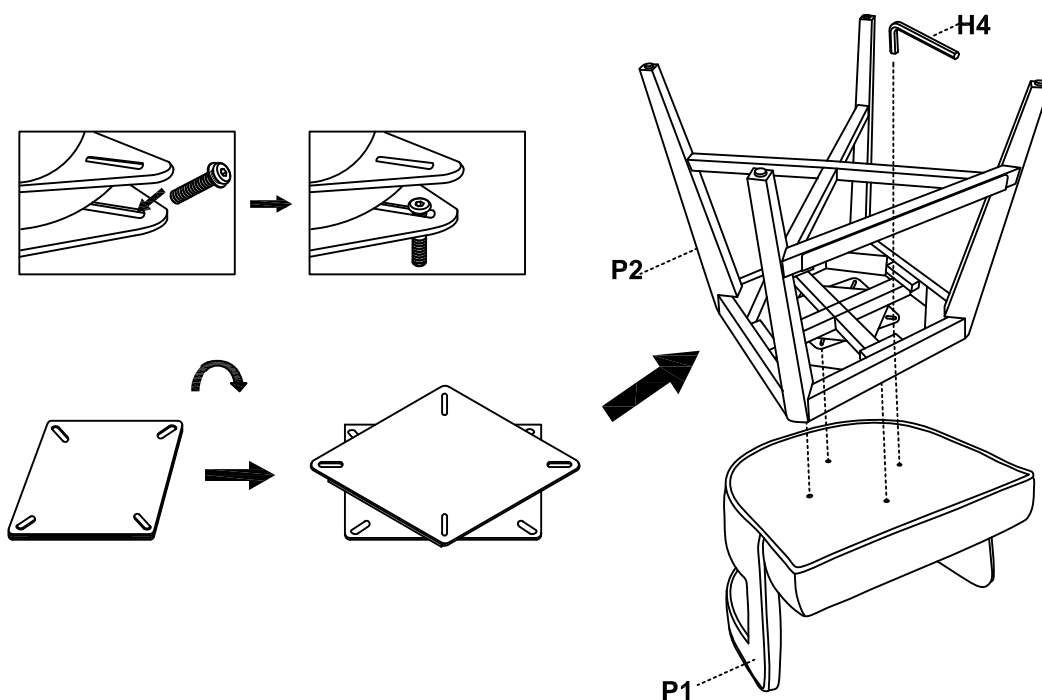

Step 3. Turn the assembled stool to an upright position, assembly is complete. **Failure to follow these instructions may cause the bolts to misalign during assembly.**

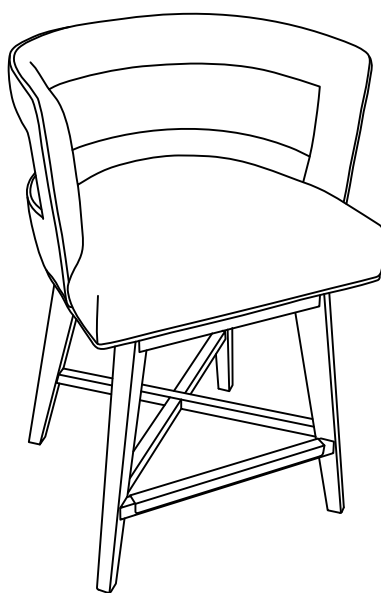

ADDITIONAL NOTE ABOUT SAFETY:

BOLTS MAY LOOSEN DURING NORMAL EVERYDAY USE.

THEY SHOULD BE INSPECTED AT LEAST EVERY 3 MONTHS AND RE-TIGHTENED AS NEEDED TO PREVENT DAMAGE OR INJURY, AND ENSURE STABILITY.

Thank you for your purchase