

THERMOSTATIC SHOWER Series INSTALLATION GUIDE

We hope you never have the need, but if you do, we are always here to provide a friendly and hassle-free service.

 info@eversteinaucet.com

 www.eversteinaucet.com

 [\(1\)888-369-2169](tel:(1)888-369-2169)
[\(Toll Free:4:30PM-6:00 AM PST\)](tel:(1)888-369-2169)

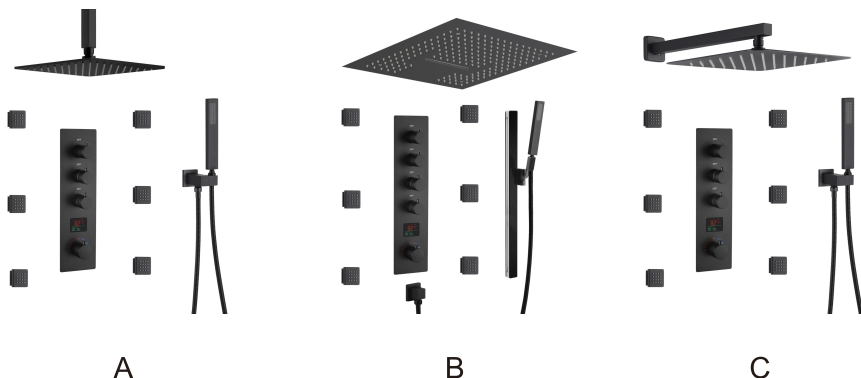

CONTENT

1.Installation condition	1
2.Luxury 3-function thermostatic shower syatem (Model:A&C)	2
3.Luxury 4-function thermostatic shower syatem (Model:B)	7
4.Body jets Insrallation (Model:A&B&C)	12
5.Care And Maintenance	19

◆ Installation Condition

1. Check the accessories list to verify that all parts are complete in this package.
2. Do not disassemble the mainbody by yourself.
3. Connect inlet pipes to supply valves.
4. Make sure inlet pipes and supply valves have been installed and cleaned, with no impurities in the pipeline.
5. After installation, check all joints for leakages.
6. Do not leave the rain shower system exposed to a severely corrosive environment.

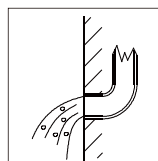
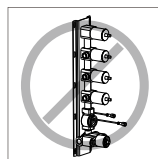
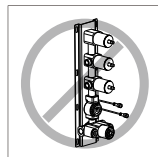

YOU MAY NEED:

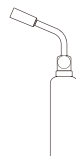
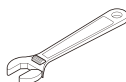
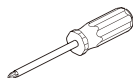

◆ **Luxury 3-function thermostatic shower syatem**
Model:A&C
Accessories List

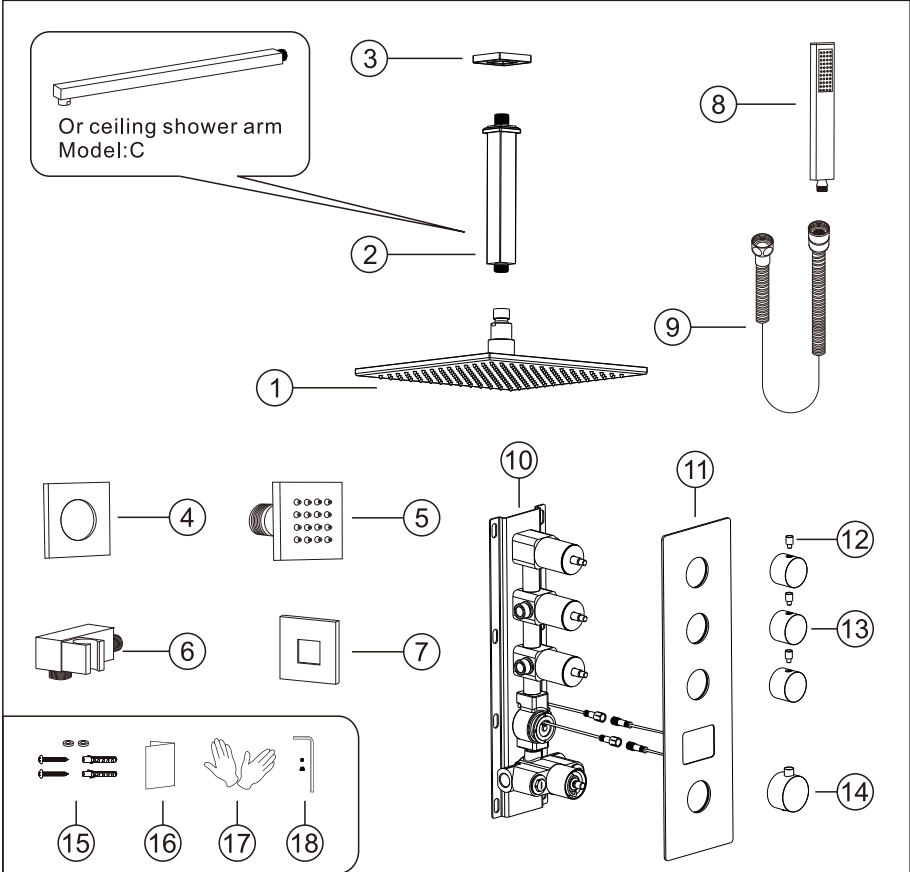

No.	Part name	Qty	No.	Part name	Qty
1	Shower head	1	10	Main body	1
2	Shower arm	1	11	Deck plate	1
3	Shower arm cup	1	12	Water diverter rod	3
4	Body jet cover	6	13	Water diverter	3
5	Body jet	6	14	Handle	1
6	Hand shower holder	1	15	Main body spare parts	8
7	Holder cup	1	16	Instruction manual	1
8	Hand shower	1	17	Gloves	2
9	Shower hose	1	18	Handle parts	1set

◆ **Essential dimensions & water pipe line (Model:A&C)**

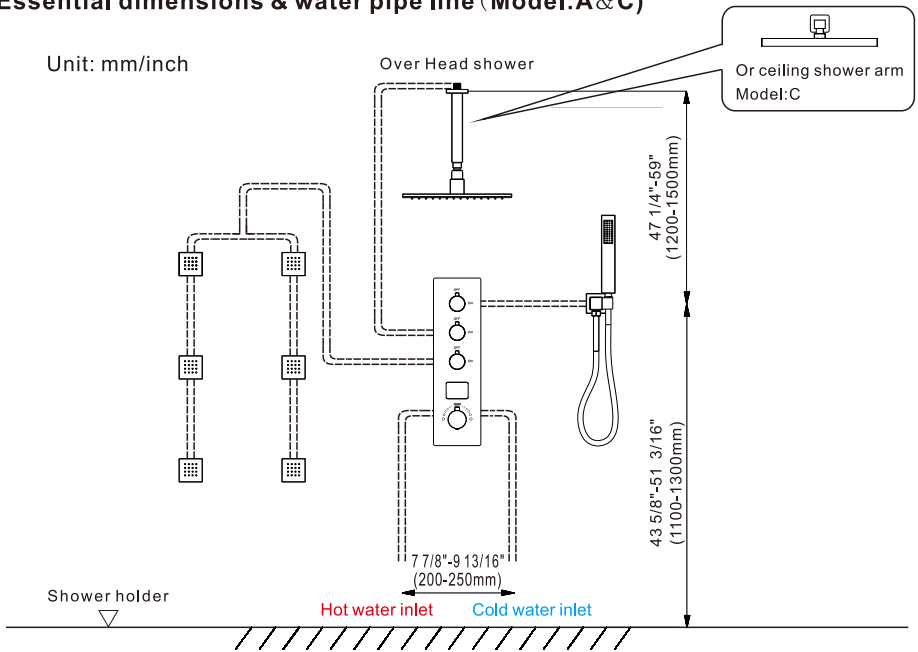

◆ **The installation depth of shower holder and body jet (Model:A&C)**

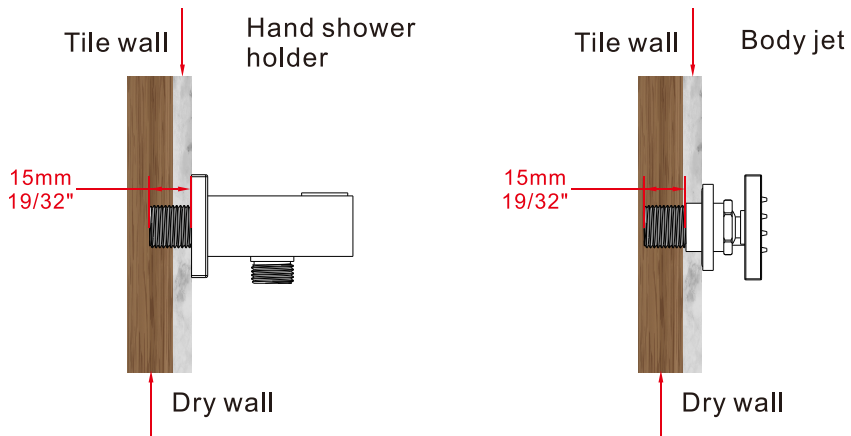

The thickness of tile must be calculated installation.

Connector size of male thread:USA: $1\frac{1}{2}''-14\text{NPT}$ Canada: $1\frac{1}{2}''-14\text{NPT}$ Europe: $G1\frac{1}{2}''$

◆ Installation Depth Of Main Body (Model:A&C)

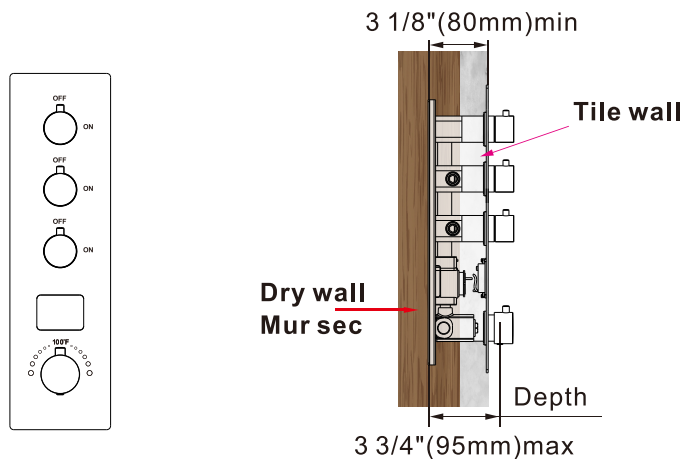

- Notice:** 1.The installation depth of main body should be no less than 3 1/8"(80mm) and no more than 3 3/4"(95mm), including the thickness of tile.Other wise,the deck plate cannot be installed.
2.The opening size of ceramic tile shall be smaller than the deck plate size.

◆ Piping Instructions Before Tiling (Model:A&C)

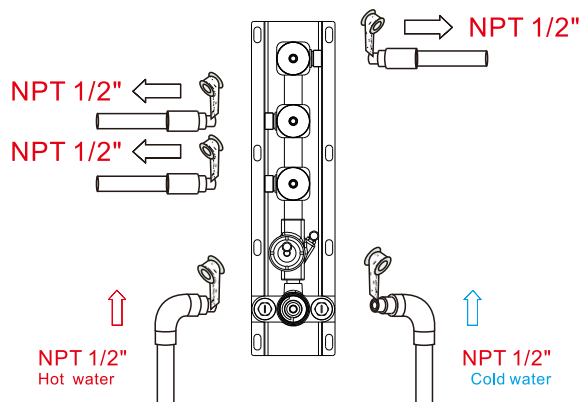

- 1.As shown in the figure,the inlet and outlet pipes are pre-buried.Please pay attention to the correct direction of installing the pre-buried main body.
- 2.Before tiling,turn on the water to test whether the left and right inlet pipes are tightly connected without leakage.Then,adjust the flow switch to be on to check the mixed outlet pipes for leakges.

◆ Main Body Valve Installation (Model:A&C)

Step1

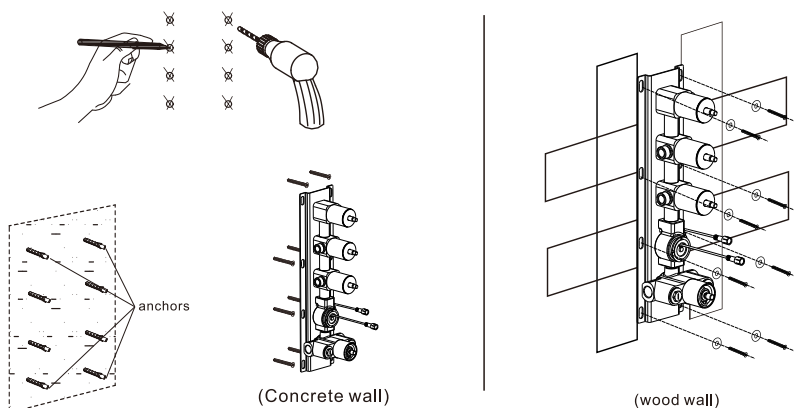

- 1.Make marks according to the size of the main body valve and then drill anchors into the wall(concrete wall)
- 2.Lock main body to wood directly with screws(wood wall)
- 3.When you installing the main body, please mark the UP side up, and do not install it upside down.

▲ Please note that the level meter should be parallel with the wall, otherwise the deck plate cannot be installed.

Step2

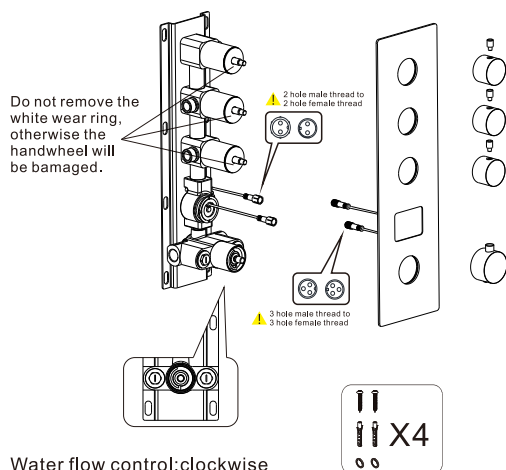

Precautions for handwheel installation

※ 1: The line can't misplace, it should be kept in a line, otherwise the water temperature of 100°F or 38°C will not be correct.

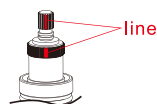

※ 2: Please ensure that A Plastic locating ring and B handwheel locating pin kept in the same line with 100°F or 38°C. Otherwise, the water temperature will be wrong.

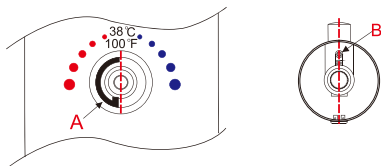

- 1.Please install deck plate, water diverters and water diverter rods step bu step.
- 2.Install the handle with the screw and handle cap.

◆ Installation of rain shower head & shower arm (Model:A&C)

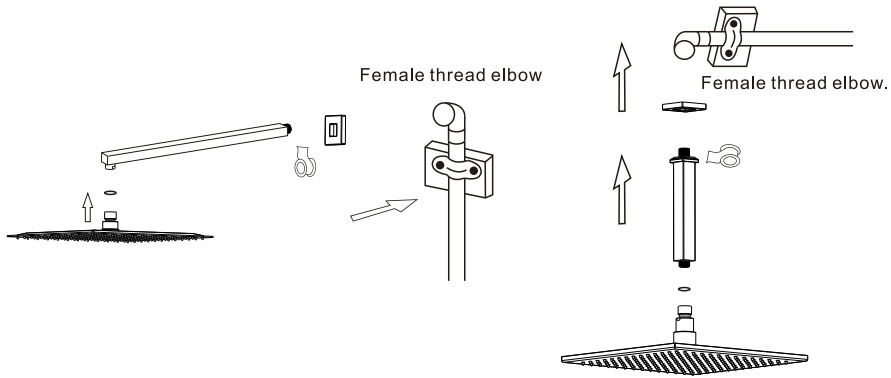

1. Connect shower arm with the cover before screwing arm into riser connection to prevent damage.
2. Fix shower head onto shower arm and apply tape to pipe threads on both ends.
3. Do not overtighten shower head. it is 360° swivel connection.

◆ Installation The Hand Show Holder (Model:A&C)

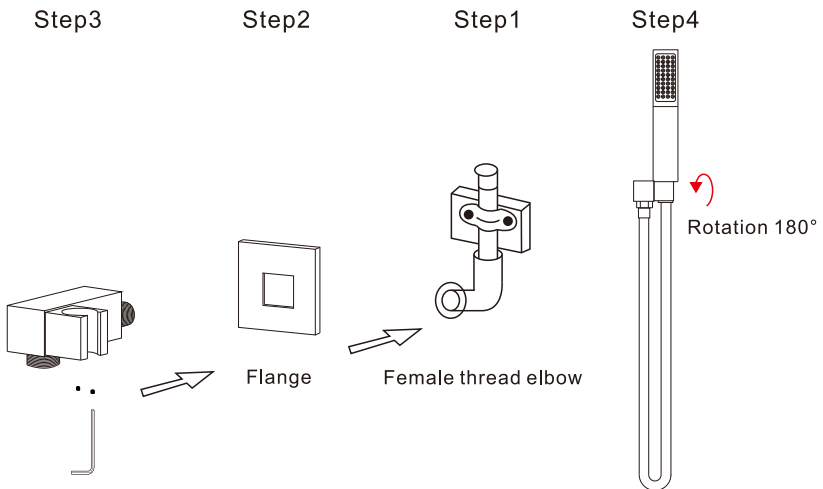

- Step 1. Screw the thread into the water pipe inside the wall
- Step 2. Screw the main body into the thread.
- Step 3. Rotate and fix the body with the special-shaped wrench
- Step 4. Connect hand shower and the hose.

◆ **Luxury 4-function thermostatic shower syatem**
Model:B
Accessories List

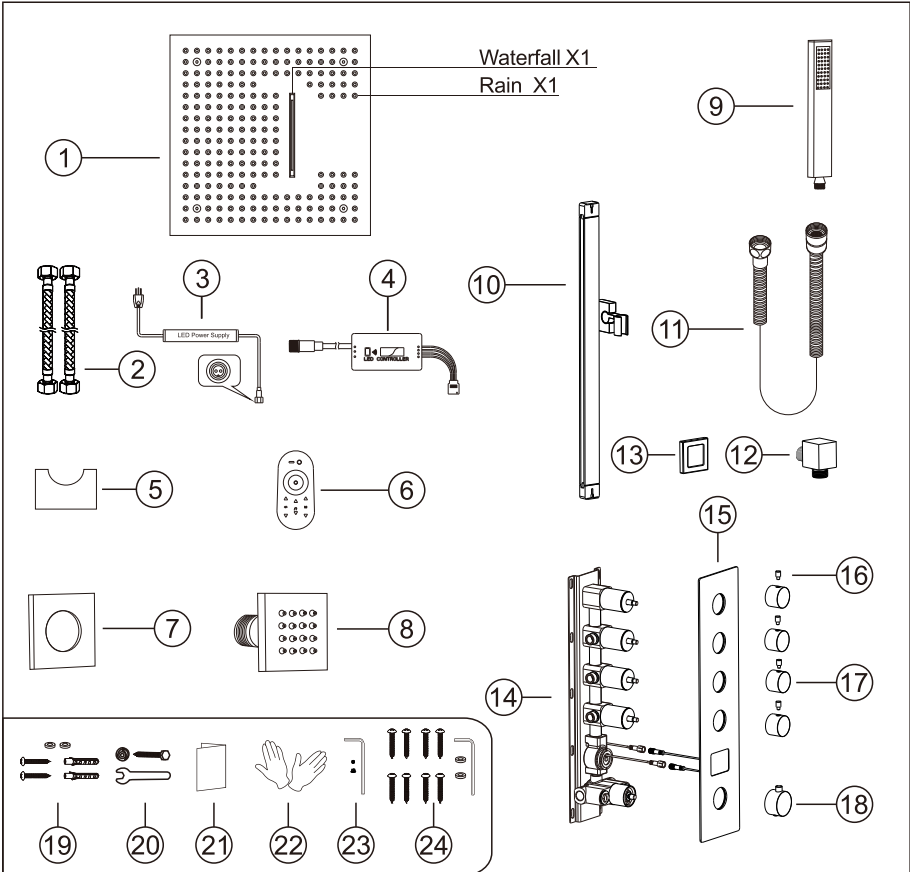

No.	Part name	Qty	No.	Part name	Qty
1	Shower head body	1	13	Cup	1
2	Corrugated pipe	2	14	Main body	1
3	Water proof power supply	1	15	Deck plate	1
4	LED Controller	1	16	Water diverter rod	4
5	Controller pedestal	1	17	Water diverter	4
6	LED Controller	1	18	Handle	1
7	Body jet cover	6	19	Main body spare parts	10
8	Body jet	6	20	Lifting rod parts	1
9	Shower head	1	21	Instruction manual	1
10	Lifting rod	1	22	Gloves	2
11	Shower hose	1	23	Handle parts	1set
12	Connector	1	24	shower head screw package	1set

◆ Essential dimensions & water pipe line

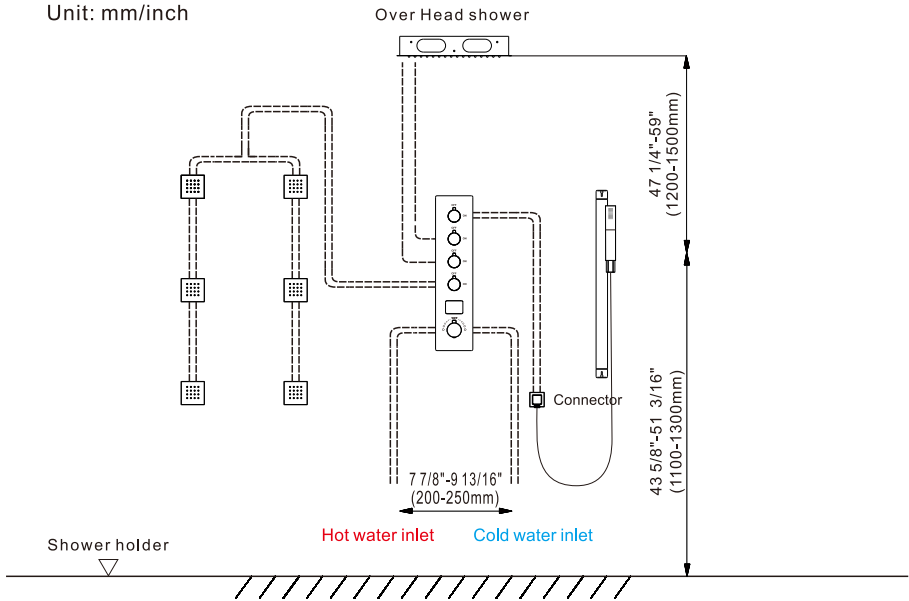

◆ The installation depth of shower holder and body jet

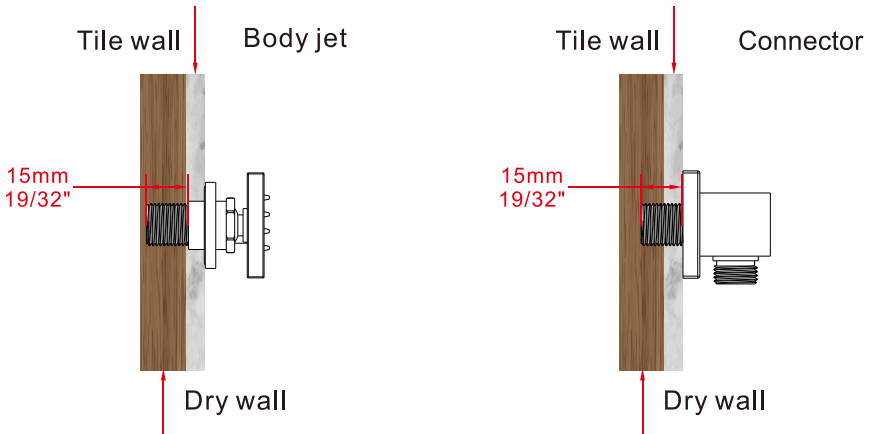

The thickness of tile must be calculated installation.

Connector size of male thread: USA: $1\frac{1}{2}" - 14\text{NPT}$ Canada: $1\frac{1}{2}" - 14\text{NPT}$ Europe: $G1\frac{1}{2}"$

◆ **Installation Depth Of Main Body**

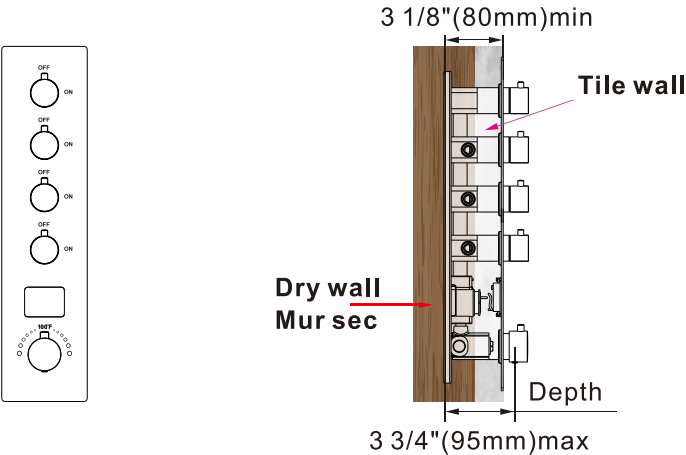

Notice: 1.The installation depth of main body should be no less than 3 1/8"(80mm) and no more than 3 3/4"(95mm), including the thickness of tile.Other wise,the deck plate cannot be installed.
2.The opening size of ceramic tile shall be smaller than the deck plate size.

◆ **Piping Instructions Before Tiling**

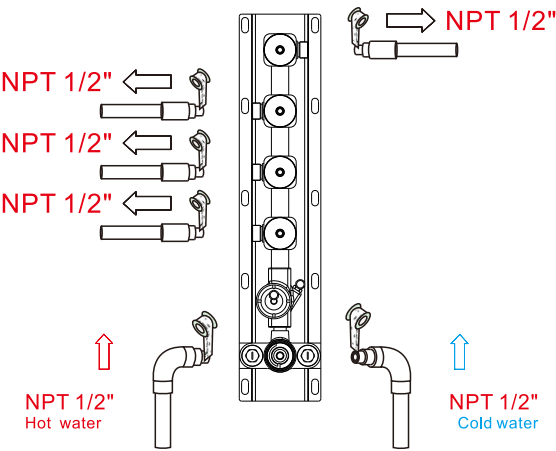

- 1.As shown in the figure,the inlet and outlet pipes are pre-buried.Please pay attention to the correct direction of installing the pre-buried main body.
- 2.Before tiling,turn on the water to test whether the left and right inlet pipes are tightly connected without leakage.Then,adjust the flow switch to be on to check the mixed outlet pipes for leakges.

◆ Main Body Valve Installation

Step1

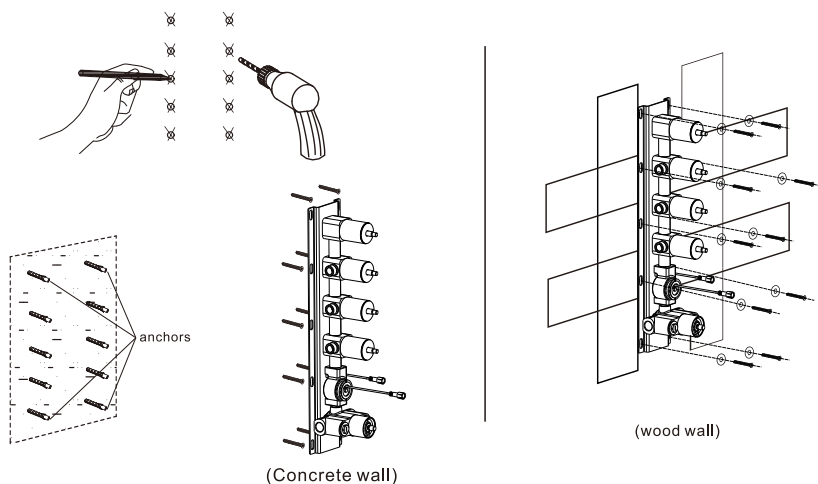

1. Make marks according to the size of the main body valve and then drill anchors into the wall (concrete wall)
2. Lock main body to wall directly with screws (wood wall)
3. When you install the main body, please mark the UP side up, and do not install it upside down.

▲ Please note that the level meter should be parallel with the wall, otherwise the deck plate cannot be installed.

Step2

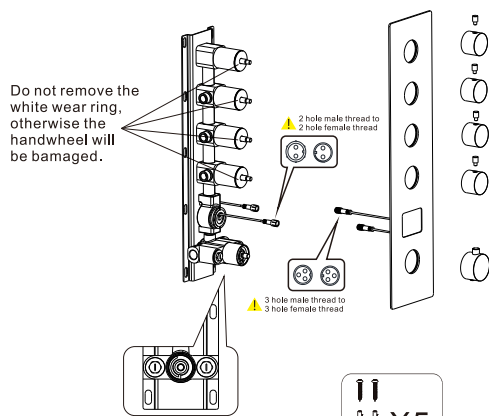

Water flow control: clockwise turn-down and stop, anti-clockwise turn-up and max

Precautions for handwheel installation

※ 1: The line can't misplace, it should be kept in a line, otherwise the water temperature of 100°F or 38°C will not be correct.

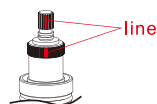

※ 2: Please ensure that A Plastic locating ring and B handwheel locating pin kept in the same line with 100°F or 38°C. Otherwise, the water temperature will be wrong.

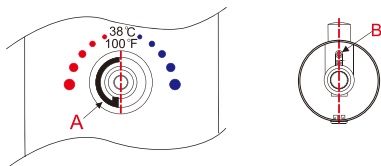

1. Please install deck plate, water diverters and water diverter rods step by step.
2. Install the handle with the screw and handle cap.

◆ Lifting Rod Installation

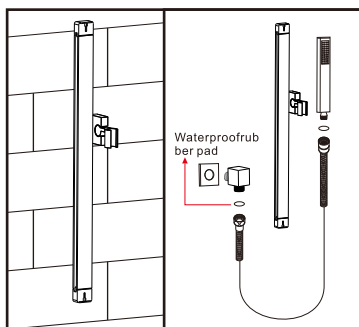
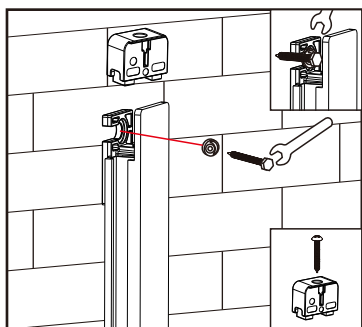
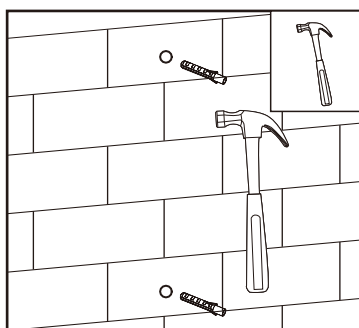
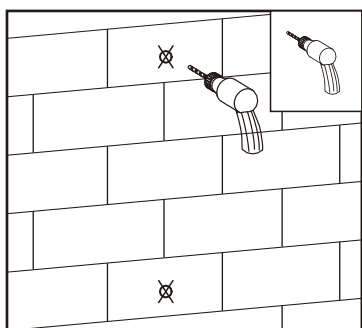
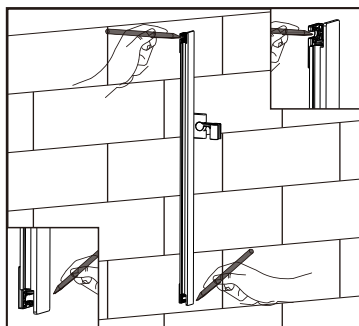
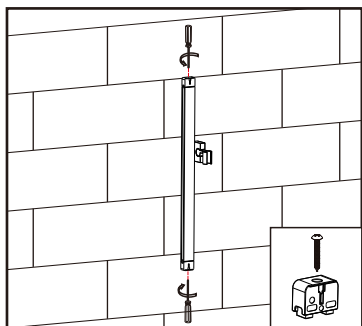

1. Remove the upper and lower screws of the sliding rod firstly.
2. Mark the size of the turning hole with a pen.
3. Hammer in the rubber particles with a hammer.
4. Use a screwdriver to install the product after twisting the screws with a wrench, .
5. Complete the installation

◆ Body jets Insrallation (Model:A&B&C)

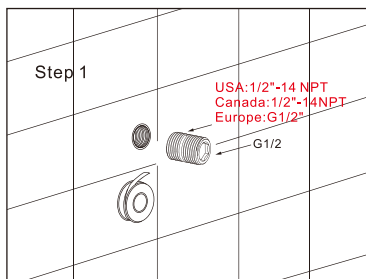

Step 2

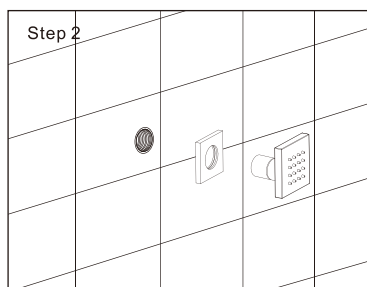
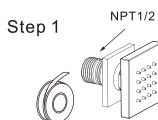
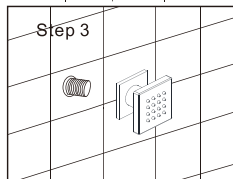
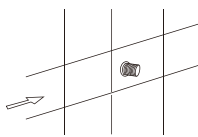

Step 1.Wrap the threaded pipe of NPT1/2 with Teflon tape and screw it into the wall.

Step 2.Cut off excesspart with a saw.

Step 3.Screw the massage body jet onto the wall.

 The opening size of ceramic tile shall be smaller than the decorative cup of boby jet size,otherwise it will not be installed

◆ Plumbing Layout of Shower Head

①

USA 1/2"-14NPT
Canada: 1/2NPT
Europe: G1/2"

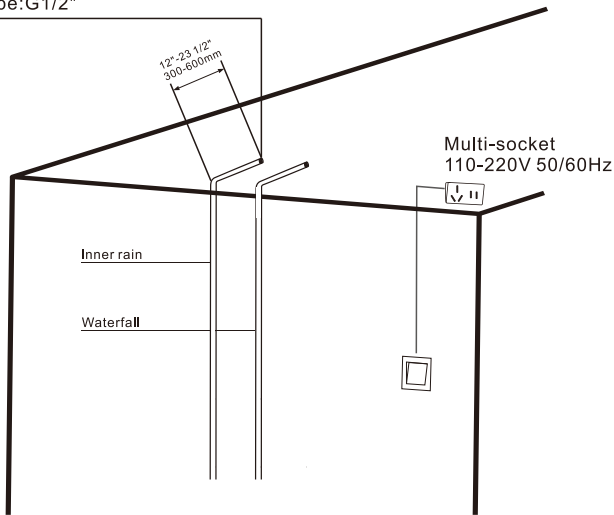

Install the power switch in the appropriate position, lay out water pipeline and connect it to the main body

◆ Holes on Ceiling

②

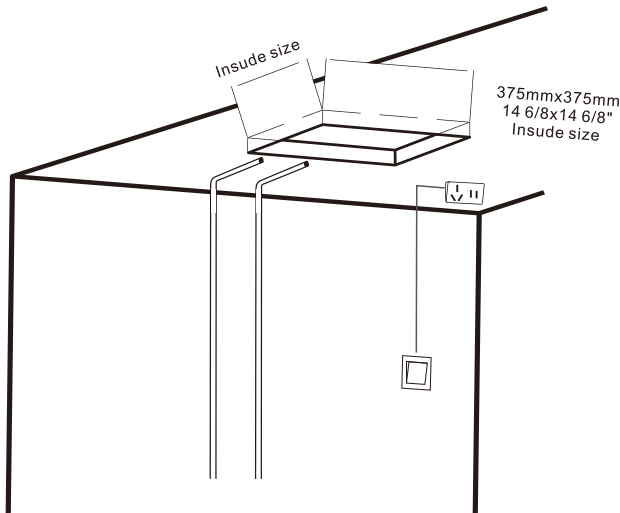

◆ Shower Head Exploded View

③

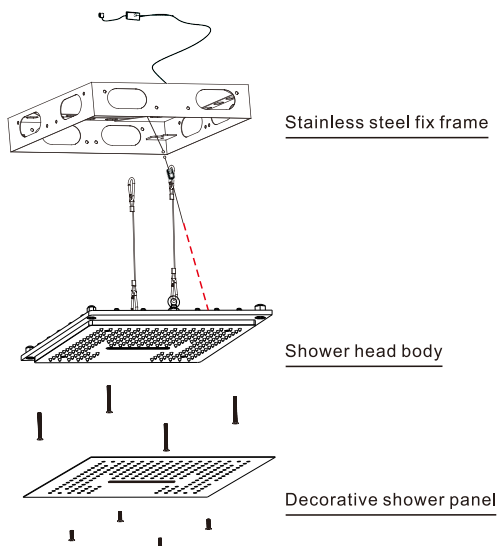

According to the mark (Remove Install) on the top of shower head panel, respectively unscrew the decorative shower panel, shower head body and fix frame.

◆ Fix Frame Insrallation

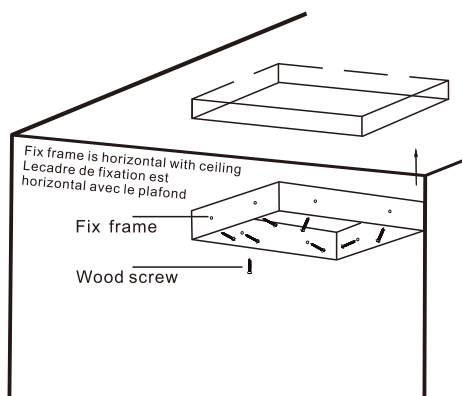

Fasten the fix frame to the wooden feame with screws.

◆ Layout for power

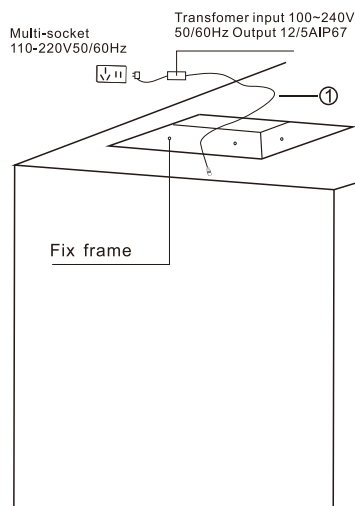

◆ LED (Single Line) Connection

⑥

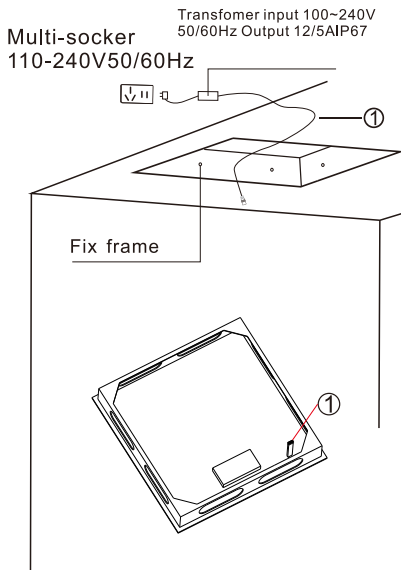

- ① to ①wifi controuler wrap it with adhesive tape to prevent it from falling off.
- ② to②connect the Power supply and WiFi.

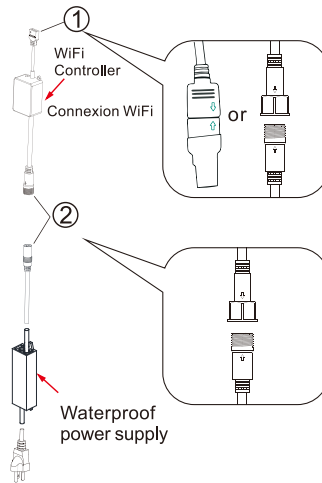

◆ Shower Head Body Installation

⑦

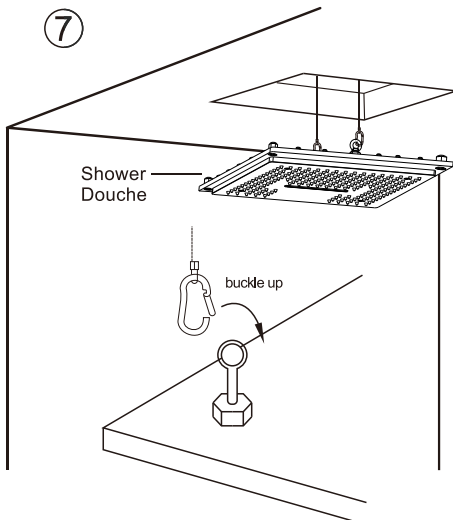

◆ Layout for Water Pipe

⑧

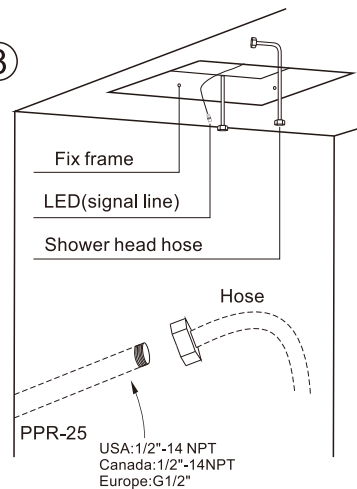

Connect one end of the corrugated pipe to the embedded PPR water pipe and the other end to the water inlet pipe on the back of shower head.

◆ Water Inlet Pipe Connection

⑨

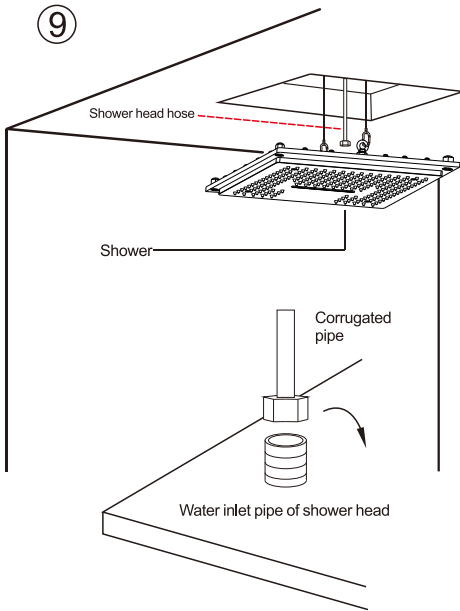

◆ Water Testing

⑩

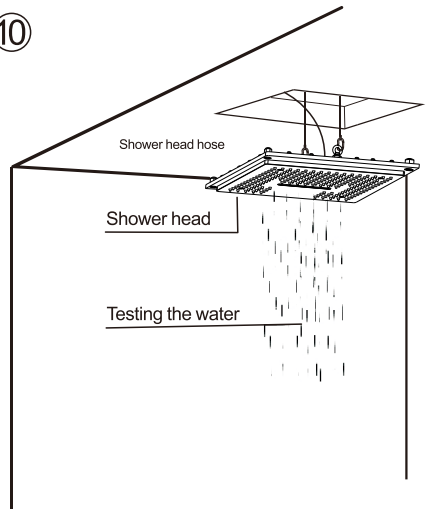

◆ Shower Head Installation

⑪

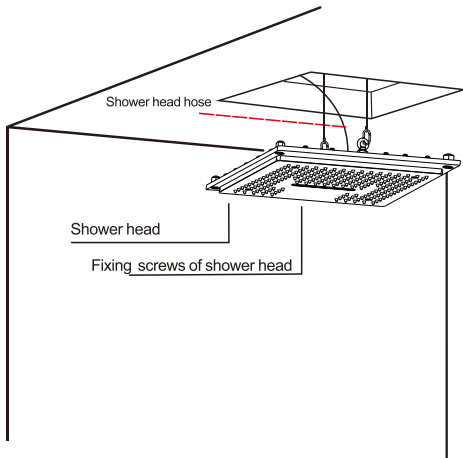

◆ Decorative Shower panel Installation

⑫

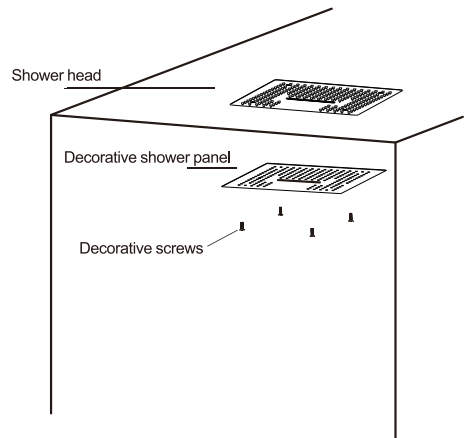

◆ LED Touch Remote Instruction

Main parameter:

Panel controller:

Working Temp.: -20~60°C

Supply Voltage: DC12-24V

Size: L50*W35*H23mm

1 15/16" * 1 6/16" * 14/16"

Output: 3 channels

Output Current: <2A (each channel)

Connection mode: common anode

Touch Remote:

Working voltage: 1.5V * 3V

Emission current: 10mA

Working Current: 300uA

Standby Current: 3uA

Standby time: 6 months

Control Distance: 20M

Color pulley point: 60



Touch remote has 9 touch keys, with each functioning as follows:

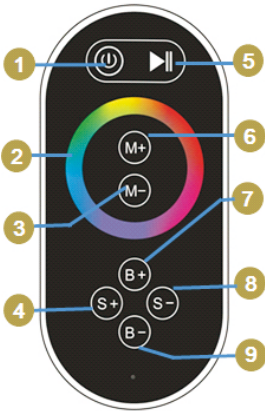

- ① Turn ON/OFF
- ⑤ Mode Switch
- ② Color Touch Ring
- ③/⑥ Color Temperature adjusting
- ④/⑧ Dynamic Speed adjusting
- ⑦/⑨ Dynamic Brightness adjusting

Mode:

NO.	FUNCTION	REMOTE
1	Static red	Brightness is adjustable Speed is unadjustable
2	Static green	
3	Static blue	
4	Static purple	
5	Static blue-green	
6	Static yellow	
7	Static white	
8	R G B Jumping	Brightness is adjustable Speed is adjustable
9	R G B Gradual	
10	7-Colors Jumping	
11	7-Colors Gradual	

2.Power supply management:

The remote will enter the standby state (untouchable state) when pressed for more than 20s. If it happens, please slightly shake it once and then the remote will come back to the normal working state (touchable state).

3.Indicator light instrction:

3.1. The remote is idle or sending signal when the PWR is bright; when the PWR is off, it will enter the standby state.

3.2. When RF is bright, it means the remote is sending signal; off means there is no signal sending.

Controller connections shown:

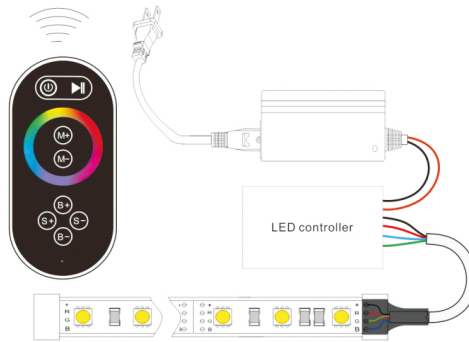

Remarks:

- 1.This product should be commissioned and installed by qualified personnel.
- 2.This product can not be waterproof, need to avoid sun and rain, if installed outdoors, please use waterproof box.
- 3.Good heat dissipation conditions will extend the life of the LED controller, please install the product in a well-ventilated environment.
- 4.Please do not install or use such products in lightning, thunder, strong magnetic or high voltage applications.
- 5.Please check whether the output voltage of the LED power supply used meets the product voltage range requirements.
- 6.The diameter of the wire used must be sufficient to load the connected LED luminaire, and ensure that the wiring is firm, to avoid the wire overheating or poor contact triggers the accident.
- 7.Before power-on debugging, ensure that all wiring is correct to avoid damage to the luminaire due to wiring errors.

◆ CARE AND MAINTENANCE

In order to keep the mixer surface bright , please clean the mixer regularly.

Rinse faucet with clean water and wipe with soft cotton cloth.

Avoid suing cleaning powder , harsh cleaning chemicals, brushes, and cloth with coarse surface to prevent scratching and corrosion.

Do not use acid cleaner to clean the faucet as it may cause surface corrosion of the faucet. If the faucet comes into contact with harmful acid substances, please rinse it with water immediately.

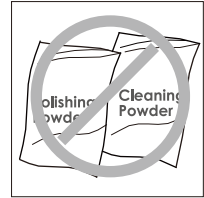

◆ IF A LARGE-SCALE CLEAN-UP IS NECESSARY, FOLLOW THESE PROCEDURES

1: Use clean water and soft cloth to remove dirt on the surface as much as possible.

2: Use one of the following cleaners to remove dirt on the surface

Mild liquid cleaner.

Colorless glass cleaner, powder cleaner which does not have abrasive function and can be dissolved completely.

Polish liquid which does not have abrasive function.

3: After cleaning, remove the cleansing agent with clean water completely and wipe with soft cotton cloth.