

Installation Manual

Step 1



Let your panels acclimate for 48 hours

Step 2



Clean your wall, make it dry and free from grease & dust

Step 3



Cover your floor with a masking film or masking paper

Step 4



Measure and make a mark for your starting point

Step 5



Apply adhesive to all 4 sides of the back of your panel

Step 6

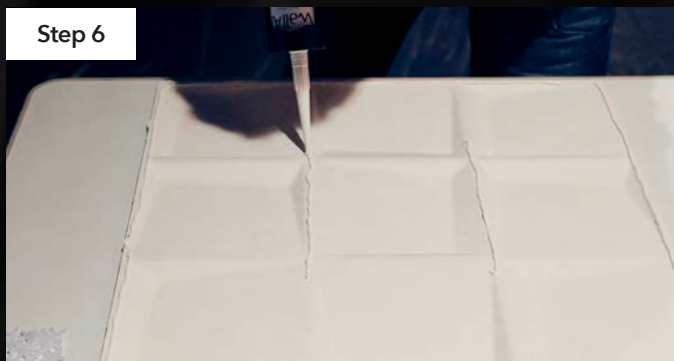

Apply 2 more vertical lines of adhesive where possible



Watch our installation video: www.mywallart.com/installation

Step 7



Install and apply equal pressure by using your fingertips

Step 8



Use a tile spacer to position each next panel

Step 9



Remove the tile spacer when surrounded by panels

Step 10



After each panel installed clean the joints using strong paper towel

Step 11



Spray or roll paint your wall (pay extra attention to the joints)

Step 12



After 24 hours apply a second layer of paint to your wall

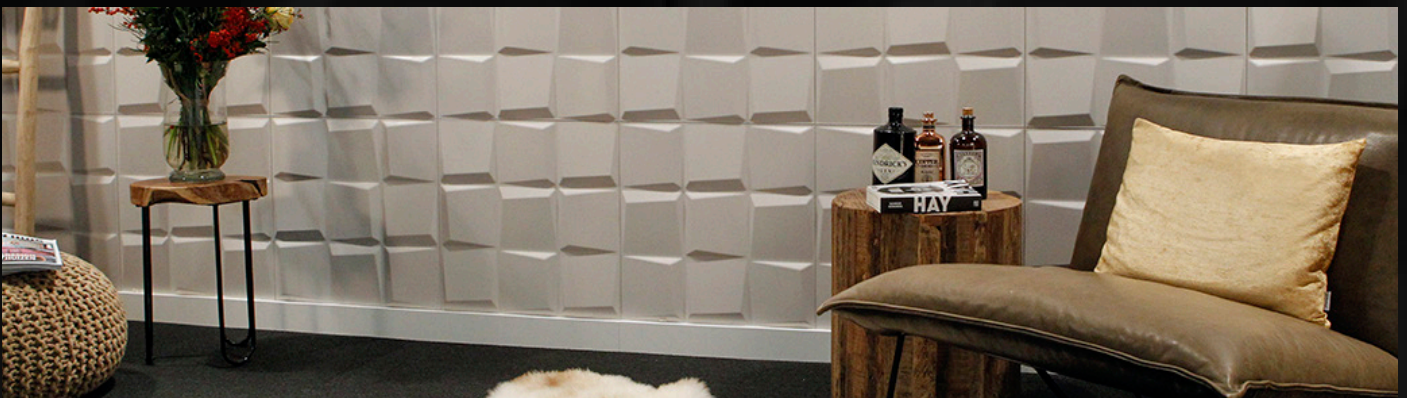

Watch our installation video: www.mywallart.com/installation