

INSTALLATION INSTRUCTIONS

Clevr Shower Seat Model No. **CRS501102**

Maximum Weight Capacity 400lbs

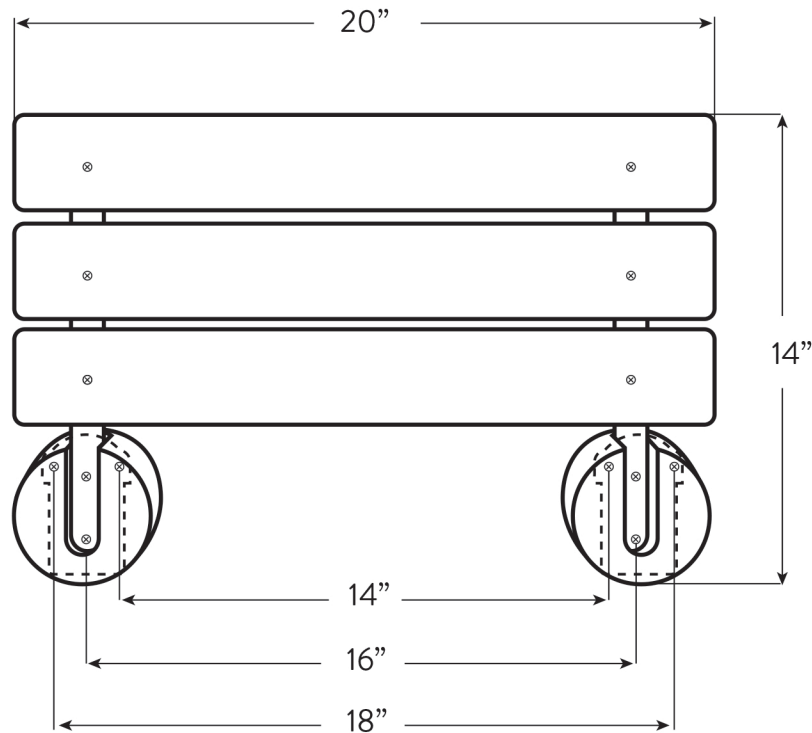

Parts:

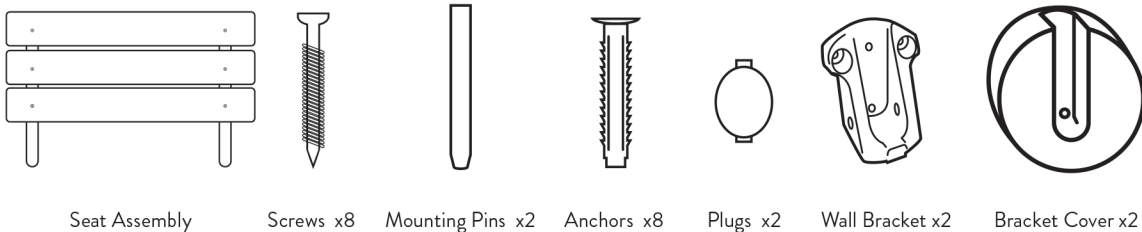

Tools required:

Electric drill, 5/16 masonry drill bit and/or 7/32 masonry drill bit (if installing directly to studs), level, and measuring tape. To uninstall, a #8-32 bolt (5/16" screw) is needed to remove mounting pins (by screwing in and pulling).

WARNING:

PLEASE READ ALL INSTRUCTIONS BEFORE USING

Installing the seat is not difficult but will require some experience in light framing, drilling and in some cases experience with installing ceramic tile. We recommend installation by a qualified contractor/tradesperson.

OUR SHOWER SEAT ARE STRONG ONLY AFTER CORRECT INSTALLATION BY PROFESSIONALS.

Under no circumstances should any shower seat be mounted to Drywall, sheetrock, plaster, fiberglass, acrylic or other similar "Hollow" wall surfaces without appropriate wood or steel backing.

Step 1

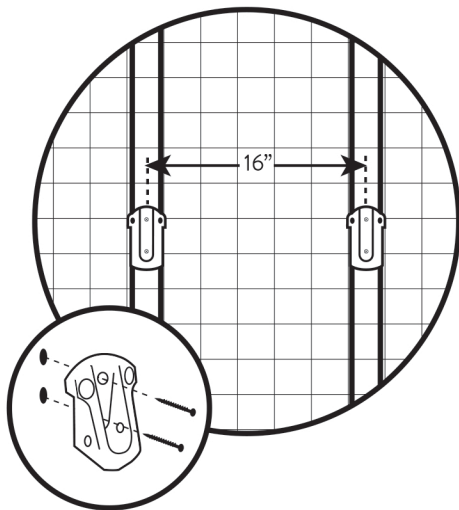

1. Stud Mounting (wood mounting)

Measure 16" apart from center holes, use template provided, use (4) screws provided for this installation. Screws should penetrate into the studs a minimum of 1.5". Use a 7/32" masonry drill bit to drill through the tile for screw clearance, careful not to drill stud.

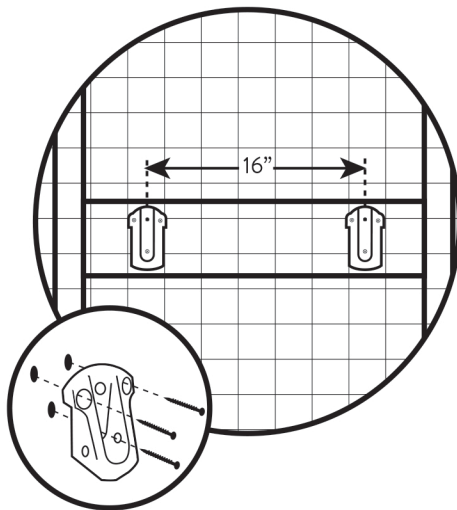

2. Wood Noggins (mounting wood)

For wood noggins, measure 16" apart from center holes (use template provided). Use (6) screws provided for this installation. Screws should penetrate into the beam a minimum of 1.5". Use a 7/32" masonry drill bit to drill through the tile for screw clearance, careful not to drill stud.

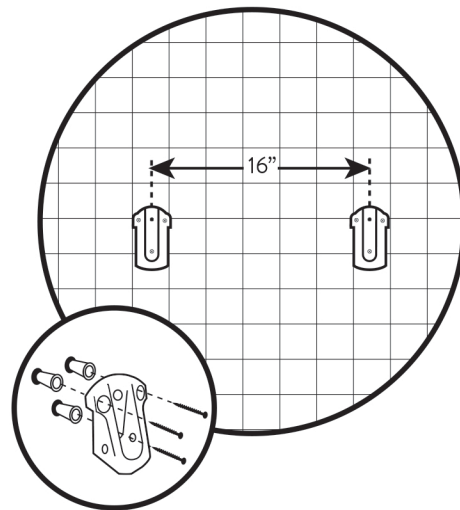

3. Mounting (Masonry, brick or block wall)

For solid brick or concrete walls, 16" on center (use template provided) use (6) screws provided for this installation. Screws should penetrate into the studs a minimum of 1.5". Use a 5/16" masonry drill bit to drill a hole deep enough to install the anchors.

Step 2

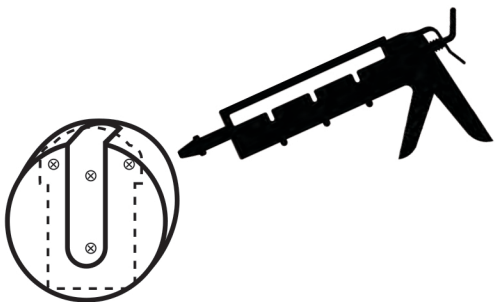

After wall brackets have been secured, place *bracket covers* over the wall brackets with the pin holes facing inward. While it is not required, we recommend caulking around the covers to prevent water from seeping in and eventually corroding brackets.

Step 3

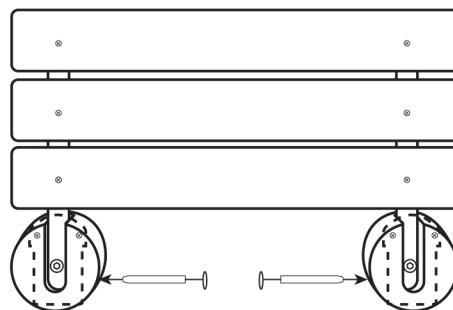

Secure seat assembly in place with the mounting pins. After assembly is complete fit *plugs* into pin holes of the *bracket covers*.

Cleaning & Wood Care:

- Clean the seat with a warm damp cloth, mild detergent (Does not contain acid) only when needed.
- Apply caulking around the covers to prevent rusting or corroding the mounting brackets is strongly recommended.

Customer Service Phone Number: (626)-965-2600

Monday - Friday 9am-5pm PST