

Note: Handlesets fit doors 1-3/4" to 2" thick.

A

USE INCLUDED DOOR PREPARATION TEMPLATE FOR NON-PREPARED DOORS.

USE INCLUDED PLASTIC TEMPLATE TO LOCATE AND DRILL THE 1/4" BOTTOM GRIP MOUNTING HOLE. (See note on reverse side.)

B

Install deadbolt and handleset latches.

Deadbolt Tongue (Part #1A) (See D Below Before Deadbolt Latch Installation)
Deadbolt Latch (Part #1)
Deadbolt Faceplate (Part #14)
3/4" Latch & Strike Wood Screws (Part #2)
Edge Bore Holes
Post Holes
Handleset Latch (Part #13)
Latch Tongue (Part #13A)
3/4" Latch & Strike Wood Screws (Part #2)
Latch Faceplate (Part #14)
Door-Inside

C Latch tongue note

Bevel side of latch tongue should contact curved side of face plate, and curved side of strike plate.

Bevel Side
Face Plate Curve
Strike Plate Curve

D Deadbolt latch tongue note

Deadbolt Tongue must be EXTENDED during installation.

E Install cylinder into plate

Door-Outside
Cylinder Assembly (part #3)
Tailpiece must be VERTICAL during installation.
Spin Ring (part #3C)
Plate (part #4)

F Place cylinder assembly with plate on door exterior.

Attach deadbolt adaptor plate with provided screws.

Deadbolt Adaptor Plate (part #5)
2-3/8" Machine Screws (part #6)
Cylinder Assembly (part #3)
Door Inside

G Attach thumbturn assembly with provided screws.

Thumbturn Assembly (part #7)
5/8" machine screws (part #8)
Door-Inside

H Insert handleset spindle

IMPORTANT: SEE SPINDLE ORIENTATION NOTE IN NEXT PANEL.

1 Insert handleset spindle silver end first, in "diamond" orientation.
2 Push button and hold during insertion
Door-Outside

I Spindle orientation note

silver
gold
DIAMOND ORIENTATION
SQUARE ORIENTATION

Silver end of spindle must be in "Diamond" orientation while initially inserting into latch.

Once silver end of spindle is inserted, the gold end should be rotated to "Square" orientation before the spindle is completely inserted.

J

Install exterior handleset on door exterior.

MAKE SURE GOLD END OF SPINDLE IS IN "SQUARE" ORIENTATION. (see previous panel)

Cylinder and Plate (part #s 3 & 4)
Handleset (part #16)
Door-Outside

K

Install long plate with lever on door inside.

Insert bottom grip mounting screw.

1" Oval Head Wood Screws*
Lever (part #19)
1" Oval Head Wood Screws*
Long Plate (part #17)
Bottom Grip Mounting Screw (part #21)
Mounting Screw Cover (part #22)
Screw Cover Adapter (part #20)
Door-Inside
Door-Outside

L Install jamb strikeplate.

Dust Box (Part #9)
Door Frame Reinforcer (Part #10)
Strike Plate (Part #12)
3" Wood Screws (Part #11)
3/4" Latch & Strike Wood Screw (Part #2)
Door Jamb

Exploded Drawing Single Cylinder Handleset Long Plate With Pre-Attached Lever

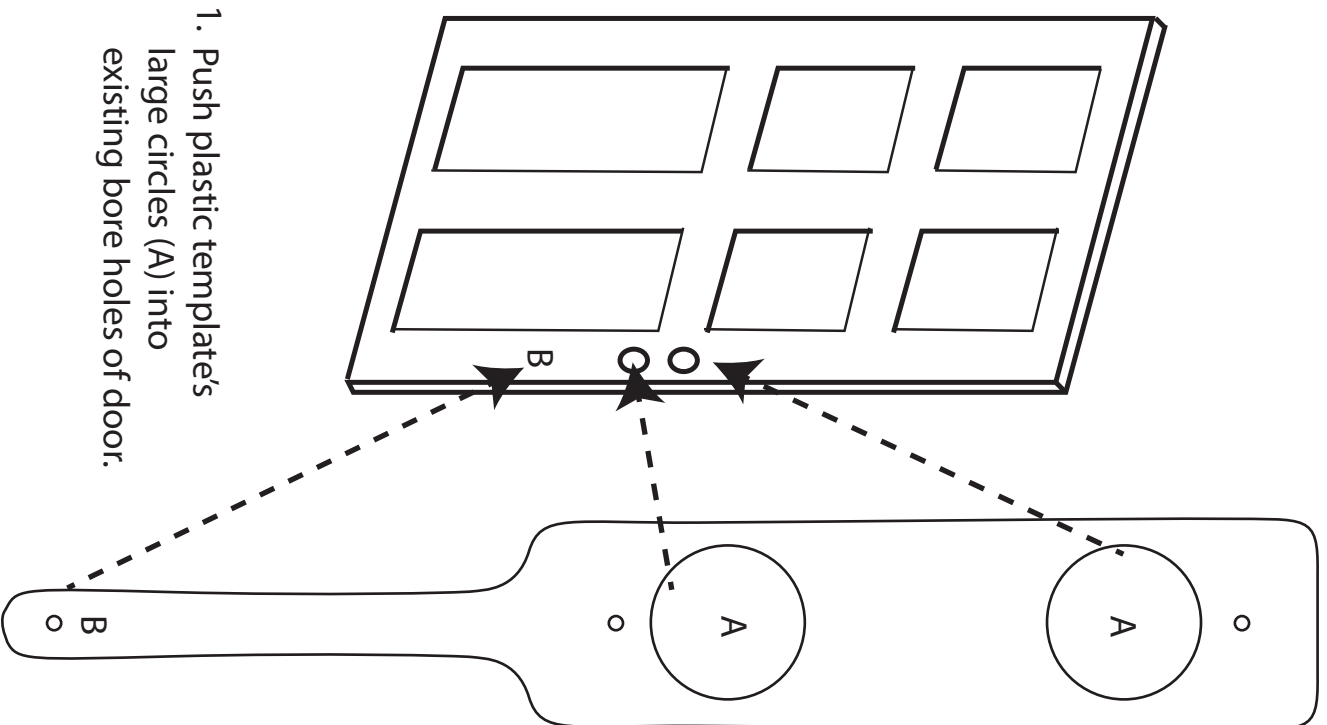

1. Push plastic templates' large circles (A) into existing bore holes of door.
2. Use position of bottom hole (B) to mark and drill 1/4 inch bottom grip mounting hole.

Part Number	Part Description
1.	Deadbolt Latch
1A.	Latch Tongue
2.	3/4" Faceplate & Strike Wood Screws (8)
3.	Cylinder Assembly (W/Keys)
3A.	Cylinder Body
3B.	Tailpiece
3C.	Spin Ring
4.	Plate
5.	Deadbolt Adapter Plate
6.	2-3/8" Machine Screws (2) for 1-3/4" thick doors. 2-1/4" Machine Screws (2) for 2" thick doors.
7.	Thumbturn Assembly
8.	5/8" Thumbturn Machine Screws (2)
9.	Dustbox for Deadbolt
10.	Door Frame Reinforcer
11.	3" Reinforcer Wood Screws (2)
12.	Strike Plate for Deadbolt
13.	Handleset Latch
13A.	Latch Tongue
14.	Latch Faceplate
15.	Handleset Spindle
16.	Exterior Handleset
17.	Long Plate
18.	1" Oval Head Wood Screws (4)
19.	Lever
20.	Screw Cover Adapter
21.	2-1/2" Bottom Grip Mounting Screw for 1-3/4" thick doors. 2-3/4" for 2" thick doors.
22.	Mounting Screw Cover
23.	Dustbox for Handleset
24.	Strike Plate for Handleset

