

SIDE TABLE SERIES

brixton tray table

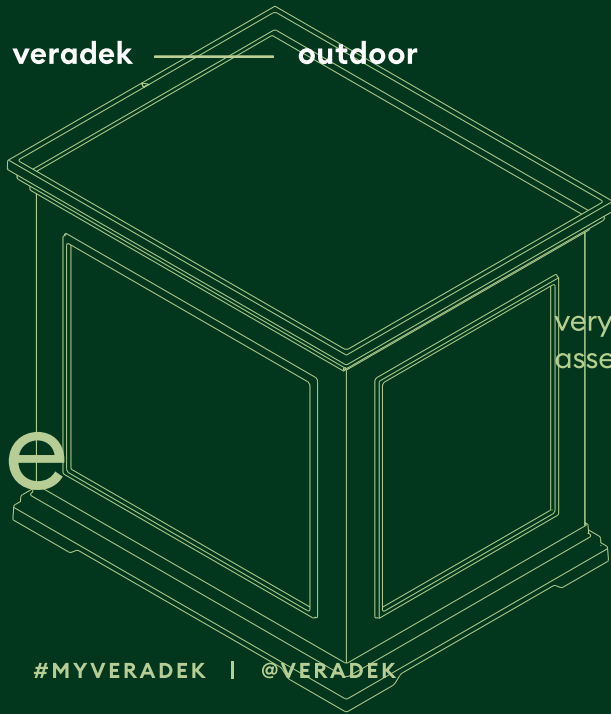

very easy, very fun
assembly instructions

#MYVERADEK | @VERADEK

let's put it together

(you're basically already done)

gather your parts, there should be six

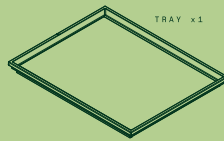
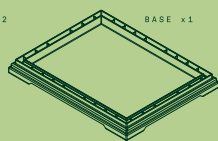
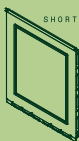
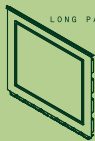

you will need a mallet

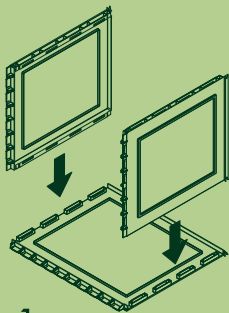
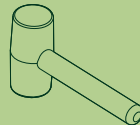

1

Click the short panels into the long panel by aligning the notches with the tabs.

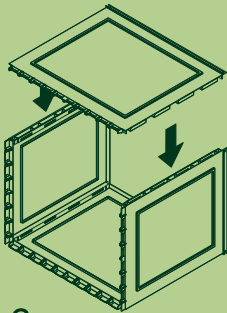

2

Repeat with second long panel, making a box.

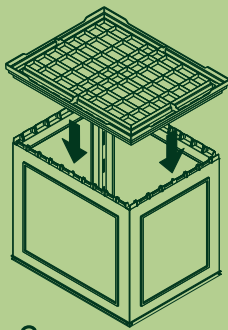

3

Flip the assembled body upright, tabs facing up. Then place the base, notches facing down, covering the opening.

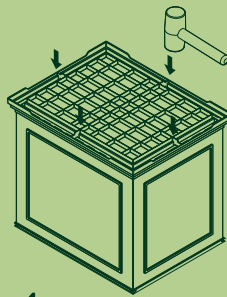

4

Secure the base onto the body by gently tapping it into place with a mallet.

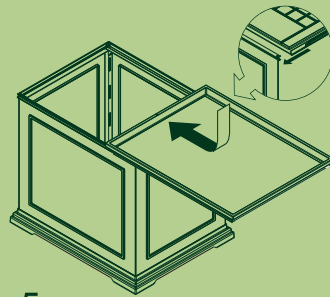

5

To attach the tray, rest the first few inches on top of the body, facing the arrow towards the opening. Then smoothly slide the tray forward until the opening is completely closed.