

# BUTLER

## SPECIALTY COMPANY

8200 S. SOUTH CHICAGO AVE. CHICAGO, IL 60617

## Assembly Instructions

Style Number 1225274 - 1225277

### PACKAGED

- (A) 1- Top
- (B) 3- Legs
- (C) 1- Base
- (D) 3- Feet
- (E) 1- Bottom Shelf
- (F) 1- Middle Shelf
- (G) 1- Top Shelf

### HARDWARE INCLUDED

- (1) 6-Flat Washer
- (2) 6-Lock Washer
- (3) 3-Short Bolt
- (4) 3-Small Bolt
- (5) 1-Allen key
- (6) 9-Shelf Clip
- (7) 9-Wood Screw

### Read all instructions before starting assembly:

- Remove all contents from the package checking that all of the components listed in the "Packaged" are included. Prepare a flat protected work surface where the product can be assembled.

**Step #1 - Attach the three [3] Feet (D) to the Base (C) and bottom of Legs (B) by using Flat Washer (1), Lock Washer (2), Short Bolt (3) with Allen Key (5) tighten.**

**Step #2 - Turn the base with legs and feet upright. Insert Shelf Clip (6) into the holes of the Legs (B). Then place the three [3] Shelves with (E) first, (F) and then (G) onto the shelf clips.**

**Step #3 - Place Top (A) onto the top of Legs (B), insert Flat Washer (1), Lock Washer (2), Small Bolt (4) and by using Allen Key (5) tighten.**

**Step #4 - Secure the shelf clips with Wood Screws (7) by using a Phillips-head screwdriver (Not Provided).**

**In any correspondence regarding this product, please include the complete Butler identification number located on the backside of this product.**

### STEP 1

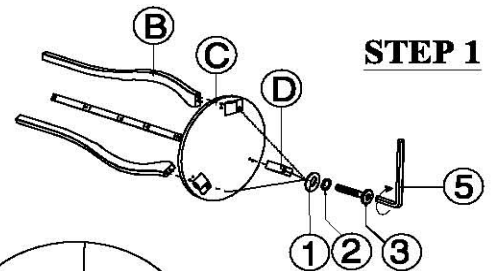

### STEP 2

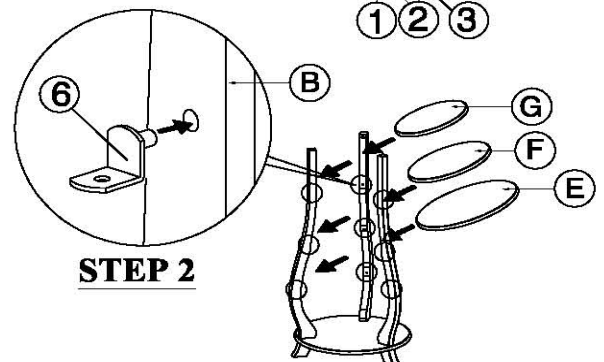

### STEP 3

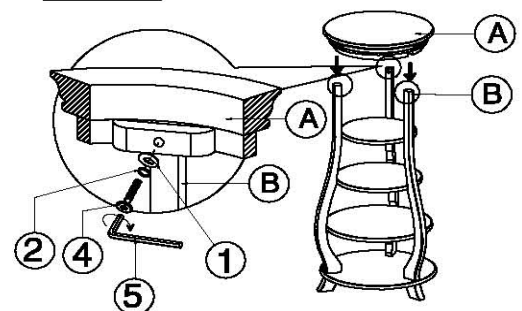

### STEP 4

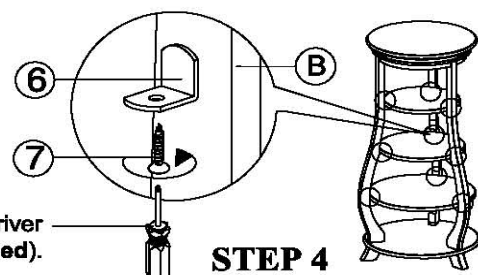

Phillips - head screwdriver  
(not provided).

*We hope this product will be a useful and decorative addition to your home for years to come.*

**Copyright © Butler Specialty Company**