

Assembly Instructions For **VS29001, VS29002, VS29003, VS29004**

(E) 5/2012

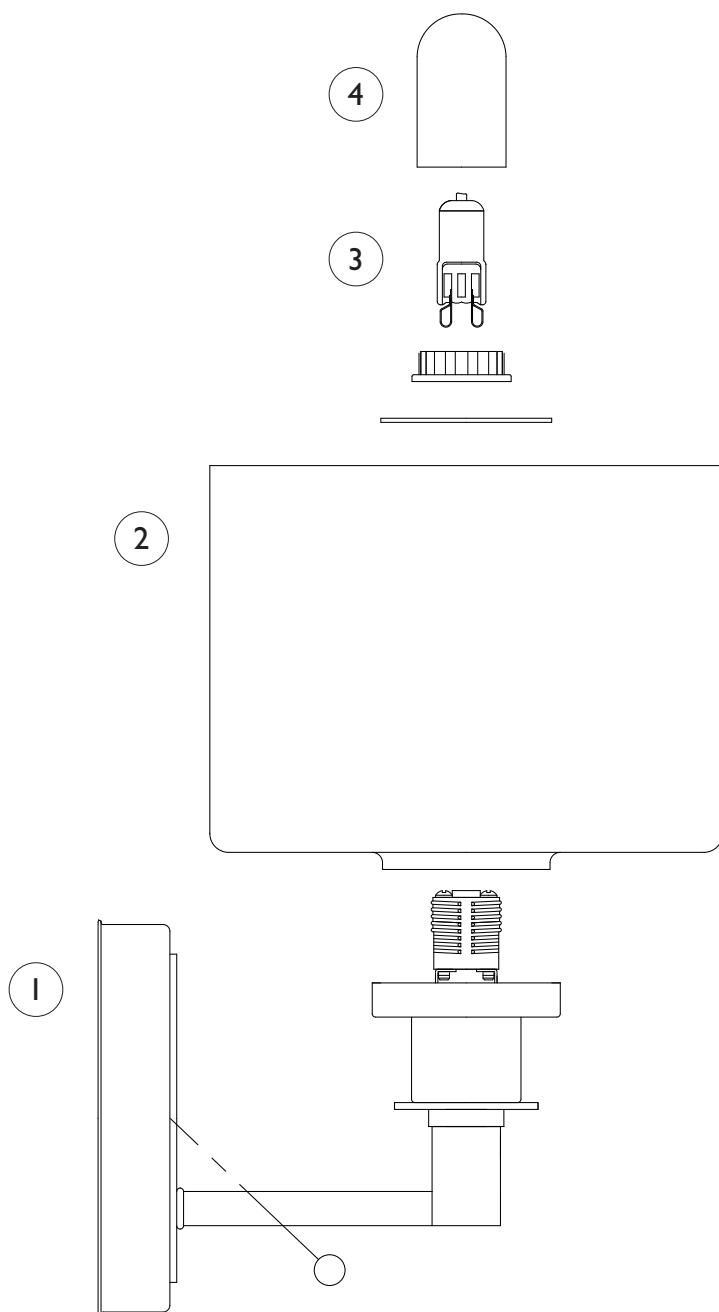

**IMPORTANT:
TURN OFF THE POWER AT THE MAIN FUSE
OR CIRCUIT BREAKER BOX
BEFORE STARTING INSTALLATION.**

**INSTALL THIS FIXTURE IN THE UP
POSITION ONLY.**

Carefully unpack and identify all parts
before assembly.

1. Follow enclosed supplement installation instructions for electrical and fixture installation onto house outlet box. If you do not have an outlet box at desired location to attach the fixture then hire a qualified electrician to create one.
2. Install shade by fastening with counter ring and washer.
3. Install halogen lamp (included). See relamping label at socket area for type and maximum allowed wattage.
lamp.
4. Install the lamp cover onto the halogen

FEISS®

EST. 1955