

# ASSEMBLY INSTRUCTION

Item#: 1610-10458-EGLO Mirrored Writing Desk

**\* Please make sure you have all parts indicated below prior to assembly.**  
**This unit is heavy and can best be assembled with the help of two or more persons.**

HARDWARE LIST			
No	Item	Description	Q'ty
A		FLAT WASHER	8
B		LOCK WASHER	8
C		BOLT 5/16*50mm	8
D		ALLEN WRENCH	1

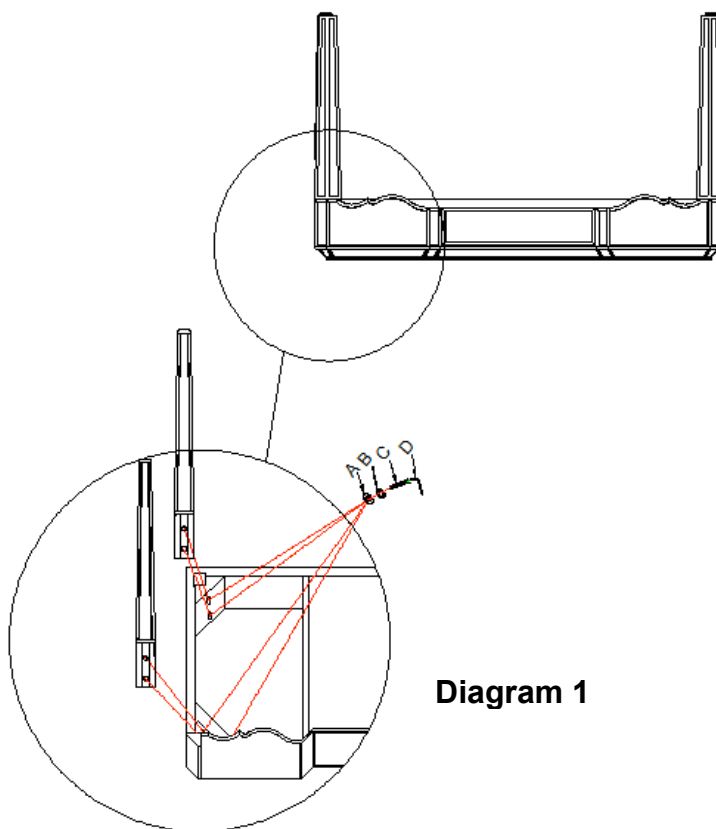
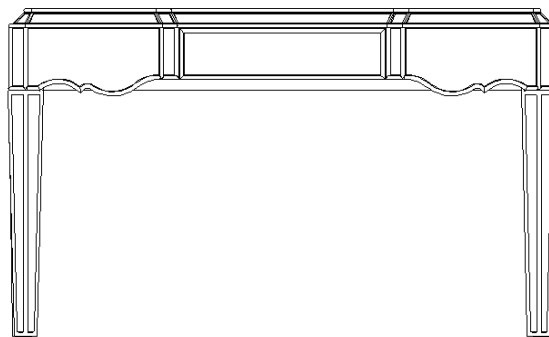

**Diagram 1**

## Assembly Steps:

1. Place the desk top upside down on a soft surface to prevent it from scratching.
2. Attach one leg as labeled to top by using bolt (C), lock washer (B) and flat washer (A). Tighten them securely with allen wrench (D). (See diagram 1)
3. Repeat step 2 to install the rest of three legs.
4. Turn table upright.

**Cleaning Instruction:** Clean finished parts with a damp cloth using a mild dishwashing liquid and water solution.  
Polish the finish with soft cloth and an industry recognized furniture polish.