

## Tools Needed:

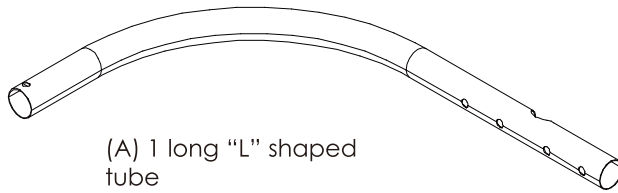

(A) 1 long "L" shaped tube

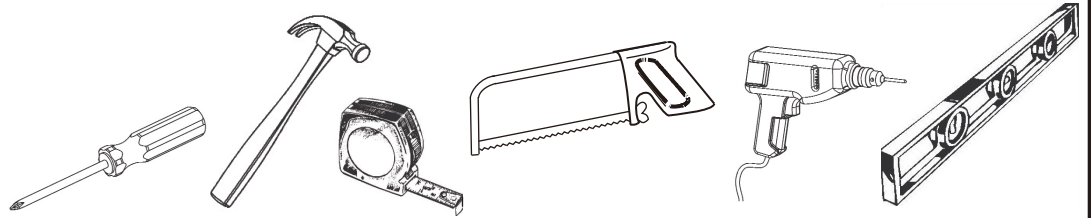
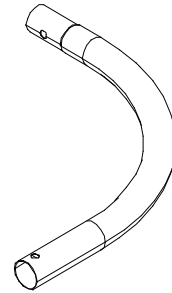

(B) 1 short "L" shaped tube

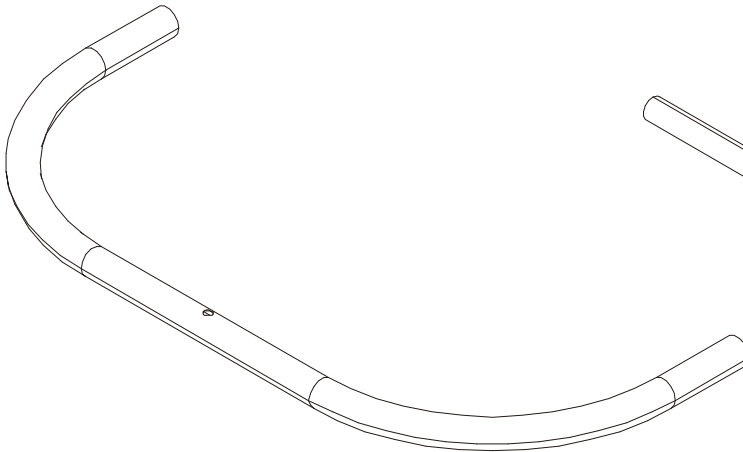

(C) 1 "U" shaped tube

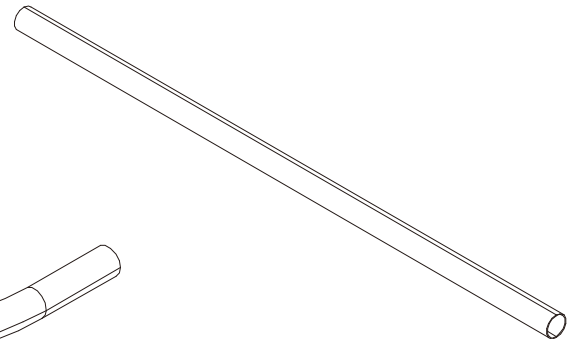

(D) 1 long straight tube

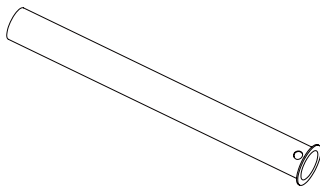

(E) 1 short tube with hole

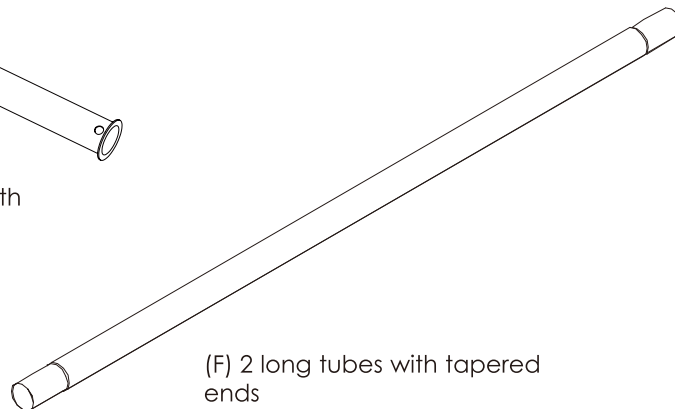

(F) 2 long tubes with tapered ends

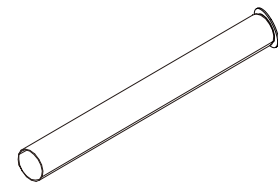

(G) 2 flared tubes

Thank you for purchasing Utopia Alley Products. Please contact us if you have difficulty with assembly or need replacement parts. Utopia Alley customer service is here to assist you.

**Email: [CustomerService@utopiaalley.com](mailto:CustomerService@utopiaalley.com)**

Please attach your name and Order ID so that we can assist you better .

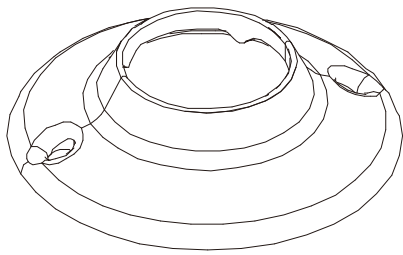

(H) 2 open metal flanges

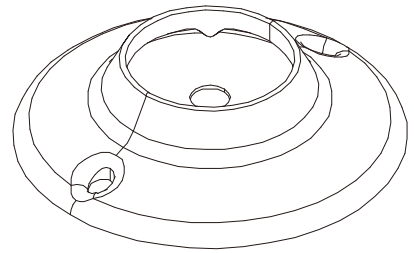

(I) 1 closed metal flange

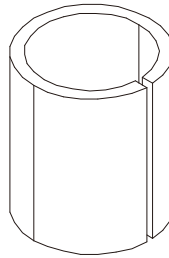

(K) 1 rubber pipe stabilizer

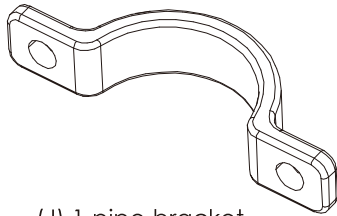

(J) 1 pipe bracket

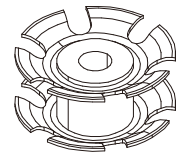

(L) 2 metal inserts

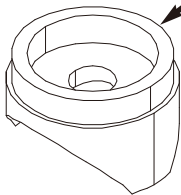

(M) 2 1 in. nylon insert

**NOTE:** For parts M & N, 1 in. and 7/8 in. refers to the diameter of the circular end that will fit inside tubes (D,G)

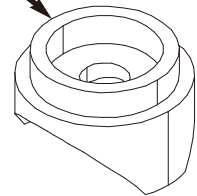

(N) 1 7/8 in. nylon insert

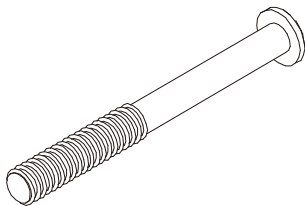

(O) 3 large screws

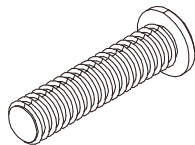

(P) 3 medium screws



(Q) 4 small screws

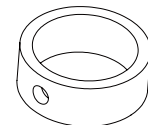

(R) 1 vertical support collar



(S) 6 mounting screws

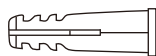

(T) 6 wall anchors



(U) 1 set screw

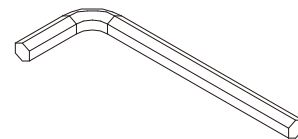

(V) 1 allen wrench for use with set screw (U)

## Mounting Instructions

1. Wrap rubber pipe stabilizer (K) around the showerhead pipe approximately 80 in. from the floor (or at the desired height for your shower curtain), as shown.

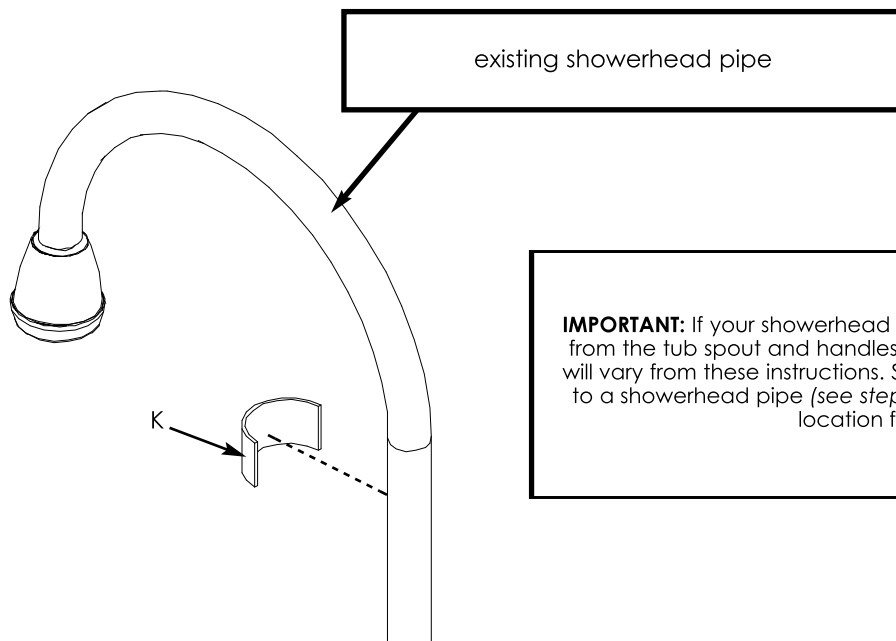

**IMPORTANT:** If your showerhead pipe comes out of the wall instead of up from the tub spout and handles (see photo on page 1), your installation will vary from these instructions. Since the shower rod will not be fastened to a showerhead pipe (see step 2), you will have to determine the best location for the shower rod.

2. Fasten pipe bracket (J) to long "L" shaped tube (A) around the shower-head pipe and rubber pipe stabilizer (K). Secure with medium screws (P).

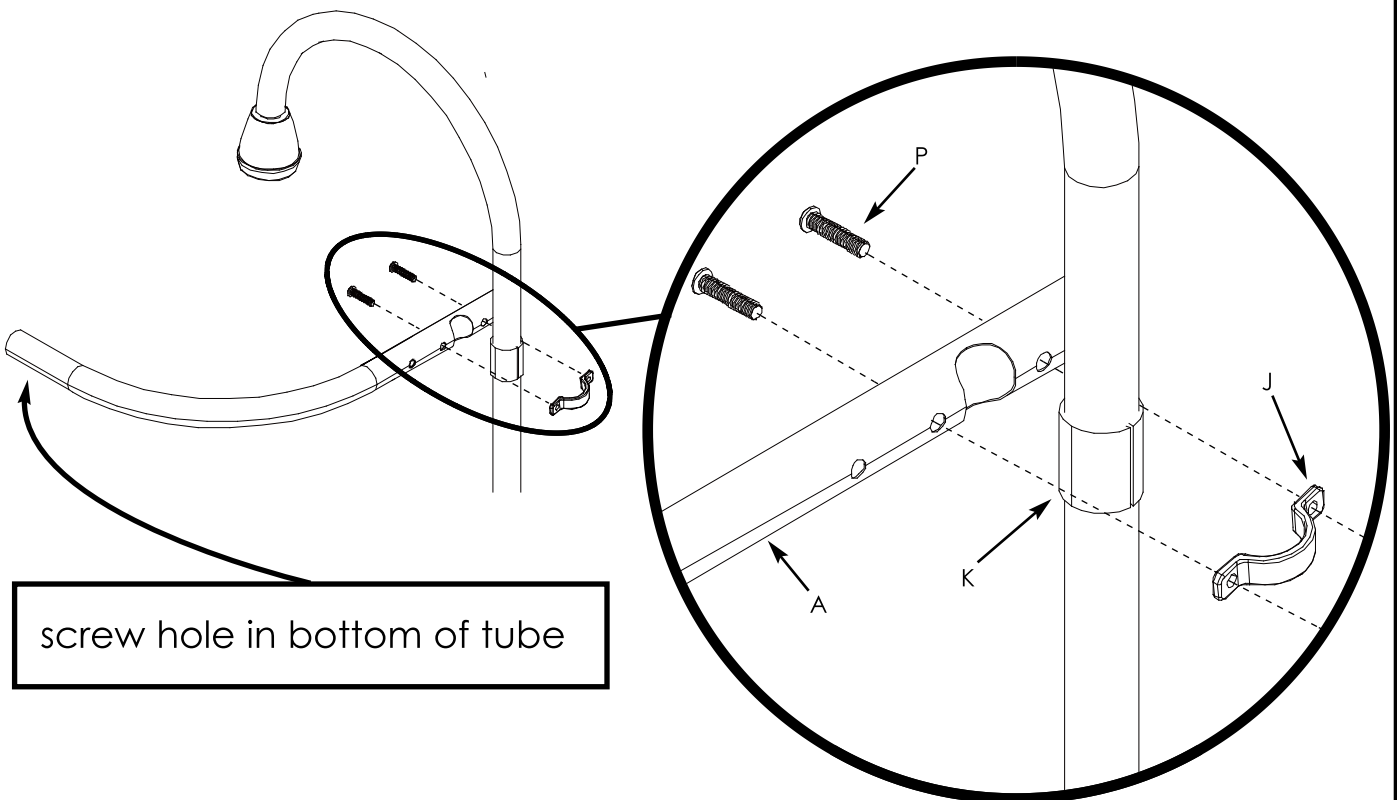

3. Measure distance from long "L" shaped tube (A) to wall.

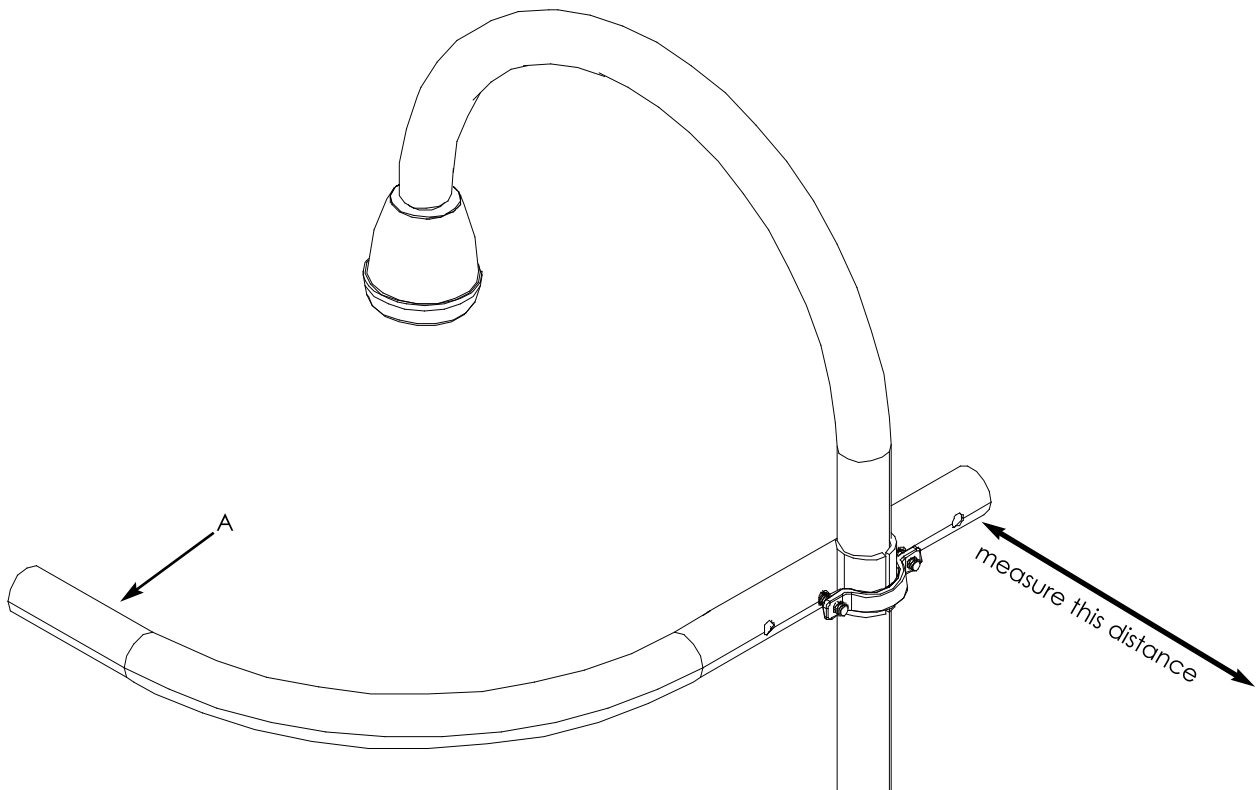

4. Subtract 1/8 in. from the measurement in step 3. Measuring from the **flared-end** of the tube, mark this measurement on flared tubes (G). Using a hacksaw, cut flared tubes (G) at the mark.

**NOTE:** Before you cut, make sure you measured from the **flared-end** of the tube.

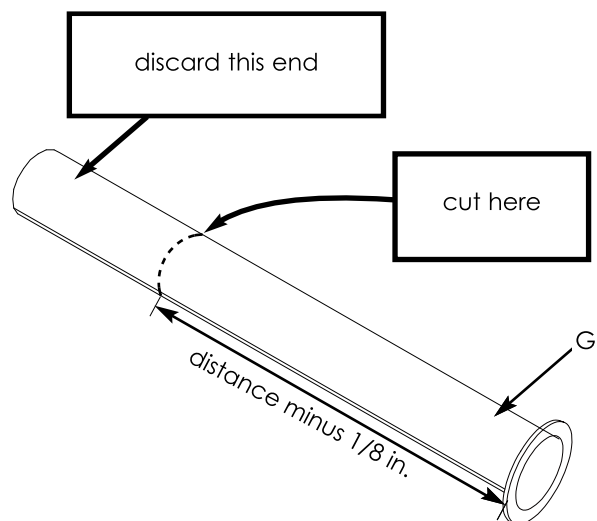

**IMPORTANT:**

Be sure to **subtract 1/8 in.** to the measurement from step 3. Before you cut, make sure you measured from the **flared-end** of the tube.

5. Screw a large screw (O) into one of the metal inserts (L). **NOTE:** Be sure flares are pointing toward the head of the bolt. Continue to screw the large screw in until it begins to come out the other end of metal insert (L).

Repeat using other metal insert (L) and another large screw (O).

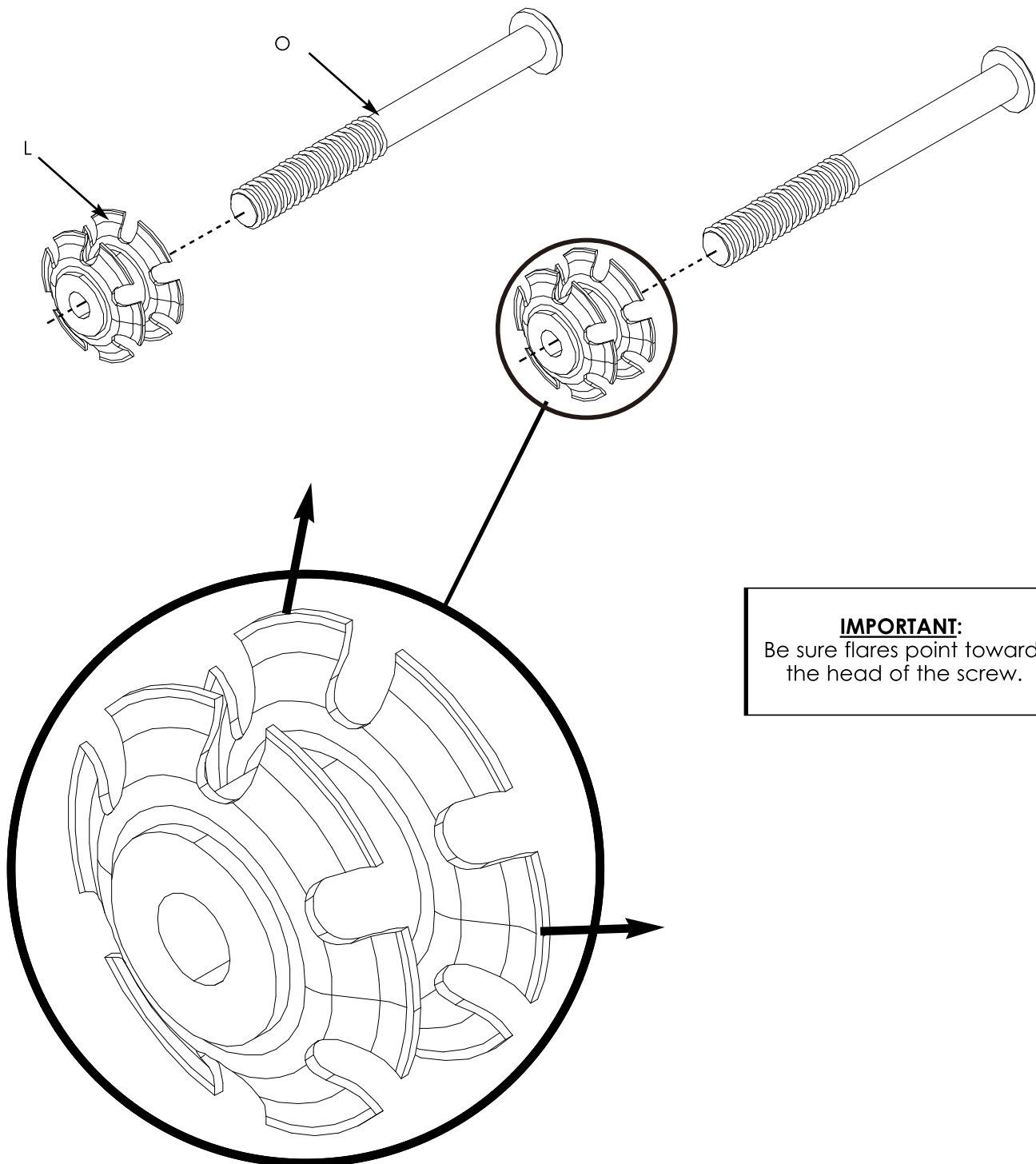

**IMPORTANT:**  
Be sure flares point toward  
the head of the screw.

6. Holding large screw (O) and using a hammer, gently tap the head of the screw to drive metal insert (L) into a flared tube (G). **IMPORTANT:** Metal insert (L) must be inserted in the tube between  $\frac{5}{8}$  in. and  $\frac{3}{4}$  in. **DO NOT INSERT THE METAL INSERT MORE THAN  $\frac{3}{4}$  in.**

**NOTE:** Use the screw to gauge that metal insert (L) is going into the tube straight. You can straighten the metal insert by gently straightening the screw.

Repeat using other large screw (O), metal insert (L) and flared tube (G).

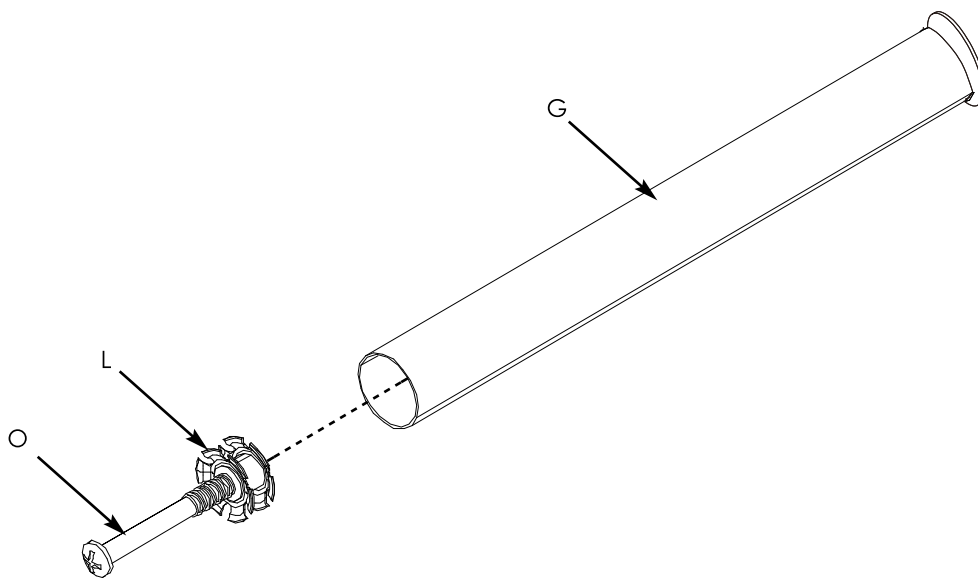

7. Unscrew large screw (O), leaving metal insert (L) inside the tube. Repeat, using other cut flared tube (G).

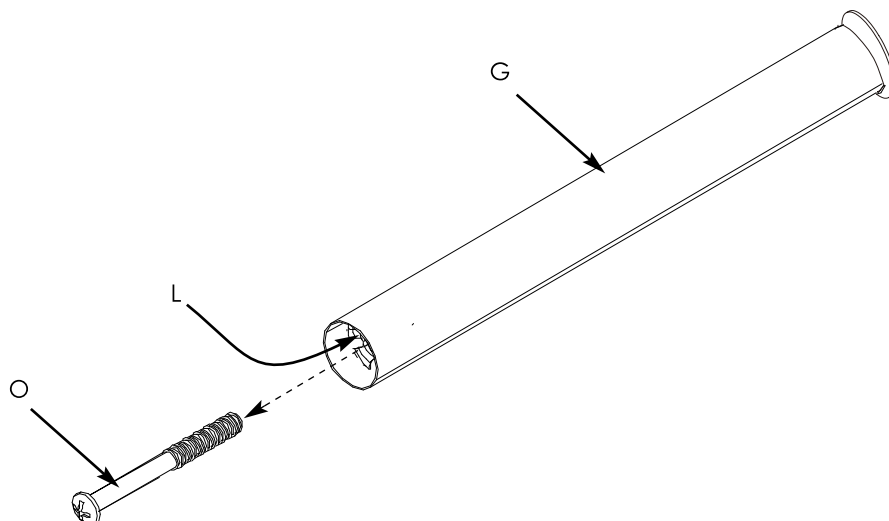

8. Insert the tapered end of short "L" shaped tube (B) into longer side (end with 4 holes) of long "L" shaped tube (A).

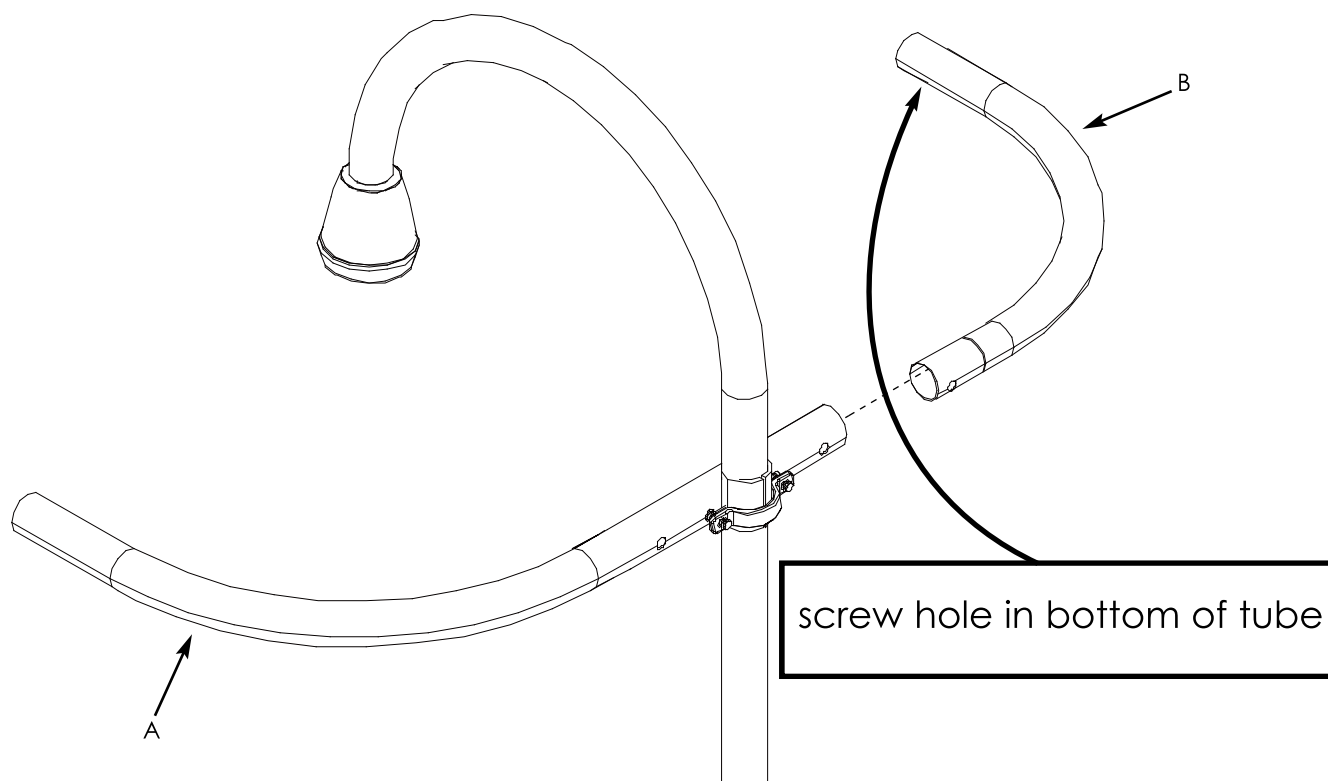

9. Slide an open metal flange (H) onto each cut flared tube (G), as shown.  
**NOTE:** Back of open metal flange (H) faces the flared end of tube (G).

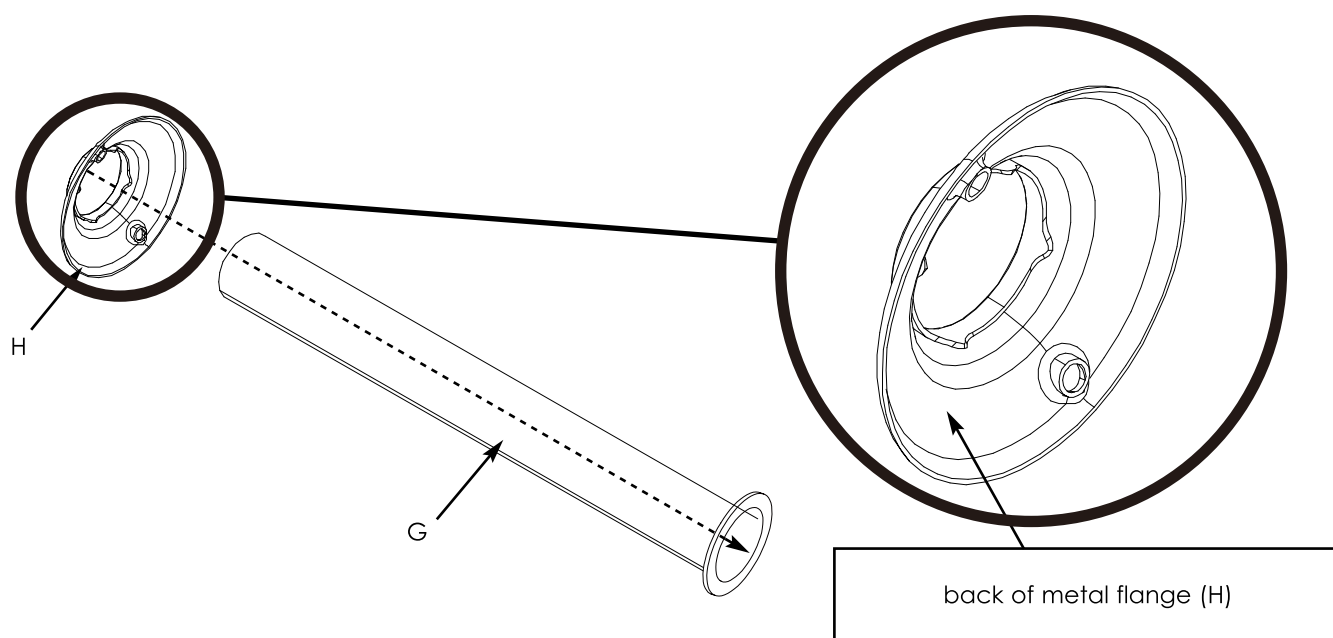

10. Insert a 1 in. nylon insert (M) into each cut flared tube (G). Fasten 2 cut flared tubes (G) to long "L" shaped tube (A), and short "L" shaped tube (B) using large screws (O).

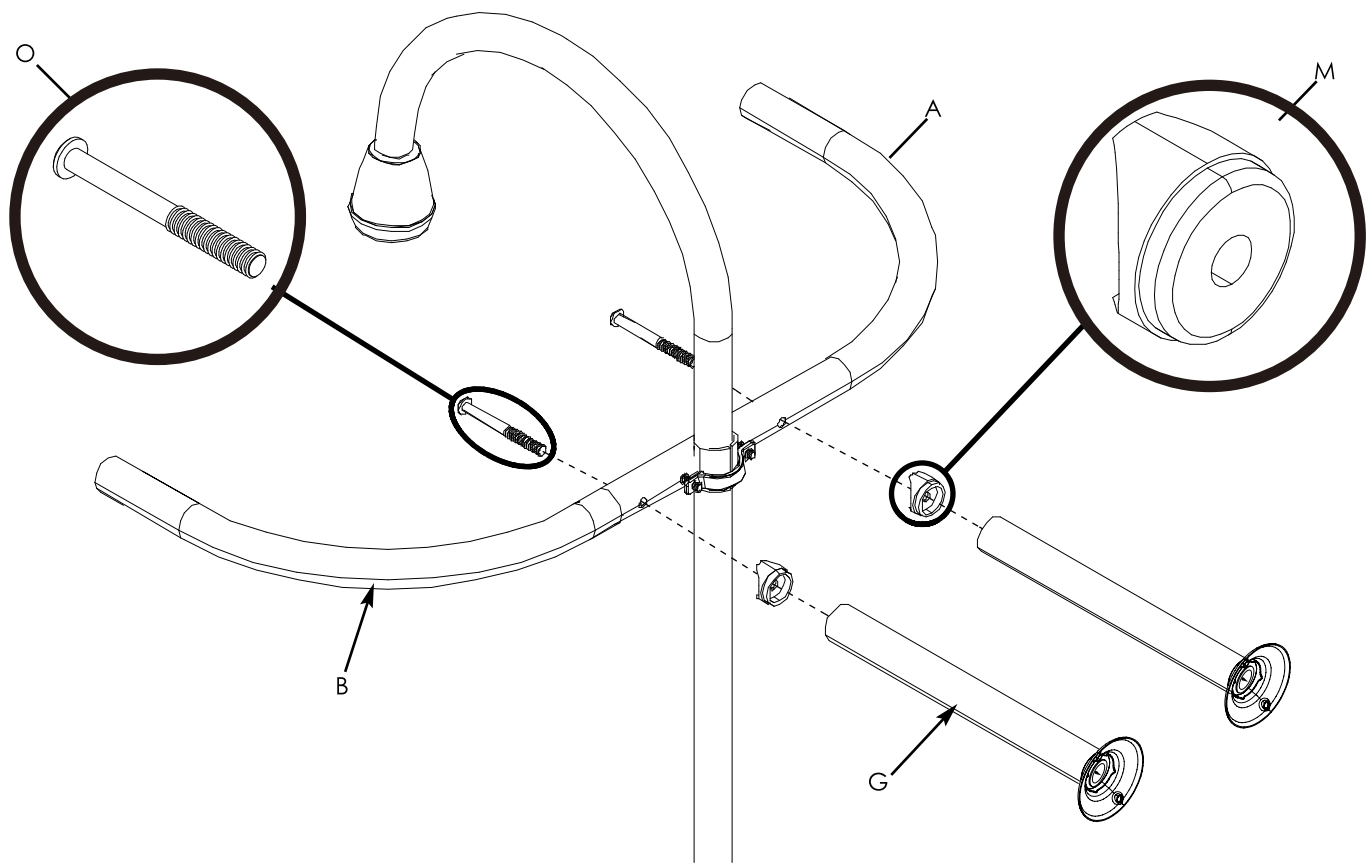

**NOTE:** If nylon inserts (M) can't be inserted inside of flared tubes (G), metal inserts (L) may need to be inserted a little farther into flared tubes (G). (See step 6.)

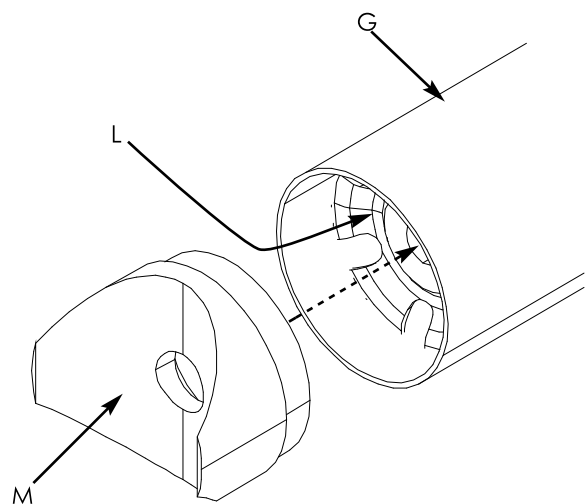



11. Mark mounting points on wall through holes in metal flanges (I).

**NOTE:** If a mounting screw (S) will be going directly into a stud, an anchor (T) should not be used. Use a 1/4 in. (6 mm) drill bit for drywall anchor installation. Use a 5/64 in. (2mm) drill bit for direct stud installation. If installing into a material other than drywall or into stud, consult a professional for proper installation.  
*If installing into a material other than drywall or into stud, consult a professional for proper installation.*

**NOTE:** Be sure to orient these parts so that the hole in the long "L" shaped tube (A) is on the bottom of the assembly.

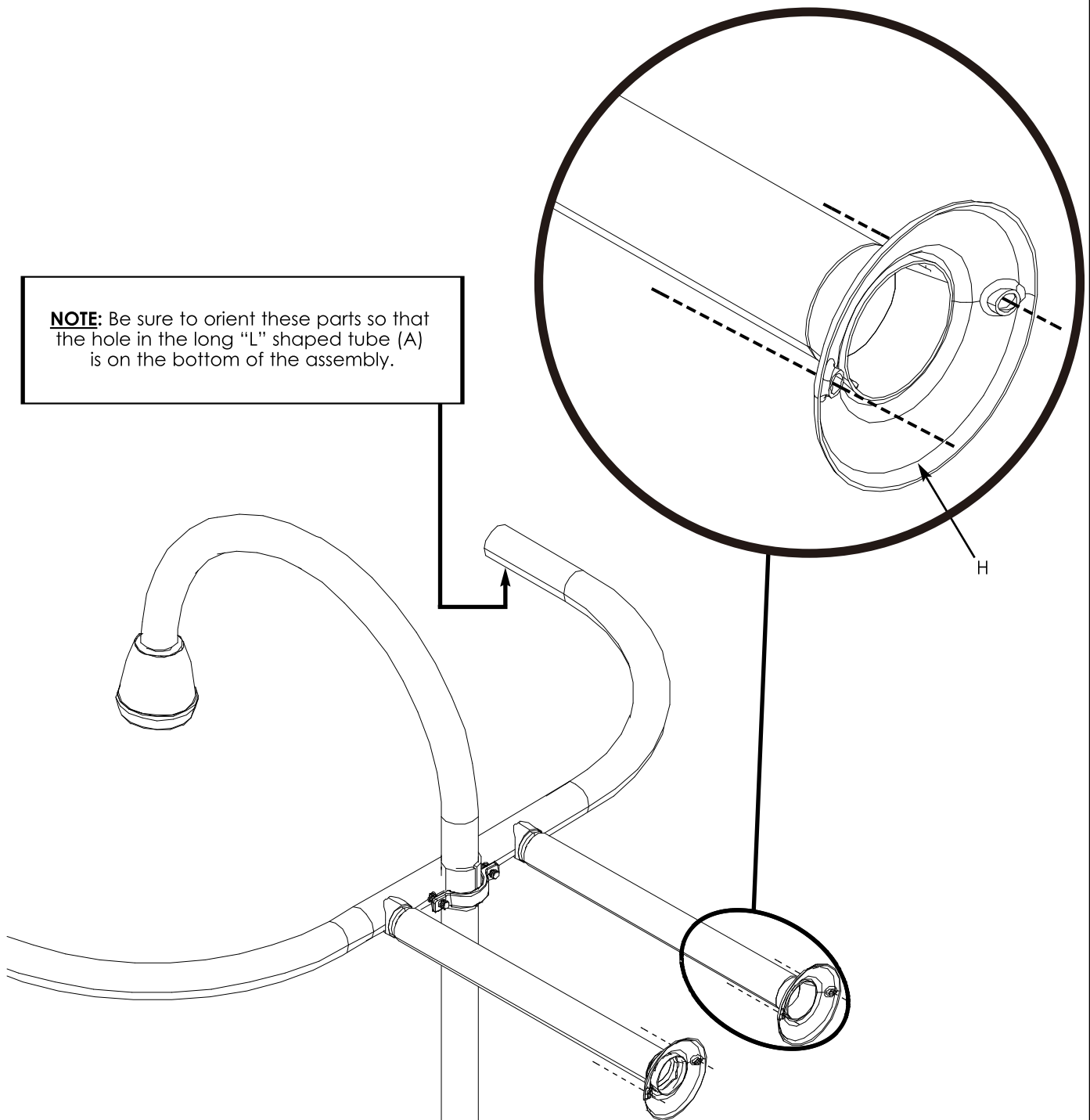

12. Attach the assembly to the wall. **NOTE:** If you screw directly into studs, anchors (T) are not necessary.

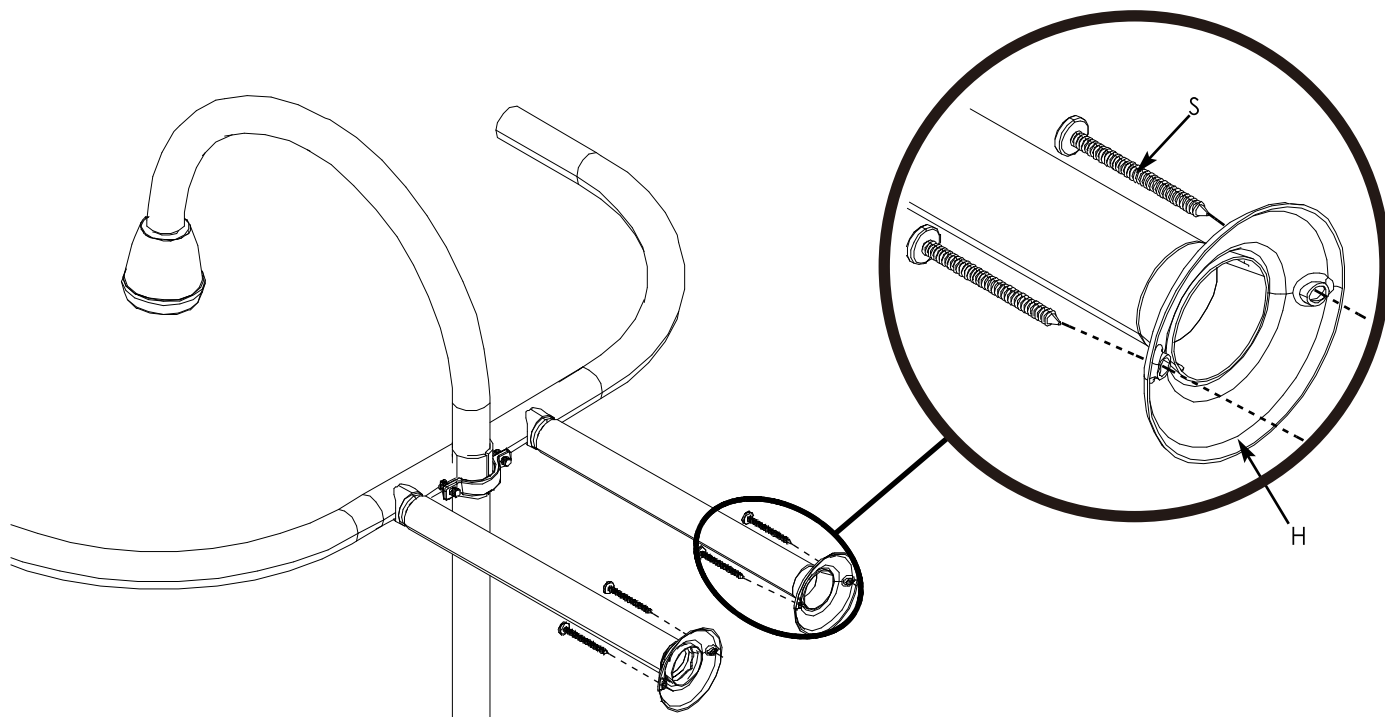

13. Fasten 2 long tubes with tapered ends (F) to the assembly using small screws (Q).

**IMPORTANT:** For the rest of the installation, do not let the assembly just hang from the wall. A second person should continue to support the assembly until it is fastened to the ceiling.

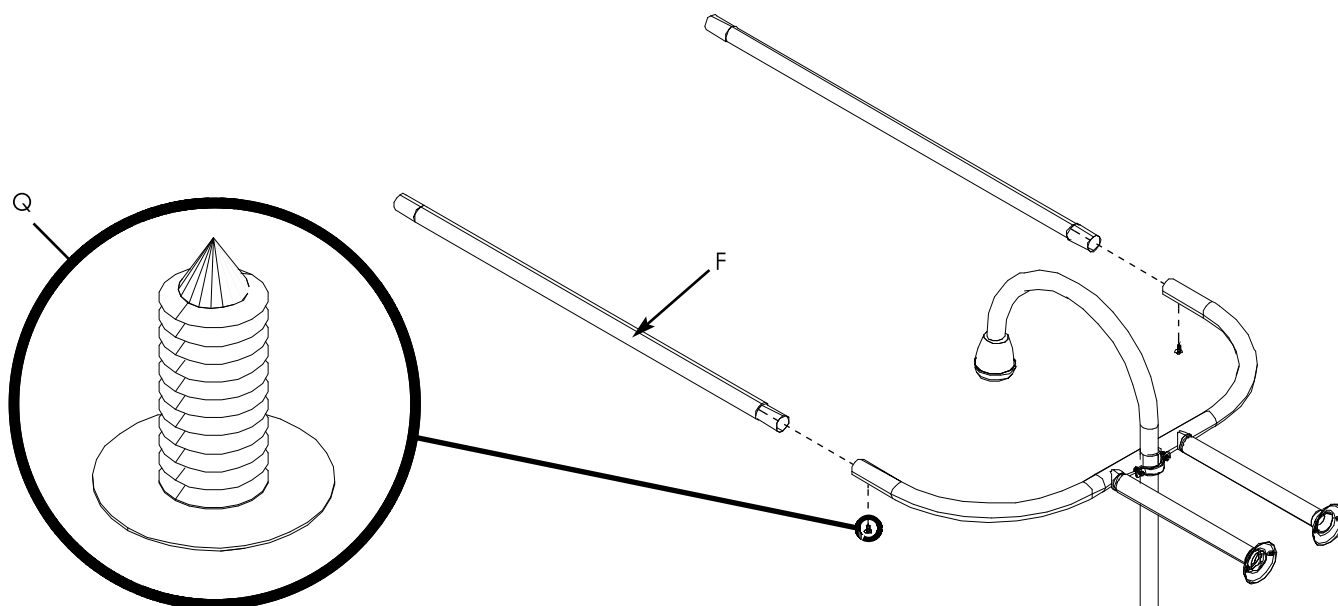

14. Attach U-shaped tube (C) to the assembly using small screws (Q).

**NOTE:** Make sure all of the small screws are attached to the bottom of the tubes, so the shower curtain rings will be able to slide freely along the top.

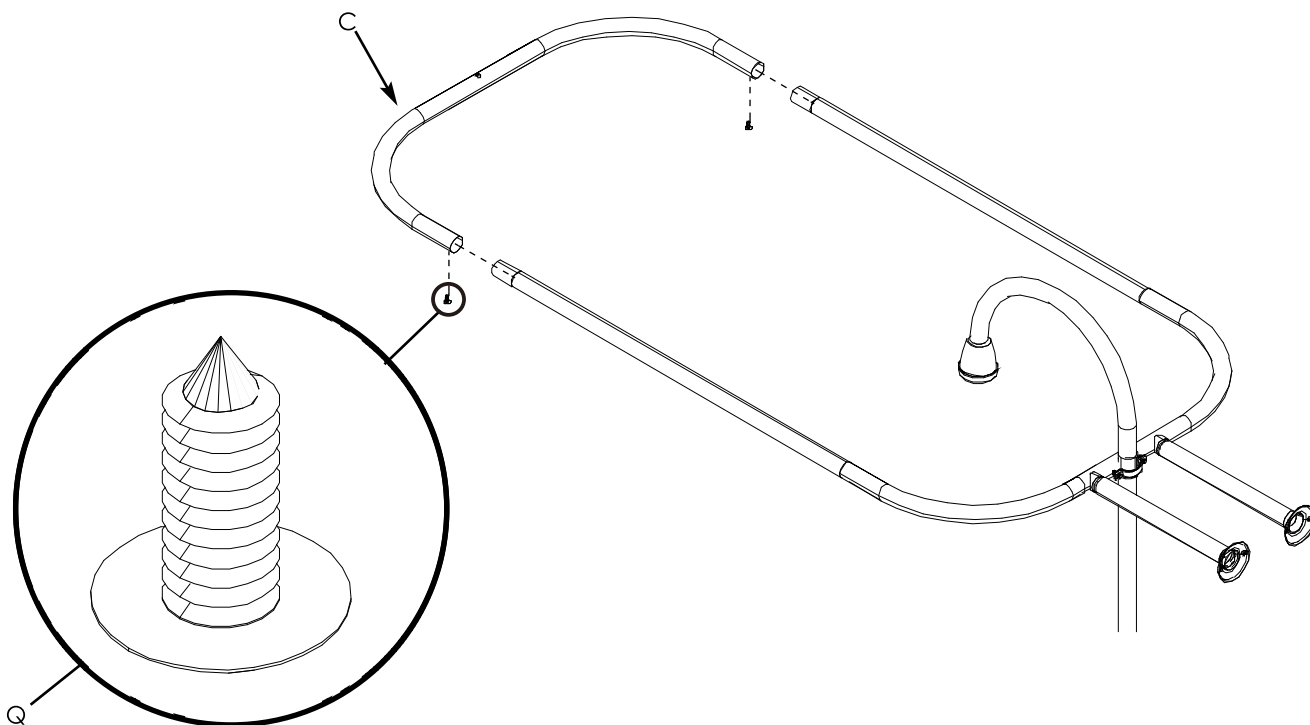

15. Keeping assembly level, measure from the top of assembly to ceiling.

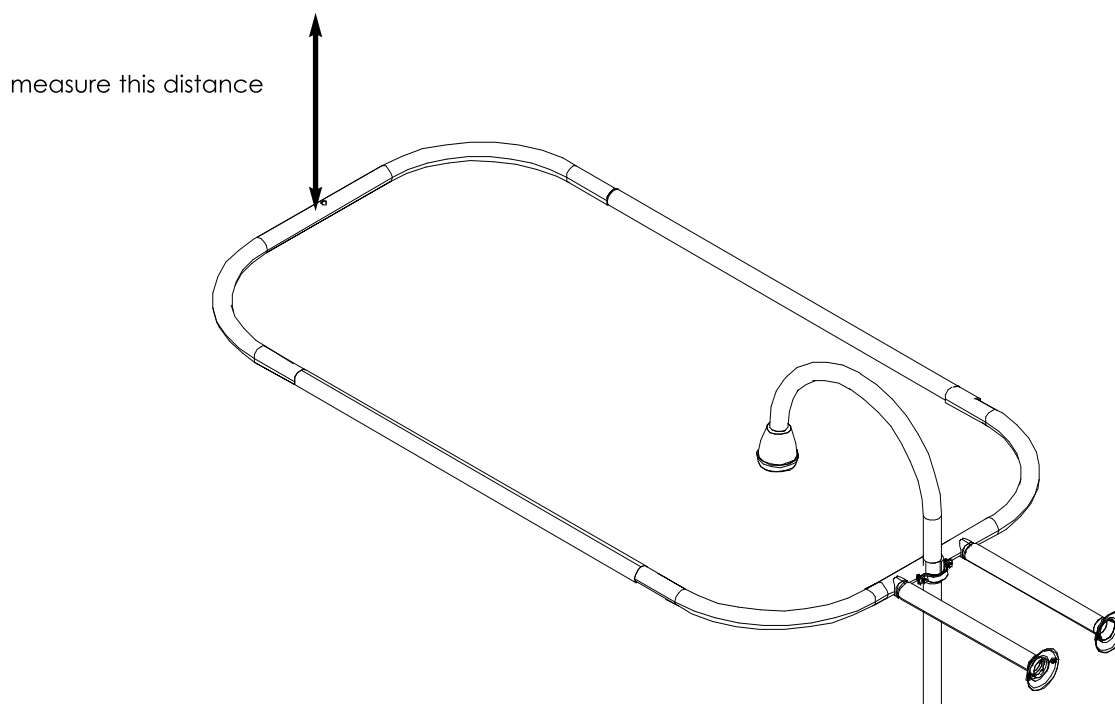

16. **Subtract 2 in.** from the measurement from step 15. Measuring from the end of the tube **with the factory metal insert**, mark this measurement on long straight tube (D). Using a hacksaw, cut long straight tube (D) at the mark.

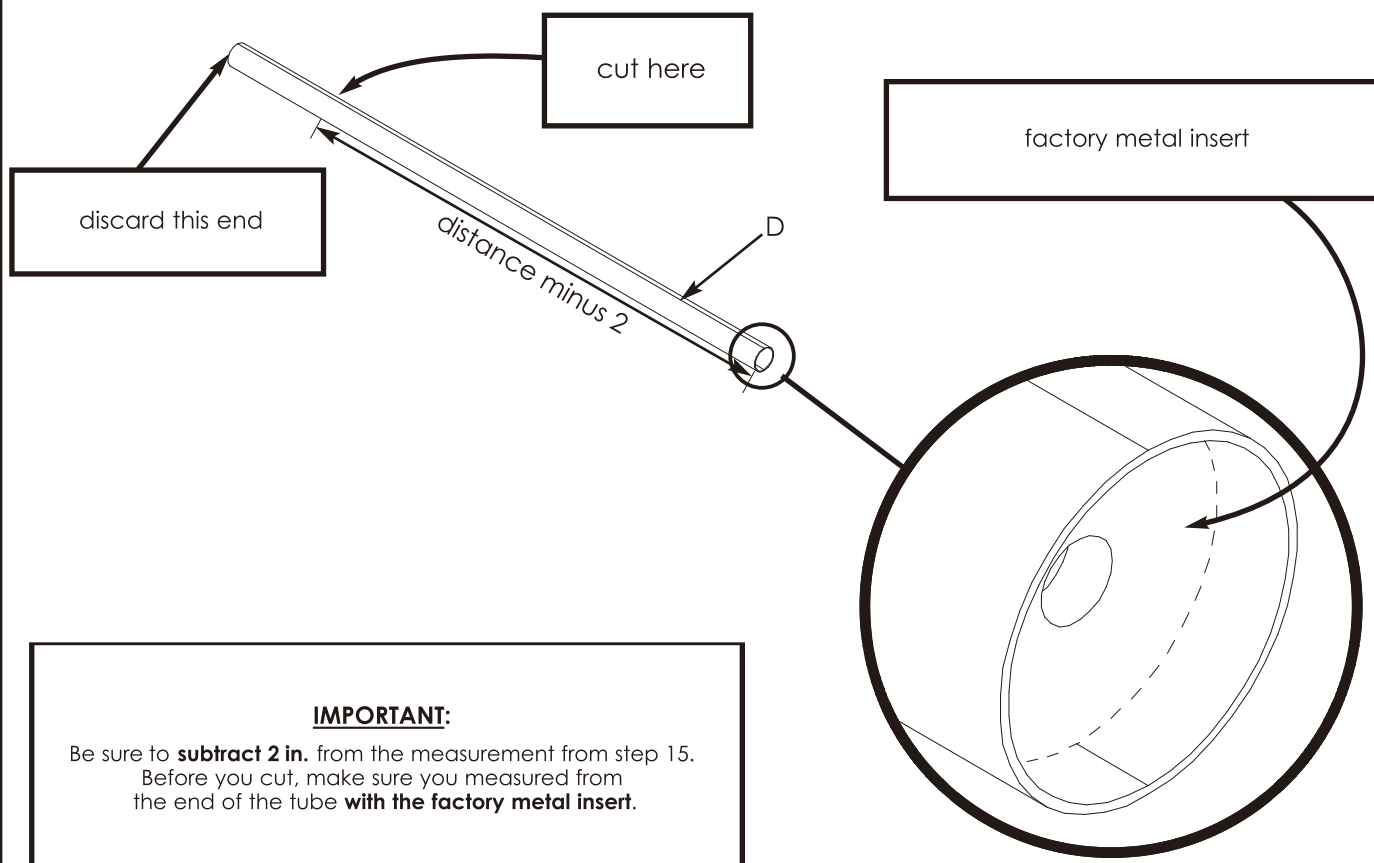

17. Put part E on the outside of the tube E, then set screw (P) goes thru part I and installed in tube E.

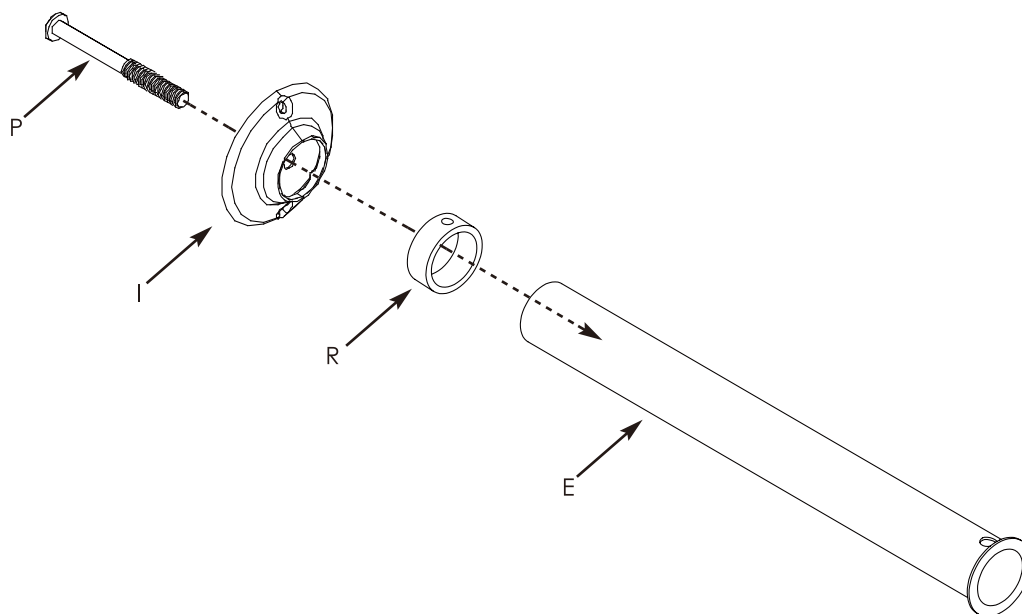

18. Slide the long straight tube (D) that you previously cut into short tube with hole (E), as shown.

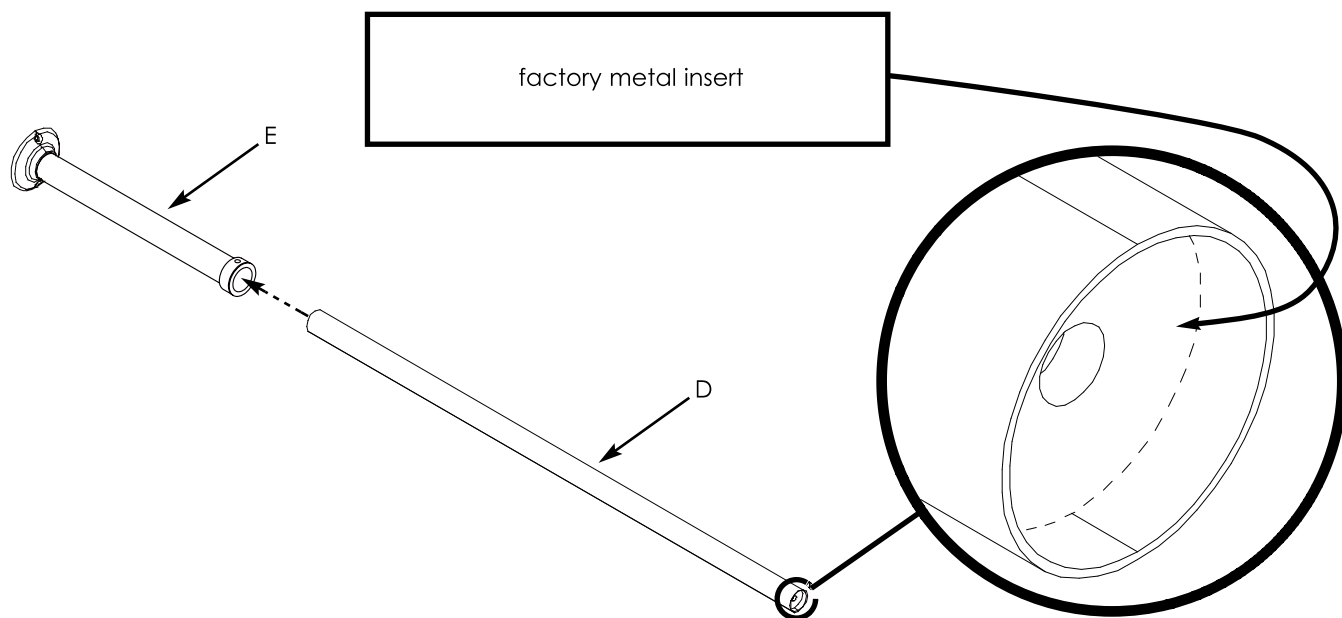

19. Insert 7/8 in. nylon insert (N) into the end of long straight tube (D). Fasten long straight tube (D) to the assembly using a large screw (O).

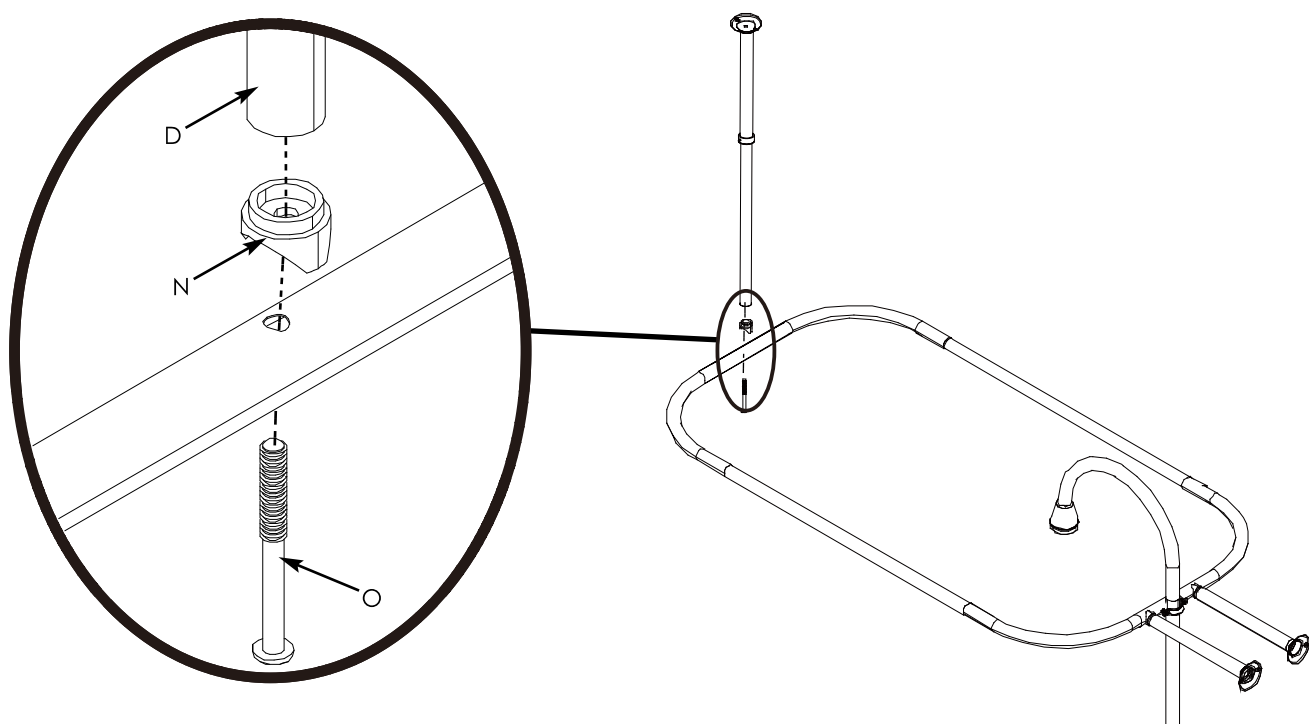

20. Slide short tube with hole (E) and closed metal flange (I) up to the ceiling. Mark mounting points on ceiling through holes in metal flange (I).

**NOTE:** If a mounting screw (S) will be going directly into wood, an anchor (T) should not be used. If an anchor (T) will **be used**, use a 1/4 in. (6mm) drill bit for drywall anchor installation. Use a 5/64 in. (2mm) drill bit for direct stud installation. If installing into a material other than drywall or into stud, consult a professional for proper installation.

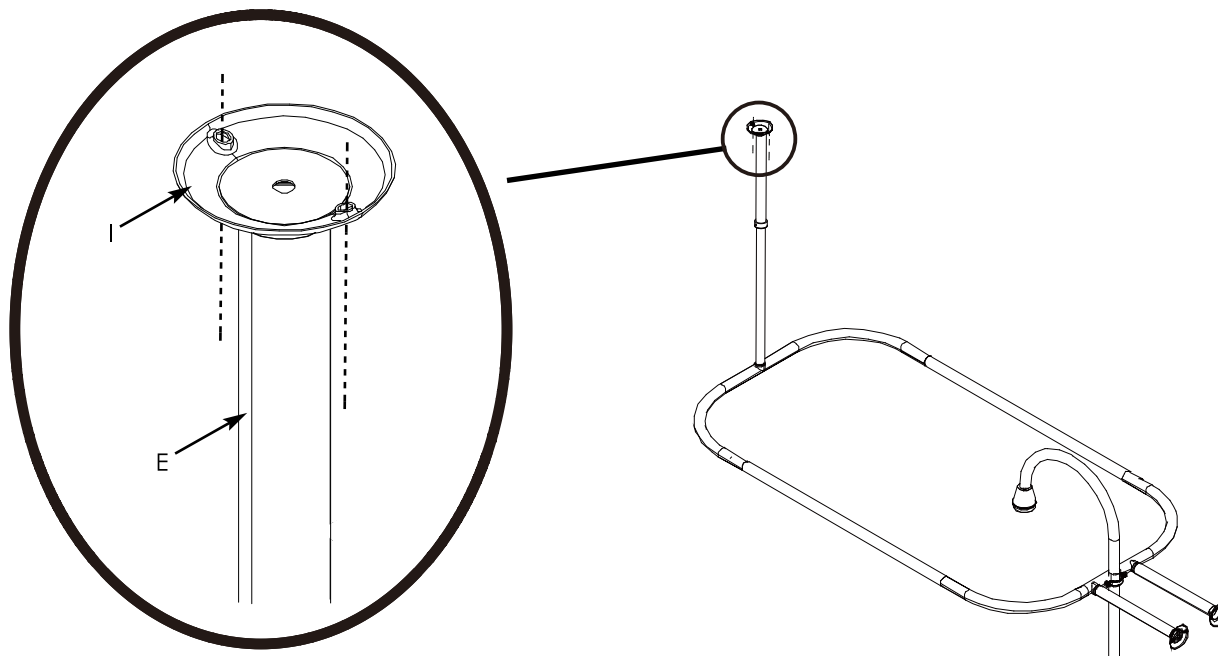

21. Using mounting screws (S), attach closed metal flange (I) to the ceiling, as shown.

**NOTE:** If you screw directly into studs, anchors (T) are not necessary.

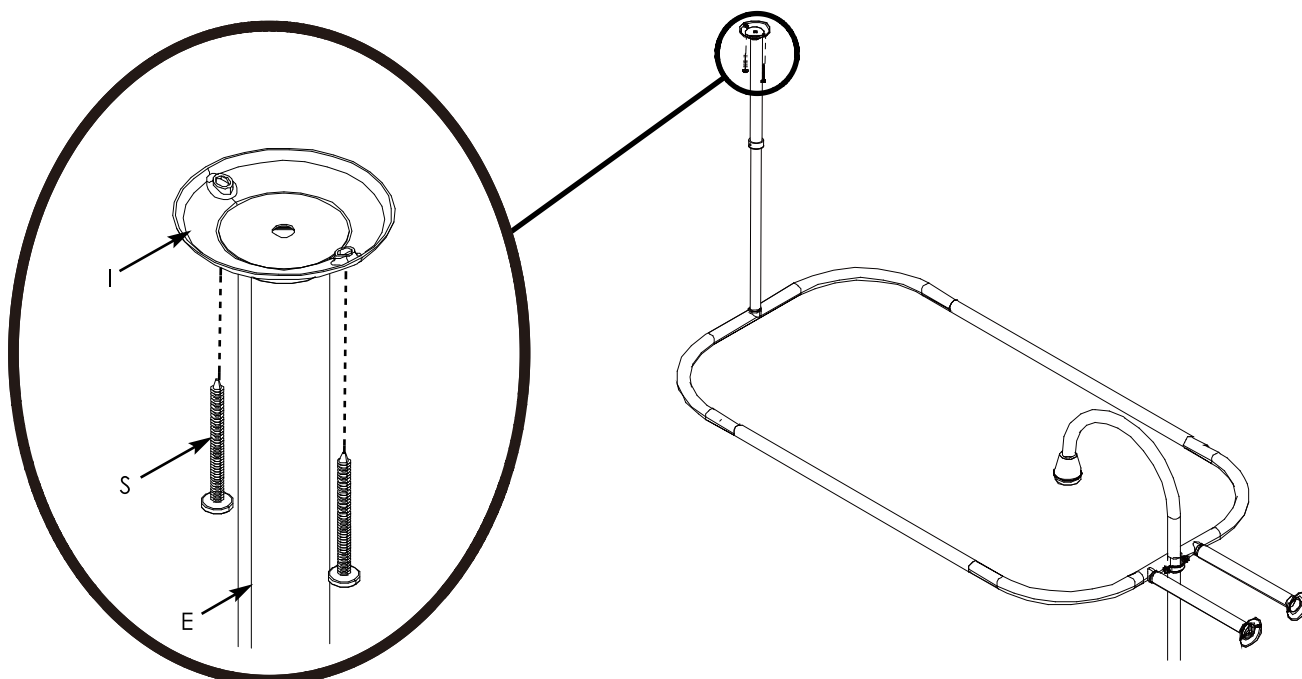

22. **NOTE:** Make sure the rod assembly is level.

Fasten the set screw (U) into the vertical support collar (R) and tighten the short tube with hole (E) to the long straight tube (D) together using allen wrench (H), as shown.

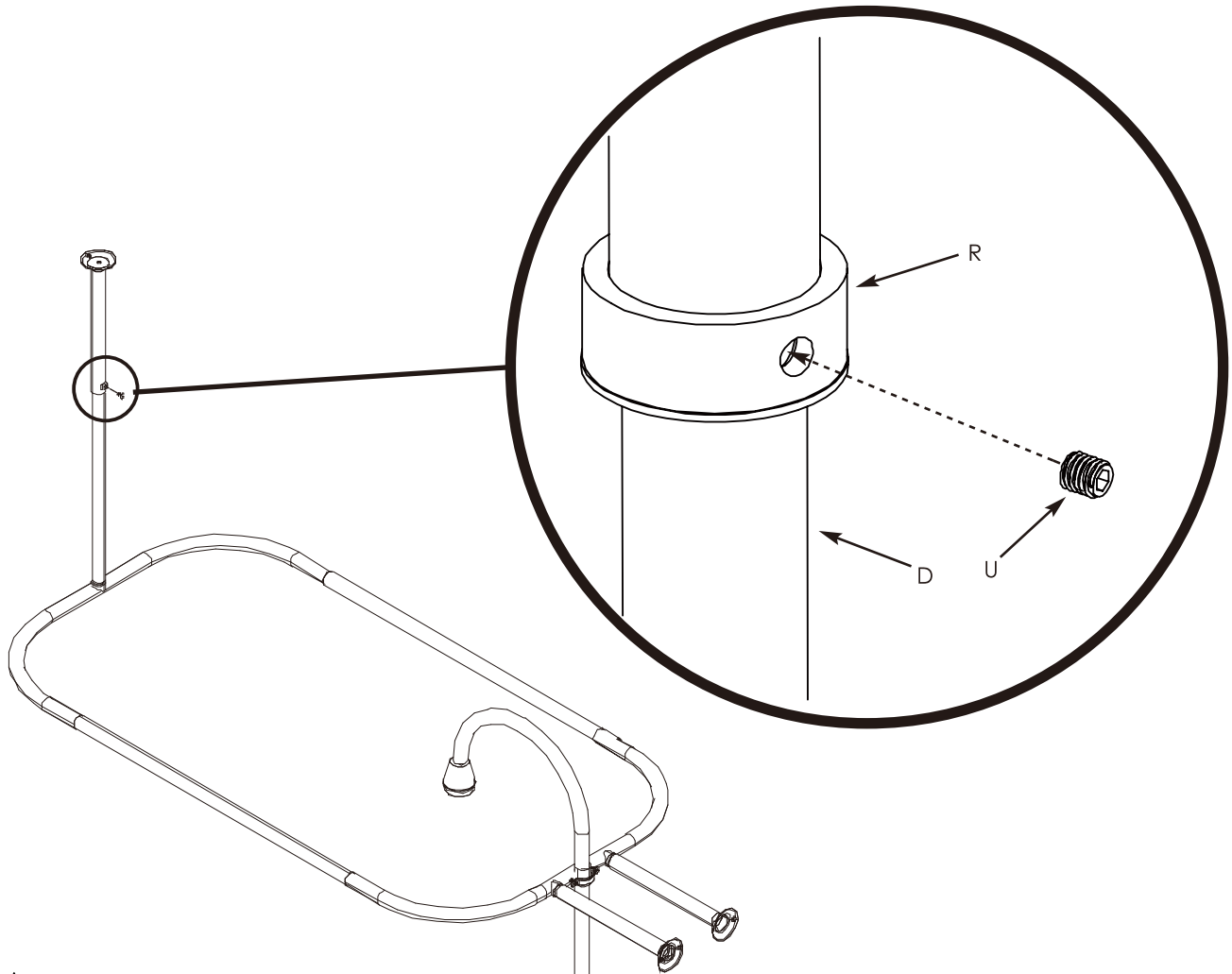

## WARNING

Manufacturer and seller expressly disclaim any and all liability for personal injury, property damage or loss, whether direct, indirect, or incidental, resulting from the incorrect attachment, improper use, inadequate maintenance, or neglect of this product.

### WARNING:

This shower rod is designed for hanging a shower curtain and/or liner only. Hanging any other items from the rod or any of its components may cause damage to the unit, the wall and/or the ceiling. Personal injury may occur.