

# Maykke™

[www.maykke.com](http://www.maykke.com)

## **Installation and Warranty Guide**



## Accessories

DLA1002401   DLA1010201   DLA1030101  
DLA1040101

### INSTALLATION: Dash Collection

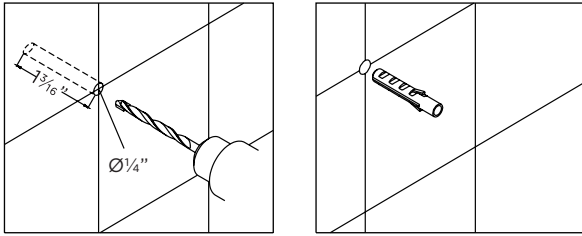

1. Using a 1/4" drill bit, drill two pilot holes approximately 1-3/16" deep and use the base bracket to determine the distance apart.
2. Insert the plastic wall anchors into the two pilot holes, making sure the anchor and the wall are even.
3. Using the provided screws, attached the base bracket to the wall.
4. Fit the base into position and lock it with the set screw using an Allen wrench.

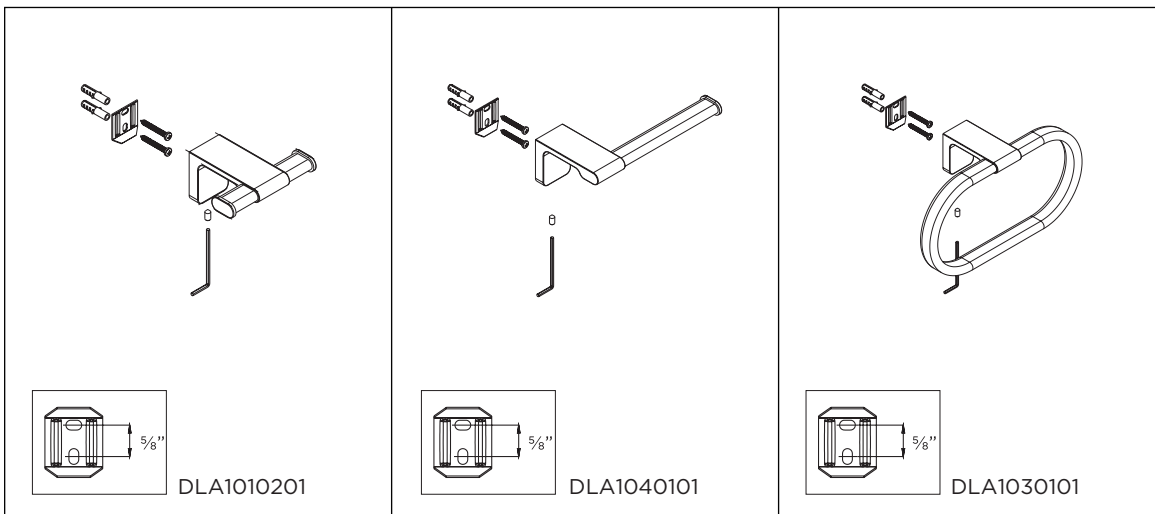
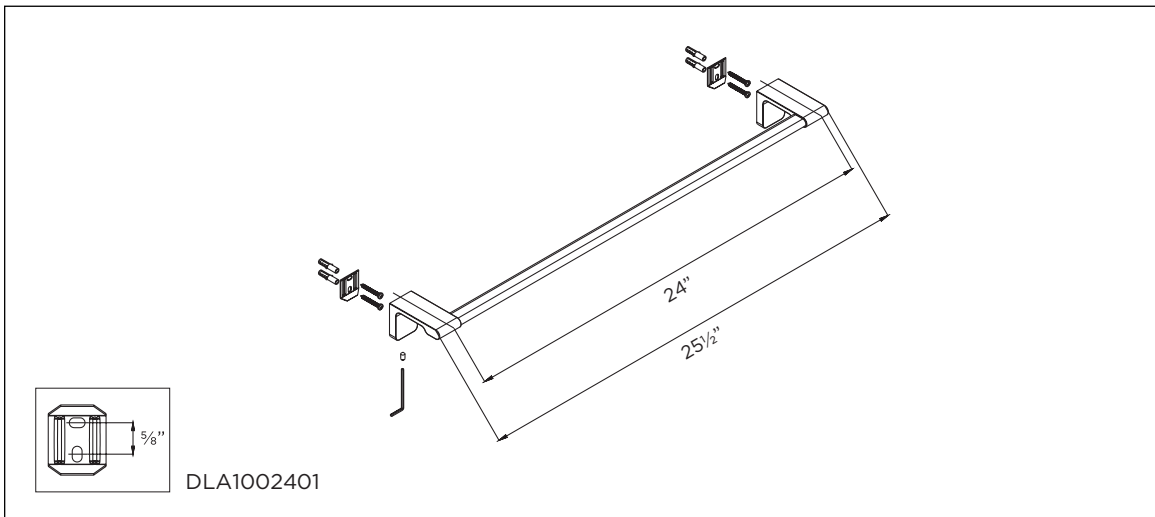

### One Year Limited Warranty

Your Maykke product is warranted against defects in material and workmanship for ONE (1) YEAR from the date of original purchase, when used in accordance with Maykke's Care Guide. Damage caused during moving or installation is not considered a defect. The warranty cannot be transferred and is for original purchaser only. Maykke will not be responsible for any installation or removal charges. For customer service concerns please email: support@maykke.com.