

**Assembly Instruction Sheet #S-2039W13AB**  
**For Style 2039W13AB**

**Tools Required:** Flathead screwdriver, Phillips screwdriver, pliers, wire cutters, wire strippers, electrical tape, safety glasses.

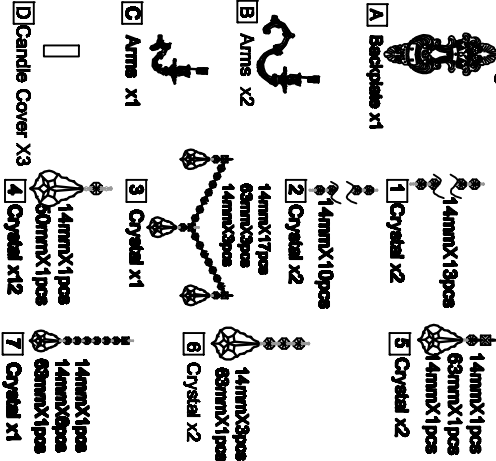
**Light Sources:** (2) E12 Candelabra Base Bulbs 60W Medium/Not Included.

Prepayment: Identify and inspect all parts before beginning installation. Check package content list and diagrams before to be sure all parts are present. If any parts are missing or damaged, do not attempt to assemble, install, or operate the boiler. Contact customer service for replacement parts.

## **⚠ Warnings and Cautions**

Turn off electricity at circuit breaker or main fuse box before installation. Consult a licensed electrician if in doubt. These instructions are provided for your safety. It is very important you read them completely before installing the bulbs. We strongly recommend that a licensed, professional electrician perform the installation. Disconnect bulbs from power source before replacing bulbs. Make sure bulbs are given sufficient time to cool before removal.

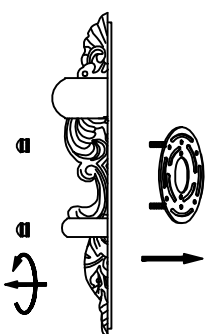
## **Package Contents**



## Hardware Contents

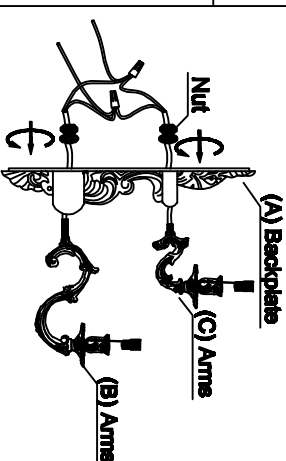
PART	DESCRIPTION	QUANTITY
BB	Wire nut	2pcs
CC	Outlet Box Screw	2pcs

### STEP 1- Release Mounting bracket from Backplate.

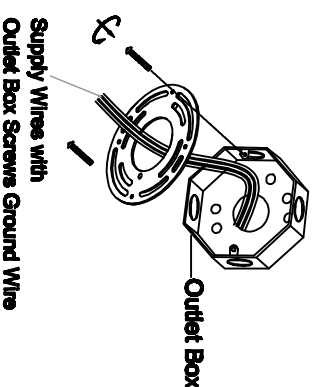


**Figure 1**

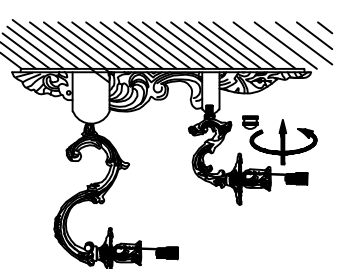
## STEP 2 - Assemble the Arms to the Backplate

**Figure 2**

### STEP 3 - Attach Mounting bracket to Outlet Box

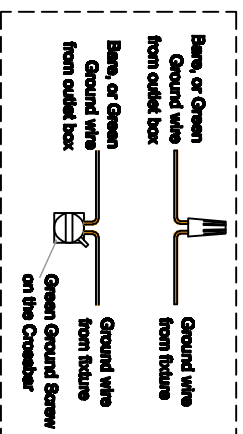
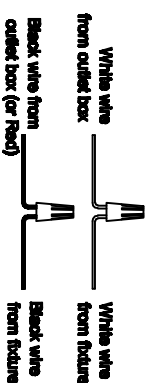
**Figure 3**

## STEP 5 - Install Backdrops to Ceiling

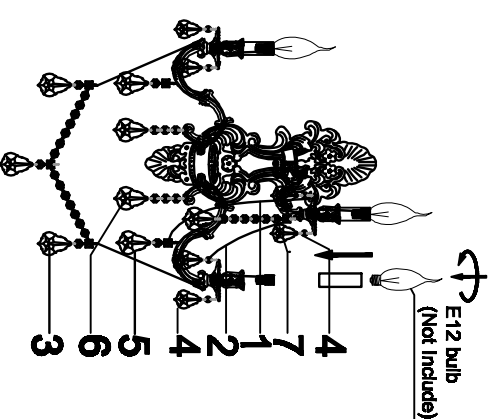
**Figure 8**

## STEP 4 - Wire Connections

**A. Use standard wire connections to make all wire connections. Twist connectors until wires are tightly joined together. Wrap each connection with approved electrical tape and carefully stuff all the connected wires into the Outlet Box.**

**Figure 4**

**STEP 6 - Install crystal candle covers and bulb.**

**Figure 7**