

# San Diego 36 Floating Vanity Installation Instruction

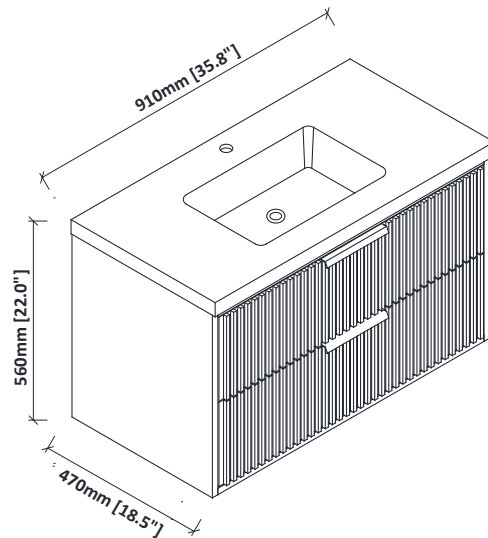

## DIMENSIONS

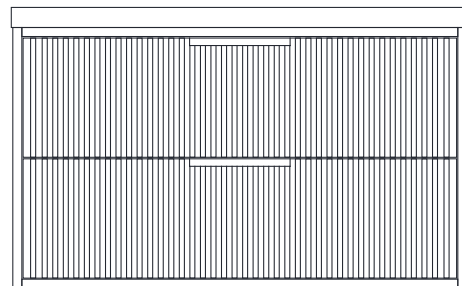
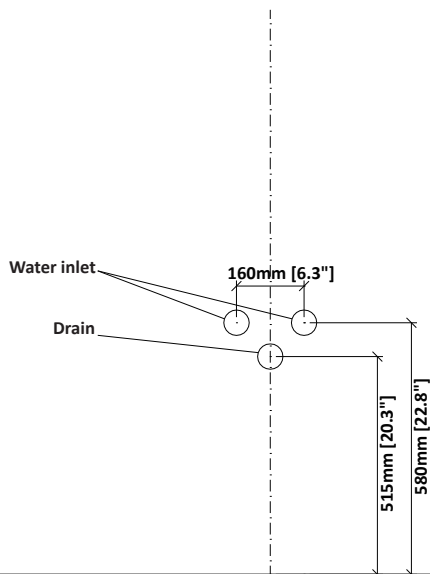
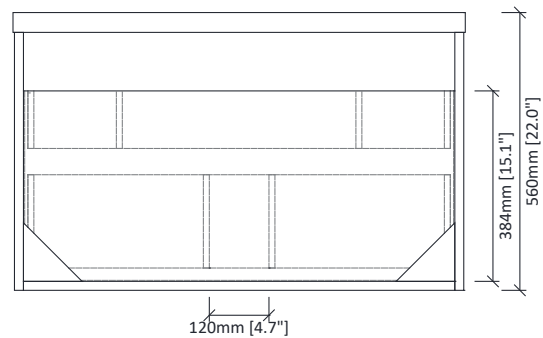
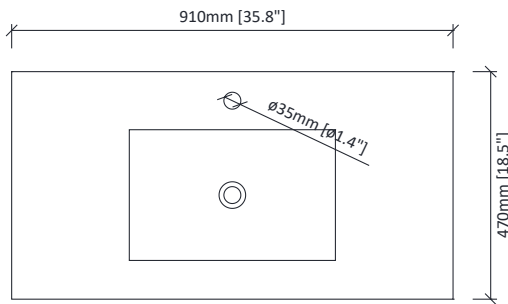

### **WARNING !**

*In the hole on the wall, please be sure to be careful to avoid the internal cables and pipelines.*

## MATERIALS & TOOLS

*Safety glasses, Pencil, Level, Tape measure, Stud Finder, Assorted screwdrivers, Assorted Wrenches, Drill, Screw gun, Caulking gun, Hammer, Screws, Nail anchors/Molly screws.*

# Vanity Installation

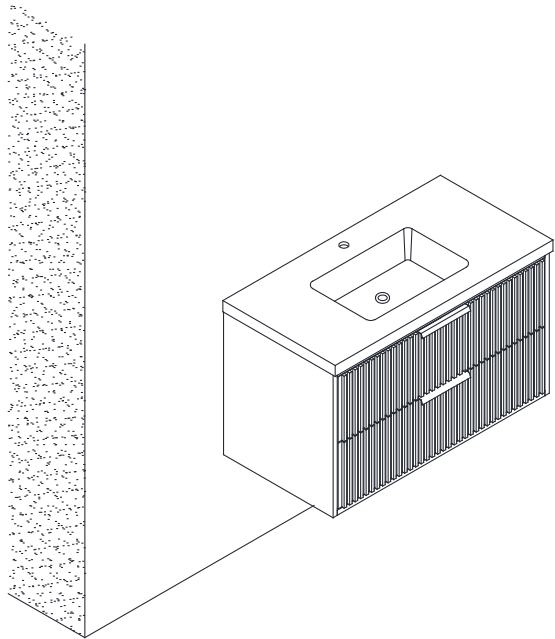
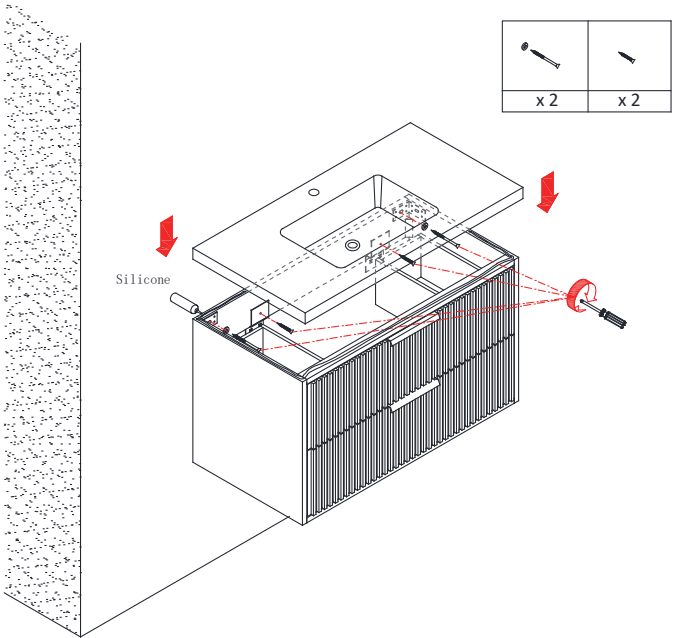
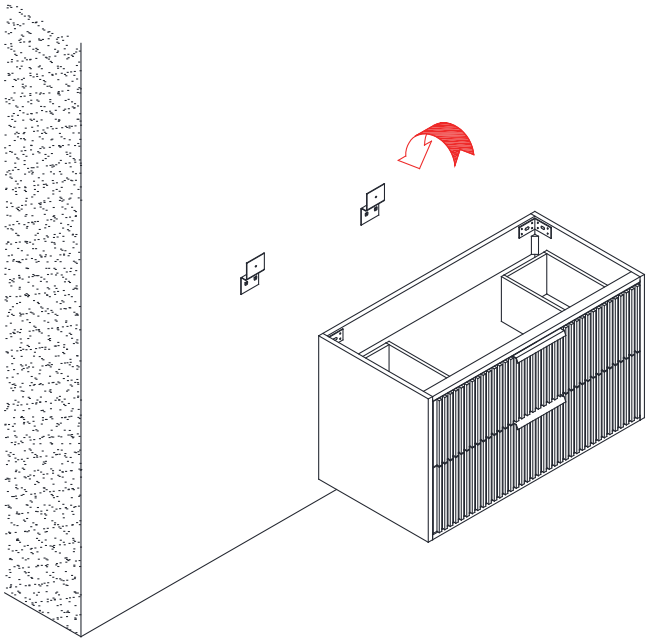
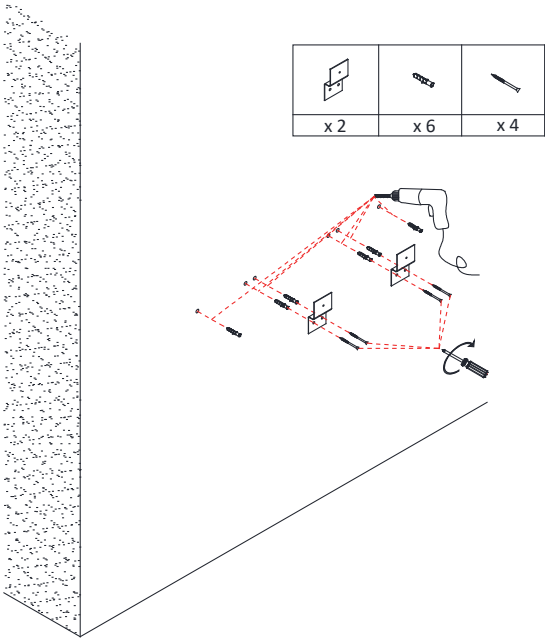

# Drain Installation Instruction

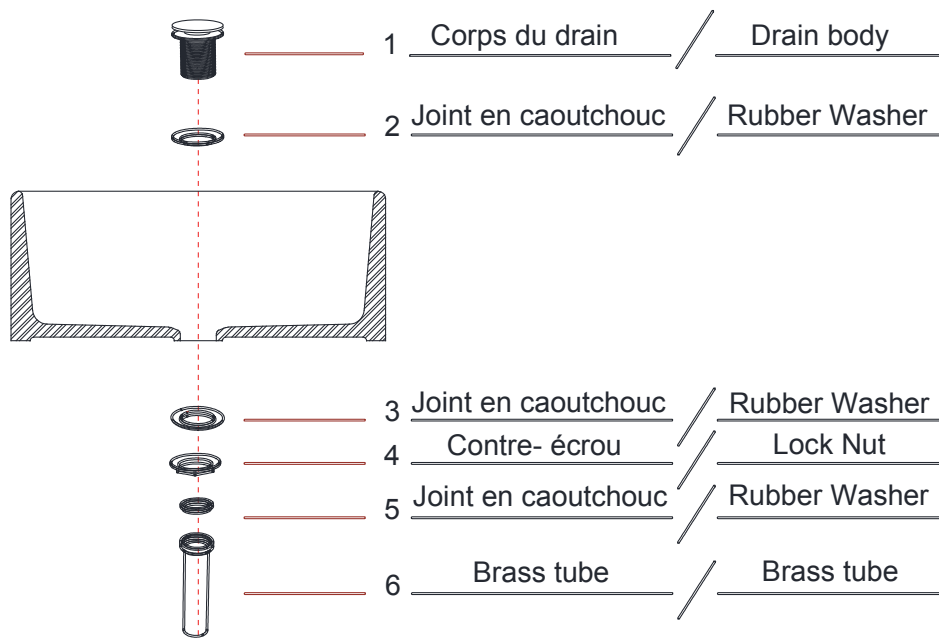
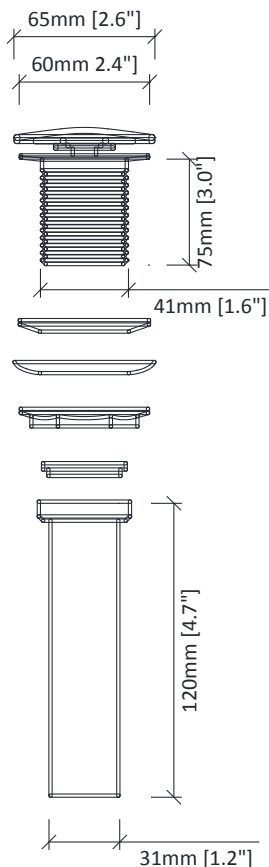

## **WARNING !**

*In the hole on the wall, please be sure to be careful to avoid the internal cables and pipelines.*