

Item Number: A05003D

WARNING (To reduce the risk of fire, electric shock, or personal injury):

1. We suggest installation by a **licensed electrician**.
2. Please read the instruction carefully and save it as you may need it at a later time.
3. Before you start, **NEVER** attempt any work without shutting off the electricity until the work is done.
 - » Go to the main fuse, or circuit breaker, box in your home.
Place the main power switch in the **"OFF"** position.
 - » Place the wall switch in the **"OFF"** position.
4. Mounting surface should be clean, dry, flat, strong enough and 1/4" larger than the canopy on all sides. Any gaps between the mounting surface and canopy exceeding 3/16" should be corrected as required.
5. Make sure that the ceiling or wall can stand the weight of the lamp before installation.
6. Make sure the voltage you are using is **120V**. The maximum wattage is **Type B, Max 40W** per bulb.
7. Keep the lamp away from acidic and alkaline substances in case of damaging the surface of the lamp.
8. When replacing bulbs, you should turn off or unplug the lamp and you must wait until it is cool as bulbs get hot quickly.
9. The safety instructions appearing in this manual are not meant to cover all possible conditions that may occur. It must be understood that common sense, caution and care must be used with any electrical products.

IMAGE FOR FINISHED PRODUCT:

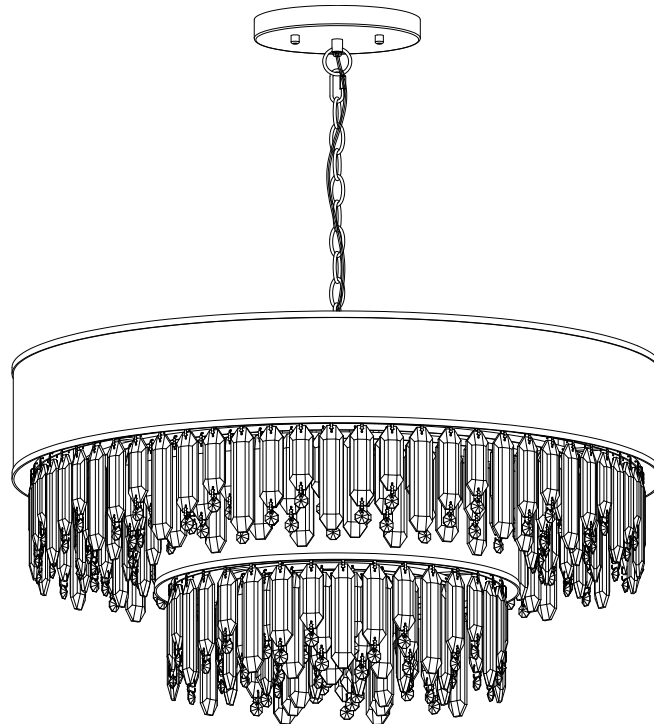

ORDERING PARTS

Keep this sheet for future reference in case you need to order replacement parts. All parts for this fixture can be ordered from the place of purchase. Be sure to use exact wording from illustration when ordering parts.

CLEANING

To clean, wipe the fixture with a soft cloth. Clean glass with a mild cleaner (such as mild and non-abrasive soap). Do not use abrasive materials such as scouring pads or powders, steel wool or abrasive paper.

TOOLS REQUIRED (NOT INCLUDED):

Before starting assembly and installation please prepare the needed tools as below picture

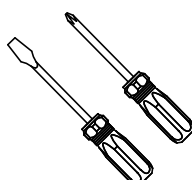
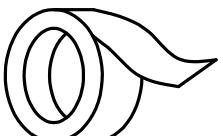
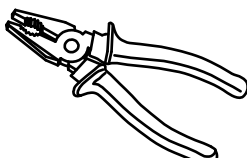
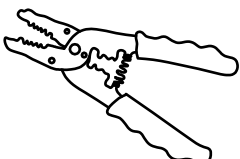
				
Ladder	Philips Head or Flat Blade Screwdriver	Electrical Tape	Pliers	Wire Cutter/Stripper

PARTS TYPE & QTY INCLUDING:

- | | |
|------------------------|-------------------------------|
| (E) Mounting plate (1) | (S) Short crystal (78) |
| (F) Canopy (1) | (T) Medium crystal (78) |
| (G) Knob nut (4) | (U) Long crystal (78) |
| (H) Quick link (2) | (W) Insurance buckle (1) |
| (I) Main chain (1) | (X) Safety cable assembly (1) |
| (J) Loop (1) | (Y) Steel wire (1) |
| (K) Screw (24) | |
| (L) Upper shade (1) | |
| (M) Short pipe (6) | |
| (N) Long pipe (6) | |
| (O) Upper frame (1) | |
| (P) Lower shade (1) | |
| (Q) Lower frame (1) | |

ACCESSORIES & QTY ENCLOSED:

- | |
|-------------------------------------|
| (A) Anchor (3) |
| (B) Green ground screw (1) |
| (C) Anchor screw (3) |
| (D) Plastic Wire Connector (3) |
| (V) Allen wrench |
| (R) Crystal hook (10) (spare part) |
| (K) Screw (1) (spare part) |
| (S) Short crystal (2) (spare part) |
| (T) Medium crystal (2) (spare part) |
| (U) Long crystal (2) (spare part) |

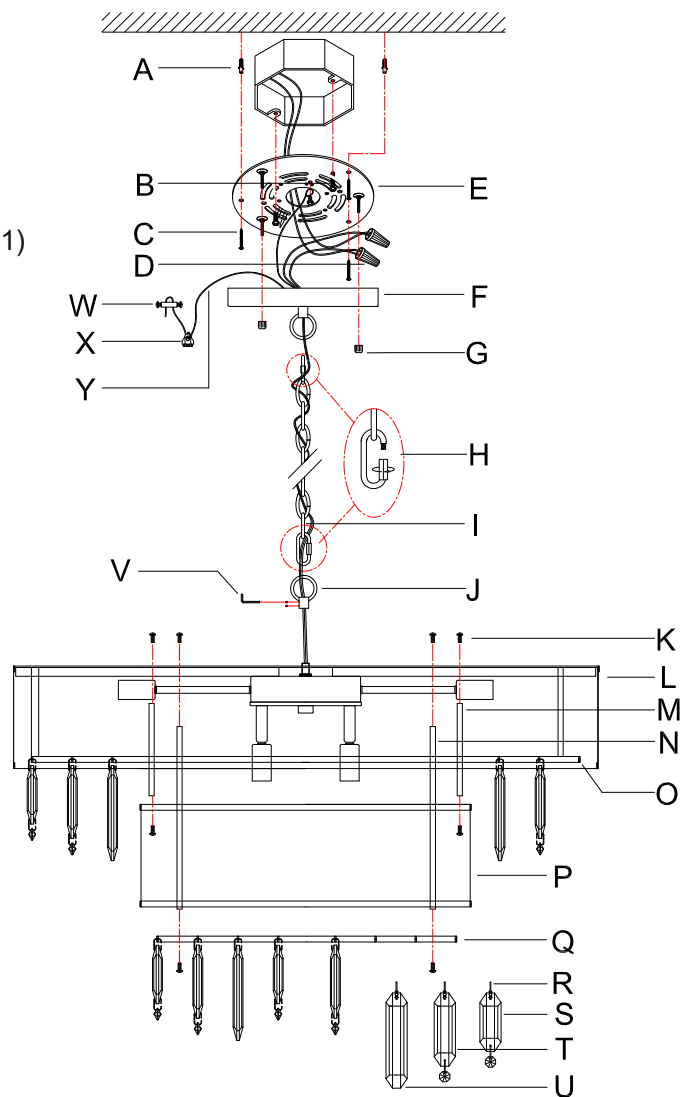

ASSEMBLY & INSTALLATION INSTRUCTIONS:

1. Carefully remove the fixture from the carton and check that all parts and accessories are included as shown in the above illustration.
2. Make pre-installation

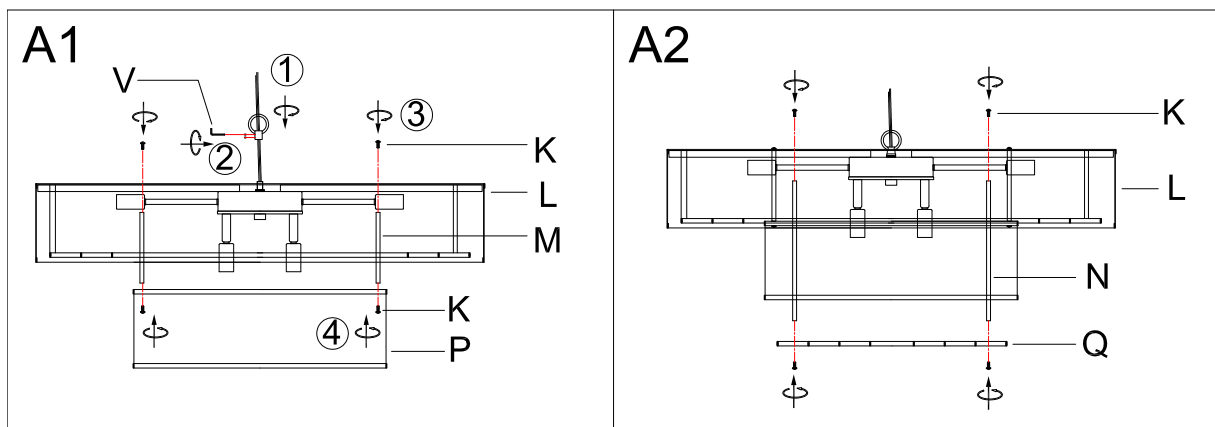

Step A1 » 1) Screw loop (J) to the top of upper shade (L) and then tighten the tiny screws of loop (J) with Allen Wrench (V) as shown in the illustration.

2) Align outer holes of upper shade (L), short pipes (M) and lower shade (P), and then screw screws (K) into holes to connect and secure them as shown in the illustration.

Step A2» Align inner holes of upper shade (L), long pipes (N) and lower frame (Q), and then screw screws (K) into holes through lower shade (P) to connect and secure them.

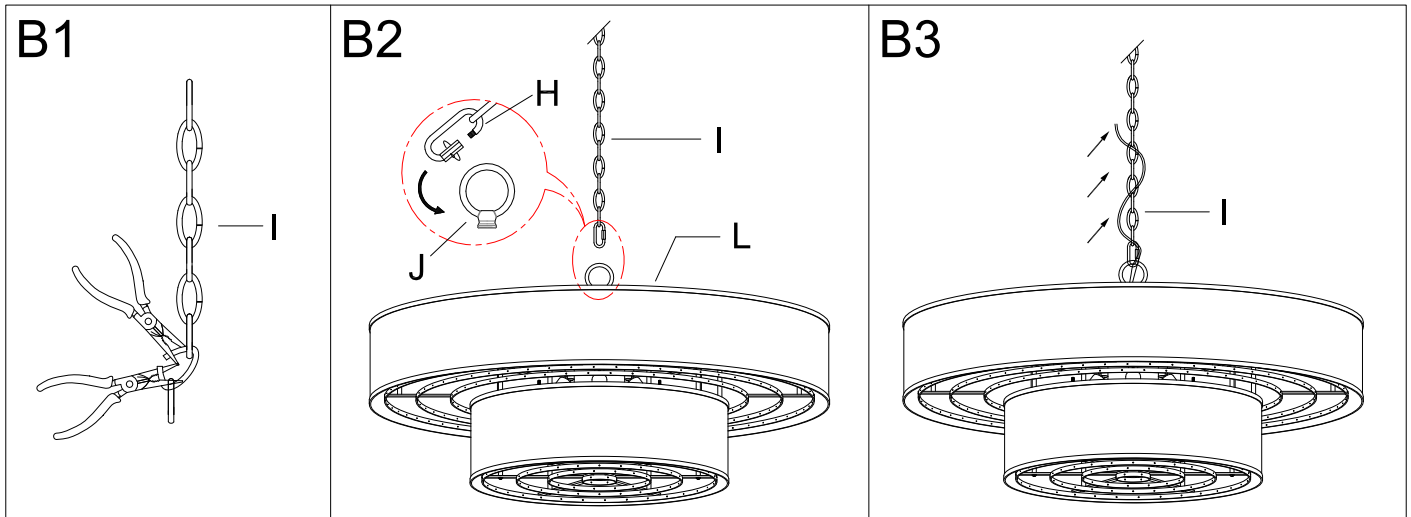

Step B1 » By measuring, determine the correct number of links needed for proper hanging height. Using the chain pliers, disconnect and discard the unwanted part.

Step B2 » Attach quick links (H) to main chain (I) and loop (J) on the top of upper shade (L).

Step B3 » Carefully weave the fixture wires through main chain (I) in and out of every other link and stop just when you reach the top of main chain (I). Gently pull the wires to ensure the wires are not stressed.

3. Turn off power

Before you start the installation, NEVER attempt any work without shutting off the electricity until the work is done.

- » Go to the main fuse, or circuit breaker, box in your home.
Place the main power switch in the "OFF" position.
- » Place the wall switch in the "OFF" position.

4. Make installation

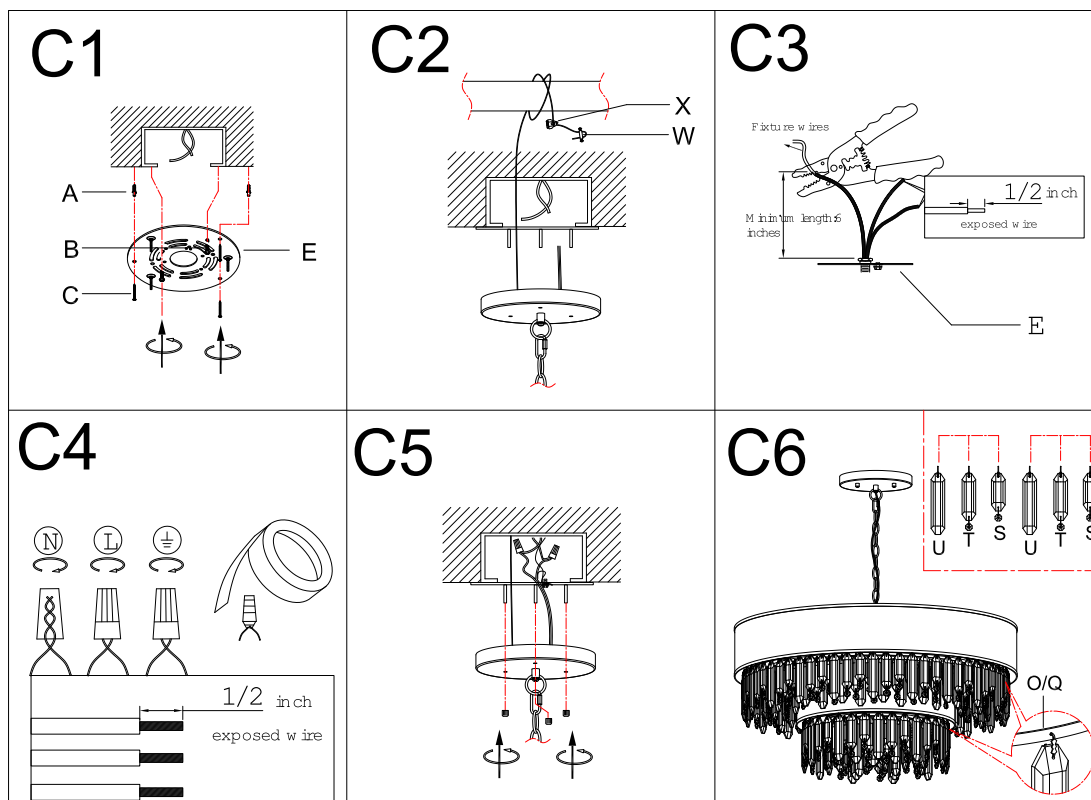

Step C1 » Carefully pass the supply wires from the outlet box through mounting plate (E).

NOTE: To drill the holes in the wall for anchors (A), attach mounting plate (E) to wall with anchor screws (C)

- 1) Attach mounting plate (E) to outlet box and then mark the position of holes in the wall with a pen as shown in the illustration.
- 2) Drill holes and gently knock anchors (A) into the marked holes until anchors (A) are level with the wall.
- 3) Secure mounting plate (E) to the wall with screwing anchor screws (C) into anchors (A).

Step C2 » 1) Wrap steel wire (Y) around the roof beam several times, and then thread the steel wire (Y) through the safety cable assembly (X).
2) Wrap steel wire (Y) passing through safety cable assembly (X) around safety cable assembly (X) several times, and then pass the remaining steel wire (Y) through insurance buckle (W) to secure the steel wire (Y).

Step C3 » If needed, shorten the length of fixture wires. At this point, the remaining wire length measured above mounting plate (E) is at least 6".

Step C4 » Make wire connections

Connect wires as shown in the charts below. **PLEASE NOTE THAT GROUND WIRE IS BARE COPPER WIRE, NEVER CONNECT OTHER WIRES TO GROUND WIRES.**

Connect ground wires according to the chart below

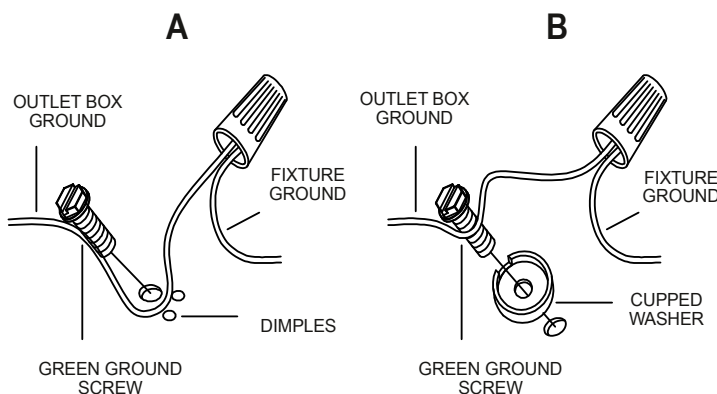

Connect wires according to the chart below

Connect Black or Red Supply Wire to:	Connect White Supply Wire to:
Black	White
*Parallel cord (round & smooth)	*Parallel cord (square & ridged)
Clear, Brown, Gold or Black without tracer	Clear, Brown, Gold or Black with tracer
Insulated wire (other than green) with copper conductor	Insulated wire (other than green) with silver conductor

* Note: When parallel wires (SPT I & SPT II) are used. The neutral wire is square shaped or ridged and the other wire will be round in shape or smooth (see illus.)

Neutral Wire

- **Twist wires together with plastic wire connectors (D) until tightly joined.**
- **Wrap each connector with approved electrical tape.**
- **Be sure that no wire strands are exposed and then carefully tuck all wires into the outlet box.**

Step C5 » Raise canopy (F) to the ceiling and secure canopy (F) in place by tightening knob nuts (G) to threads of mounting plate (E).

Step C6 » 1) Please hang short crystal (S), medium crystal (T) and long crystal (U) one next to the other on holes of frames (O & Q) with crystal hooks (R) as shown in the illustration.
• **Please note that one short crystal (S), one medium crystal (T) and one long crystal (U) as a group.**
2) Install bulbs (not included) (Please do not exceed the maximum wattage recommended on the socket.)

5. Check that everything is installed properly, then you can turn on the light. We hope you enjoy your new lighting!