



9800 Enna Forever Crib



9800 Enna Forever Crib – 2305 Chest – 2306 Double Dresser – *Vintage White*



9800 Enna Forever Crib – 2306 Double Dresser – 2305 Chest – *Vintage White*



Enna Full-Size Bed – 6666 Low-profile footboard –
Vintage White

Finishes

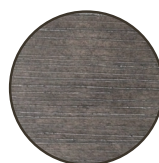

Distressed Granite



Vintage White

Italian Style

- Superior Italian design from 100 years of furniture manufacturing experience
- Cribs convert to toddler beds, child's day beds and full-size beds (rails sold separately)
- Cribs have 3 different mattress height levels
- Most cases have adjustable levelers on front posts/feet
- Nylon glides on cribs and cases to help prevent scratching of floors



Enna Forever Crib – 9800
W:59 x D:31 x H:48.5

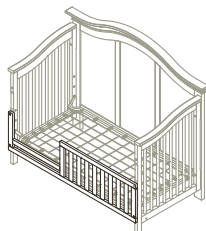

Enna Toddler Rail – 1515
W:59 x D:31 x H:48.5

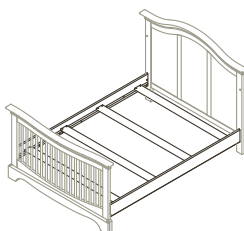

Enna Full-Size Bed Rails – 1216
W:59 x D:80 x H:48.5

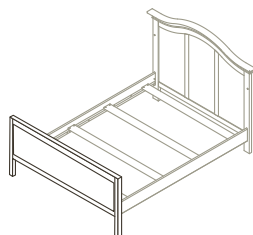

Low-profile Footboard – 6666
W:59 x D:80 x H:48.5

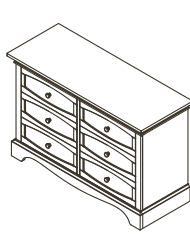

Ragusa Double Dresser – 2306
W:52 x D:20 x H:34.25



Ragusa Chest – 2305
W:36 x D:20 x H:46



Ragusa Nightstand – 2314
W:24 x D:18 x H:24

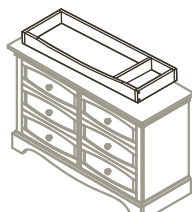

Changing Tray 9900
W:46 x D:19.5 x H:5

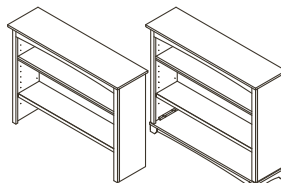

Bookcase Hutch – 5555
W:47 x D:13.5 x H:42/46



Top Quality Manufacturing

- All crib slats made of select solid Radiata Pine for its exceptional strength while being environmentally responsible
- All crib slats are glued and nailed, top and bottom
- All composite wood materials (MDF, particle board or plywood) are certified to meet California and EPA requirements for formaldehyde emissions
- Taller cases feature tip restraint kits
- Drawer boxes with soft-closing, full-extension drawer glides for safety and convenience
- Drawer boxes in solid wood with English dovetail joints (front and back)
- Solid wood corner blocks and supports underneath every drawer box for the best construction



Superior Safety

- JPMA member since 1971
- All cribs and cases are tested to voluntary American Society for Testing and Materials (ASTM) standards
- All products are compliant with Consumer Product Safety Commission (CPSC) recommendations
- Furniture meets or exceeds all mandatory and voluntary standards for all products for both US and Canada
- Every production run is tested to exceed all required lead standards



Commitment to the Environment

- Green Guard Gold Certification
- Solid woods that are sustainably harvested from trusted and reliable sources that are committed to minimizing environmental impact
- Non-toxic finishes regularly tested by independent laboratories
- CARB compliant composite woods certified to meet formaldehyde standards