

WamBam Sturbridge Vinyl Yard & Pool
Gate w/Stainless Steel Hardware
(48" H x 48" W)
(Adjustable Width)



REALLY

^ Important stuff to know about
installing your WamBam gate.



This gate is designed to be integrated with our
WamBam Sturbridge Vinyl Yard & Pool Fence - 4' High.
(This gate can also be used in any opening that is 50" wide or less
by trimming down both the top and bottom rail).

V-2.0

1-877-778-5733
www.wambamfence.com

1 - Read Over Fence Instructions First

Your gate and fence will work better together as an integrated solution if you first take the time to read and understand your fence instructions.

2 - Pre-Assemble the Gate Frame (without pickets)

Please do not screw your gate frame together until you have first temporarily assembled the gate. In other words, do a dry run first.

This will ensure three things:

- a) *That you have everything necessary to complete the gate.*
- b) *That you will have assembled the gate in the correct order.*
- c) *All the pieces fit and function properly.*

It's easier to trouble shoot when things are not screwed together. After you assemble your gate correctly, please disassemble as necessary and use screws to permanently assemble the gate.

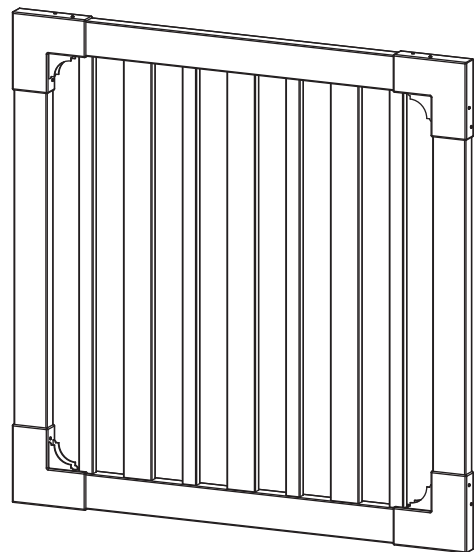

3 - Ideally, Install Your Gate Posts Before Your Fence Posts

Your fence panels will be more forgiving for a custom fit than your gate. Ideally, position and install your gate posts before you do anything else, or very early on in the process of setting up your fence run.

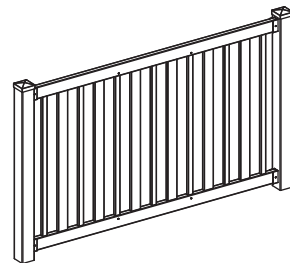
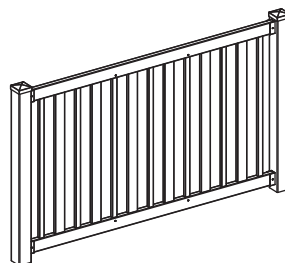

**Install Your Gate Posts
Before Installing Your
Fence Posts.**

4 - Ideally, Do Not Hang Your Gate System Off a Single Non-Supported Post

Your gate will perform better and last longer if your hinge post is connected to a panel of fence which is connected to another post. The weight strain will be transferred unto two posts versus just one. Installing fence panels on both sides of your gate is the ideal in all situations. If this is not possible because of space restrictions, please contact us for alternative solutions to overcome.

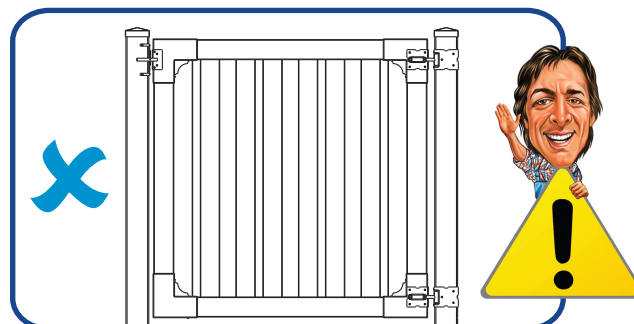
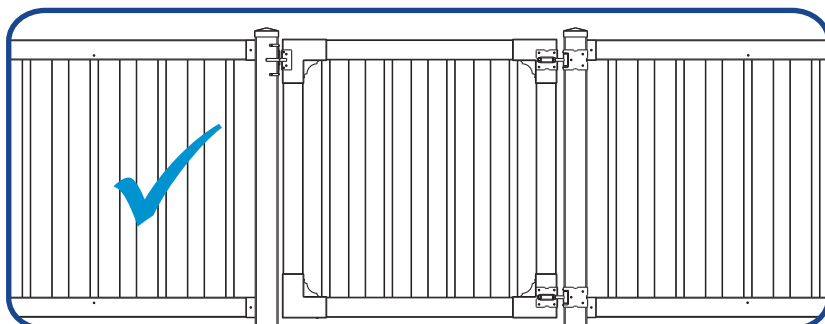

Do Not Hang Gate on Lone Soldier Post.

PRODUCT OVERVIEW

Gate Assembly

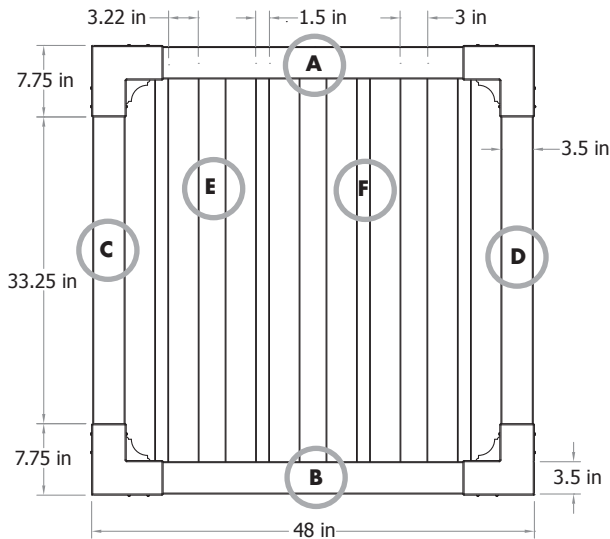

Gate Installation

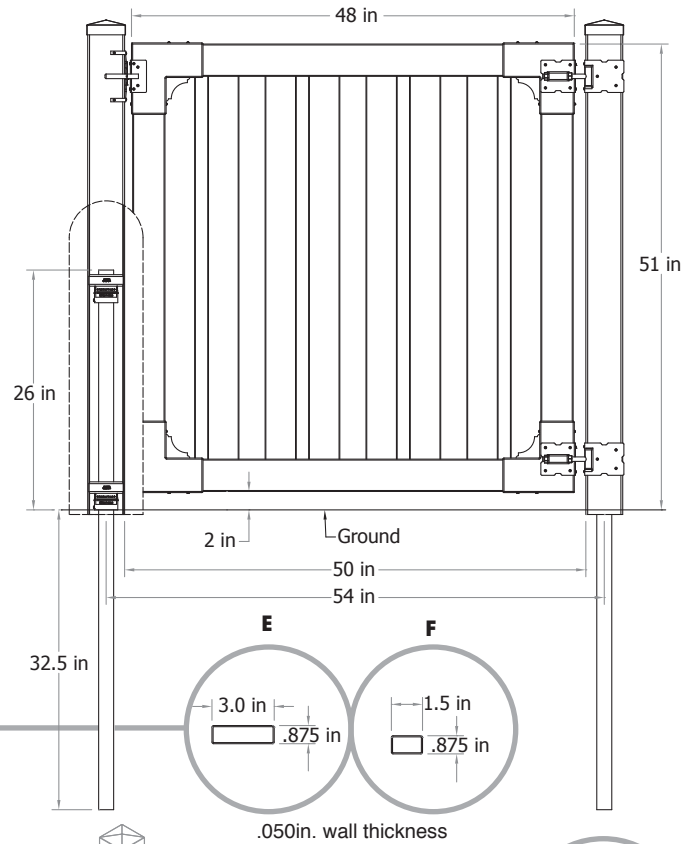

Wall Thickness

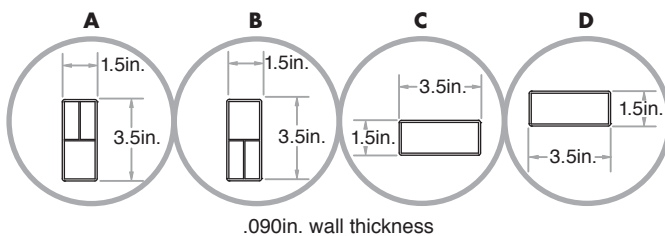

BOX CONTENTS

Each Gate Box Includes:

- Gate Latch (1)
- Vertical Stiles (2)
- Corner Brackets (4)
- Top Rail (1)
- Pickets (7)
- Gate Hinges (2)
- Bottom Rail (1)
- Stainless Steel Screws (20)

Sold Separately:

- 4ft. Post & Pipe Anchor (1-Pack)

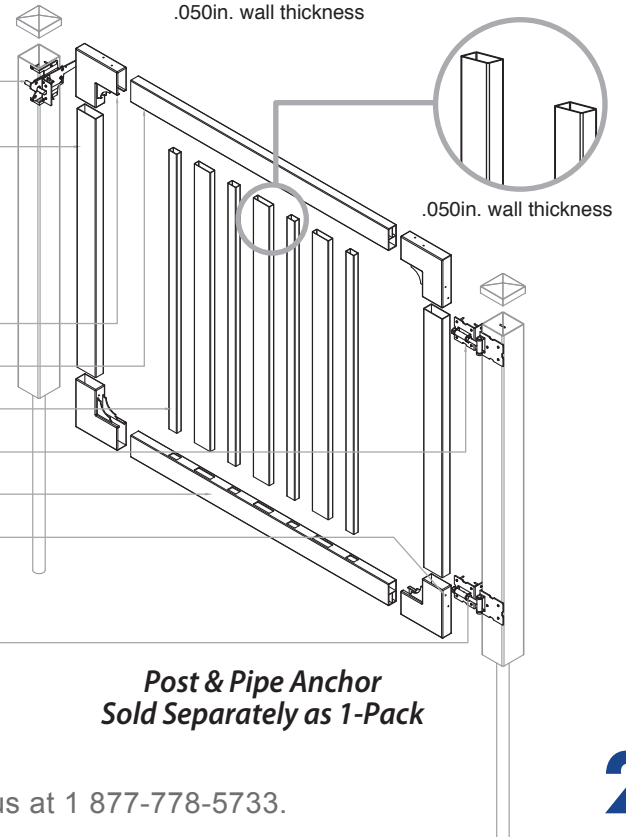

**Post & Pipe Anchor
Sold Separately as 1-Pack**

DETAILED ASSEMBLY INSTRUCTIONS

STEP 1 Assemble the Gate Frame Bottom & Sides

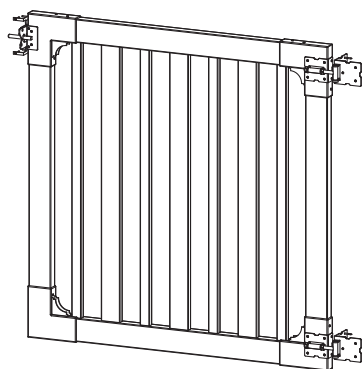

Completely assembled gate shown

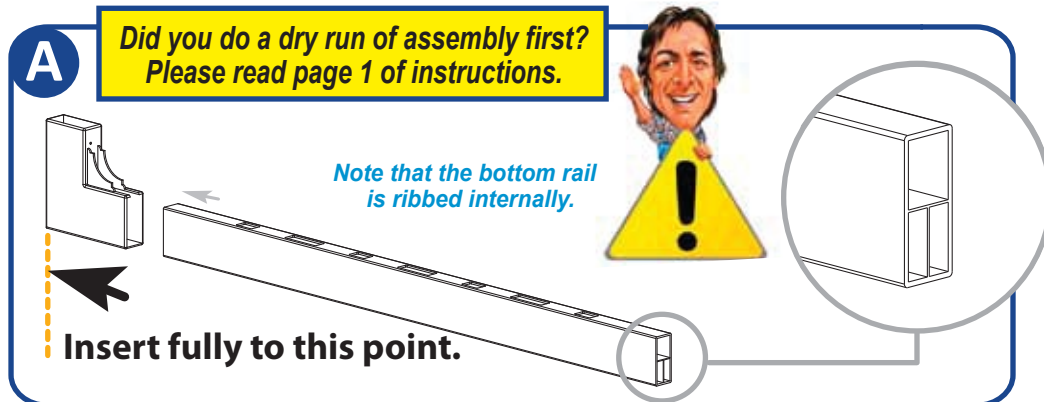

A - Insert the bottom rail **ALL THE WAY** until it **BOTTOMS OUT** inside gate bracket

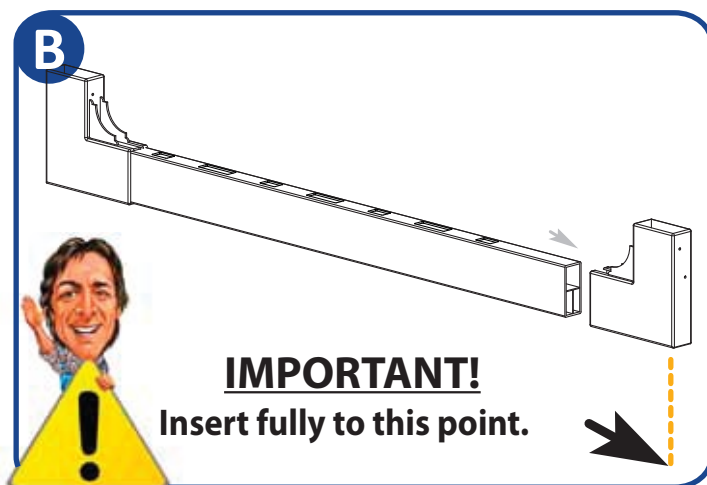

B - Insert the bottom rail **ALL THE WAY** until it **BOTTOMS OUT** INSIDE GATE BRACKET

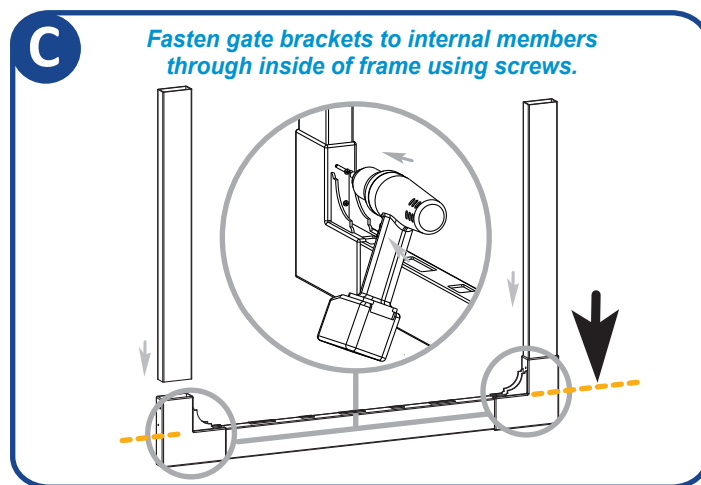

C - Insert vertical gate stiles. They will **BOTTOM OUT** against bottom horizontal rail

STEP 2 Assemble Pickets & Assemble the Gate Frame Top

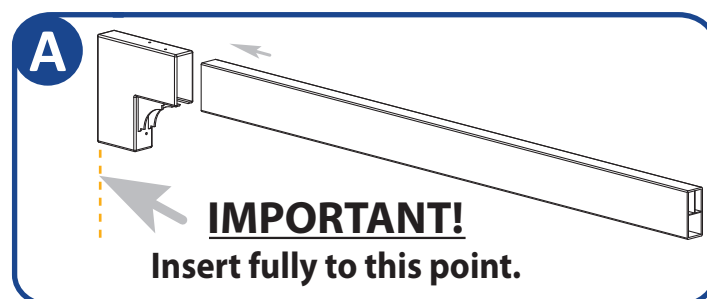

A - Insert top rail **ALL THE WAY** until it **BOTTOMS OUT** inside bracket

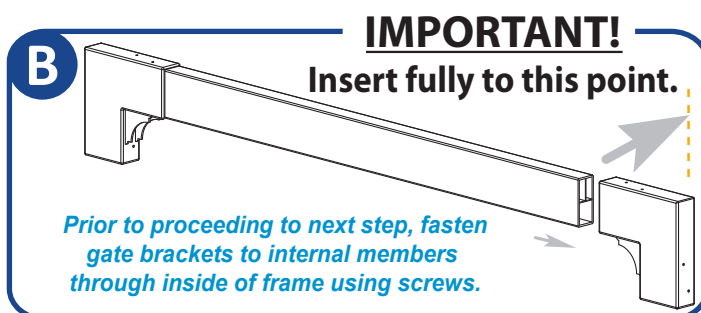

B - Insert rail **ALL THE WAY** until it **BOTTOMS OUT** inside bracket

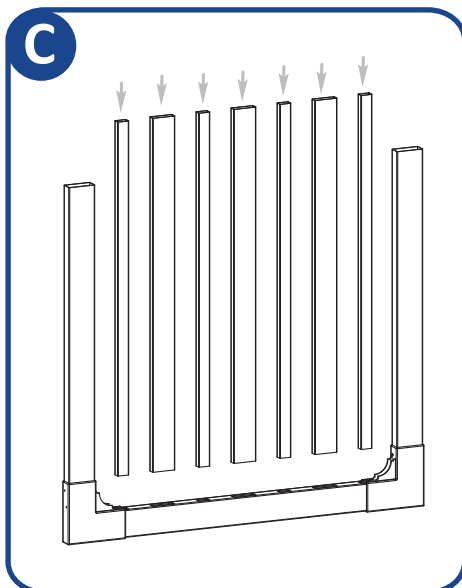

C - Insert pickets in the proper order into the bottom rail

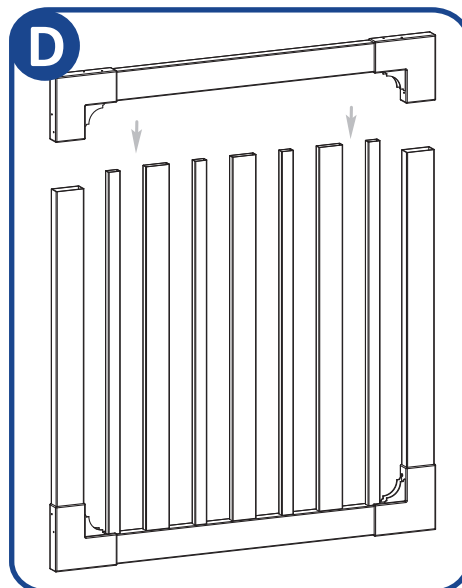

D - Slide top rail with brackets down over the pickets and vertical gate stiles

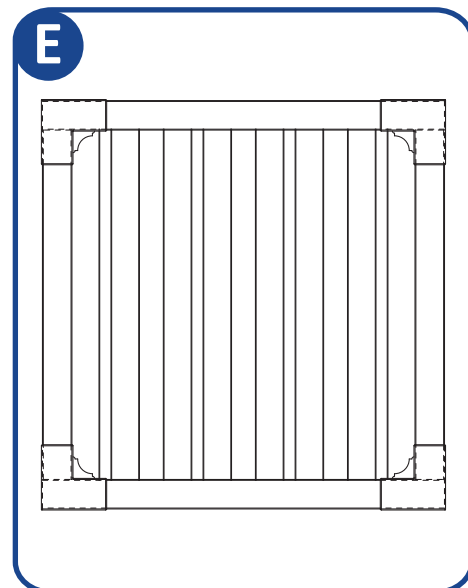

E - Complete assembled gate frame shown

STEP 3 Screw Gate Frame/Brackets

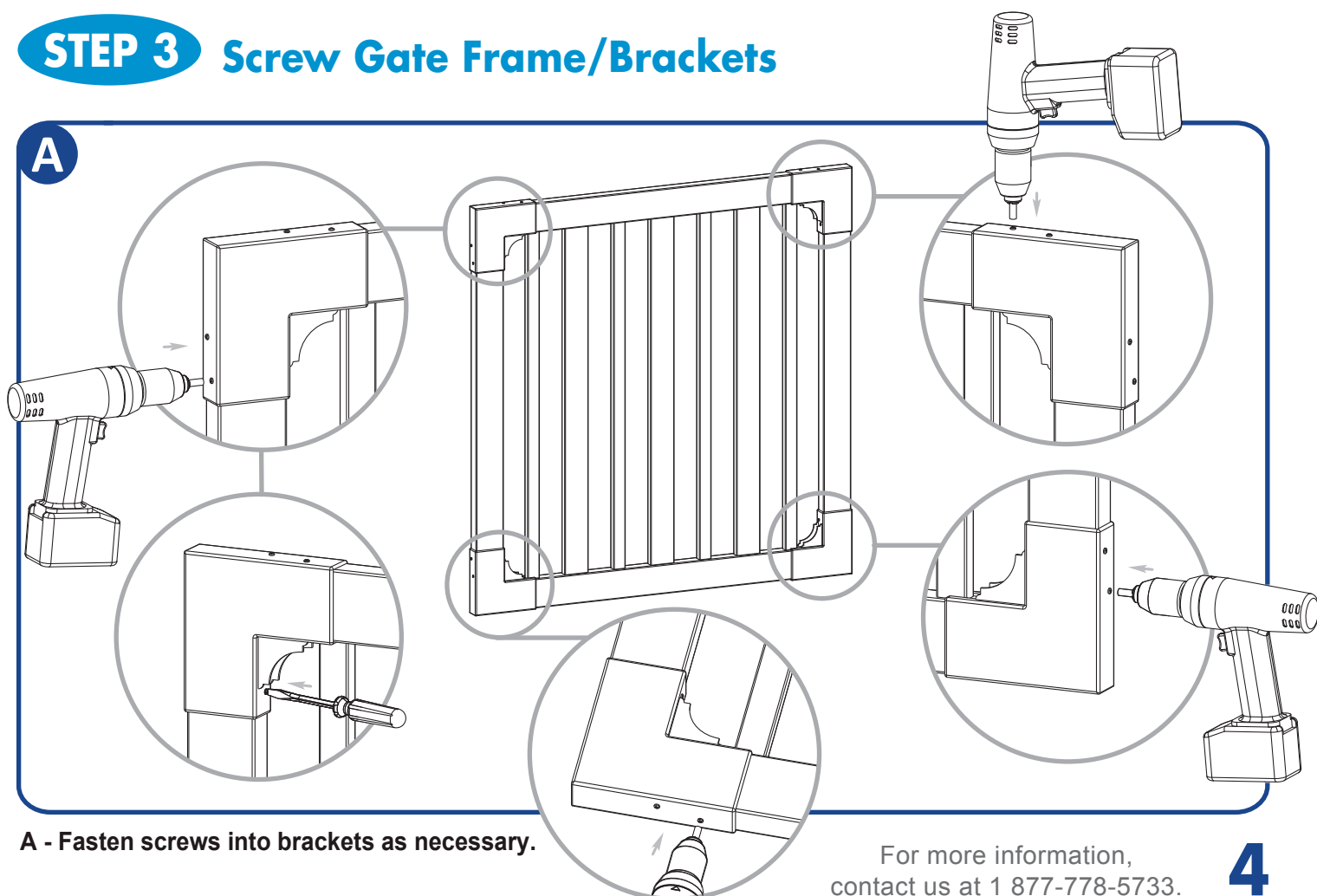

A - Fasten screws into brackets as necessary.

For more information,
contact us at 1 877-778-5733.

STEP 4 Fasten Gate Hinges & Gate Latch

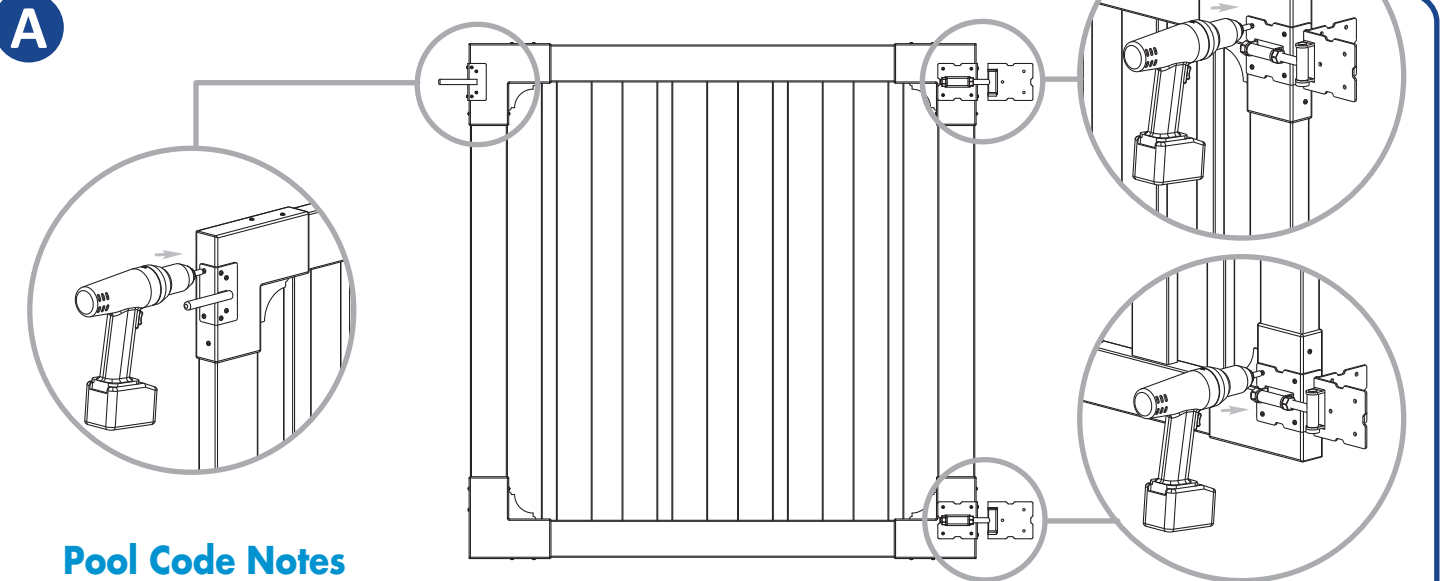

Pool Code Notes



For swimming and other child safety gates, most safety standards specify:

- a) Your fence height needs to be between 4' and 6' high minimum
- b) Your gate needs to open outwards away from the pool
- c) Latch releasing mechanism to be minimum 54" off the ground.

***This gate will require a specialized latching system to meet pool code.
Use MagnaLatch Top Pull Hardware (not included).
Magna Latch Top Pull Code is # MLTPS2BGA.**

***Always confirm these and other requirements with the appropriate authorities in your area.
Code will change from one location to another across the country.**

A - Fasten gate hinges and gate latch onto the gate brackets with screws.

STEP 5 Position, Adjust & Algn Gate/Secure Hinges to Posts

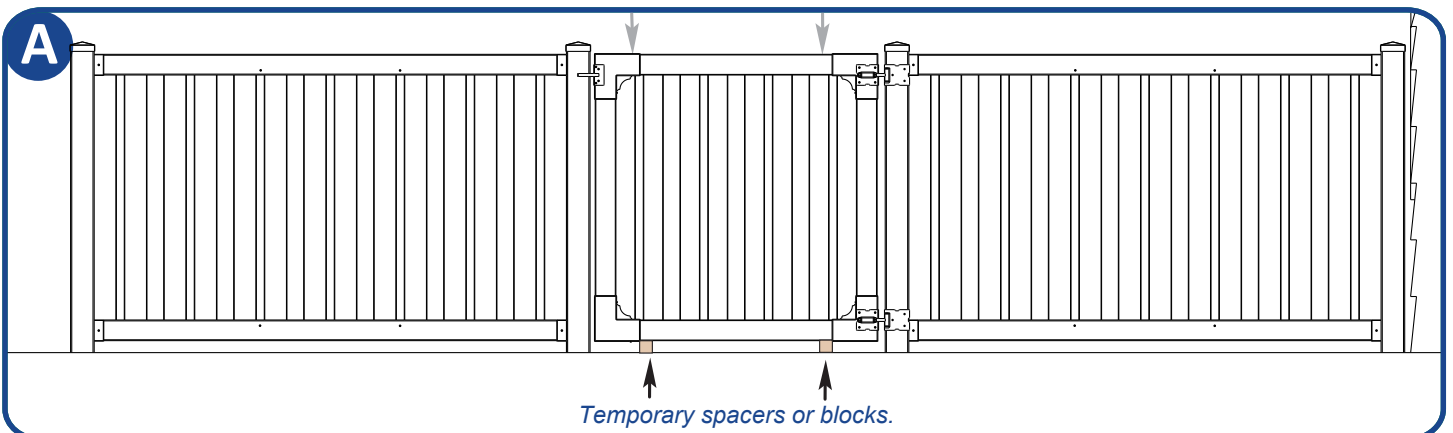

A - Use temporary spacers or blocks to rest the gate on during alignment and installation

For more information, contact us at 1 877-778-5733.

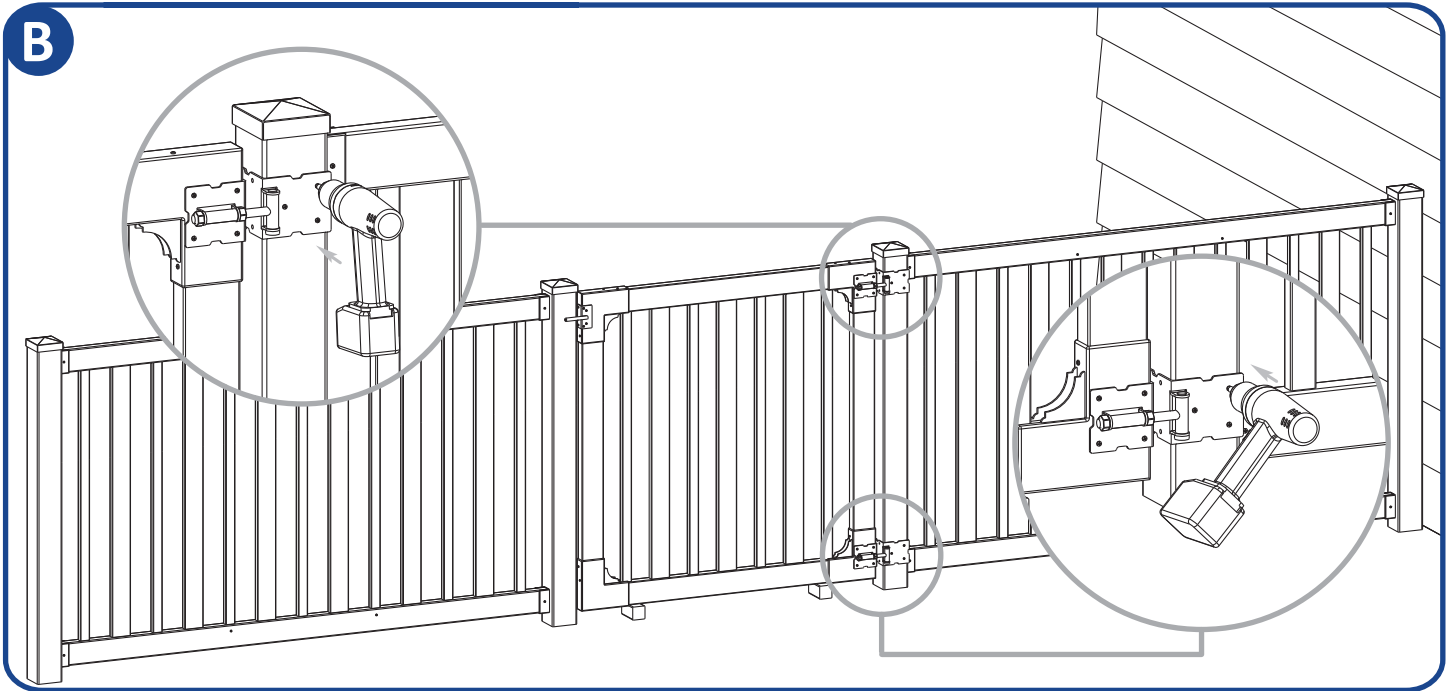

B - Fasten hinges to post with screws

STEP 6 Level Gate & Adjust Hinges

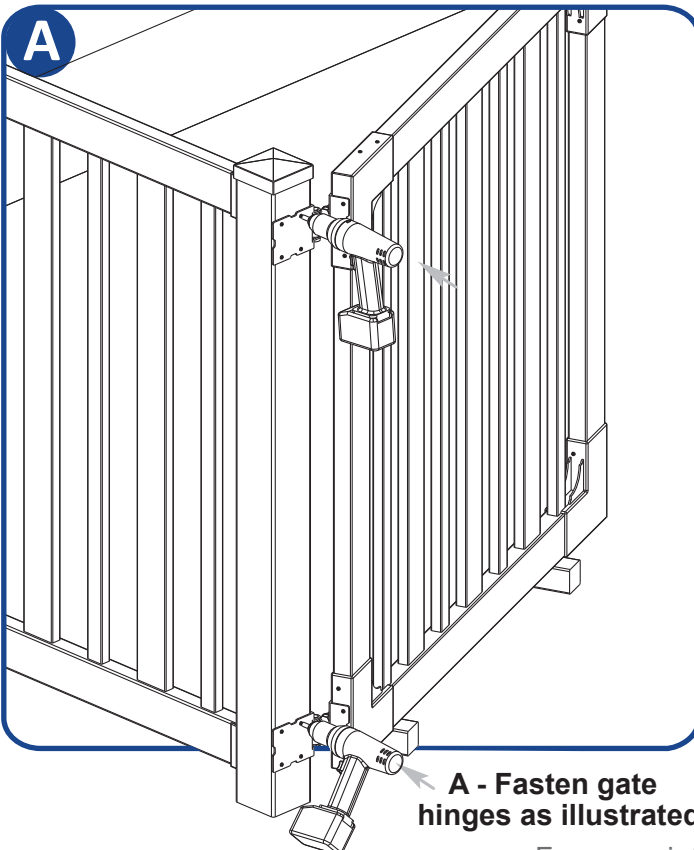

A - Fasten gate hinges as illustrated.

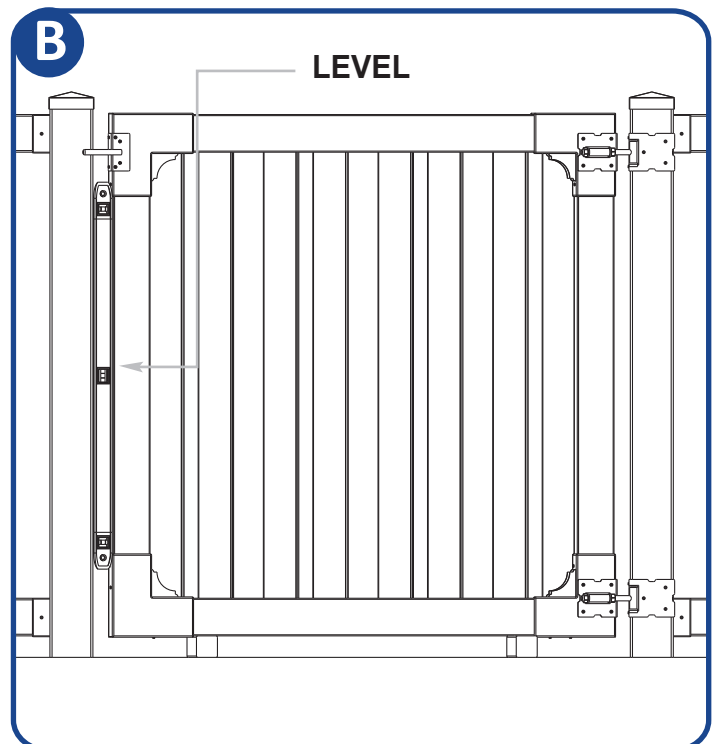

B - Check for level, fit and function to latching post

For more information, contact us at 1 877-778-5733.

WamBam Sturbridge Vinyl Yard & Pool Gate w/Stainless Steel Hardware

WamBam FENCE



C - Hinges can be adjusted moderately to bring gate into level alignment with post

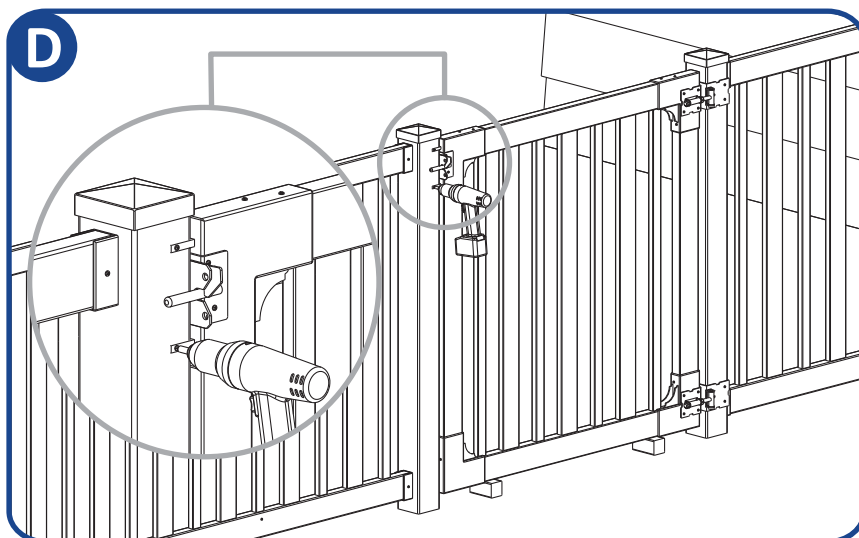

D - Latch is designed for left and right hand applications. Temporarily remove the spring, bolt and reverse paddle portion as necessary.

STEP 7 Align & Install Latch

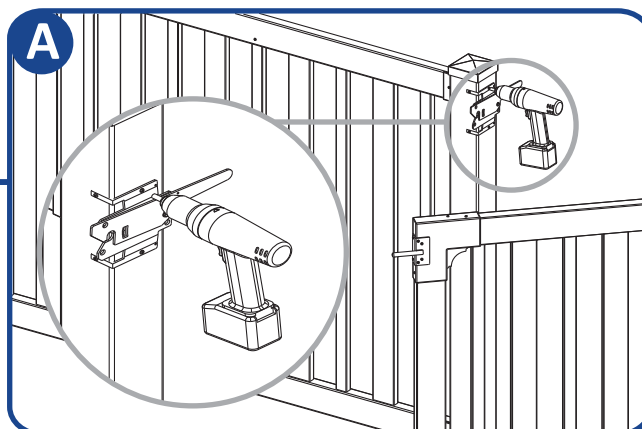

A - Align and fasten the gate latch catch to fit and function with the gate finger.

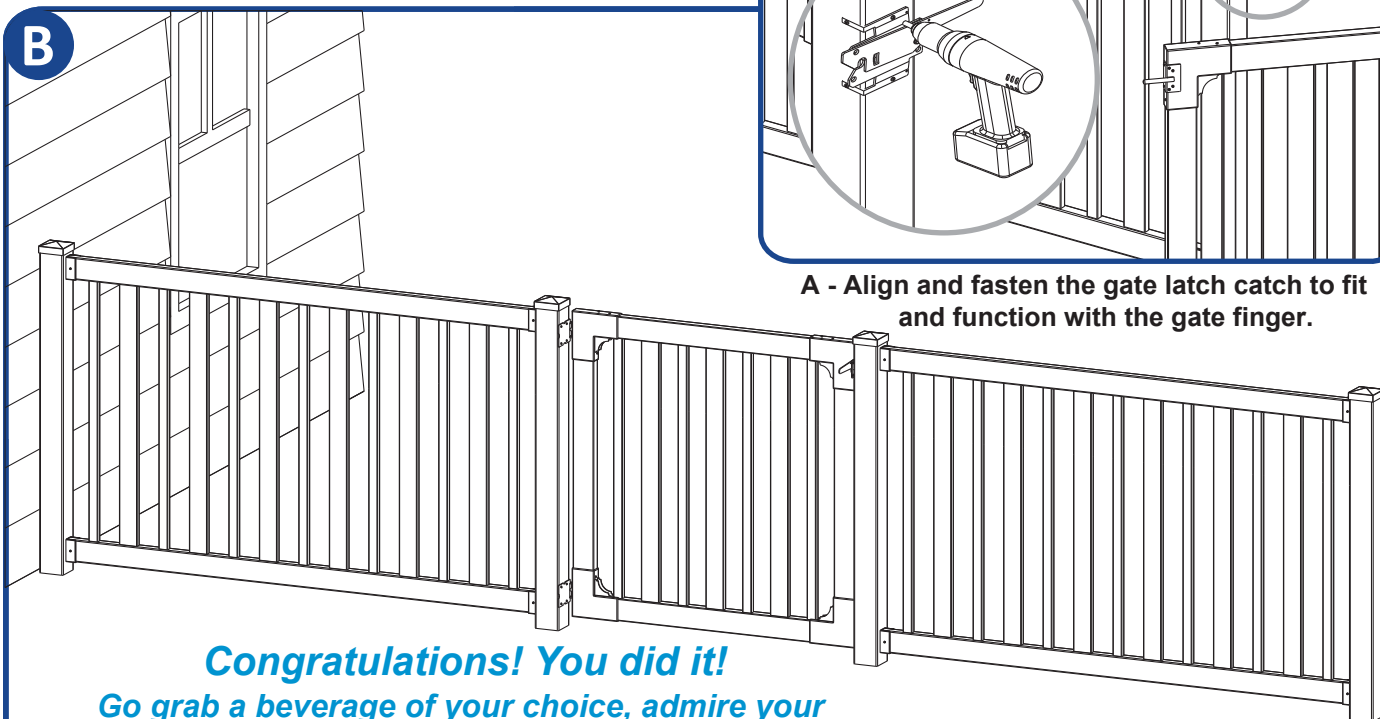

Congratulations! You did it!
Go grab a beverage of your choice, admire your handy work, and show us what you got by entering our annual photo/video contests!