

# Assembly instruction

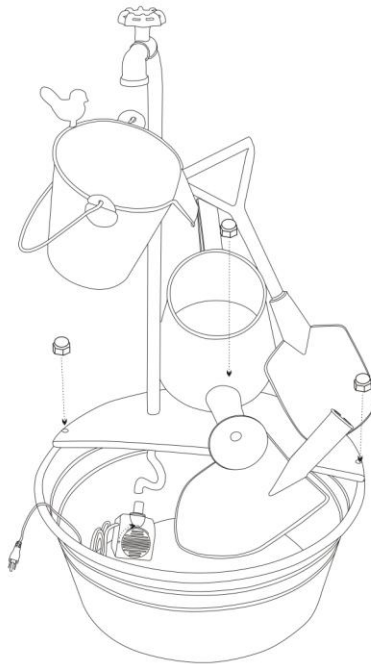
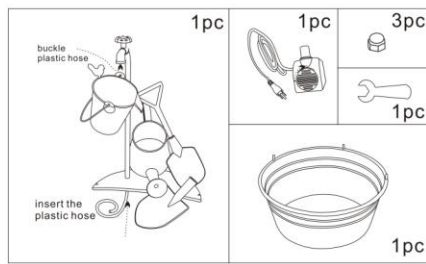

## IMPORTANT SAFETY INSTRUCTIONS

When using electric products, basic precautions should always be followed including the following:

**READ AND FOLLOW ALL SAFETY INSTRUCTIONS.**

1. Before using, be sure the water level is 1/2 way full or more in the base.
2. Make sure water is clean and free from debris.
3. When not in use, empty water from base and unplug.
4. Keep the pump power cord away from high temperatures.
5. Keep out of reach from children and pets.
6. Always make sure fountain is on a steady, level surface when in use.
7. Fountains are frost-resistant up to -4°F (-20°C) but pump must be removed from fountain during freezing temperatures. If fountain must be left outside and temperatures drop below -4°F (-20°C):
  - (a) Remove pump for storage indoors.
  - (b) Raise fountain base from ground with wood strips so that base will not freeze to the ground surface.
  - (c) Cover or wrap the fountain with burlap or other absorbent material (old blanket or towel) and then cover securely with plastic, making sure that water will not accumulate in the basin or other fountain component and freeze.
  - (d) Check fountain periodically to insure that plastic is secure and water is not accumulating in any fountain component.