

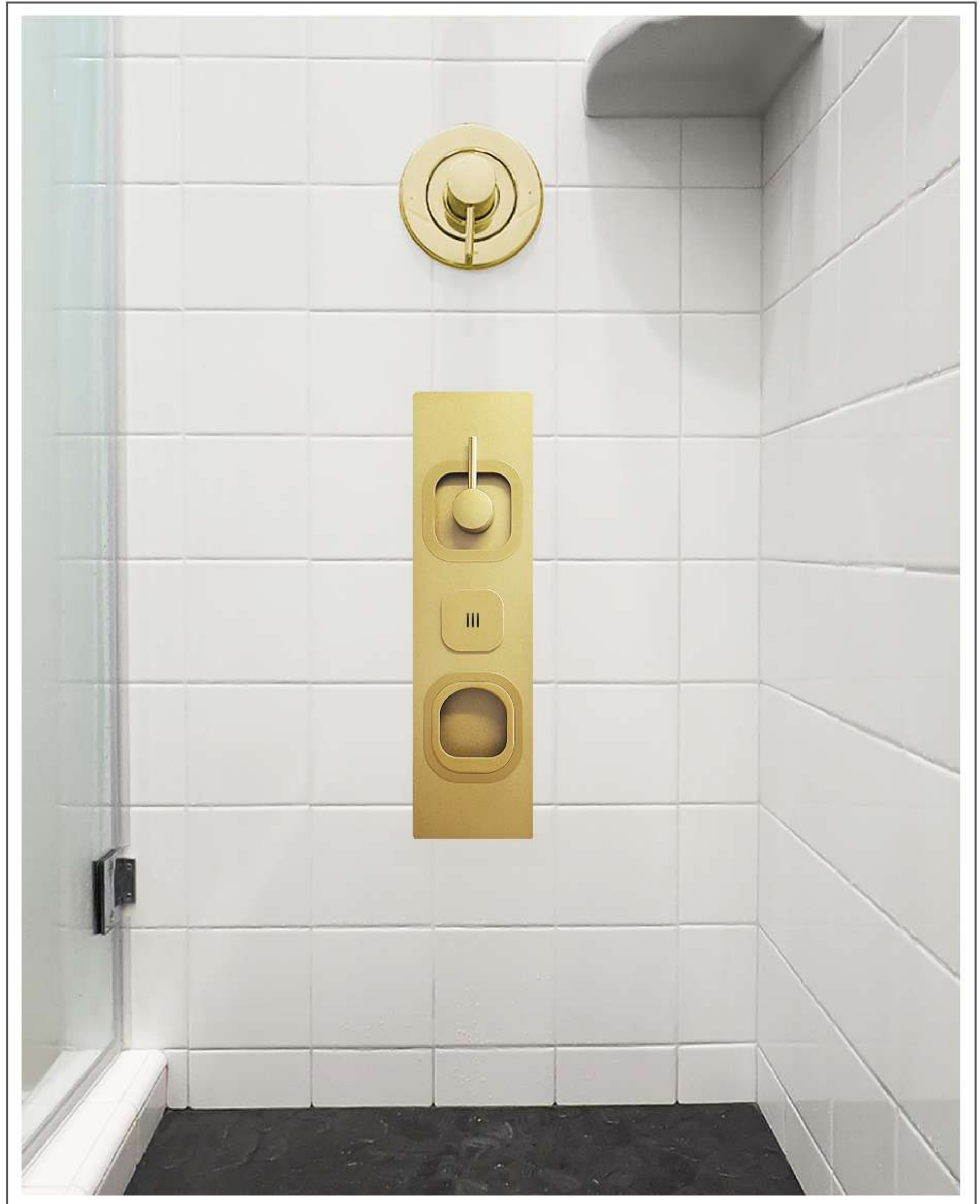

# USER GUIDE

## Solar Flare - Revive



Serene Steam is in compliance with the Uniform Plumbing Code IAPMO - IGC- 154-2019 Standard, including product certification.

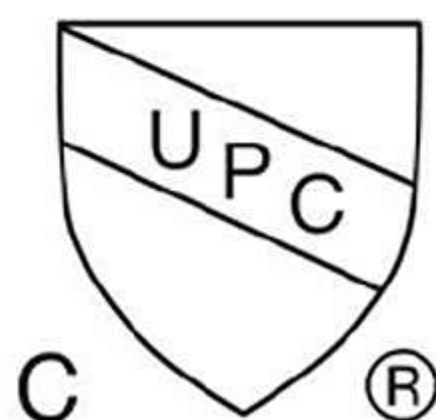



**PLEASE READ**  
**PRODUCT DISCLAIMER ON BOTH PAGES**  
**BEFORE USE**



Serene Steam is not a medical device in any way, and it is not intended to diagnose, treat, cure or prevent diseases. If any physical, mental or other personal condition is present or persists, contact a doctor before use. We also recommend that you do not rely solely on the information presented in this manual and/or anywhere displayed by Serene Steam and that you always read disclaimers, warnings, and directions before using or purchasing a product.

Serene Steam is a heat producing appliance. Therefore, you should always consult your doctor or physician before using Serene Steam so you can be sure that you do not have any condition which may cause harm during use.

All sample images of use described in this manual are merely examples of what's possible with Serene Steam and should not be taken as any direction, nor instruction to do so. Serene Steam produces moist heat and hot water vapors, so any position you decide to place yourself within its environment should first be recommended and confirmed by a physician to make sure the features and sample uses of Serene Steam are not harmful to you in any way. If you are sitting on a shower bench during use, it is always recommended to stand up slowly during or after use due to hot vapor/steam exposure. Please be aware that the use of Essential Oils may also have an effect on one's reaction. Always position yourself in a comfortable distance from the system (not closer than approximately 12 inches) to experience the moist heat infused with Essential Oils.



## DISCLAIMER CONTINUED



Elderly persons and/or those in poor health, or with a heart condition, high blood pressure or diabetes, must not use Serene Steam devices unless otherwise directed by your physician. Should you have any other condition which requires medication of any type, you must also check with your doctor before using Serene Steam. All bathers, or steam bath users should ask their doctor for the estimated time recommended for using a steam shower product. Never use Serene Steam while under the influence of alcohol, prescription medication, or any other drugs without checking with a doctor as this could be a serious hazard to your health.

***Should you become dizzy, faint, or drowsy or experience any other uncomfortable feeling or sensation, immediately exit the steam shower.***

Please be extra aware that the flooring or other surfaces in your Serene-Steam environment may become slippery and dangerous to use. Make sure that all floor materials are non-slip and that any additional equipment, such as shower mats, are certified non-slip. This includes any foot-ware that you may be wearing upon entering the Serene Steam shower.

Never make direct contact with the steam or hot water vapor coming out of the steam opening during use, as this could cause burns or physical harm. Make sure you are not allergic to Essential Oils in any way before use. Children under the age of 18 should not use Serene Steam, unless supervised by an adult.

*By using Serene Steam, you indemnify Serene Steam, its affiliates or any associated entity from any lawsuit or action should any bodily harm result from the features offered or used by Serene Steam. The primary feature of Serene Steam is the production of moist heat, which can turn your shower enclosure into a convenient personal steam room and/or spa.*



# RECOMMENDED STEPS TO FOLLOW

## A favored routine to maximize your relaxation during spa use



All steam spa's can take some time to heat up your environment. Here is a popular technique to prepare your shower enclosure prior to using Serene Steam. Warm up your body and shower enclosure first by having a regular shower for a few minutes, this may relax you, and warm up your enclosure faster. This is a good technique to make your environment ready for a calming, & therapeutic spa experience. Colder weather months may take slightly longer to heat up your shower enclosure, this is normal with most steam shower systems.

## Bathroom extractor fans and air conditioning during spa use

Air conditioners

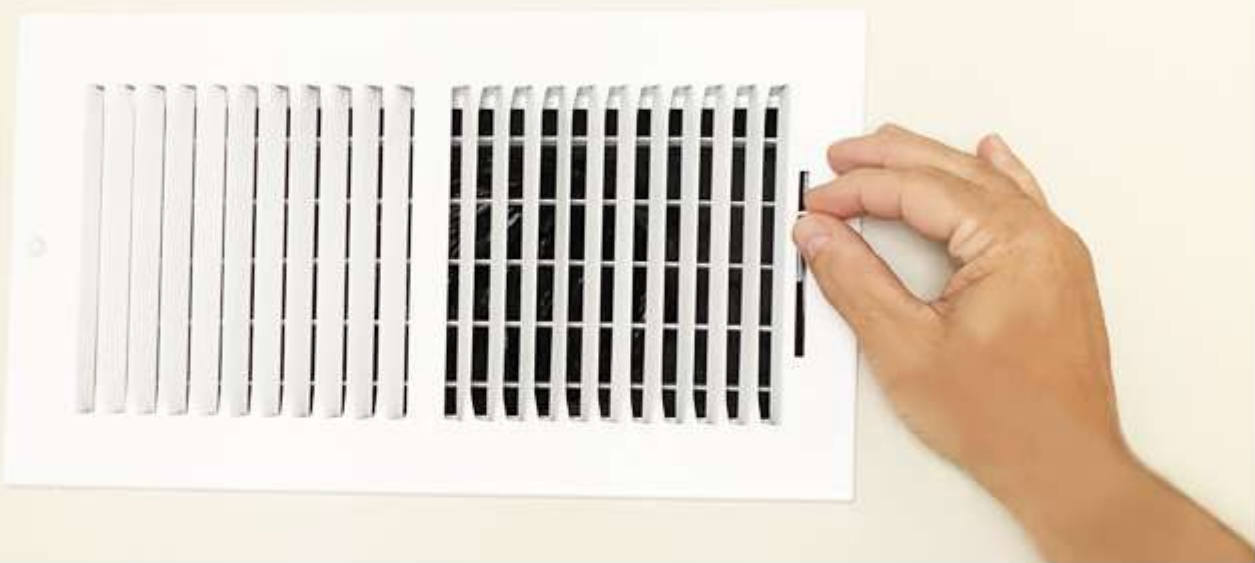

It is recommended to close your air conditioning vents if the air is flowing in your bathroom **while using Serene Steam**. If your vents cannot close, switch off the air conditioning during spa use.

Extractor fans



If your extractor fan is installed **inside your shower enclosure**, it is not recommended to have it functioning during spa use, as it will extract the steam and heat.



# PRODUCT FEATURES

Please become familiar with the features before use



On - Off control valve. Opening and closing this valve controls the amount of steam/hot vapor flow. **Do not** pull this valve forwards, it functions only by turning it left or right to open or close. Insert your essential oils into this opening as described later.

Air flow vent. Does not have any user function.

Here is where the steam/hot vapor will flow.

Please scan this QR code with your mobile phone to see how Serene Steam functions.



When the product is in use you will notice an amount of steam/hot vapor flowing from this opening as shown. The flow will feel similar to a fan blowing hot air and steam/hot vapor simultaneously. **Please note that it is normal for mild water droplets to appear here during use.**



# AROMATHERAPY & ESSENTIAL OILS

When using the aromatherapy feature to enhance your steam spa experience, **it is required** to use a bottle dropper to release a desired amount of quality essential oils into the Serene Steam system during use. [Please do not attempt to add essential oils directly from the bottle.](#)

## Mixing your own essential oils

Prior to use, initially pour an amount of essential oils into the empty glass bottle provided. Use the stainless steel mini funnel for pouring, and repeat this step to create your own blend of oils.

An empty bottle with dropper is included with all Serene Steam systems.



**We recommend** testing the strength of the aromatherapy **prior** to regular use.

Test the strength by adding only a few drops of essential oils into the Serene Steam system during spa use (one or two drops initially).

Increase, or decrease the amount of essential oil to reach a desired comfort.



# AROMATHERAPY & ESSENTIAL OILS

Using aromatherapy during steam spa use

**Please use quality, and pure essential oils only**

1. Release the essential oils from the dropper directly inside the opening which surrounds the Serene Steam control handle. Insert the dropper as far as it will go as shown.
2. Only release essential oils into the system once the steam is flowing. Repeat as desired during use.

**Do not** release essential oils into any other area of the Serene Steam system.





## PRODUCT MAINTENANCE

**There is no general maintenance required**, other than replacing the mesh filter inside the threaded water line connection to prevent any sediment from entering the system. **Replace every 18 months.**



**It is recommended** to make a note of your Serene Steam's first use-date so you'll know when to replace the mesh filter.

Replacement mesh filters are available from Serene Steam: **[www.SereneSteam.com](http://www.SereneSteam.com)**.

**Replacing the mesh filter is simple, but it is required to be performed by a qualified plumber only**



### Step 1

**Using the provided tool only**, gently manoeuvre the metal blade between your tiled wall and the top of your trim as shown.

With a slow, and gentle cutting motion, loosen the small amount of silicone behind the trim. The location of the cured silicone should be in the center, and close to the edge. Repeat this step at the bottom of your trim as well, until it is loosened, and able to be removed.

### NOTE:

During your initial installation, the install guide detailed the correct process for stabilizing the trim with a small amount of silicone at the top and bottom only, so removing the trim should be simple.



# PRODUCT MAINTENANCE

## Step 2

Once the trim has been removed from the rough-in, **close the shut-off valve inside the rough-in.**

Disconnect the water flex line from the back of the trim as shown.



The mesh filter is now accessible.

## Step 3

Remove the old mesh filter with the tool provided only, and replace with a new one. Insert the new filter firmly inside the threaded connection as shown.



Mesh filter

## Step 4

Re-attach the water flex line to the trim & open the shut-off valve.

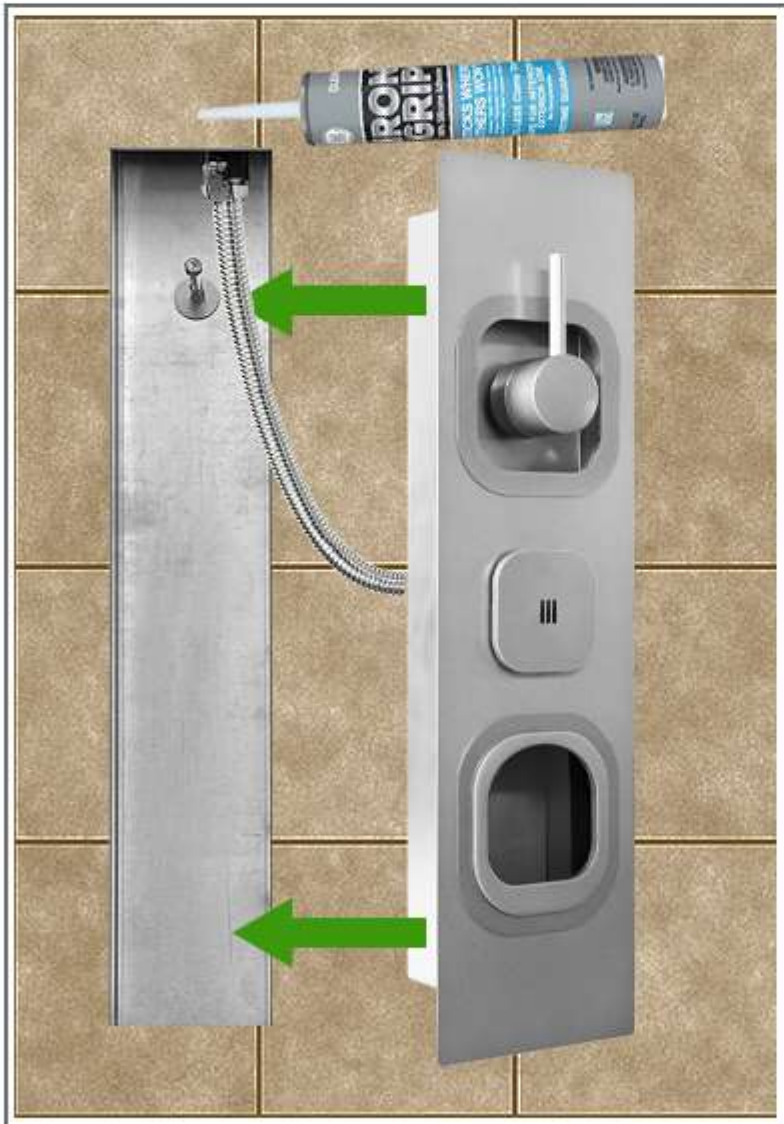

Re-attach your trim to the rough-in and apply a **VERY THIN** amount of silicone at the top and bottom only as shown.



# GENERAL TROUBLESHOOTING

 Problem or issue	 Possible cause	 Possible remedy
Everything is connected but the system will not operate.	There is an overriding shut off valve inside, and at the top of the rough-in part.	Make sure that the shut off valve is in the open position when the system is correctly, and completely connected ready for use.
Steam/hot vapor flow does not seem to be flowing.	There may be a kink in your water flex line connecting the main system to the rough-in.	Gently remove the main system and check that the stainless steel flex water line is not bent, which will prevent flow.
There is steam but it does not feel hot enough.	Your water heater may not be set to the correct temperature.	Set heater to 140 degrees F for best results. During colder weather months, heat up your shower environment first by taking a regular shower prior to using Serene Steam.
I can't smell the essential oils during use.	You may be using a non-compatible essential oils dropper, or you are not using the <b>supplied</b> dropper correctly.	Only use the supplied essential oils dropper and follow detailed instructions as described earlier in this manual.
There is a excessive splashing coming out of the steam exit.	A small amount of splash is normal and will continue throughout use. The splash should be mild and almost unnoticeable after a short period during use.	Make sure that your household water pressure has an updated water regulator. Water regulators are required in every household and should be set correctly to Approximately 50 - 60 PSI.
I notice small droplets of water at the bottom of the flow exit.	The small amount of water droplets which may accumulate at the bottom of the flow exit is normal.	N / A



## CLEANING SERENE STEAM



Please take care when using, and cleaning your Serene Steam Spa system. **Gently** polish the unit if desired using the included **micro fiber cloth only**. **NEVER** use an abrasive cloth to clean your system.

We recommend ***MILSEK stainless steel cleaner***. Cleaner is not included with your Serene Steam purchase but is available from numerous on line retailers.



**PRODUCT WARRANTY  
AND SUPPORT**

**5**  
YEARS

***There are no*** user-serviceable parts on Serene Steam. Should you become aware of a change in product performance please contact **your distributor** and a Serene Steam technical support member will contact you.

**SereneSteam.com**

1 (877) 783-2614 (Corporate) - [info@serenesteam.com](mailto:info@serenesteam.com)





Version 3.0