

READ AND SAVE THESE INSTRUCTIONS

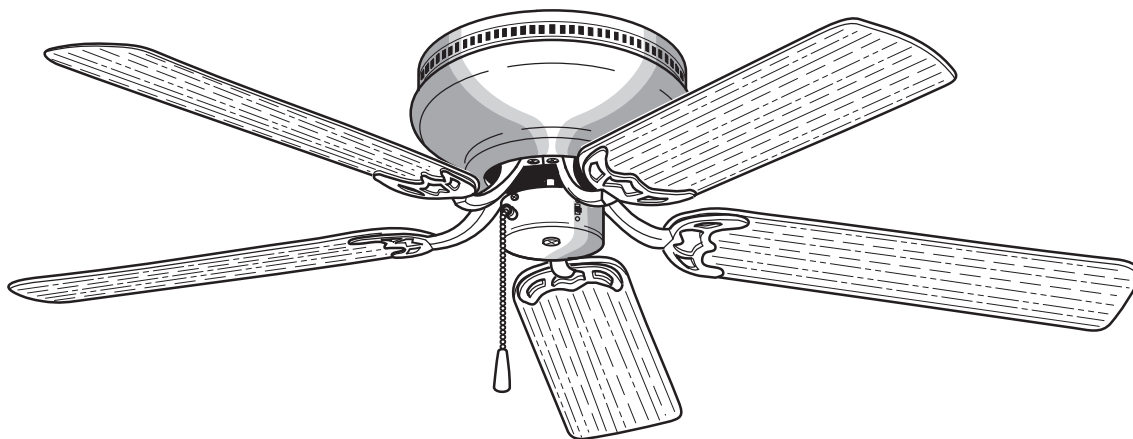

EMERSON™



SNUGGER

Ceiling Fan Owner's Manual

52" Model Numbers

CF805SBS02 - Brushed Steel
CF805SORB02 - Oil Rubbed Bronze
CF805SWW02 - Appliance White

Net Weight: **13.9** Lbs.

42" Model Numbers

CF804SBS02 - Brushed Steel
CF804SORB02 - Oil Rubbed Bronze
CF804SWW02 - Appliance White

Net Weight: **11.2** Lbs.

Questions, problems, missing parts: Before returning to the store
call Customer Service 8 a.m. - 6 p.m., Eastern, Monday-Friday

1-800-654-3545

www.emersonfans.com

Table of Contents

Section	Page	Section	Page
Safety Instructions	2	6. Using Your Ceiling Fan	8
1. Unpacking Instructions	3-4	7. Maintenance	8
2. Electrical Requirements	4	8. Accessories	9
3. How to Hang Your Ceiling Fan	5	9. Troubleshooting	9
4. How to Wire Your Ceiling Fan	6	10. Repair Parts	10
5. Ceiling Fan Assembly	7	Ceiling Fan Limited Warranty	11

READ AND SAVE THESE INSTRUCTIONS

Safety Instructions

WARNING

TO REDUCE THE RISK OF FIRE, ELECTRICAL SHOCK, OR INJURY TO PERSONS, OBSERVE THE FOLLOWING:

- Use this unit only in a manner intended by the manufacturer. If you have questions, contact the manufacturer.
- Before servicing or cleaning unit, switch power off at service panel and lock service panel disconnecting means to prevent power from being switched on accidentally. When the service disconnecting means cannot be locked, securely fasten a warning device, such as a tag, to the service panel.

- Read your owner's manual carefully and keep it for future reference.
- Be careful of the fan and blades when cleaning, painting, or working near the fan. Always turn off the power to the ceiling fan before servicing.
- Do not put anything into the fan blades while they are turning.
- Do not operate reverse switch until fan blades have come to a complete stop.

Additional Safety Instructions for Installation

- To avoid possible shock, be sure electricity is turned off at the fuse box before wiring, and do not operate fan without blades.
- All wiring must be in accordance with the National Electrical Code "ANSI/NFPA 70-2017" and Local Electrical Codes. Use the National Electrical Code if Local Codes do not exist. The ceiling fan must be grounded as a precaution against possible electrical shock. Electrical installation should be made or approved by a licensed electrician.

- The outlet box and joist must be securely mounted and capable of reliably supporting at least 50 pounds. Use only U.L. outlet boxes listed as "Acceptable for Fan Support of 22.7kg. (50 lbs.) or less", and use the mounting screws provided with the outlet box. Most outlet boxes commonly used for support of light fixtures are not acceptable for fan support and may need to be replaced. Consult a qualified electrician if in doubt.

CAUTION

To reduce the risk of injury, install the fan so that the blades are at least 7 ft. (2.1m) above the floor.

- The downrod furnished with the fan provides the minimum recommended floor to fan blade clearance for an 8 foot ceiling.
- Follow the recommended instructions for the proper method of wiring your ceiling fan. If you do not know enough about electrical wiring, have your fan installed by a licensed electrician.

NOTE: This fan is suitable for use with solid-state speed controls.

WARNING

To reduce the risk of electrical shock, this fan must be installed with an isolating wall control/switch.

This product is designed to use only those parts supplied with this product and/or any accessories designated specifically for use this product. Substitution of parts or accessories not designated for use with this product by Emerson could result in personal injury or property damage.

To reduce the risk of personal injury, do not bend the blade flange when installing the blade flanges, balancing the blades or cleaning the fan. Do not insert foreign objects in between rotating fan blades.

1. Unpacking Instructions

⚠ WARNING

Do not install or use fan if any part is damaged or missing. Call Toll-Free:

1-800-654-3545

⚠ WARNING

This product is designed to use only those parts supplied with this product and/or any accessories designated specifically for use with this product. Substitution of parts or accessories not designated for use with this product by Emerson could result in personal injury or property damage.

1.1

Check to see that you have received the following parts:

NOTE: If you are uncertain of part description, refer to exploded view illustration.

HARDWARE CONTENTS

Part	Description	Quantity
1	Wire Connectors, 12 ga.	3
2	M5 x 6mm Phillips Washer Head Screws	16
3	M5 x 10mm Phillips Pan Head Screws with Internal Tooth Washers	5
4	1/4" Hex Locknuts	4
5	Wood Pendant with Chain	1
6	Chain Coupling	1
7	CF804S ONLY: M5 x 13mm Phillips Pan Head Screw with Lockwasher	1
8	CF805S ONLY: M6 x 14mm Phillips Pan Head Screw with Lockwasher	1

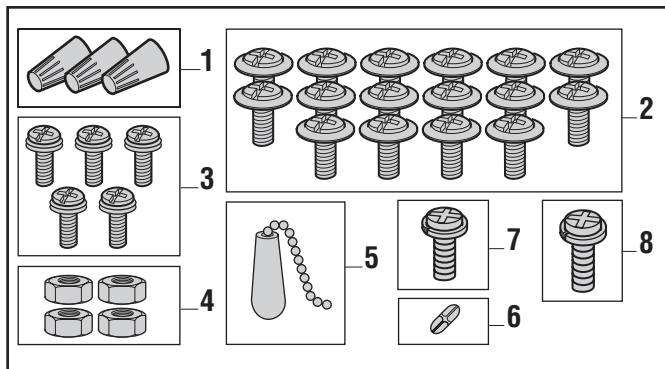

NOTE: Place the parts from the loose parts bags in a small container to keep them from being lost. If any parts are missing, call 1-800-654-3545 for replacement parts before proceeding.

PACKAGE CONTENTS

Part	Description	Quantity
A	Fan Motor Assembly	1
B	Mounting Plate	1
C	Fan Housing	1
D	Flange Sets	5
E	Blade Sets	5

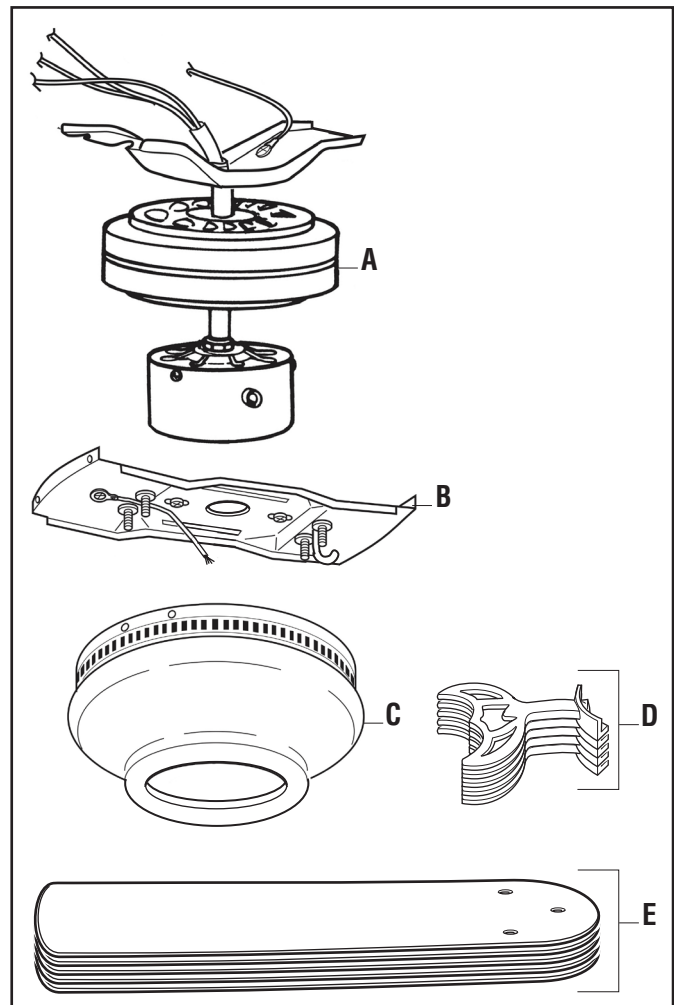

1.2

Remove the Fan Motor Assembly from the protective plastic bag.

Place the Fan Motor Assembly into the upper foam pad with the Wires up.

1. Unpacking Instructions (Continued)

This Manual Is Designed to Make it as Easy as Possible for You to Assemble, Install, Operate and Maintain Your Ceiling Fan

Tools Needed for Assembly

One Phillips Head Screwdriver One Stepladder
One 1/4" Blade Screwdriver One Wire Stripper

Materials

Wiring outlet box and box connectors must be of type required by the local code. The minimum wire would be a 3-conductor (2-wire with ground) of following size:

<u>Installed Wire Length</u>	<u>Wire Size A.W.G.</u>
Up to 50 ft.	14
50-100 ft.	12

WARNING

Before assembling your ceiling fan, refer to section on proper method of wiring your fan (page 6). If you feel you do not have enough wiring knowledge or experience, have your fan installed by a licensed electrician.

This Ceiling Fan may be used with the following Accessories (Purchased Separately): SW46 4-Speed Slide Wall Control, SW90 Fan & Light Dual Slide Wall Control and LED Light Fixtures.

2. Electrical Requirements

Your new Ceiling Fan will require a Grounded Electrical Supply line of 120 Volts AC, 60 Hz, 15 Amp Circuit.

WARNING

To reduce the risk of fire, electric shock, or personal injury, mount fan to outlet box marked "Acceptable for Fan Support of 22.7 kg. (50 lbs.) or less", and use screws supplied with outlet box. Most outlet boxes commonly used for support of light fixtures are not acceptable for fan support and may need to be replaced. Consult a qualified electrician if in doubt.

WARNING

Turning off wall switch is not sufficient. To avoid possible electrical shock, be sure electricity is turned off at the main fuse box before wiring. All wiring must be in accordance with National and Local codes and the ceiling fan must be properly grounded as a precaution against possible electrical shock.

The Outlet Box must be securely anchored and capable of withstanding a load of at least 50 pounds.

If your Fan is to replace an existing ceiling light fixture, turn Electricity Off at the Main Fuse Box at this time and remove the existing light fixture.

WARNING

To avoid fire or shock, follow all wiring instructions carefully.

Any electrical work not described in these instructions should be done or approved by a licensed electrician.

Please call Technical Support at 1-800-654-3545 if you have any questions about installation and operation of this Ceiling Fan.

3. How to Hang Your Ceiling Fan

⚠ CAUTION

To reduce the risk of injury, install the fan so that the blades are at least 7 ft. (2.1m) above the floor (Figure 1).

⚠ WARNING

The outlet box and joist must be securely mounted and capable of supporting at least 50 lbs. Use only a U.L. outlet box listed as "Acceptable for Fan Support of 22.7 kg. (50 lbs.) or less".

⚠ WARNING

To reduce the risk of fire, electric shock, or personal injury, mount fan to outlet box marked "Acceptable for Fan Support of 22.7 kg. (50 lbs.) or less", and use screws supplied with outlet box. Most outlet boxes commonly used for support of light fixtures are not acceptable for fan support and may need to be replaced. Consult a qualified electrician if in doubt.

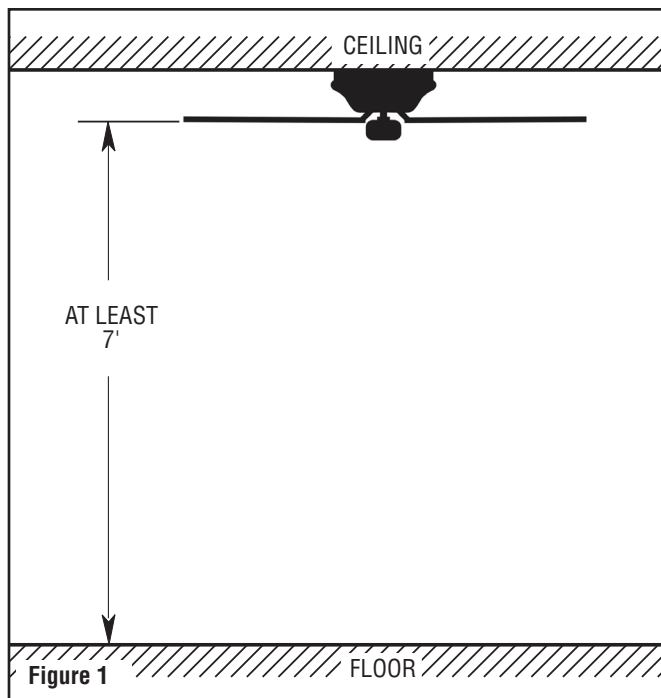

Figure 1

3.1

Securely attach the Mounting Plate to the Outlet Box (Figure 2) using Two Screws (supplied with outlet box).

NOTE: For better fan performance make sure the mounting plate is level. Additional washers (not included) may be needed to insert between the electrical box and mounting plate (Figure 2).

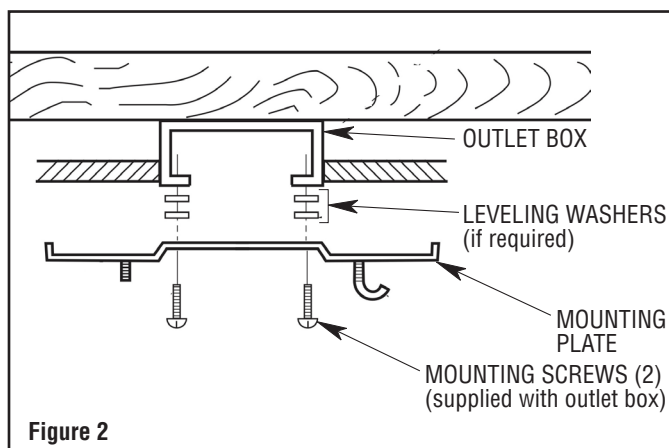

Figure 2

3.2

Pull the Black, White and Ground Wires out of the Outlet Box through the Hole in the Mounting Plate and lay them to the side as shown in Figure 3.

Carefully lift the Fan Motor Assembly and engage the Slot in the Motor Bracket with the Hook on the Mounting Plate so that it is securely suspended (Figure 3). Then connect wiring to your Fan according to Section "4. HOW TO WIRE YOUR CEILING FAN".

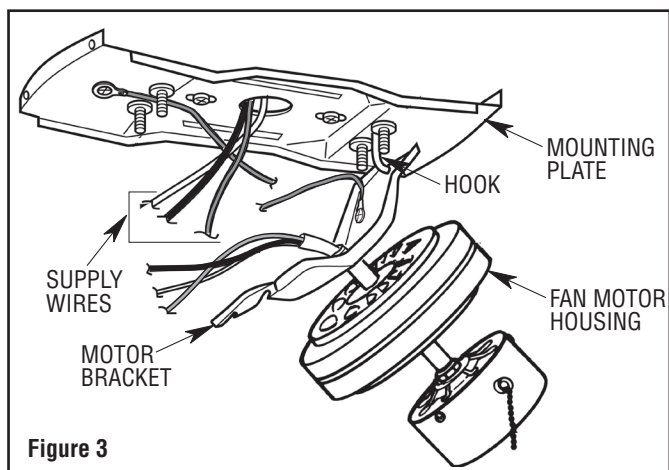

Figure 3

4. How to Wire Your Ceiling Fan

If you feel that you do not have enough electrical wiring knowledge or experience, have your fan installed by a licensed electrician.

⚠ WARNING

To avoid possible electrical shock, be sure electricity is turned off at the main fuse box before wiring.

NOTE: If you are not sure if the outlet box is grounded, contact a licensed electrician for advice, as it must be grounded for safe operation.

⚠ WARNING

To avoid risk of fire or shock, check to see that all connections are tight, including ground, and that no bare wire is visible at the wire connectors, except for the ground wire. Do not operate fan until blades are in place. Noise and fan damage could result.

4.1

Connect the Green Grounding Wires from the Motor Bracket and the Mounting Plate to the Grounding Conductor of Supply (this may be a bare wire or wire with green colored insulation). Securely connect Wires with Wire Connectors (supplied) (Figure 4).

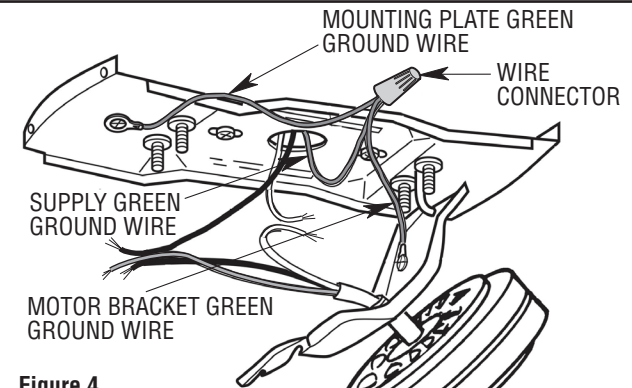

Figure 4

4.2

Connect the Fan Motor White Wire to the Supply White (neutral) Wire using a supplied Wire Connector (Figure 5).

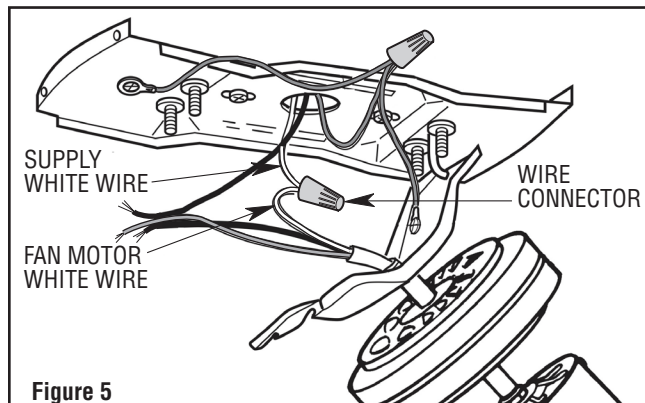

Figure 5

4.6

Connect the Fan Motor Black Wire and Blue Wire to the Supply Black (hot) Wire using a supplied Wire Connector (Figure 6).

Your Fan is now wired to be turned ON and OFF from the Fan Switch. After connections have been made, turn Wires upward and carefully push Wires into the Outlet Box, with the White and Green Wires on one side of the Outlet Box and the Black and Blue Wires on the other side of the Outlet Box.

Proceed to Step 1 of Section "5. CEILING FAN ASSEMBLY".

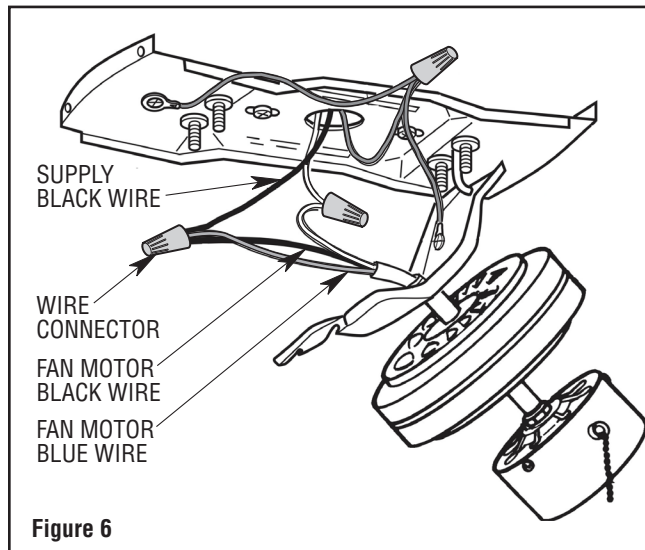

Figure 6

5. Ceiling Fan Assembly

5.1

Once wiring is completed, lift the Motor Bracket so that the Four Threaded Studs on the Mounting Plate protrude through the Four Slots in the Motor Bracket (See Figure 7).

Securely tighten the Four 1/4" Hex Locknuts (supplied) onto the Threaded Studs, then try to shake the Motor Bracket to ensure that the assembly is tight.

WARNING

To avoid possible fire or shock, do not pinch wires between the motor bracket and mounting plate.

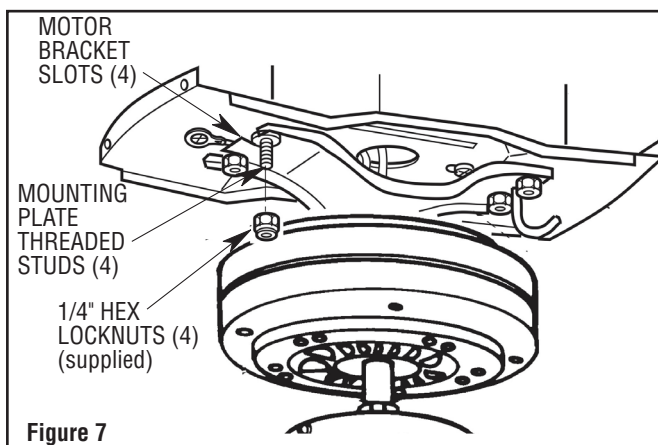

5.2

Align the Four Holes in the Fan Housing with the Holes in the Mounting Plate and install Four M5 x 10mm Phillips Pan Head Screws with Internal Tooth Washers (supplied) (Figure 8).

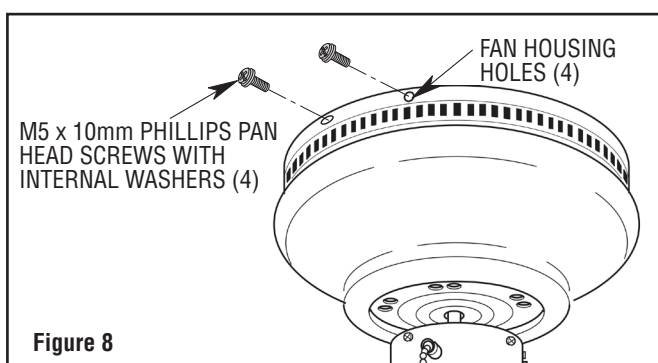

5.3

Mount the Flanges to the Blades using Three M5 x 6mm Phillips Washer Head Screws per Blade (supplied) (Figure 9).

Repeat for the Four remaining Blades Assemblies.

WARNING

To reduce the risk of personal injury, do not bend the blade assemblies when installing, balancing the blades or cleaning the fan. Do not insert foreign objects in between rotating fan blades.

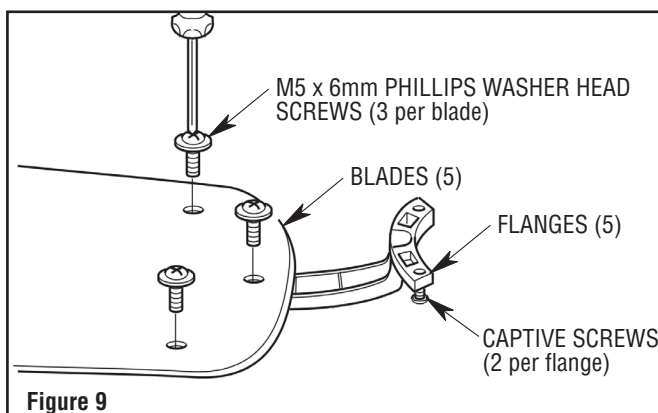

5.4

Attach One Blade Assembly to the Motor Hub using the Captive Screw provided for each Flange (Figure 8).

Make sure the Screws are tightened securely.

Repeat this procedure for the other Four Blade Assemblies.

NOTE: Take care not to scratch the fan housing when installing the blade assemblies.

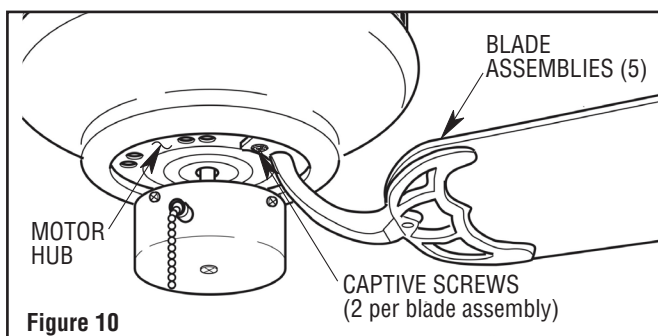

6. Using Your Ceiling Fan

⚠ WARNING

To reduce the risk of fire or electrical shock, do NOT use this fan with any solid-state speed control device.

6.1

Restore Electrical Power to the Outlet Box by turning the Electricity on at the Main Fuse Box.

Connect the Wood Pendant with Chain to the 3-Speed Switch Pull Chain using the Chain Coupling (Figure 11).

Check the operation of the Fan by gently pulling on the 3-Speed Switch Pull Chain (Figure 11). The operation sequence is as follows:

- | | |
|-------------------|----------------|
| 1st pull - High | 3rd pull - Low |
| 2nd pull - Medium | 4th pull - OFF |

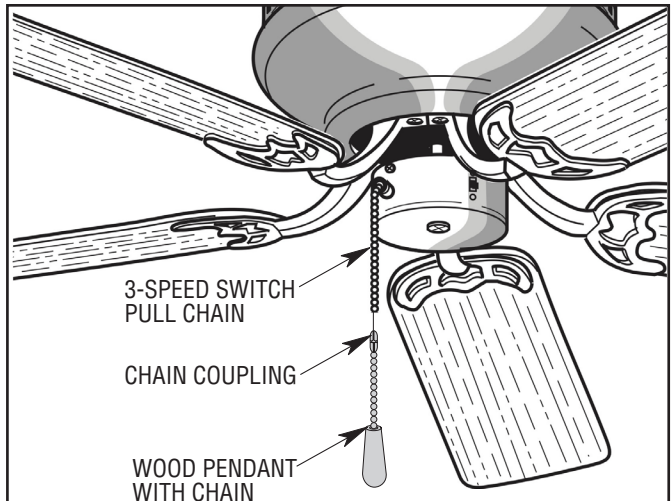

Figure 11

6.2

During Summer Months, run the Fan Counter-Clockwise, as you look up at it, to direct airflow downward.

During the Winter Months, run the Fan Clockwise, as you look up at it, to direct airflow upward.

If airflow is desired in the opposite direction, turn the Ceiling Fan OFF and wait for the Blades to stop turning.

Slide the Reverse Switch (located on the Switch Housing) to the opposite position, and turn the Ceiling Fan on again (Figure 12).

The Fan Blades will turn in the opposite direction and reverse the airflow.

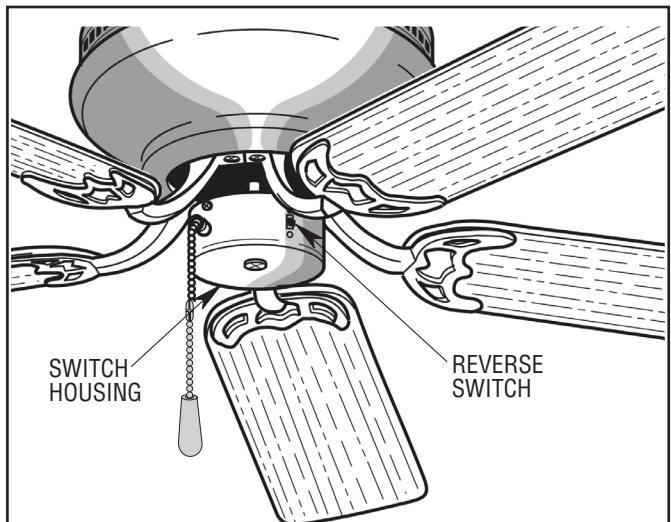

Figure 12

Reverse Switch Information

Season	Blade Rotation Direction
Summer	Counter-Clockwise
Winter	Clockwise

7. Maintenance

IMPORTANT CARE INSTRUCTIONS for your Ceiling Fan

Periodic cleaning of your new ceiling fan is the only maintenance that is needed.

When cleaning, use only a soft brush or lint free cloth to avoid scratching the finish.

Abrasive cleaning agents are not required and should be avoided to prevent damage to finish.

⚠ WARNING

Do not use water when cleaning your ceiling fan. It could damage the motor or the blades and create the possibility of an electrical shock.

8. Accessories

See your local Emerson dealer, www.emersonfans.com or the Emerson Ceiling Fan catalog for these accessories:

- SW46 4-Speed Slide Wall Control, SW90 Fan & Light Dual Slide Wall Control
- LED Light Fixtures

WARNING

The use of any other control not specifically approved for this fan could result in fire, shock and personal injury.



WARNING

This product is designed to use only those parts supplied with this product and/or any accessories designated specifically for use with this product. Substitution of parts or accessories not designated for use with this product by Emerson could result in personal injury or property damage.

9. Troubleshooting

WARNING

FOR YOUR OWN SAFETY TURN OFF POWER AT FUSE BOX OR CIRCUIT BREAKER BEFORE TROUBLESHOOTING YOUR FAN.

1. Fan will not start.	<ol style="list-style-type: none"> 1. Reverse switch in neutral position. 2. Loose power line connections to the fan, or loose switch wire connections in switch housing. 	<ol style="list-style-type: none"> 1. Make sure reverse switch position is all the way to one side. <div data-bbox="873 989 1487 1098">  WARNING Make sure main power is turned OFF. </div> <ol style="list-style-type: none"> 2. Check line wire connections to fan and switch wire connections in the switch housing.
2. Fan sounds noisy.	<ol style="list-style-type: none"> 1. Blades not attached to fan. 2. Loose screws in motor housing. 3. Screws securing fan blade flanges to motor are loose. 4. Wire connectors inside switch housing rattling. 5. Screws holding flanges to blades are loose. 	<ol style="list-style-type: none"> 1. Attach blades to fan before operating. 2. Check to make sure all screws in motor housing are snug (not over-tight). 3. Check to make sure the screws which attach the fan blade flanges to the motor are tight. <div data-bbox="873 1346 1487 1455">  WARNING Make sure main power is turned OFF. </div> <ol style="list-style-type: none"> 4. Check to make sure wire connectors in switch housing are not rattling against each other or against the interior wall of the switch housing. 5. Tighten securely.
3. Fan wobbles or shakes.	<ol style="list-style-type: none"> 1. Screws securing fan blade flanges to motor are loose. 2. Fan blade flanges not seated properly. 3. Mounting plate and/or ceiling outlet box is not securely fastened. 4. Fan blades out of balance. 	<ol style="list-style-type: none"> 1. Check to be sure screws which attach the fan blade flanges to the motor are tight. 2. Check to be sure the fan blade flanges seat firmly and uniformly to the surface of the motor. If flanges are seated incorrectly, loosen the flange screws and retighten according to the procedure in the section on "Ceiling Fan Assembly". 3. Tighten the mounting plate screws to the outlet box, and/or secure outlet box. 4. Interchanging an adjacent (side-by-side) blade pair can redistribute the weight and result in smoother operation.

10. Repair Parts

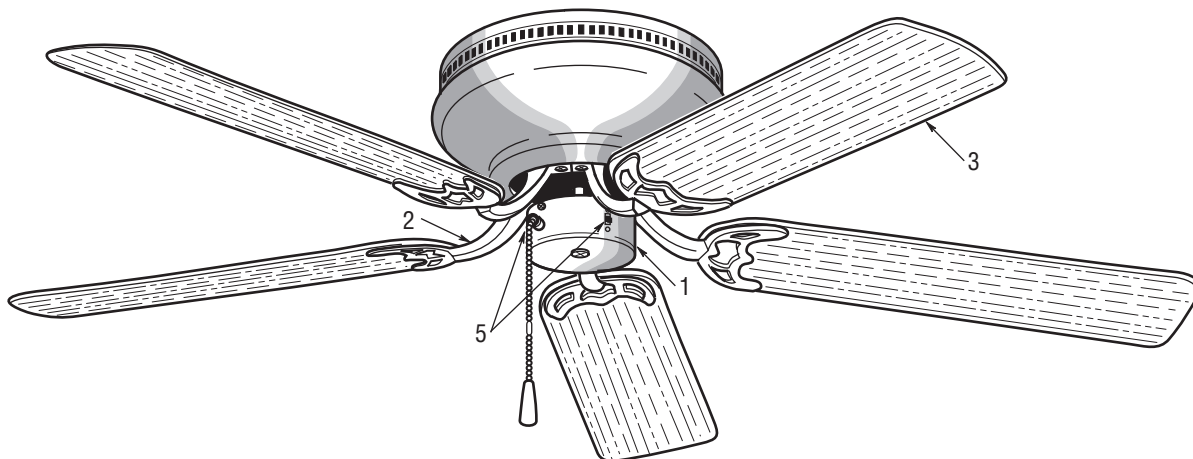

Key No.	Description	52" Part Numbers		
		Model Number CF805SBS02	Model Number CF805SORB02	Model Number CF805SWW02
1	Switch Housing Assembly	762577-3	762577-9	762577-2
2	Flange Sets (set of 5)	762573-3	762573-6	762573
3	Blade Sets (set of 5)	765172-DC/MH	765172-DC/MO	765172-WW/BO
4	Loose Parts Bag Containing: Blade Hardware Hanging Hardware Pull Chain Ball	762567-3	762567-1	762567-2
5	Harness, Wiring	762569-3	762569-2	762569-4
–	Owner's Manual	BP7192-10	BP7192-10	BP7192-10

Key No.	Description	42" Part Numbers		
		Model Number CF804SBS02	Model Number CF804SORB02	Model Number CF804SWW02
1	Switch Housing Assembly	762575-5	762575-4	762575
2	Flange Sets (set of 5)	762571-5	762571-4	762571
3	Blade Sets (set of 5)	765170-DC/MH	765170-DC/MO	765170-WW/BO
4	Loose Parts Bag Containing: Blade Hardware Hanging Hardware Pull Chain Ball	762567-4	762567-1	762567-2
5	Harness, Wiring	762568-3	762568-2	762568
–	Owner's Manual	BP7192-10	BP7192-10	BP7192-10

Before discarding packaging material, be certain all parts have been removed.

HOW TO ORDER REPAIR PARTS

WHEN ORDERING REPAIR PARTS, ALWAYS GIVE THE FOLLOWING INFORMATION:

- PART NUMBER
- NAME OF ITEM
- PART DESCRIPTION
- MODEL NUMBER

The model number of your Fan will be found on a label attached to the top housing. For repair parts, phone 1-800-654-3545.

Emerson Ceiling Fan Product Limited Warranty

What The Limited Warranty Covers:

This limited warranty is offered by Emerson, a Division of Luminance Brands ("Emerson" or "our" or "we" or "us") to the original purchaser ("you" or "your") of a consumer or industrial Emerson ceiling fan product including its motor and the other components, and accessories of a consumer or industrial Emerson ceiling fan product sold separately ("Emerson Ceiling Fan Product(s)") against defects in workmanship and materials, subject to the exclusions described below.

What The Limited Warranty Period Of Coverage Is:

All limited warranty periods herein begin on the date of original Emerson Ceiling Fan Product purchased by You.

This limited warranty covers the Emerson consumer Ceiling Fan Product motor for the lifetime of the original purchaser's ownership when operated in accordance with Your Emerson Ceiling Fan Product Owner's Manual or other instructions provided by Emerson to You with the Emerson consumer Ceiling Fan Product.

This limited warranty covers the Emerson industrial Ceiling Fan Product motor for five years from the date of purchase of Your Emerson industrial Ceiling Fan Product (when operated in accordance with Your Emerson Ceiling Fan Product Owner's Manual or other instructions provided by Emerson to You with the Emerson industrial Ceiling Fan Product).

This limited warranty covers the Emerson Ceiling Fan Product LED drivers and LED arrays component or accessory LED drivers and LED arrays for a period of five (5) years. All other components of the Emerson Ceiling Fan Product certified as ENERGY STAR® including motor electronics are covered by this limited warranty for a period of three (3) years. All other components and accessories of the Emerson Ceiling Fan Product including motor electronics are covered by this limited warranty for a period of one (1) year.

No Other Express or Implied Warranty Applies:

THE LIMITED WARRANTIES PROVIDED ABOVE ARE THE SOLE AND EXCLUSIVE WARRANTIES PROVIDED BY EMERSON TO YOU FOR YOUR Emerson Ceiling Fan Product, AND ARE IN LIEU OF ALL OTHER WARRANTIES, WRITTEN OR ORAL, EXPRESS OR IMPLIED, WHETHER ARISING BY OPERATION OF LAW OR OTHERWISE, WHETHER OR NOT THE PURPOSE HAS BEEN DISCLOSED AND WHETHER OR NOT THE Emerson Ceiling Fan Product HAS BEEN SPECIFICALLY DESIGNED OR MANUFACTURED FOR YOUR USE OR PURPOSE. EMERSON HEREBY DISCLAIMS ANY AND ALL IMPLIED WARRANTIES, INCLUDING WITHOUT LIMITATION, IMPLIED WARRANTIES OF MERCHANTABILITY OR FITNESS FOR A PARTICULAR PURPOSE.

How You Can Receive Warranty Service:

You must be the original purchaser and have proof of Your purchase of Emerson Ceiling Fan Product from an authorized Emerson Dealer to obtain Your remedy under this limited warranty. You can return Your Emerson Ceiling Fan Product to an authorized Emerson Dealer, or You can call Emerson Customer Service at 1-800-237-6511 to obtain a return authorization and service identification tag. In order for Us to confirm that Your Emerson Ceiling Fan Product is still under warranty, please retain Your receipt or other proof of purchase and have that information readily available when returning Your Emerson Ceiling Fan Product to Your place of purchase, or upon calling Emerson Customer Service. If You call Emerson Customer Service, prior to Your call please be prepared to provide all model numbers shown on Your Emerson Ceiling Fan Product. Once We have processed your return authorization request, We will provide You with a postage paid return label which should be affixed to the Emerson Ceiling Fan Product package You ship. The return label will be sent to the mailing address You provide to Us by phone.

What We Will Do To Correct Problems:

If the defect is covered by this limited warranty, Emerson will repair or replace the applicable Emerson Ceiling Fan Product at no charge to You. If repair of the Emerson Ceiling Fan Product is not practical or possible within a reasonable time and no replacement Emerson Ceiling Fan Product can be provided, Emerson will refund You the actual purchase price of Your Emerson Ceiling Fan Product. We will ship the repaired or the replacement Emerson Ceiling Fan Product to You at no charge, but You are responsible for all costs of removal and reinstallation of Your Emerson Ceiling Fan Product.

What Is Not Covered under the Limited Warranty:

This limited warranty does not extend to and expressly excludes:

- The glass globes and light bulbs of Your Emerson Ceiling Fan Product,
- Any costs or fees associated with the labor, including electrician's fees, required to install, remove, repair or replace a fan or any fan components or accessories.
- Loss or damage to the Emerson Ceiling Fan Product motor or any Emerson Ceiling Fan Product component or Emerson Ceiling Fan Product accessory caused by normal wear and tear, rather than due to defects in materials or workmanship,
- Loss or damage resulting from conditions beyond our reasonable control, including without limitation, unforeseeable operating environmental conditions, repairs not made at Our factory or authorized service center, use of parts or accessories not provided to You as part of this warranty by Our factory or authorized service center, mishandling, unreasonable use, misuse, abuse, modifications or other damage caused by You or a third party to your Emerson Ceiling Fan Product while not in Our possession,
- Loss or damage resulting from improper installation, or other failure to comply with instructions in Your Owner's Manual including but not limited to Emerson Ceiling Fan Products installed in unintended industrial or residential applications.
- Emerson Ceiling Fan Product purchases from unauthorized Emerson Dealers.

This limited warranty is deemed null and void upon the occurrence of either of the following events:

- You as the original purchaser cease to own the Emerson Ceiling Fan Product, or
- The Emerson Ceiling Fan Product is moved from its original point of installation.

This limited warranty is only valid within the 50 United States, the District of Columbia, and Canada. No other written or oral warranties apply, and no employee, agent, dealer or other person is authorized to give any warranties on behalf of Us.

Limitation of Liability:

REPAIR, REPLACEMENT OR A REFUND ARE THE EXCLUSIVE REMEDIES AVAILABLE TO YOU UNDER THIS LIMITED WARRANTY. TO THE EXTENT PERMITTED BY LAW, IN NO EVENT SHALL EMERSON OR ANY EMERSON AUTHORIZED DEALER BE LIABLE FOR ANY INCIDENTAL, SPECIAL, INDIRECT, OR CONSEQUENTIAL DAMAGES, INCLUDING ANY ECONOMIC LOSS, WHETHER RESULTING FROM NONPERFORMANCE, USE, MISUSE OR INABILITY TO USE THE Emerson Ceiling Fan Product OR FOR THE NEGLIGENCE OF EMERSON OR AN EMERSON AUTHORIZED DEALER. EMERSON SHALL NOT BE LIABLE FOR DAMAGES CAUSED BY DELAY IN PERFORMANCE AND IN NO EVENT, REGARDLESS OF THE FORM OF THE CLAIM OR CAUSE OF ACTION (WHETHER BASED IN CONTRACT, INFRINGEMENT, NEGLIGENCE, STRICT LIABILITY, OTHER TORT OR OTHERWISE), SHALL EMERSON'S OR ANY EMERSON AUTHORIZED AGENT'S LIABILITY TO YOU OR ANY INDIVIDUAL USING THE Emerson Ceiling Fan Product EXCEED THE PRICE PAID BY THE ORIGINAL OWNER FOR THE Emerson Ceiling Fan Product. The term "consequential damages" shall include, but not be limited to, loss of anticipated profits, business interruption, loss of use or revenue, cost of capital or loss or damage to property or equipment.

Dispute Resolution:

In the event of any dispute INCLUDING, BUT NOT LIMITED TO, BREACH OF CONTRACT, BREACH OF WARRANTY, CLAIMS BASED IN TORT, NEGLIGENCE, PRODUCT LIABILITY, FRAUD, MARKETING, STATE OR FEDERAL REGULATIONS, ANY CLAIMS REGARDING THE ENFORCEABILITY OF THIS LIMITED WARRANTY, AND THE WAIVER OF CLASS ACTION TRIALS between You and Emerson, either party may choose to resolve the dispute by binding arbitration, as described below, instead of in court. THIS MEANS IF EITHER YOU OR EMERSON CHOOSE BINDING ARBITRATION, NEITHER PARTY SHALL HAVE THE RIGHT TO LITIGATE SUCH CLAIM IN COURT OR HAVE A JURY TRIAL. DISCOVERY AND APPEAL RIGHTS ARE LIMITED IN BINDING ARBITRATION. You and Emerson agree that the proper venue if Arbitration is not so chosen by You or Emerson of all actions arising in connection herewith shall be only in the state of Missouri and the parties agree to such jurisdiction.

CLASS ACTION WAIVER: BINDING ARBITRATION MUST BE ON AN INDIVIDUAL BASIS. THIS MEANS NEITHER YOU NOR EMERSON MAY JOIN OR CONSOLIDATE CLAIMS IN ARBITRATION BY OR AGAINST OTHERS, OR LITIGATE IN COURT OR ARBITRATE ANY CLAIMS AS A REPRESENTATIVE OR MEMBER OF A CLASS OR IN A PRIVATE ATTORNEY GENERAL CAPACITY.

ADMINISTRATION OF ARBITRATION: The binding arbitration must be administered by the American Arbitration Association ("AAA") in accordance with its Commercial Arbitration Rules and/or Supplementary Procedures for Consumer-Related Disputes (including proceedings to mitigate costs of travel). This binding arbitration is governed by the Federal Arbitration Act ("FAA") (9 USC §1, et. seq.) and will govern the interpretation and enforcement. The binding arbitration shall be held at a location determined by AAA or at such other location as mutually agreed. In addition to the terms stated above, the following will apply to the binding arbitration: (1) the arbitrator, and not any federal, state, or local court or agency, will have exclusive authority to resolve any dispute relating to the interpretation applicability, enforceability or formation of this agreement including any claim that all or any part of this agreement is void or voidable; (2) the arbitrator shall apply Missouri law consistent with the FAA.

How State and Provincial Law Relates To The Warranty:

Some states and provinces do not allow the exclusion or limitation of incidental or consequential damages so the above exclusion or limitation may not apply to You. This limited warranty gives you specific legal rights, and You may also have other rights which vary from state to state or province to province.

SERIAL NUMBER: _____ **DATE CODE:** _____

The serial number of this fan can be found on the nameplate on top of the fan housing. The date code can be found on the carton and on top of the fan housing, stamped in ink on a white label. You should record this data above and keep it in a safe place for future use.



EMERSONTM

DIVISION OF LUMINANCE BRANDS
1945 S. Tubeway Ave. • Los Angeles, CA 90040

Questions, problems, missing parts: Before returning to the store call
Customer Service
8 a.m. - 6 p.m., Eastern, Monday-Friday

1-800-654-3545

www.emersonfans.com

Retain this manual for future use.