

ASSEMBLY INSTRUCTIONS

X-FRAME 3-SHELF BOOKCASE

A Shelf Panel

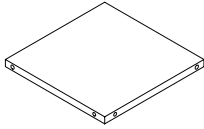

3PCS

B Bottom Panel

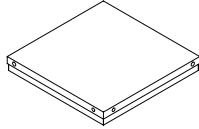

1PC

C Left Side Frame

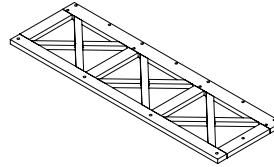

1PC

D Right Side Frame

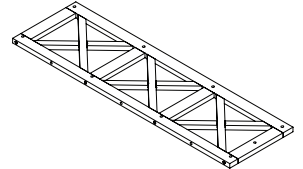

1PC

E Wood Dowel
Ø8 x 30mm



13PCS

F Bolt
1/4" x 1" x Ø1/2"

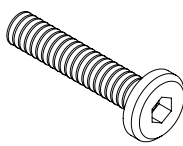

12PCS

G Allen Wrench
4mm

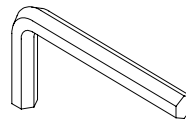

1PC

H Bolt
1/4" x 1/2" x Ø1/2"
(Anti-Tip Kit)

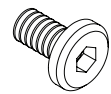

2PCS

I Wood Screw
4 x 25 x 9mm
(Anti-Tip Kit)

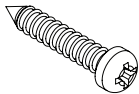

2PCS

J Plastic Anchor
Ø6 x 26mm
(Anti-Tip Kit)

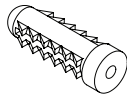

2PCS

K Metal Bracket
22 x 22 x 17mm
(Anti-Tip Kit)

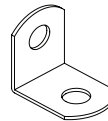

4PCS

L Plastic Mounting Strap
7 x 285mm
(Anti-Tip Kit)



2PCS

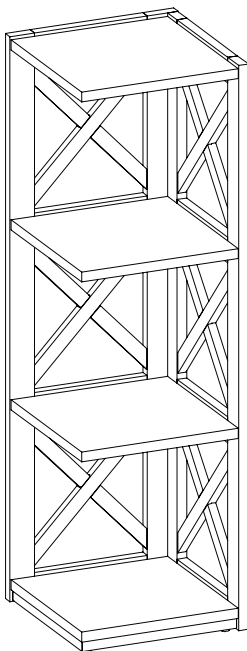

This page lists all the contents included in the box. Please take the time to identify the hardware as well as the individual components to this product. As you unpack and prepare for assembly, place the contents on a carpeted or padded area to protect them from damage.

***Do not tighten screws & bolts until the entire unit is completely assembled.

- 1** Insert Wood Dowel (E) into the Shelf & Bottom Panel (A & B). Attach the Shelf & Bottom Panel (A & B) to the Right Side Frame (D) using Bolt (F) with the Allen Wrench (G).

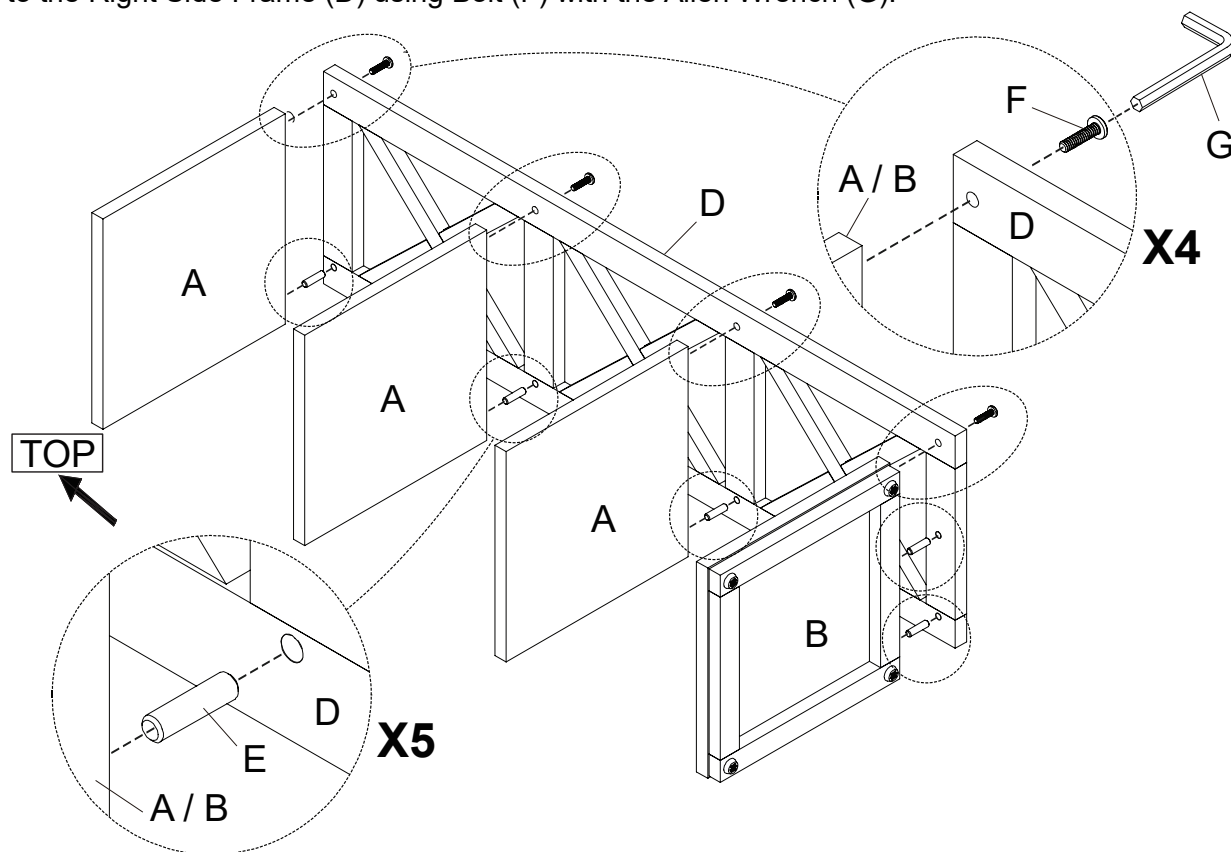

- 2** Turn the assembled unit and insert Wood Dowel (E) into the Shelf & Bottom Panel (A & B) and Right Side Frame (D). Attach the Left Side Frame (C) to the Shelf & Bottom Panel (A & B) and Right Side Frame (D) using Bolt (F) with the Allen Wrench (G).

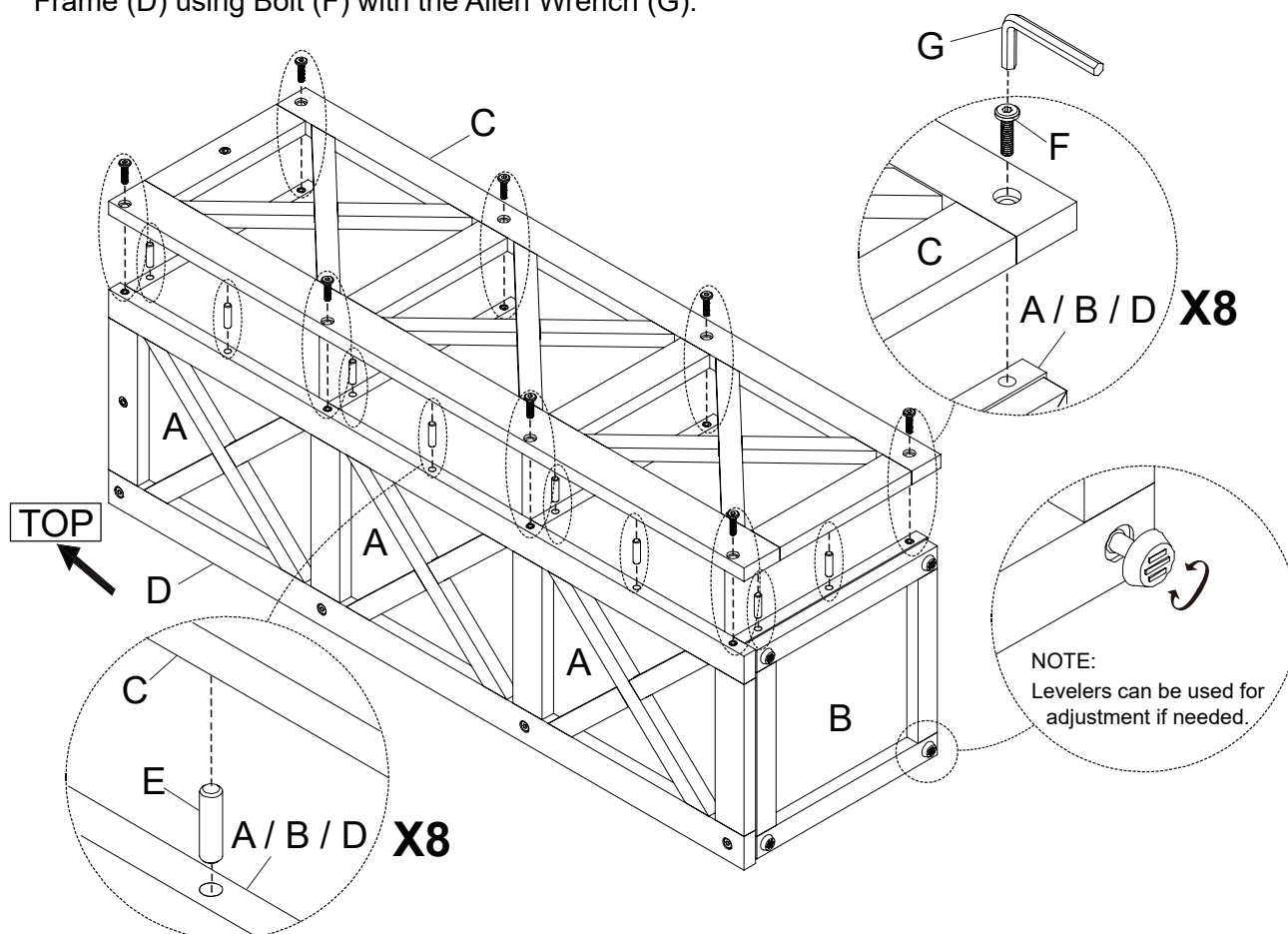

3

For your safety, please secure the product to the wall using the provided Anti-Tip Kit as per the instructions below.

1. Attach 2pcs of Metal Bracket (K) to the holes on the back of the Left & Right Side Frame (C & D) using Bolt (H) with the Allen Wrench (G).
2. Choose the desired location for the furniture and mark the wall for the Metal Bracket (K). Drill 2 holes in the wall approximately 2" below the corresponding positions and insert the Plastic Anchor (J).
3. Attach the other 2pcs of Metal Bracket (K) to the wall over the Plastic Anchor (J) using Wood Screw (I) with a screwdriver (not provided).
4. Position the furniture so that the Metal Bracket (K) on the Left & Right Side Frame (C & D) align with the Metal Bracket (K) on the wall.
5. Connect the aligned Metal Bracket (K) with the Plastic Mounting Strap (L) and tighten as needed before locking them in place.

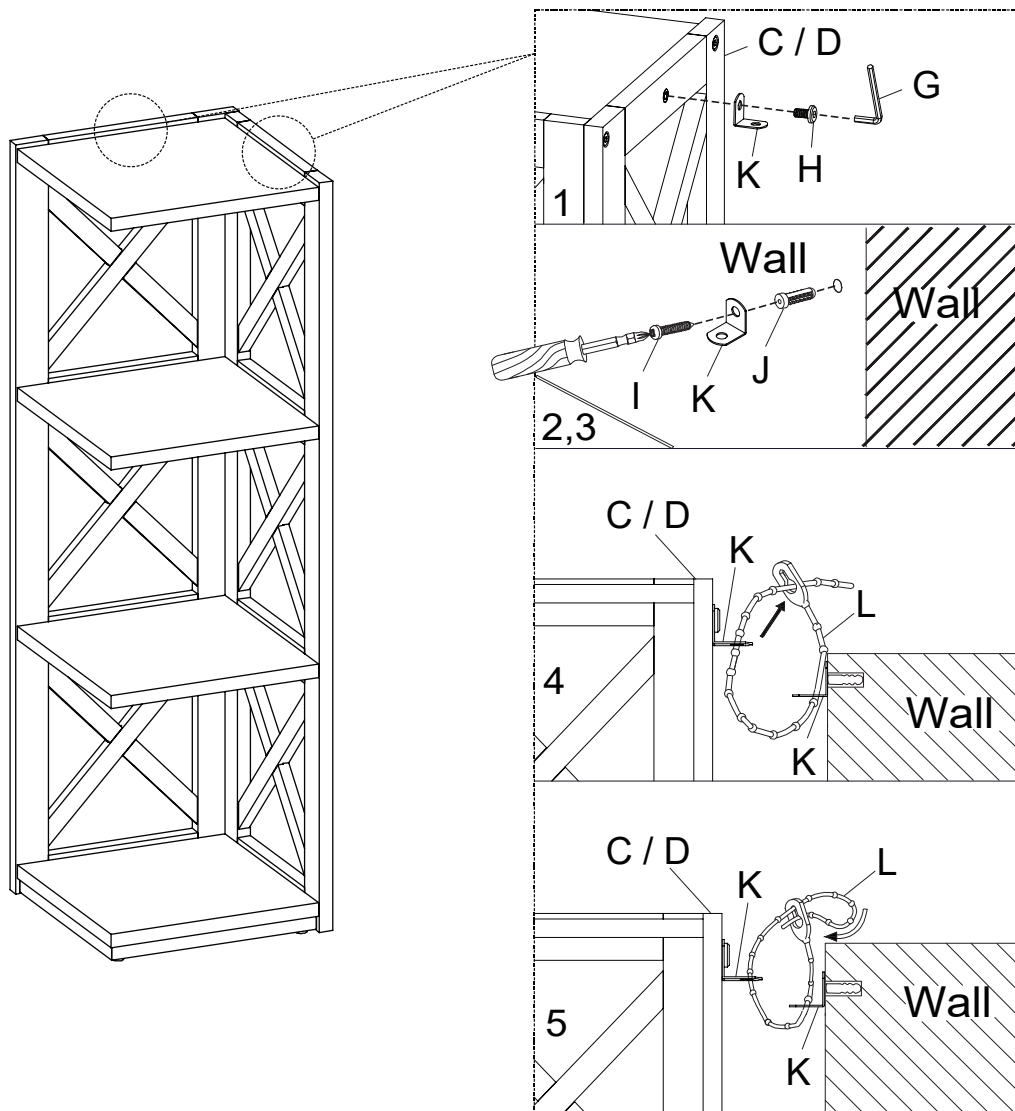

Cleaning & Care

Treat surfaces with care. Surfaces are resistant to scratches but are not scratch resistant. Clean surfaces with a dry or damp soft cloth. Do not use abrasive cleaners. Hardware may loosen over time. Periodically check that all connections are tight.