

Maykke

www.maykke.com

Installation Guide



Deck Mount Tub Filler

Notice: Before beginning please read all installation instructions and observe all local safety and building codes.

Notice: Inspect all products before installing.

Notice: Consult a professional if you are unfamiliar with faucet installation. We accept no liability for damages to property or person during installation.

Notice: Insure that the waterline is clean and clear of debris before beginning.

Notice: Make sure water is turned off before beginning.

TOOLS NEEDED:



Glue



Plier



Monkey Wrench

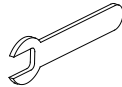

Wrench

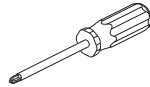

Screwdriver

PARTS INCLUDED:

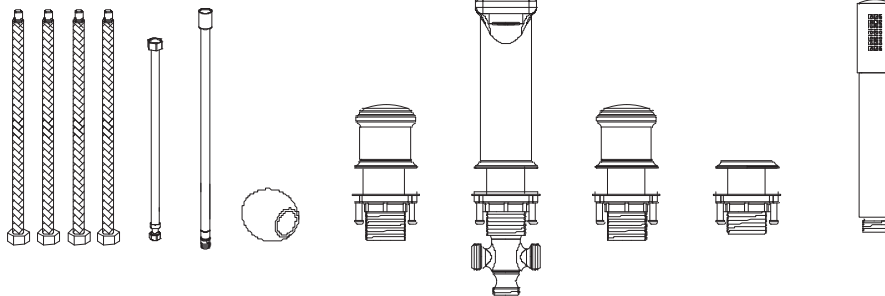

RECOMMEND TOOL:

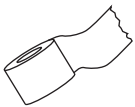

PLUMBER'S TAPE

1. Remove the locknuts from all faucet trim pieces.
(If your model has the diverter built into the spout, you will need to unscrew the diverter from the back of the spout before proceeding)

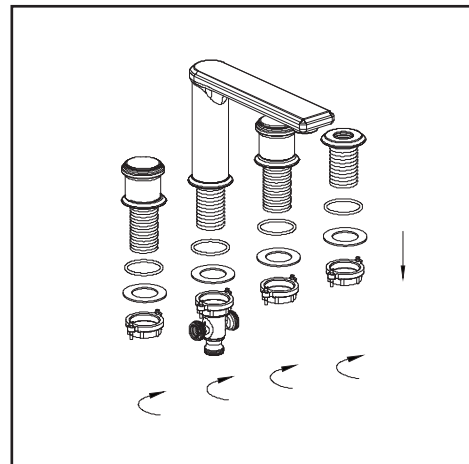

2. Insert the faucet components through the mounting holes and tighten the nuts. Making sure the cold valve is on the right, hot valve is on the left. (replace the diverter from step one)

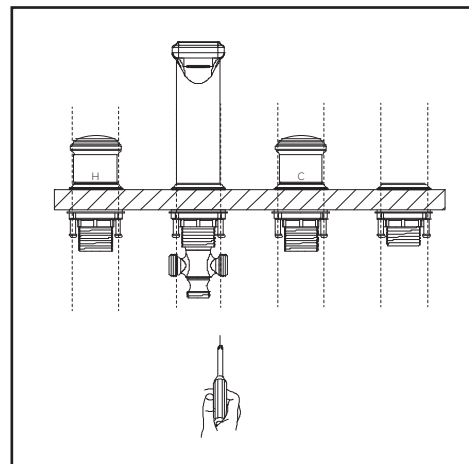

3. Connect the supply lines, using plumber's tape, to both the hot and cold valve connectors, then to the main faucet connector.

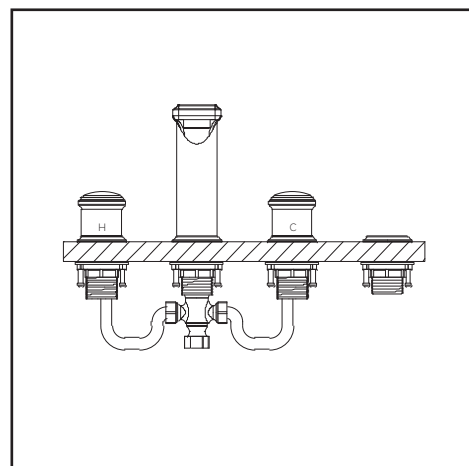

4. Tighten using a wrench.

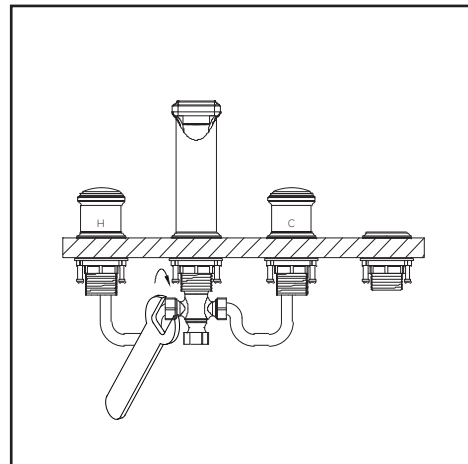

5. Using the other two supply lines connect the water lines, cold to cold and hot to hot. Insuring to use plumber's tape on all threads.

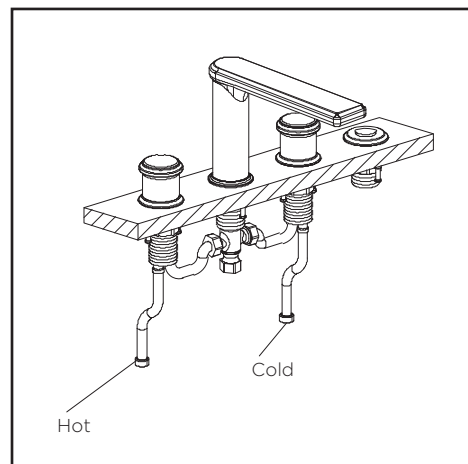

6. Connect the large end of the handshower hose to the hand shower (using plumber's tape) and feed the smaller end through the mounting trim.

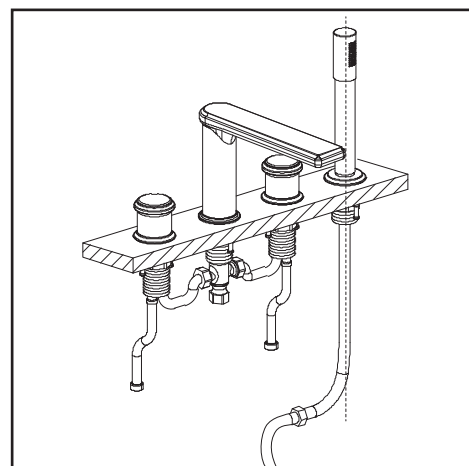

7. Open the hose weight by loosening the screw. Feed the handshower hose through the weight and tighten the screw to secure.

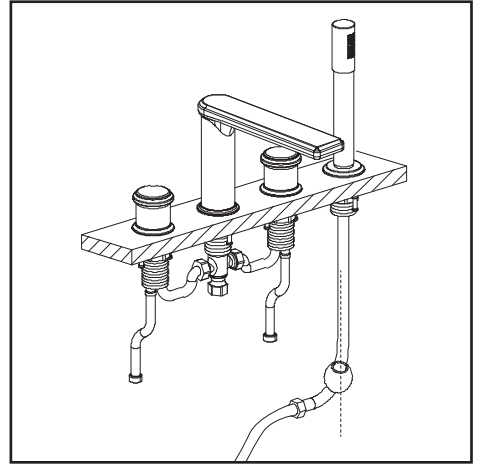

8. Using plumber's tape connect the small end of the handshower hose to a water supply hose and then connect the hose to the centerline of the faucet spout.

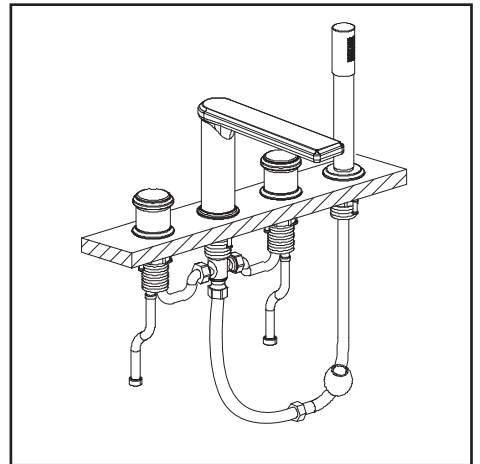

9. Turn water on to test.

For warranty information please check www.maykke.com

For customer service concerns or support please email: support@maykke.com