



**Liberty Furniture**  
INDUSTRIES, INC

# LIBERTY FURNITURE

## ASSEMBLY INSTRUCTION

ITEM # 705-BR23HU/BR23FS/BR23RSP  
705-BR24HU/BR24FS/BR24RSP \_\_\_\_\_ DESCRIPTION Upholstered Bed \_\_\_\_\_

Thank you for purchasing this quality product. Be sure to check all packing materials carefully for small parts which may have come loose inside the carton during shipment. Identify and count all parts and compare with the parts List Below.

### Assembly steps:

**Step 1.** Assemble the Posts (B) (L/R) to the Headboard (A) using Bolt (d), spring washer (f), flat washer (g) and wrench (h).

**Step 2.** Assemble the Cross bar (G) to the Headboard (A) using Bolt (e), spring washer (f), flat washer (g) and allen wrench (h).

**Step 3.** Attach the Side rails (D) to the Headboard (A) using set-screw (a), washer (b), nut (c) and wrench (i).

**Step 4.** Attach the Slat support (F) to the Slat roll (E)

**Step 5.** Screw slat roll (E) in place.

**Step 6.** Remove handles from back to front of drawers.

### PARTS LIST

NO.	SKETCH	DESCRIPTION	Q'TY
A		Upholstered Headboard	1pc
B		Post (L/R)	Queen King 2pcs
C		Footboard	1pc
D		Side Rails	2pcs
E		Slat roll (13 pcs)	Queen King 1set
F		Slat support	Queen King 5pcs
G		Cross bar	1pc

### HARDWARE LIST

NO.	SKETCH	HARDWARE	Q'TY
a		5/16"x18x2-3/4"	8pcs
b			8pcs
c		5/16"	8pcs
d		5/16"x18x2-1/4"	4pcs
e		5/16"x18x1-1/2"	2pcs
f		5/16"x12 mm	6pcs
g		5/16"x19 mm	6pcs
h		4 mm	1pc
i		12 mm	1pc
j		#8x1"	10pcs

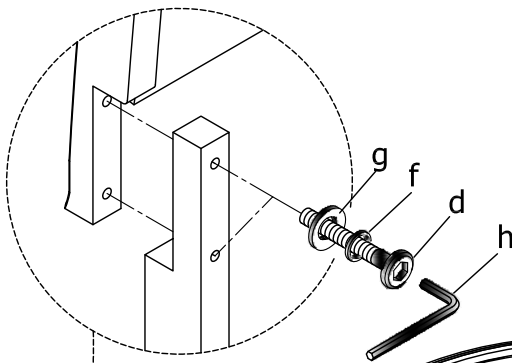

Step 1

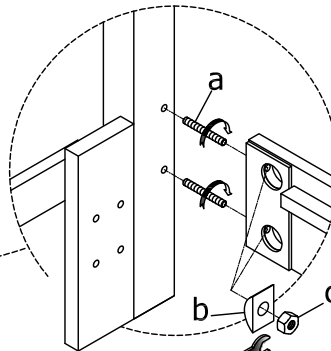

Step 3

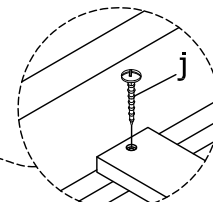

Step 5

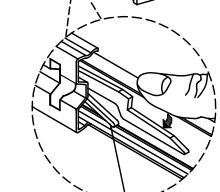
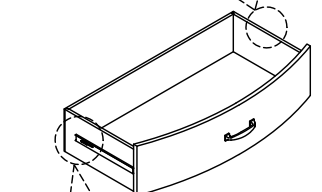
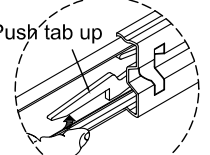

Push tab down

MADE IN VIETNAM

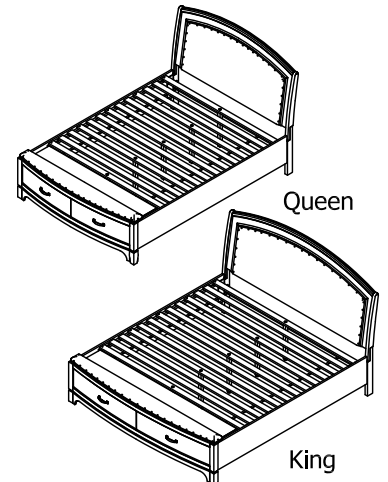
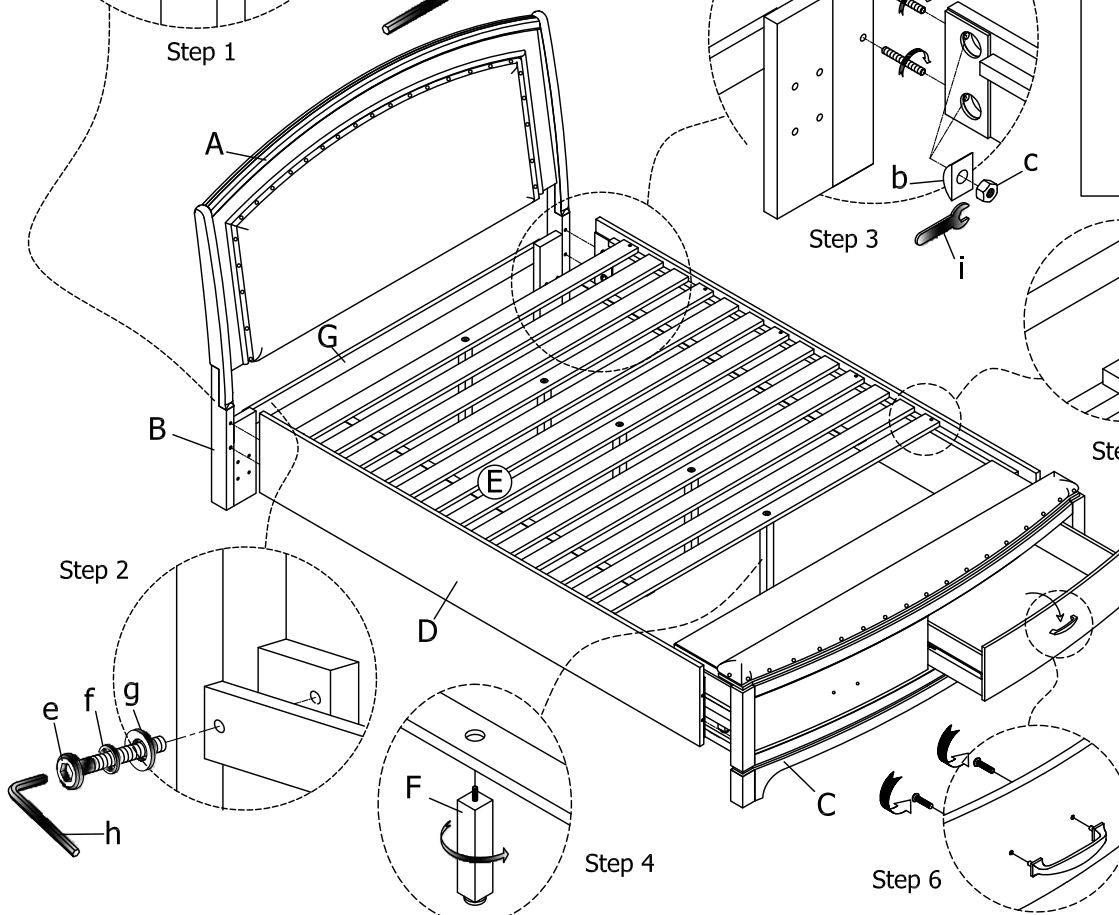

Complete Assembly

### HOW TO OPEN DRAWER

Push tab up

Push tab down