

ASSEMBLY INSTRUCTION

LOVESEAT & STORAGE CHAISE

A Loveseat Frame **B** Chaise **C** Backrest-Loveseat

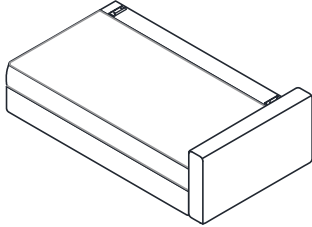

1pc

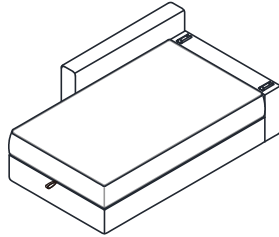

1pc

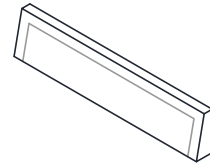

1pc

D Backrest-Chaise **E** Back Cushion -Chaise **F** Back Cushion -Loveseat

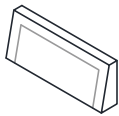

1pc

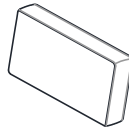

1pc

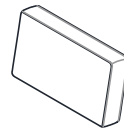

2pcs

G Leg



9pcs

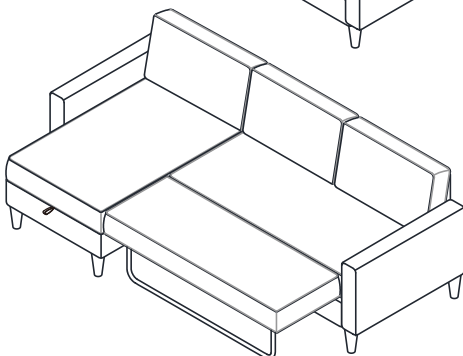
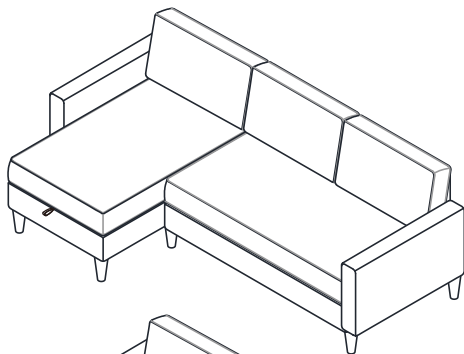

This page lists all the contents included in the box. Please take the time to identify the hardware as well as the individual components to this product. As you unpack and prepare for assembly, place the contents on a carpeted or padded area to protect them from damage.

-
- 1** Hook the Backrest-Loveseat (C) onto the Loveseat Frame (A) properly.

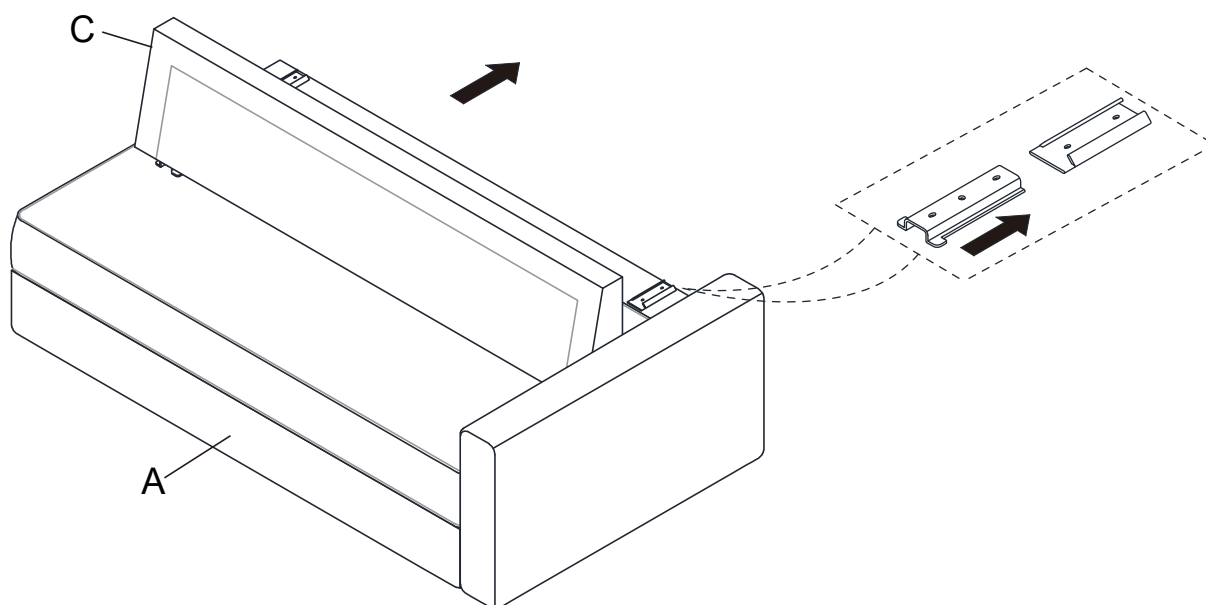

-
- 2** Hook the Backrest-Chaise (D) onto the Chaise (B) properly.

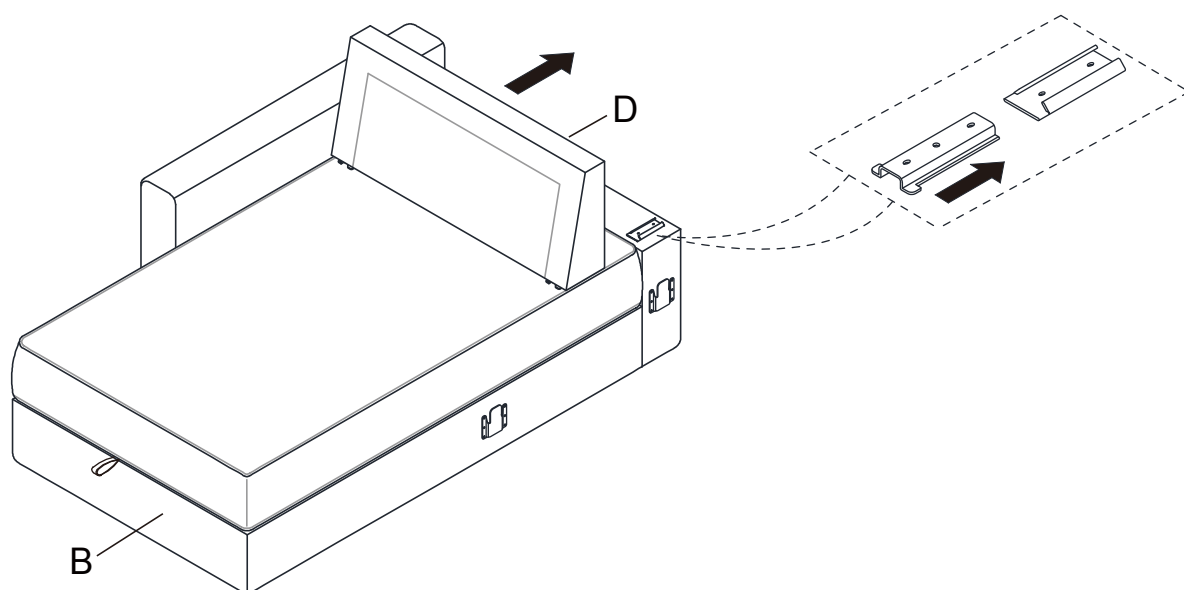

- 3** Put the assembled loveseat & chaise on a smooth flat surface and please flip over them, then assemble Leg (G) to Loveseat Frame (A) & Chaise (B) until the legs are tight.

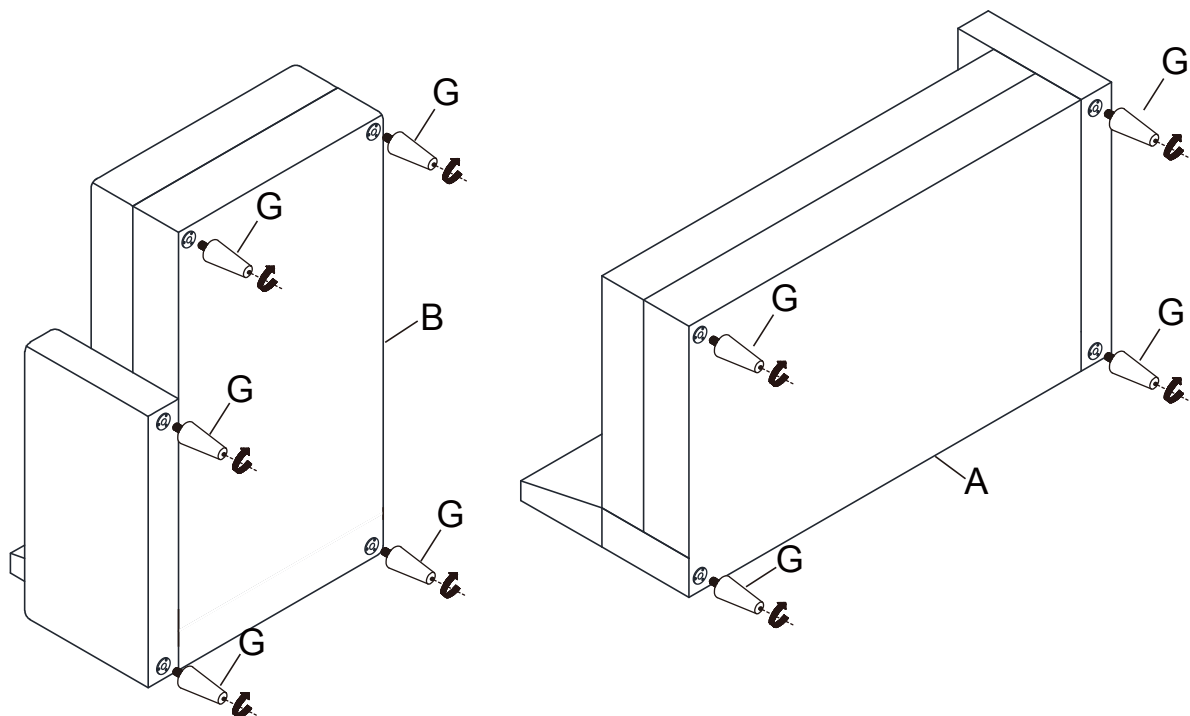

- 4** Hook up the assembled loveseat with chaise together as below.

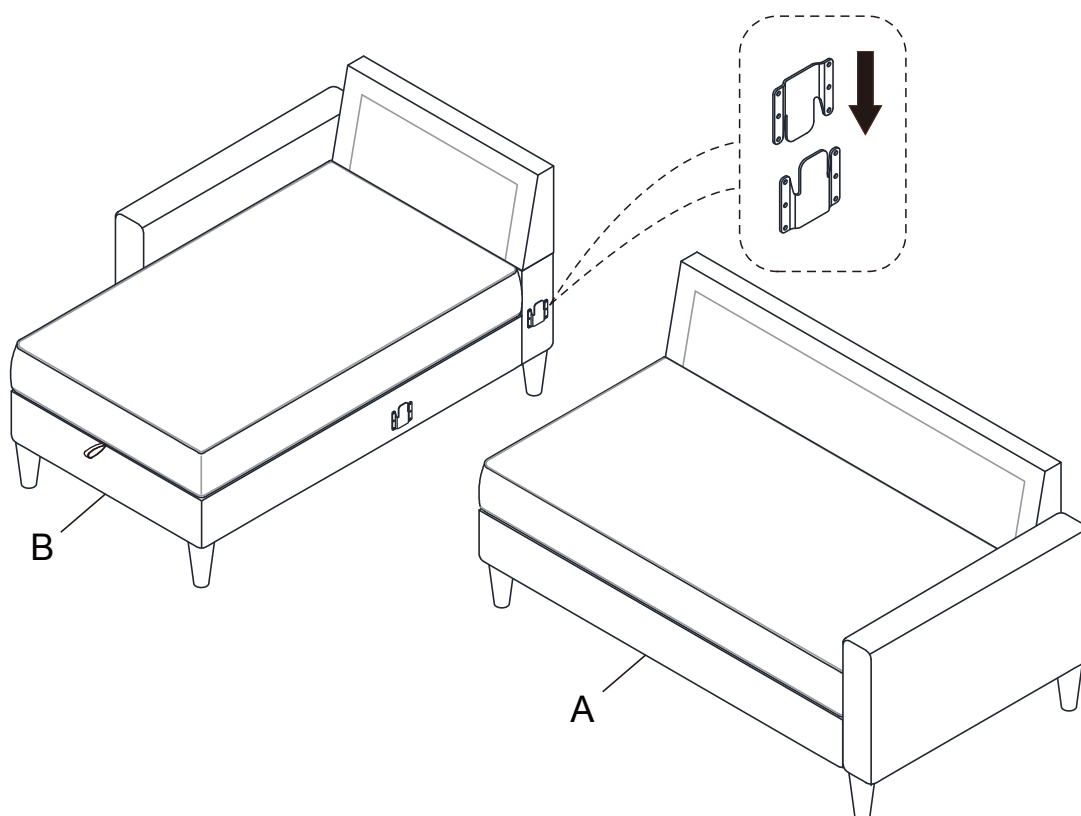

- 5** Put Back Cushion (E) on Chaise (B) and put Back Cushion (F) on Loveseat Frame (A) as below shown.

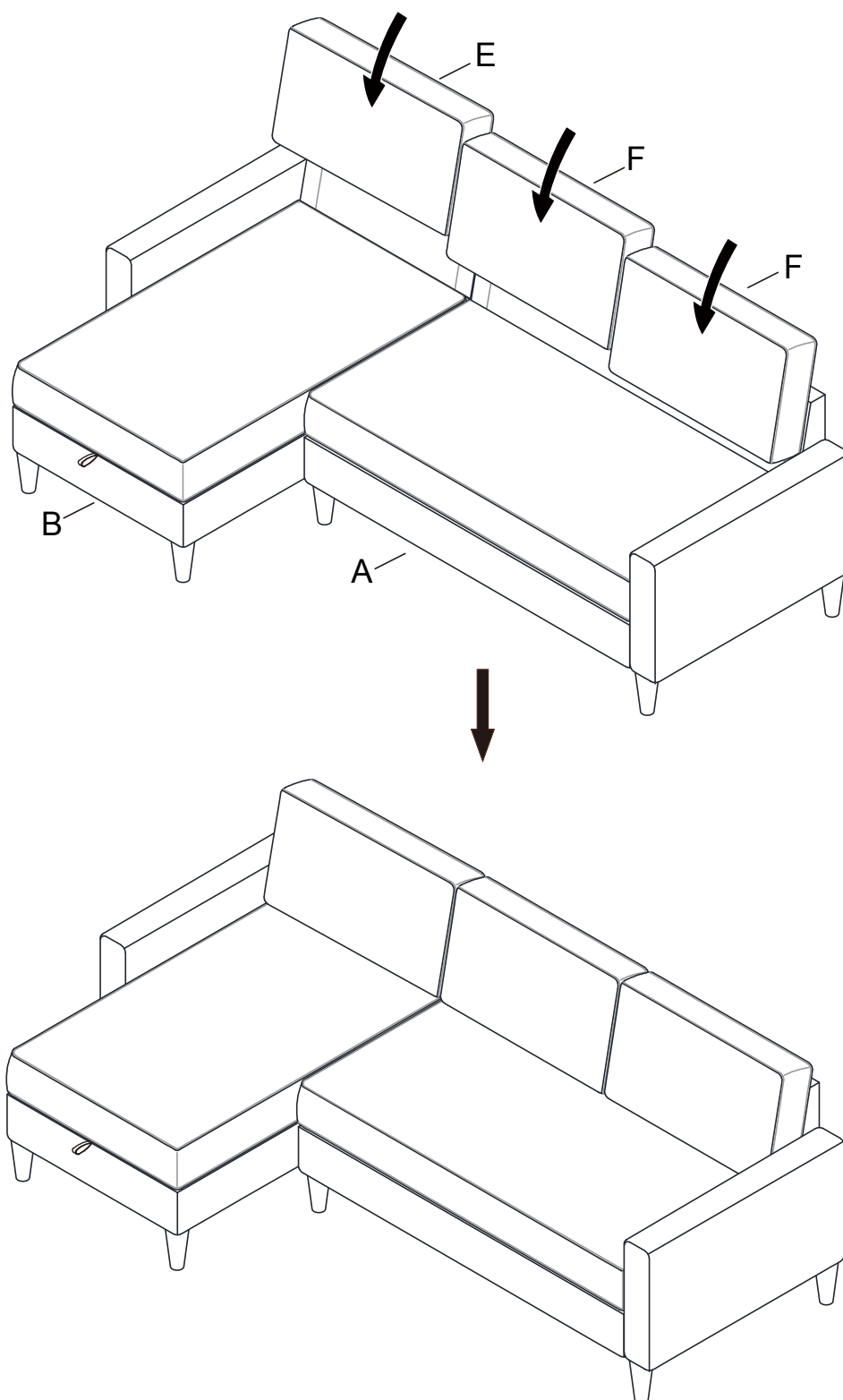

6 Open the Loveseat Frame (A) and pull out the bed cushion as below shown.

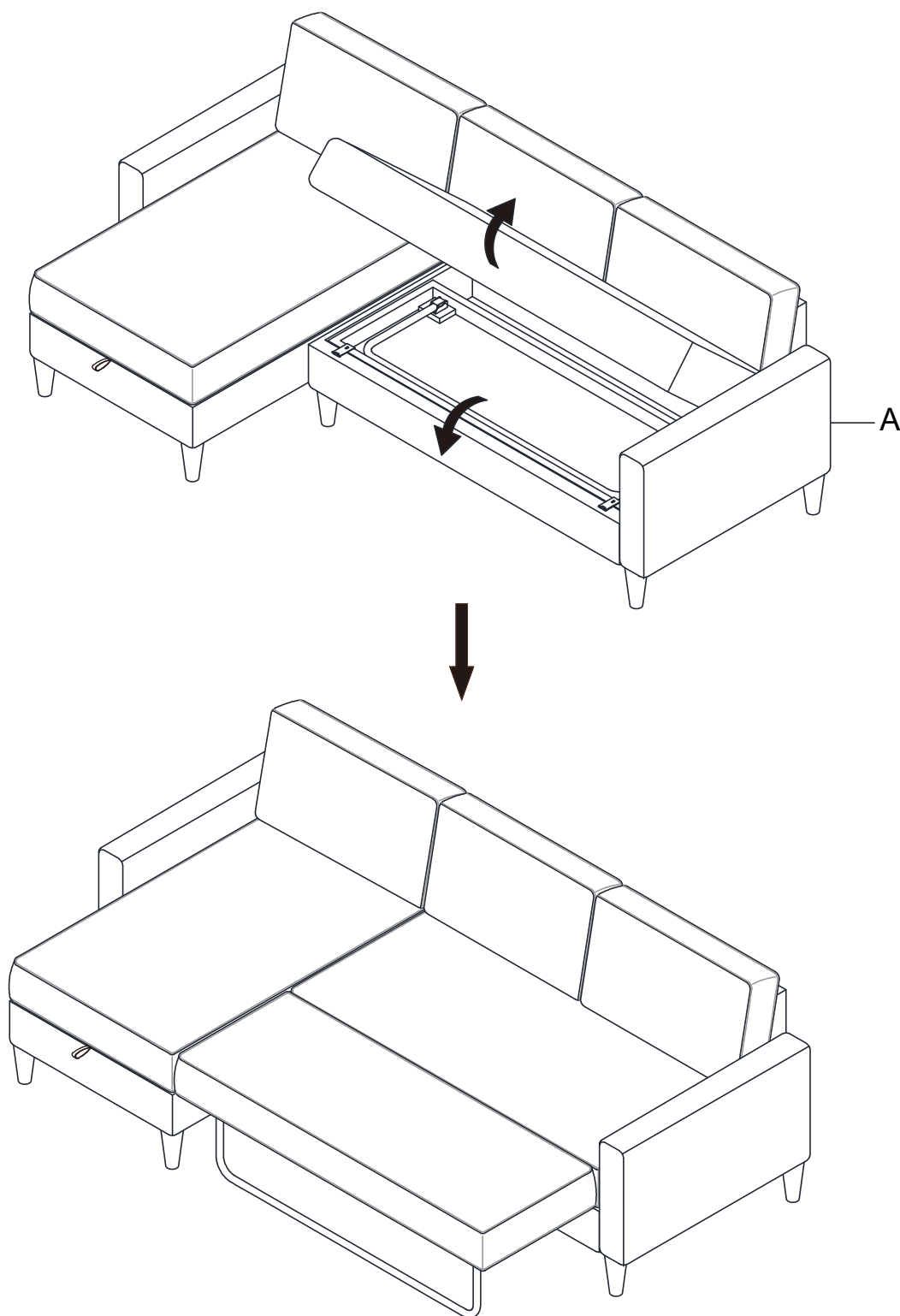

7

Open the Loveseat Frame (A), then fold the bed cushions into the Loveseat Frame(A), as below shown.

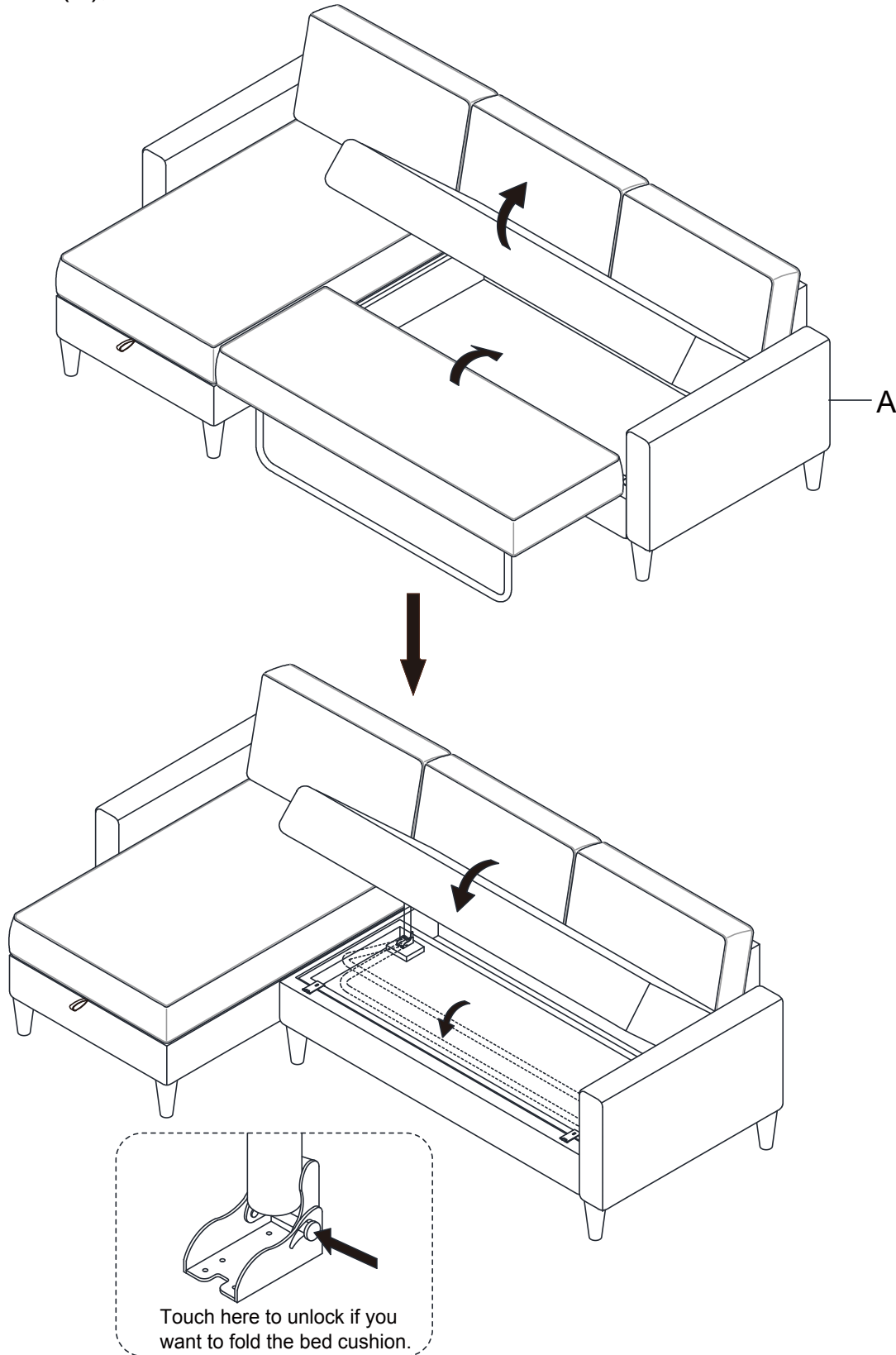

Cleaning & Care

Treat surface with care. Surface is resistant to scratches but is not scratch resistant. Clean surfaces with a dry or damp soft cloth. Do not use abrasive cleaners. Hardware may loosen over time. Periodically check that all connections are tight.