

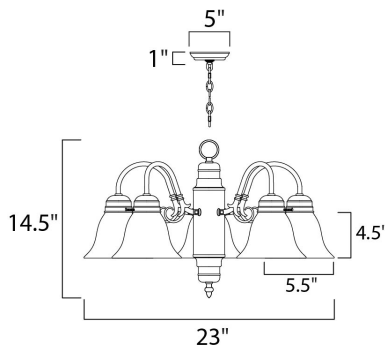

#### PRODUCT DESCRIPTION

Maxim Lighting's commitment to both the residential lighting and the home building industries will assure you a product line focused on your basic lighting needs. With the Builder Basics collection you will find quality lighting that is well designed, well priced and readily available.



#### MEASUREMENTS

DIMENSION : 23" L x 23" W x 14.5" H  
CANOPY : 5" W x 1" H x 5" L  
HANGING WEIGHT : 7.92 lb

#### LAMPING

INPUT VOLTAGE : 120V  
BULB : 5 x 60W Incandescent E26 Medium , 300W Total  
BULB INCLUDED : (Not Included)  
DIMMABLE : Yes

#### FINISHES OPTION

 Matte White  
 Oil Rubbed Bronze  
 Satin Nickel

#### GLASS

Marble MR

#### MATERIAL

Steel, Glass

#### RATINGS

cETLus  
Dry Location



#### ADDITIONAL

ADJUSTABLE  
OPERATING TEMPERATURE:  
-20°C (-4°F), 40°C (104°F)

Always consult a qualified electrician before installing any lighting product.



**WESTERN DISTRIBUTION CENTER (HEADQUARTER)**  
253 NORTH VINELAND AVE | CITY OF INDUSTRY, CA 91746

**EASTERN DISTRIBUTION CENTER**  
4200 SHIRLEY DR. | ATLANTA, GA 30336

P. 626.956.4200 | F. 626.956.4225 | maximlighting.com