

ASSEMBLY INSTRUCTIONS

ITEM NO: P306-95 / P309-95

LIFT-TOP THREE PACK TABLE

Thank you for purchasing this quality product. Be sure to check all packing material carefully for small parts that may have come loose inside the carton during shipment.

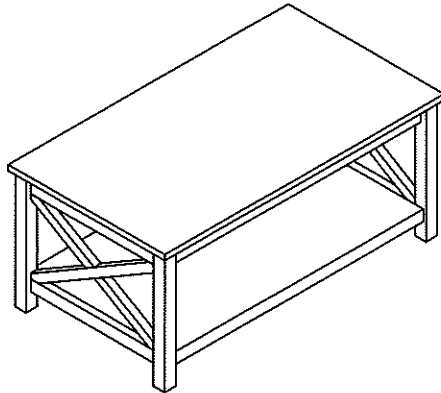

Parts List

NO	SKETCH	Description	QTY
A		Table Top	1 pc
B		Table Leg	2 pcs
C		Shelf	1 pc

Hardware List

NO	SKETCH	DESCRIPTION	QTY
D		Allen Bolt 1/4"X35MM	8 pcs
E		Allen Wrench 4mm	1 pc
F		Wooden dowel Ø8x30	4 pcs

Step 1

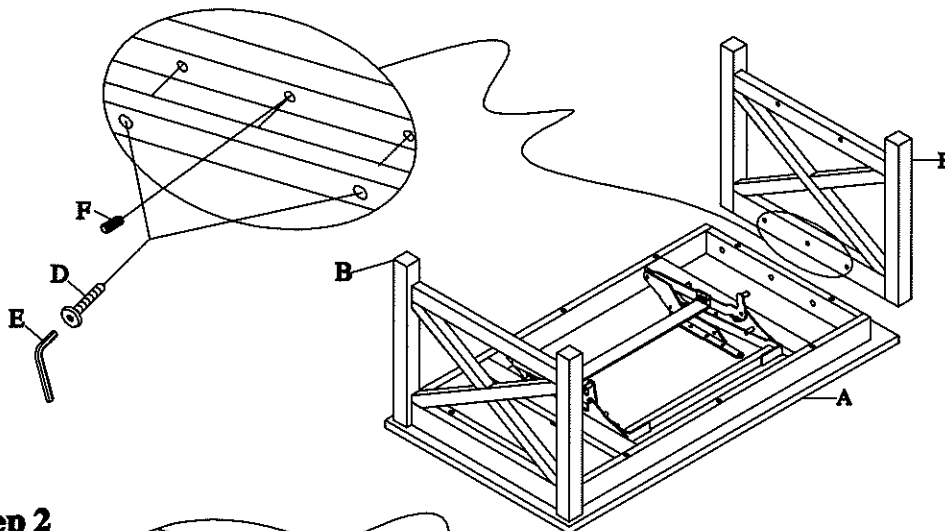

Step 2

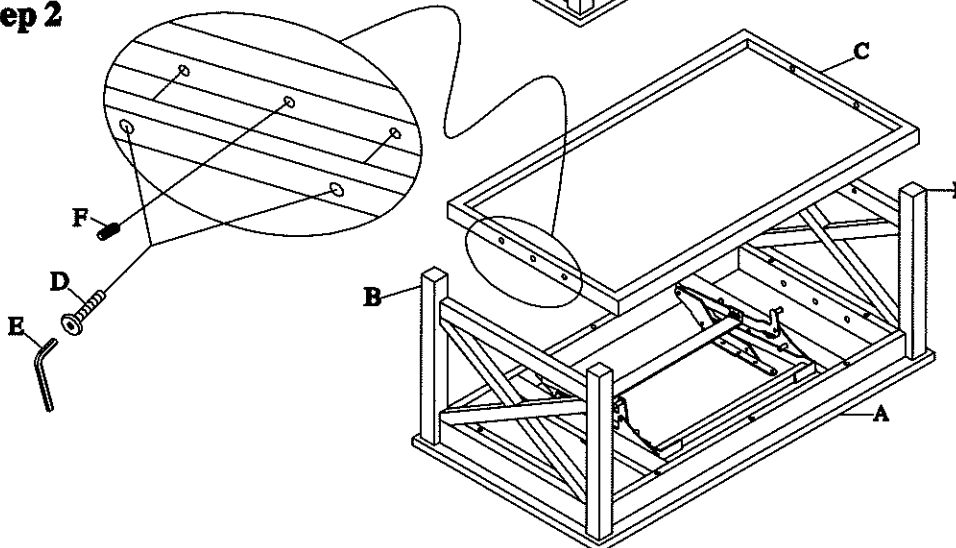

ASSEMBLY INCTRUC TIONS

ITEM NO:P306-95 / P309-95

LIFT-TOP THREE PACK TABLE

Thank you for purchasing this quality product. Be sure to check all packing material carefully for small parts that may have come loose inside the carton during shipment.

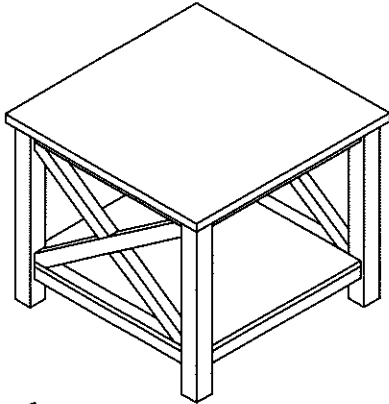

Step 1

Parts List

NO	SKETCH	Description	QTY
G		Table Top	1 pc
H		Table Leg	2 pcs
I		Shelf	1 pc

Hardware List

NO	SKETCH	DESCRIPTION	QTY
D		Allen Bolt 1/4"X35MM	8 pcs
E		Allen Wrench 4mm	1 pcs
F		Wooden dowel Ø6x30	4 pcs

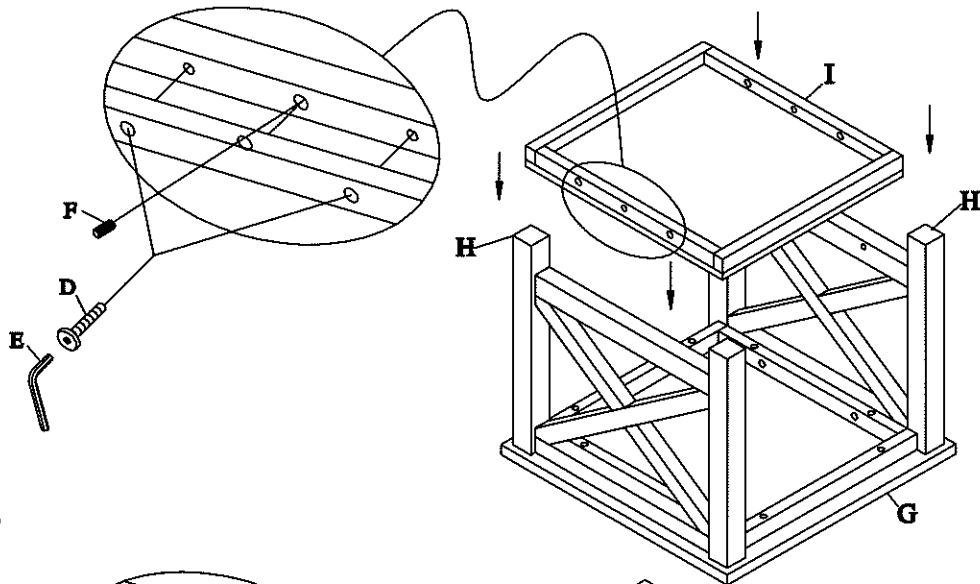

Step 2

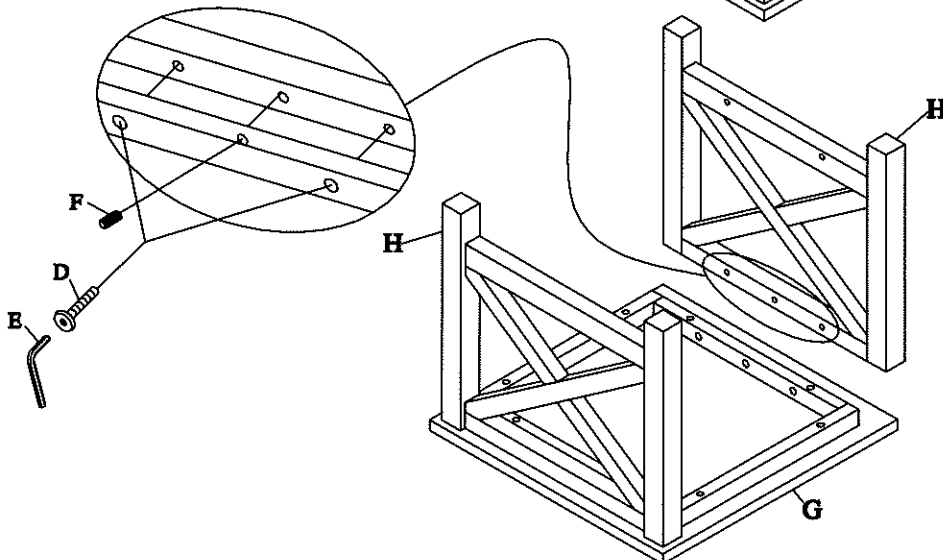

ASSEMBLY INCTRUC TIONS

ITEM NO:P306-95 / P309-95

LIFT-TOP THREE PACK TABLE

Thank you for purchasing this quality product.Be sure to check all packing material carefully for small parts that may have come loose inside the carton during shipment.

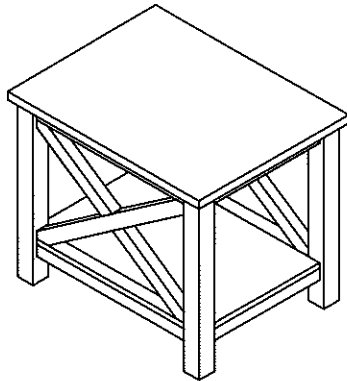

Parts List

NO	SKETCH	Description	QTY
J		Table Top	1 pc
H		Table Leg	2 pcs
K		Shelf	1 pc

Hardware List

NO	SKETCH	DESCRIPTION	QTY
D		Allen Bolt 1/4"X35MM	8 pcs
E		Allen Wrench 4mm	1 pcs
F		Wooden dowel Ø6x30	4 pcs

Step 1

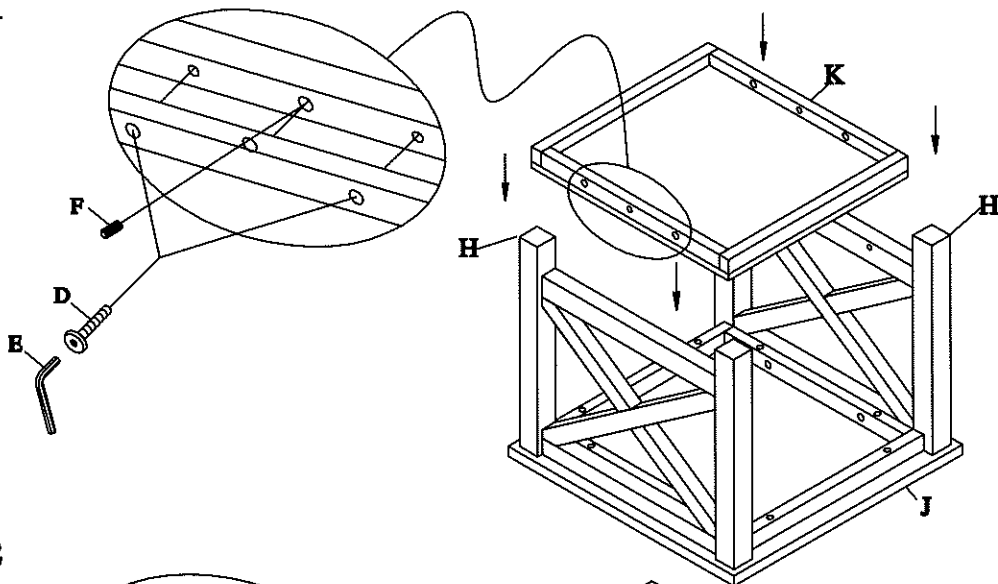

Step 2

