



INSTALLATION INSTRUCTIONS

EUROLINE II SERIES — FLUSH MOUNTED

Product Information

Flush Mounted Euroline II Series Features:

- White Baked Enamel Steel Body
- European Hinges
- Touch Latch Magnet
- Adjustable Glass Shelves



* * Professional Installation is recommended to insure proper installation.

* * Door removal is recommended, but not required for installation.

* * Please do not stand your medicine cabinet on end while unboxing. Lie the cabinet down mirror side up prior to installation. Set on a clean surface, like a towel or carpet to avoid damage.

* * Prior to discarding the packaging, locate shelves, door hardware, and screws where applicable.

Installation Steps

1. Make sure the wall opening is plumb and level prior to installation. This will allow the door to operate properly. (Figure 1)
2. Allow for 1" of clearance on height elevation above any obstructions as illustrated in Figure 2. Note the door will exceed the wall opening by 1" on top and bottom of most cabinets. Refer to technical data for exact sizes.
3. Single door cabinets can be inverted in for right or left hand installation. Locate the hinge to properly select door swing desired. Insert cabinet into wall opening making sure the flange covers the rough wall opening evenly. You may need to insert shims as needed (not included). (Figure 3)
4. For drywall/wood stud applications insert wood screws into pre-drilled mounting holes located on the interior sides of the cabinet. (Pro-tip do not overtighten with this will wrack the cabinet) use a level to test that the cabinet is plumb. (Figure 4)
5. Insert shelf clips at desired height locations and place glass shelf. Do not install shelves prior to cabinet installation.

NOTICE:

1. Gently close the cabinet door to avoid potential injuries and damage. Damaged glass should be replaced right away.
2. The cabinet must be installed onto a solid wall. (Thinner wood siding wall and hollow wall are not applicable)

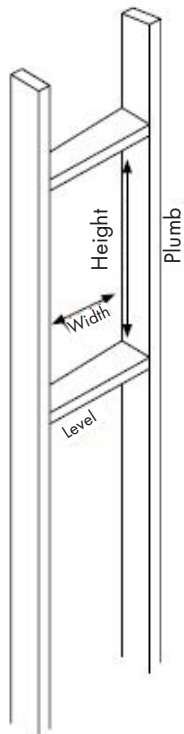

Fig. 1

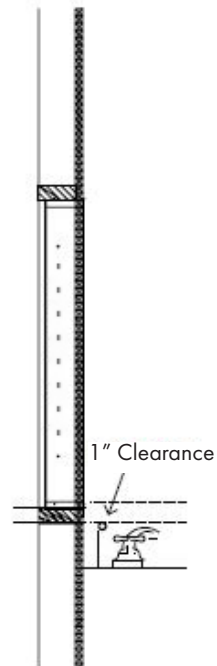

Fig. 2

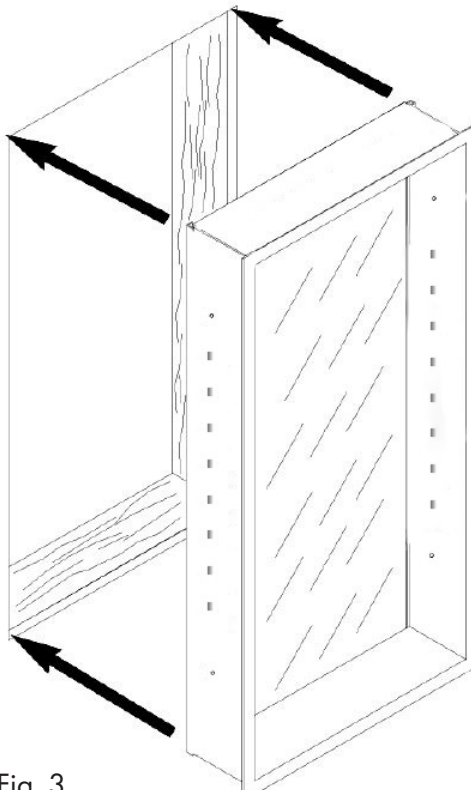

Fig. 3

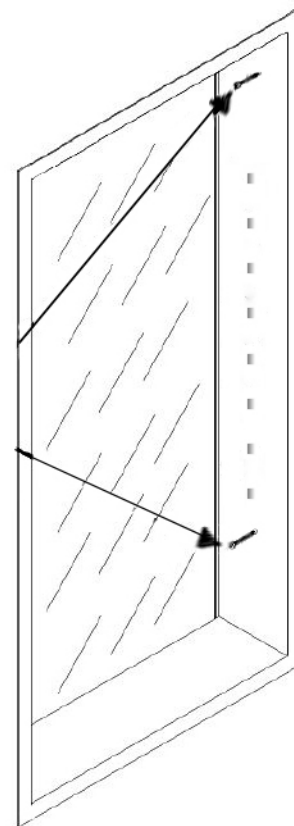

Fig. 4