



# LIBERTY FURNITURE

## ASSEMBLY INSTRUCTION

ITEM# **LB#545 - BR22H/BR22F(BR21H/BR21F)/BR91**

DESCRIPTION: **KING UPH SLEIGH BED**  
**QUEEN UPH SLEIGH BED**

Thank you for purchasing this quality product. Be sure to check all packing material carefully for small parts which may have come loose inside the carton during shipment. Identify and count all parts and compare with the parts List Below:

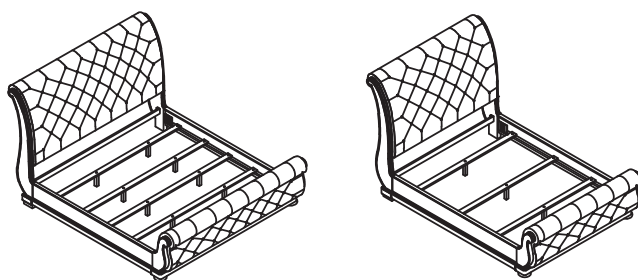

HARDWARE LIST			
NO.	Drawing	Description	Q'ty
A		Threaded Bolt (Ø5/16"x3-1/2")	8pcs
B		Flat washer (Ø5/16"x19mm)	8pcs
C		Spring washer (Ø5/16")	8pcs
D		Hex Nut (Ø5/16")	8pcs
E		Ø5/16" Wrench(12mm)	1pc
F		Wood screw Ø8 x 1-1/4	8pcs

### PART LIST:

HEAD BOARD: 1PC	FOOT BOARD: 1PC	SIDE RAIL : 2PCS	King Bed Slats : 4pcs	King Bed Support legs : 8pcs
			Queen Bed Slats : 3pcs	Queen Bed Support legs : 3pcs

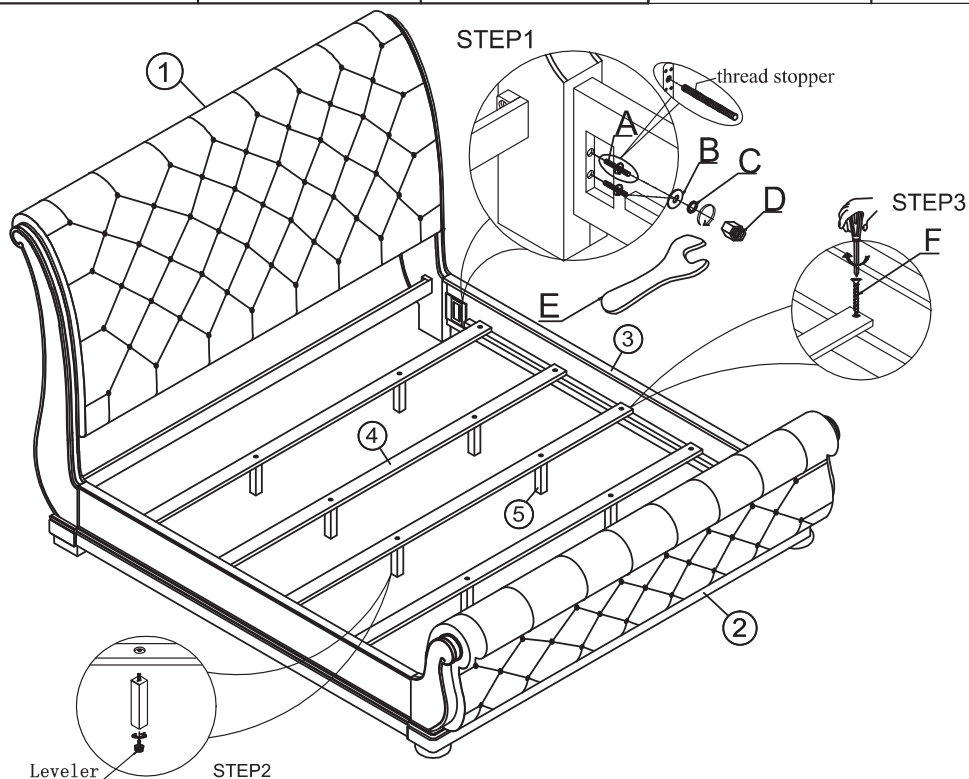

## CLEANING INSTRUCTION

Clean the Bed surface with a furniture polish and a soft cloth.

Made in VietNam



# LIBERTY FURNITURE

## ASSEMBLY INSTRUCTION

DESCRIPTION: KING UPH SLEIGH FOOT BOARD

ITEM# LB#545 - BR22F

Thank you for purchasing this quality product. Be sure to check all packing materials carefully for small parts, which may have come loose inside the carton during shipment. Identify and count all parts and compare with the parts list below.

### PARTS LIST:

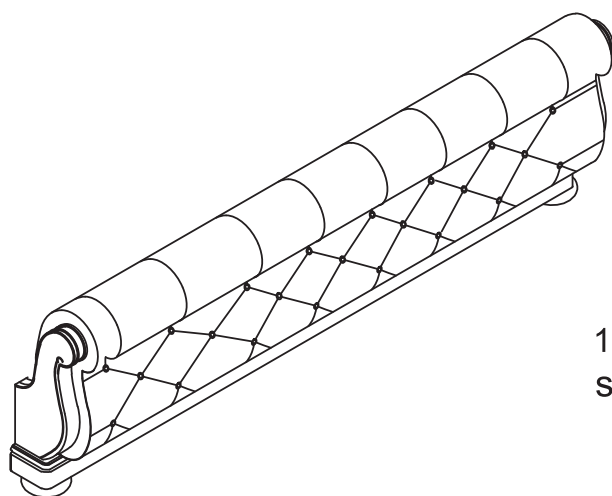

FOOTBOARD : 1PC	BUN FOOT: 4PCS

1. Remove bun foot from inner box and secure bun foot as shown on drawing.

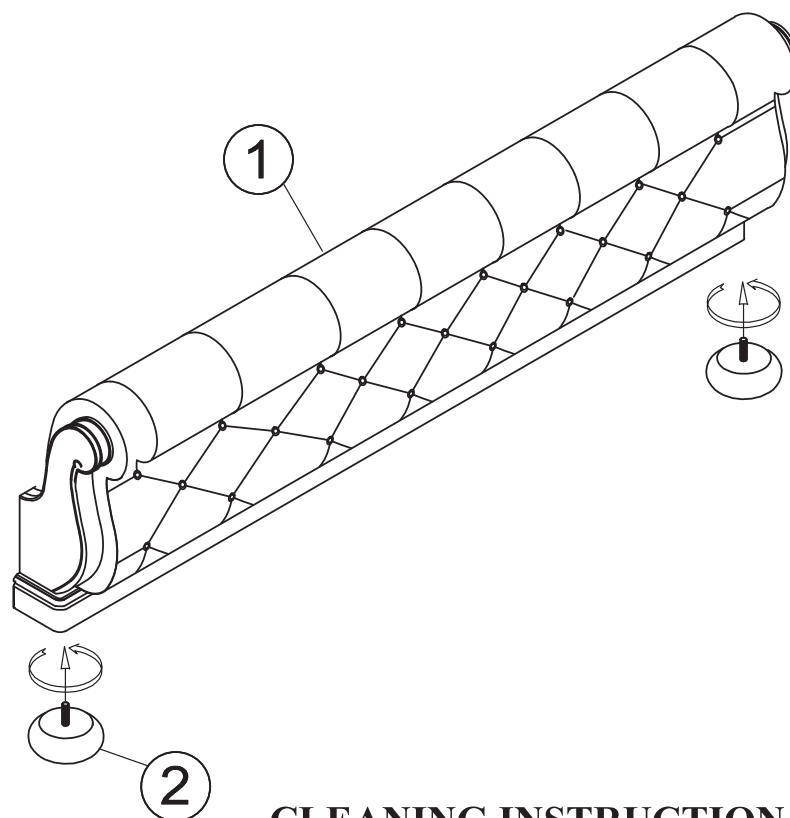

### CLEANING INSTRUCTION

Clean the King Sleigh Footboard surface with a furniture polish and a soft cloth.

Made in VietNam