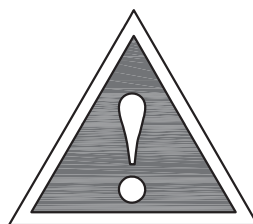
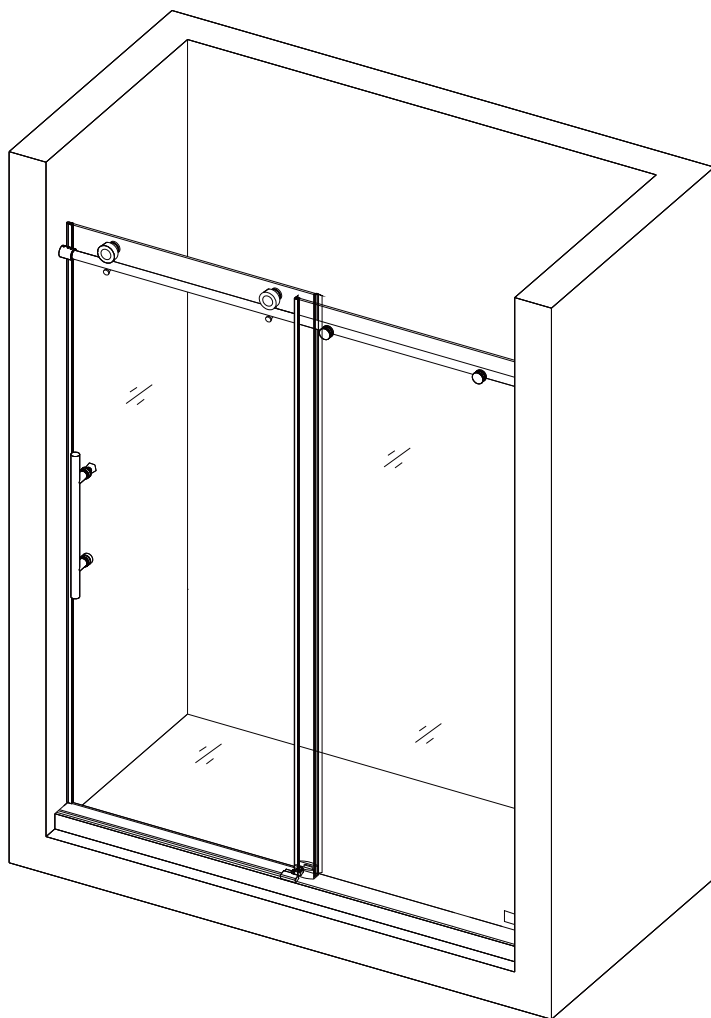

# **SHOWER ENCLOSURE HANGING WHEEL SLIDING DOOR INSTALLATION INSTRUCTIONS**

**Model: SSD6076-08CH-Soft / SSD6076CH-Soft /  
SSD6076-08BN-Soft / SSD6076BN-Soft /  
SSD6076-08MB-Soft / SSD6076MB-Soft /  
SSD6076-08BNG-Soft / SSD6076BNG-Soft**

**Maintenance tip:**

The following substances or articles may cause physical harm and/or damage the shower door.

Do not use them for cleaning:

Acid and alkaline solvents, chemicals such as hydrochloric acid, acetone thinner, solvents, cleansers, or polishers, nylon brooms or sandpaper.

**Our product may have changes without prior notice**

## Important Note

### Attention:

The Glass Shower doors include with anti-shatter film-on the reverse side of the certification printed logo.

See the Fig1 & Fig2

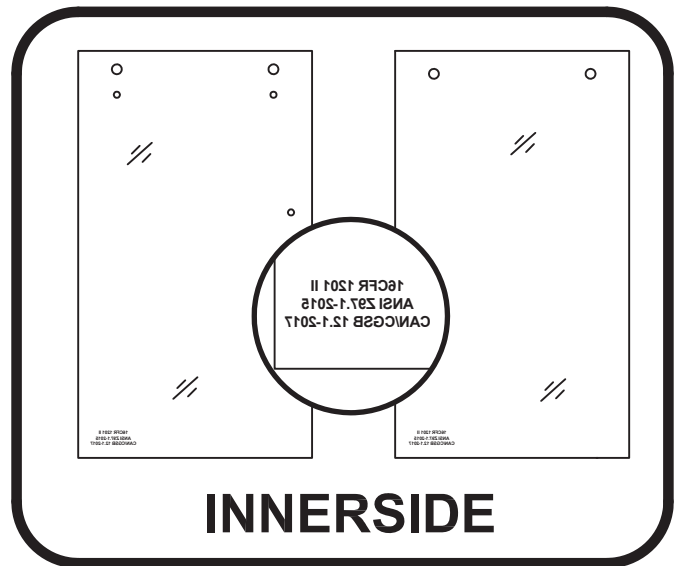

Fig 1

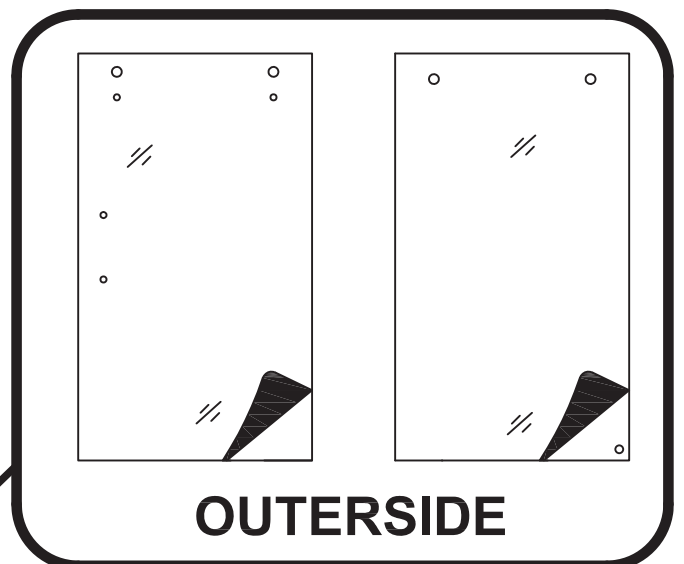
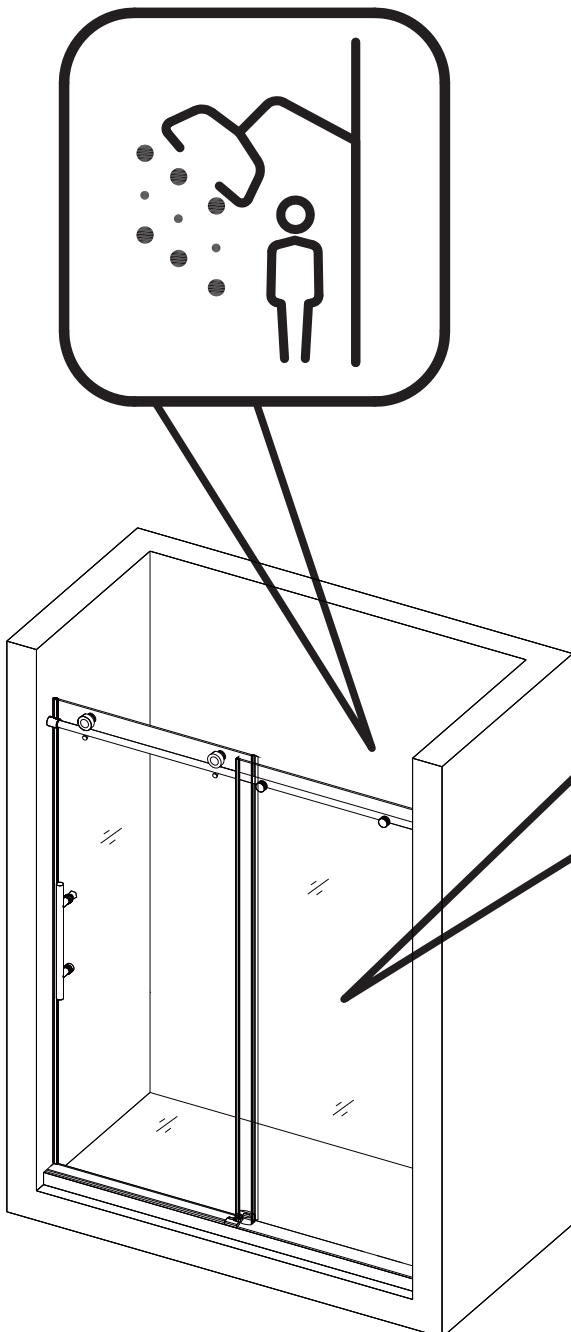
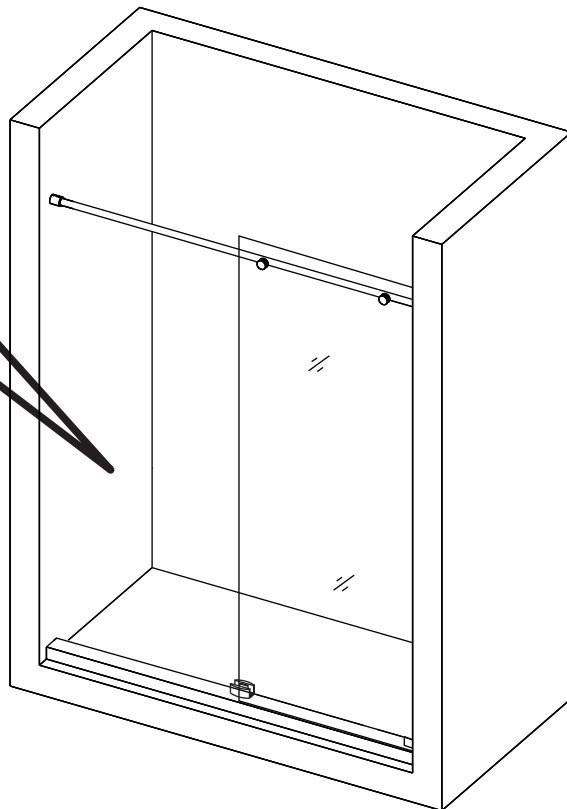
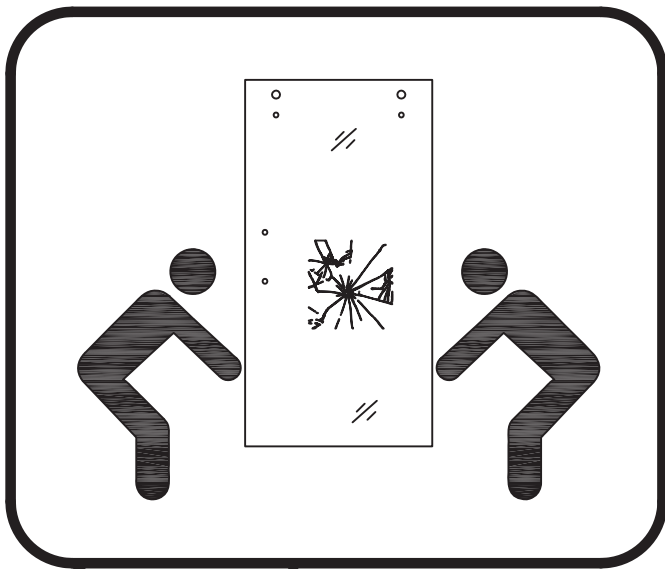

Fig 2



With anti-shatter film helps to hold glass in place in the event of breakage. So as to prevent the glass shatter will hurt the user. Allowing the panel to be carefully removed by a professional at a later date.



**In the event of breakage please follow the steps below.**

- 1. If someone is inside the shower, move the panel slowly out of the way and exit the bathroom as soon as possible. Do not allow anyone to re-enter bathroom until prepared to remove and dispose of broken panel.**
- 2. Utilize safety precautions such as a hard-hat, safety glasses, leather gloves, proper footwear and moving blankets to minimize risk of injury.**
- 3. It is recommended that two people assist in the removal of the panel. One person to hold panel steady, and the other to un-install the hardware. Then carefully remove glass from shower and lay flat on cardboard or plywood until it can be removed. Once laying flat, a razor knife or box cutter can be utilized to cut the film and remove in smaller pieces.**

# PREPARATION

1. WE STRONGLY RECOMMEND THAT A LICENSED AND INSURED PROFESSIONAL CONTRACTOR TO INSTALL THIS PRODUCT INCLUDING THE ASSISTANCE OF A SECOND PERSON DURING INSTALLATION.
2. After opening all boxes and packages, read this introduction carefully. Check that all of the needed parts are included in the package by marking all the components on the "Detailed Diagram of Shower Door Components". Examine boxes and packages for shipping damage. If the unit has been damaged, has a finishing defect, or is missing parts, please contact our customer support department to be served immediately. Please note that We will not replace any damaged products or missing parts free of charge after 5 business days or if the product has been installed. Feel free to contact your local distributor if you have any questions.  
**VERY IMPORTANT:** Please double check the glass corner and four edges of the glass door and fixed panel to make sure that all the glass are in perfect condition and without any breakage. Please do not try to install the shower door, if there is breakage to the glass corner.
3. Please note that you should consult your local building codes with questions on installation compliance standards. Building and plumbing codes may vary by location, and We are not responsible for code compliance standards for your project and will not accept any returns.
4. Prior to installation, ensure that the installation surface is leveled and solid and will be able to support the total weight of the unit. Also, make sure the walls are at the right angles. Irregular installation surface level or improper angle of side walls will result in serious problems during installation. Please, note that some adjustments and drilling might be necessary during the installation process.
5. **NOTE!** This door does not have out-of-plumb adjustment. Make sure your walls are at right angles.
6. This door requires a minimum 2 3/4" wide threshold, base or installation space. Please note that Step 6 calls for installation of the door to the wall using anchors. However, the manufacturer strongly recommends installing these heavy doors to the studs or to preinstalled 2" x 4" wood reinforcements behind the wall and attach the Wall brackets to it.

**ATTENTION: THIS DOOR IS EXTREMELY HEAVY AND REQUIRES PROFESSIONAL INSTALLATION. INSTRUCTIONS ARE GIVEN FOR THE SHOWER DOOR INSTALLATION. PLEASE, FOLLOW THE SAME INSTRUCTIONS TO INSTALL THE GLASS DOOR. INSTRUCTIONS THAT, IF IGNORED, COULD RESULT IN DEATH OR SERIOUS PERSONAL INJURY CAUSED BY INCORRECT HANDLING OR INSTALLATION OF THE PRODUCT. THESE INSTRUCTIONS MUST BE OBSERVED FOR SAFE INSTALLATION.**

## TOOLS REQUIRED



Soft Cloth  
or Blanket

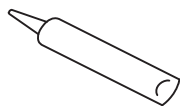

Caulk

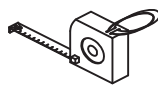

Tape  
Measure

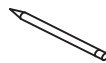

Pencil

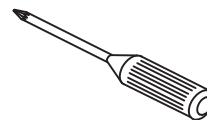

Phillips  
Screwdriver



Drill Bit  
=ø8



Safety Glass



Level

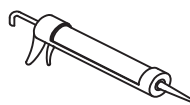

Caulk Gun



Drill

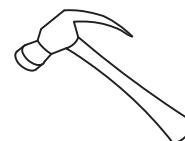

Hammer

**OTHER TOOLS MAY BE REQUIRED**

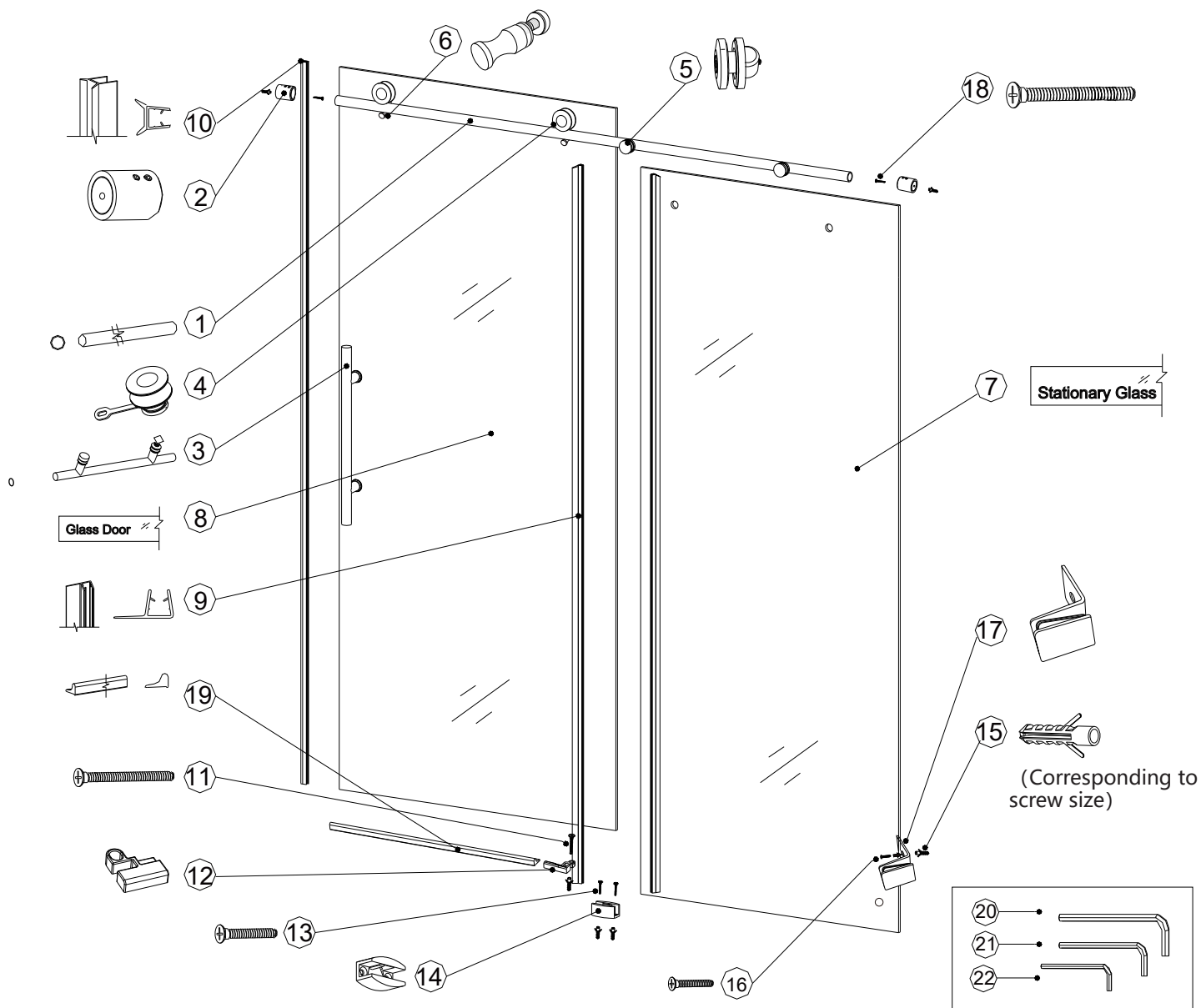

No.	Description	QTY	No.	Description	QTY
1.	Upper Guide Rail	1PC	13.	Screw M4X30	2PCS
2.	Guide Rail Bracket	2PCS	14.	Guide Block	1PC
3.	Handle	1PC	15.	Wall Anchor (Corresponding to screw size)	7PCS
4.	Roller	2PCS	16.	Screw M4.8X32	1PC
5.	Glass Bracket	2PCS	17.	L Wall Cover	1PC
6.	Safety Pin	2PCS	18.	Screw M5X40	2PCS
7.	Stationary Glass	1PC	19.	Anti-splash Threshold	1PC
8.	Glass Door	1PC	20.	M6 Allen key	1PC
9.	Side Anti-Water Strip	2PCS	21.	M5 Allen key	1PC
10.	Bumper Strip	1PC	22.	M2.5 Allen key	1PC
11.	Screw M4X25	2PCS	<b>TEAR OFF THE PROTECTIVE SOFT FILM ON THE GLASS WITH LABEL STICKERS BEFORE INSTALLATION</b>		
12.	Cover(optional)	1PC			

If there are no structural limitations in the shower room,  
we recommend the installation as shown " ✓ " below

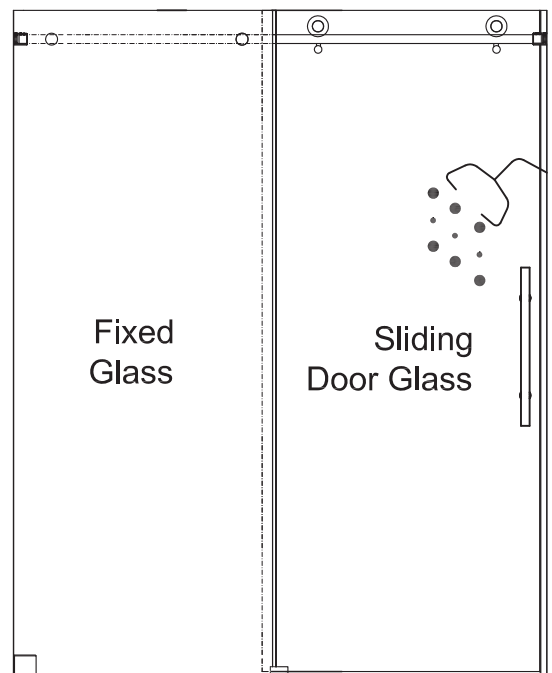
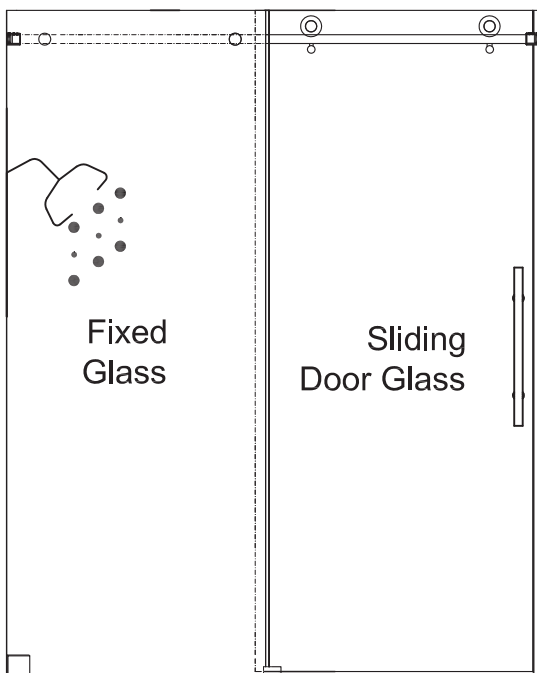
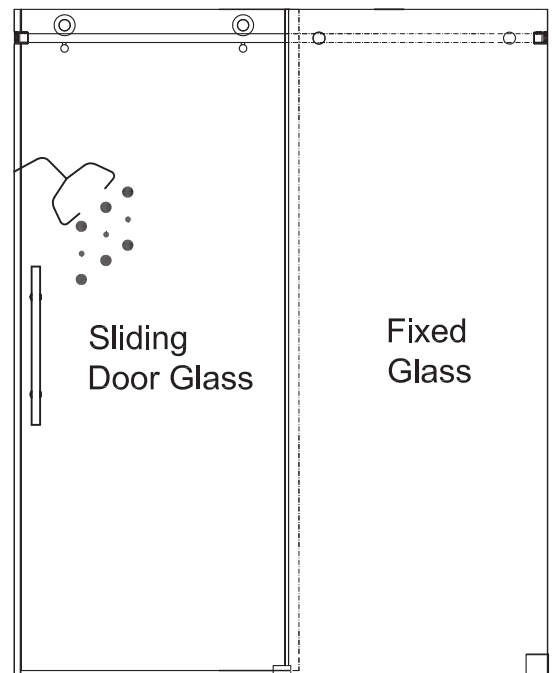
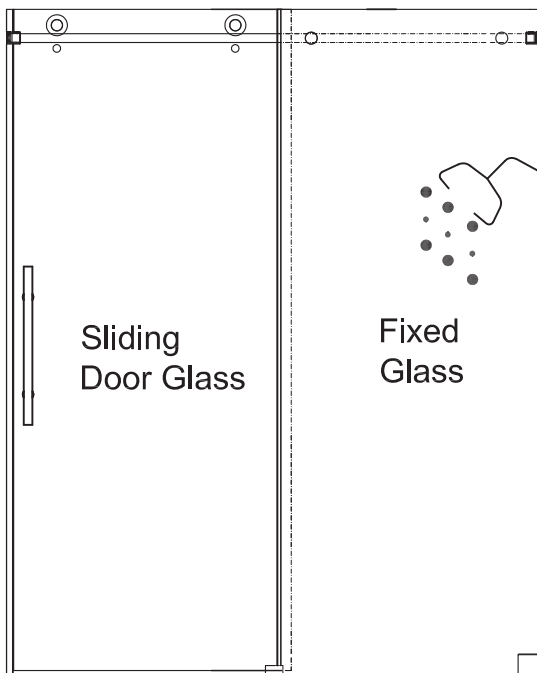

## TIPS

01:

Open the packaging carefully and inspect all the necessary parts using detailed diagram and component list in your manual as a reference. Before discarding the carton, check for small hardware bags that tend to fall to the bottom of the box. If any parts are damaged or missing, please contact us for replacement.

02:

Retain these installation instructions for future use if in need.

1. Measure the distance between two finished walls. This distance is marked as W.

Please see Fig 1 for details:

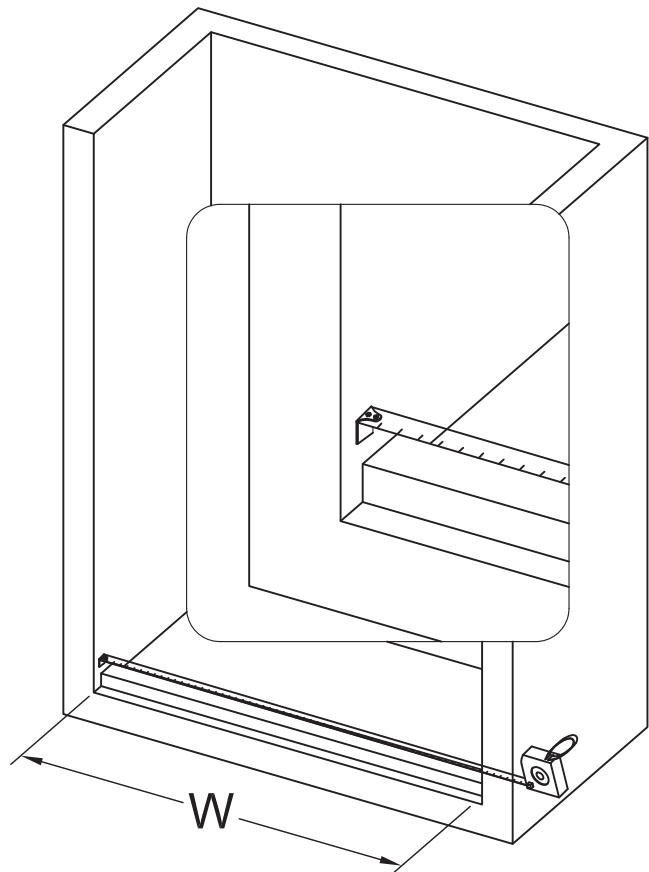
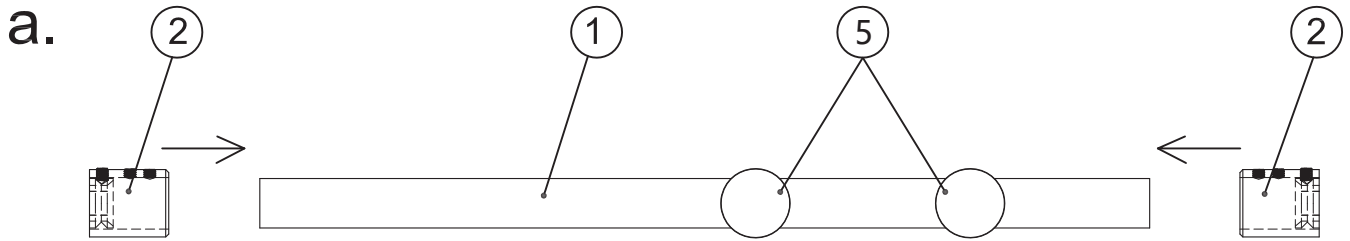
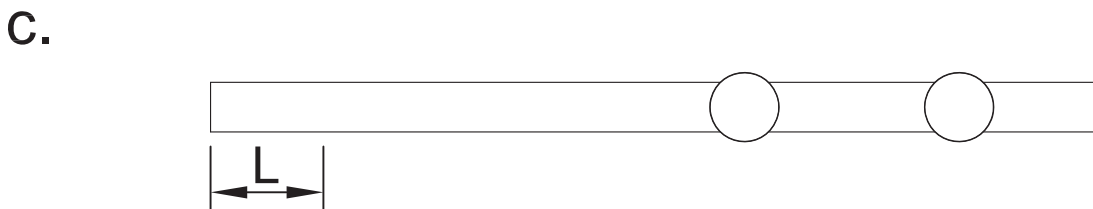
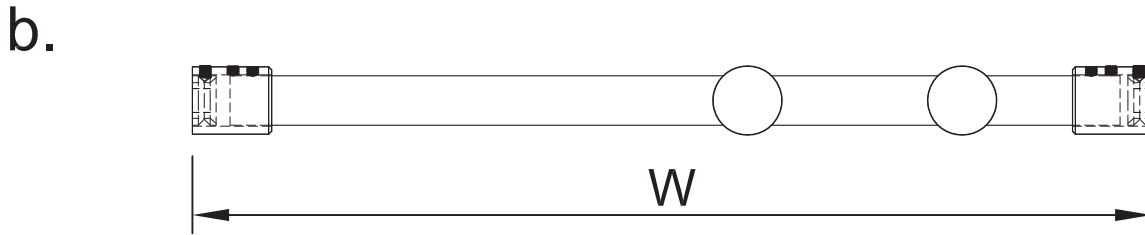

Fig 1



Note: The Glass Brackets( 5 ) have been pre-installed to the Upper Guide Rail(5).



2. Your Upper Guide Rail (01) has been precut for your Shower model opening width, eg. 60" for shower width.

If W-width of your wall-to-wall opening is equal to the size of your Shower model, it is unnecessary to cut the Upper Guide Rail and you can continue to Step 3.

If W-width of your wall-to-wall opening is less than the size of your Shower model, you will need to cut the Upper Guide Rail from the end which is farther from the Glass brackets (05) holes.

The length to cut off will be L:

$L = \text{Shower model size} - W$   
 $L = \text{Subtract } W \text{ from the size of your Shower model.}$

**FOR EXAMPLE**

If your wall opening  $W = 59"$ . Your shower model is 60".

$L = 60" - 59" = 1"$ ,

You have to cut 1" off from the rail.

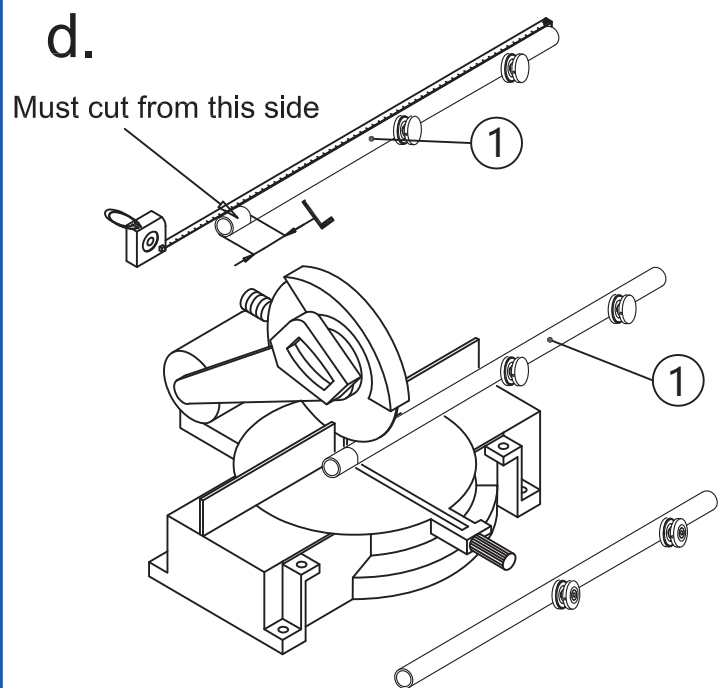
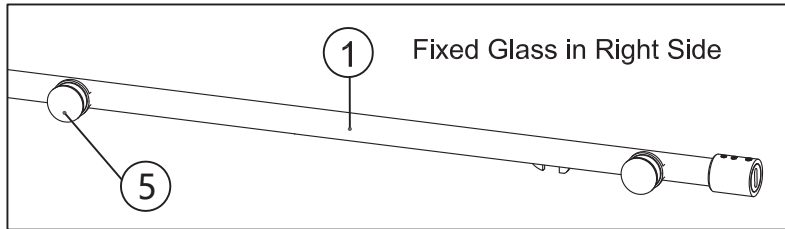

Fig 2

Please see Fig 2 for details





**Fig 3** - For Right Opening Door

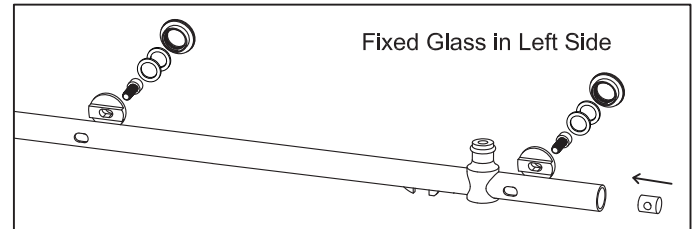

**Fig 4** - For Left Opening Door

3. Unscrew the Glass Bracket (5) fixed on Upper Guide Rail (1) and split it into two parts, one of which is still fixed on the upper guide rail. Place the two parts on each side of the Stationary Glass (7), corresponding to the holes above the Stationary Glass (7), and then screw the removed section back to the part fixed to the Upper Guide Rail (1)

Never set your glass down directly onto a tile or concrete floor.

Always use a piece of wood or cardboard and leave the corner pads on the glass until it becomes necessary to remove them to protect the bottom edge and the corners of the glass from breakage.

Please see Fig 3 & Fig 4 for details

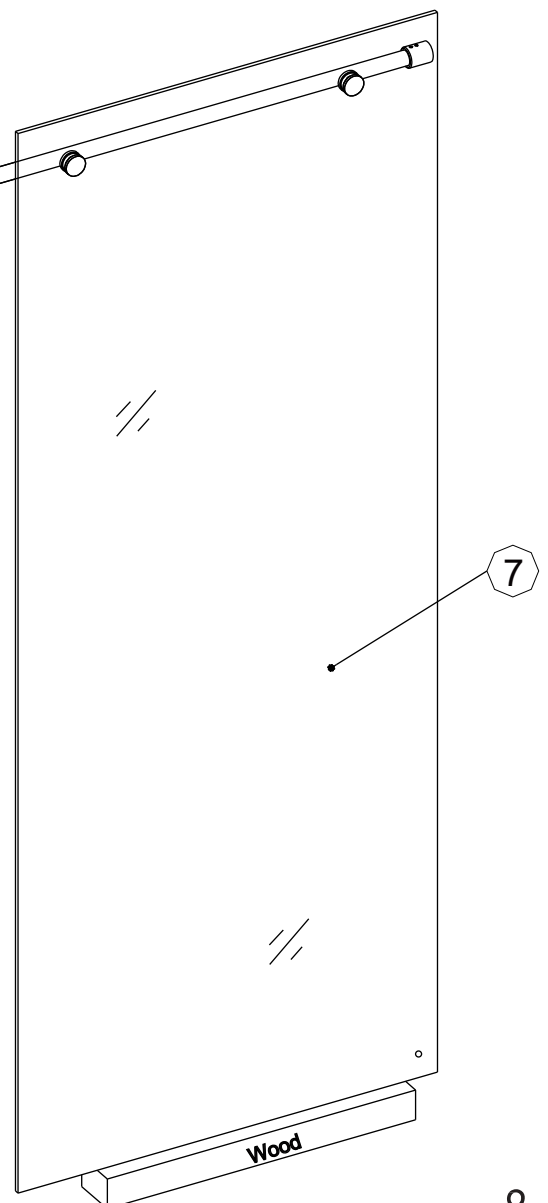
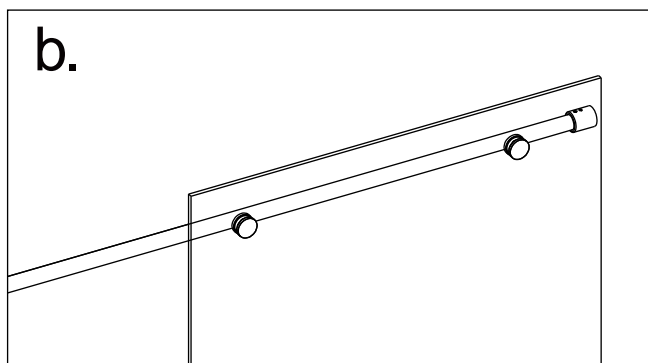
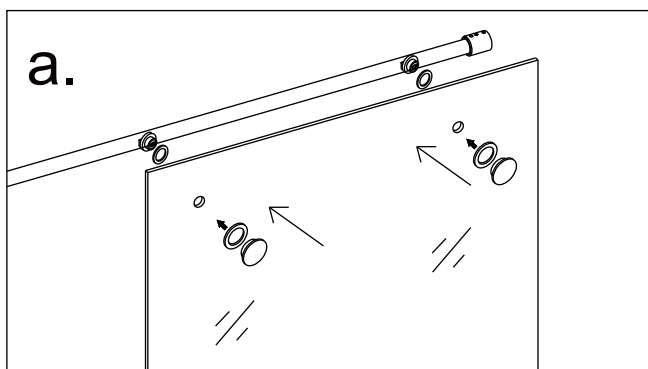

4. Make a mark on a wall perpendicular to the ground at a height of 72.84 inches, then drill holes in the determined position and apply silicone into the holes, insert the Wall anchors (15) for the Guide Rail Bracket.

Mount the Wall Bracket of the Guide Rail Bracket (2) to the wall by using the Screw M5X40 (18). The other side of the Guide Rail bracket (2) is installed in the same way.

Please see Fig 5 for details:

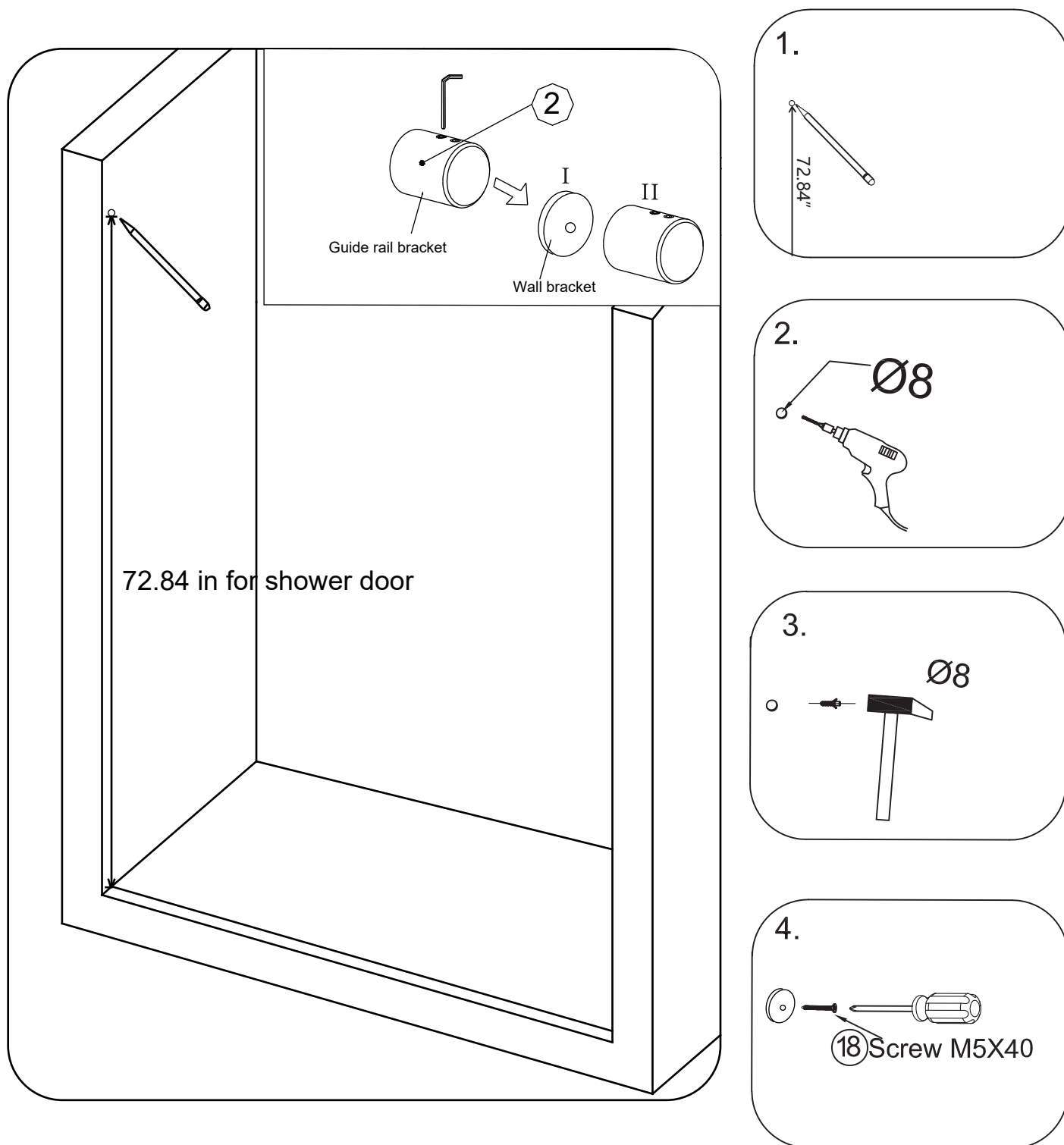

Fig 5

5. Place the Stationary glass (7) back into the designated position. Slide the II part of the Guide Rail Brackets (2) to the two end sides of the Upper Guide Rail (1), then connect II and I part of the Guide Rail Brackets (2). Tighten the set screws on the Guide rail bracket (2) with Allen Key (22) to secure the guide rail to the wall. Cover the L wall cover (17) with glass on one side, and lock the L wall cover on the wall with Screw M4.8X32(16) on the other side.

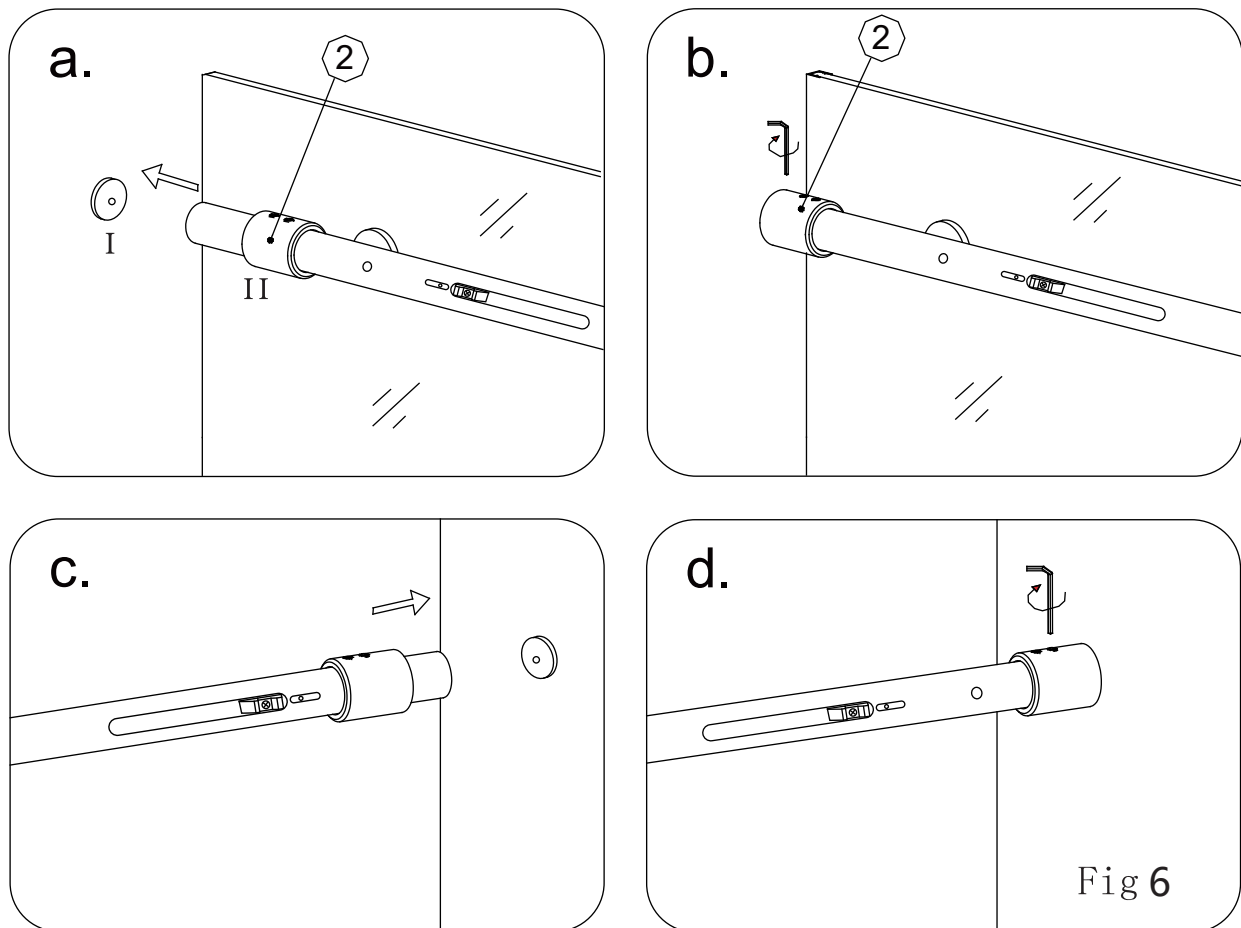

Fig 6

Please see Fig 6 & Fig 7 for details

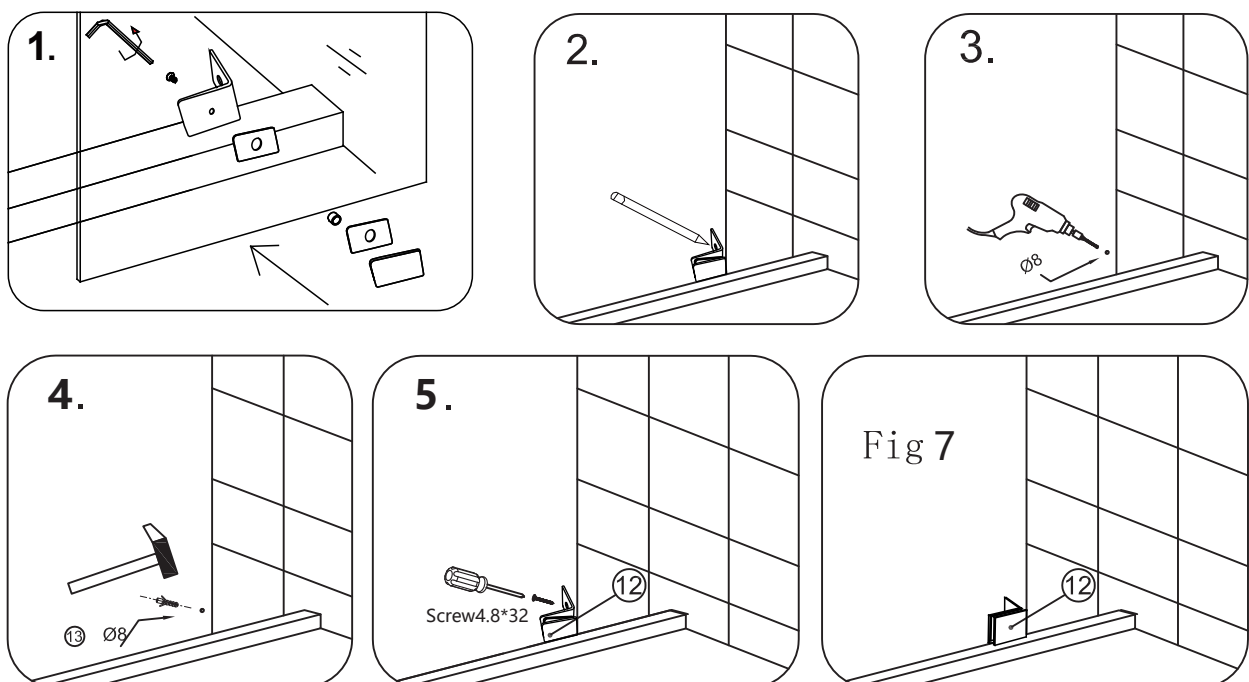

Fig 7

6. Loosen the Rollers (4) screw as shown in the figure to disassemble the rollers (4) and install the rollers to the glass door (8). And then Install Handle (3) and Bumper Strip (10) to the glass door (8).

Please see Fig 8 for details:

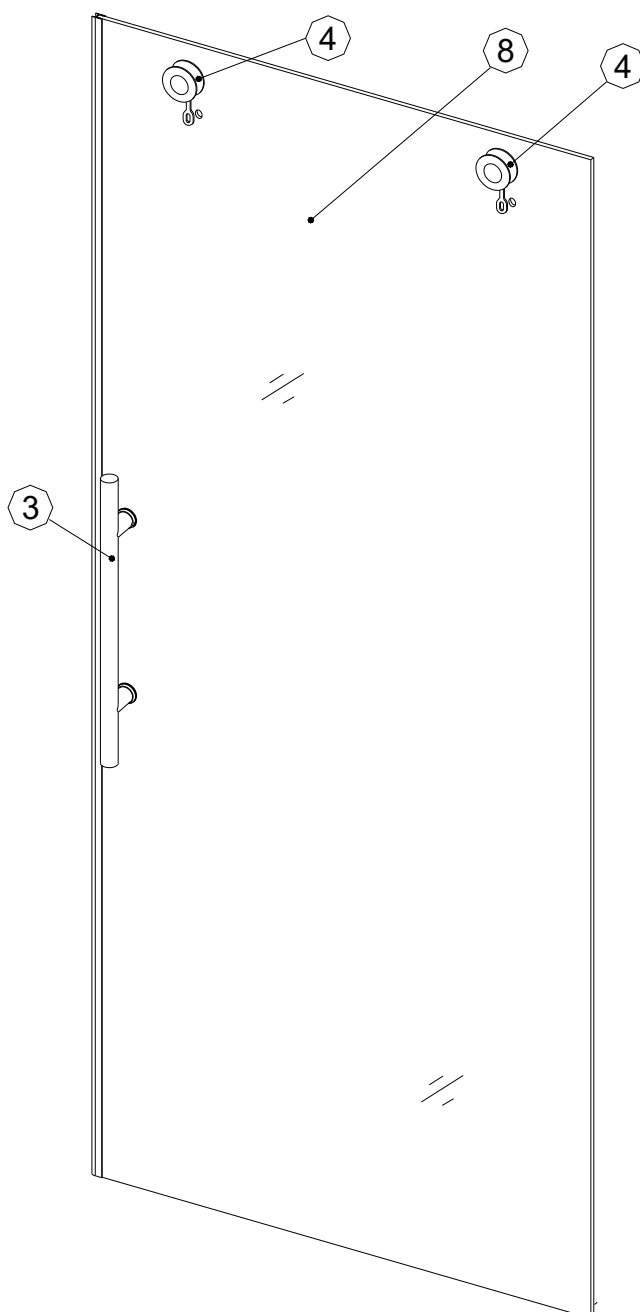
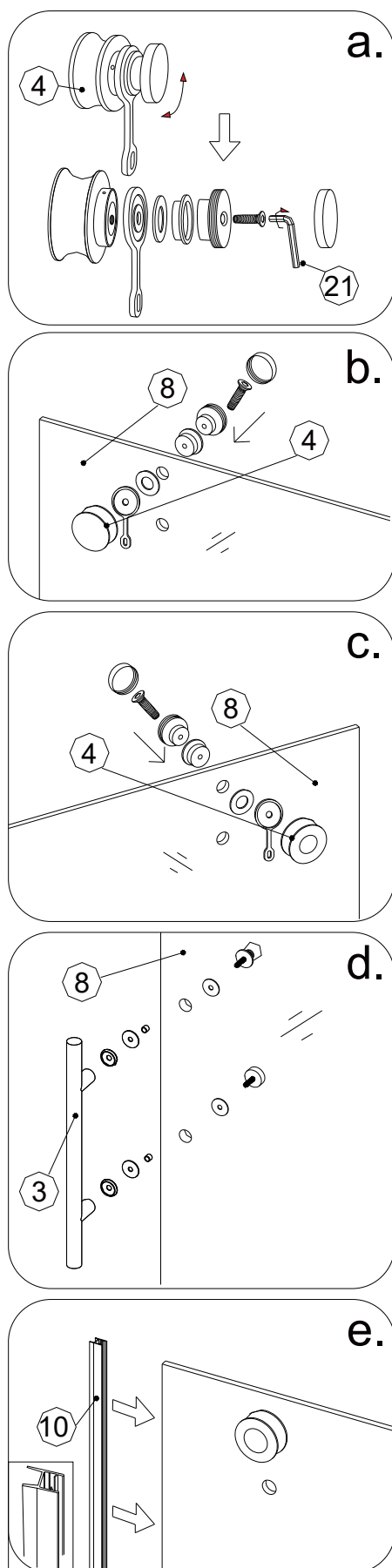

Fig 8

Attention: Need to loosen the small allen screws before loosening the long allen screw on the roller

7. Hang the Glass Door (8) installed with rollers, handles and strip to the Upper Guide Rail (1). Slide the Guide Block (14) to the bottom of the glass door. Mark down the predrilled position of the guide block. Set the glass door aside. Now drill the hole with drill bit to the threshold. Put the silicone to the hole and then put the wall anchor (15) into the hole. Now secure the guide block to the threshold with Screw M4X30 (13)

Please see Fig 9 for details:

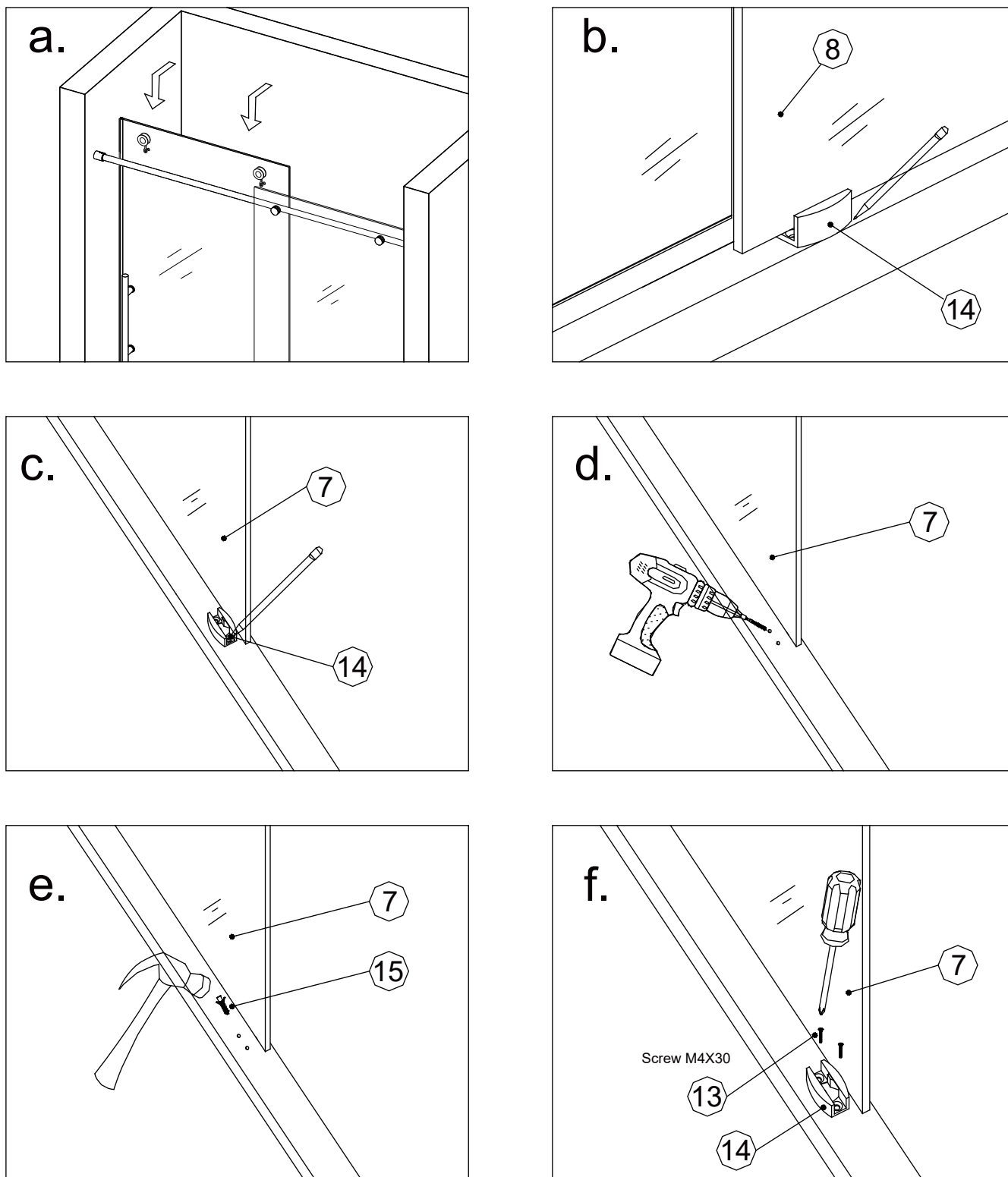

Fig 9

8. Hang the Glass Door (8) back to the upper Guide Rail (1) , slide the bottom of the glass door into the slot of the Guide Block (14). Be careful that the glass door should not touch the metal part of the guide block.

Please see Fig 10 for details:

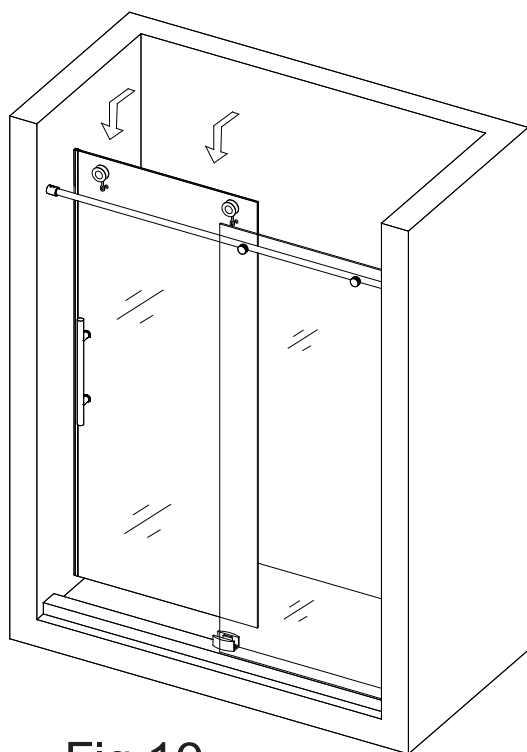
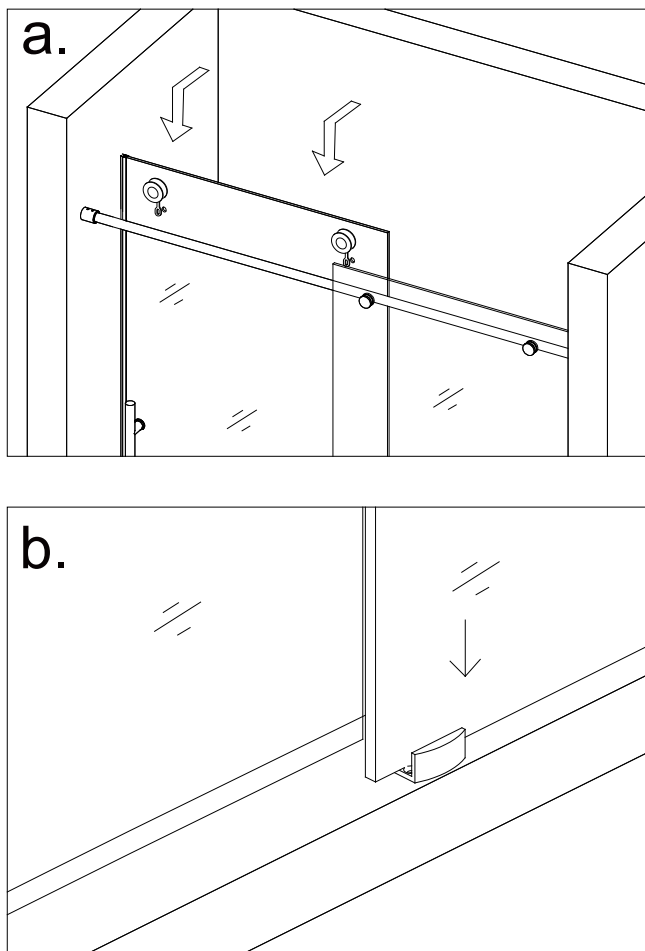

Fig 10



9. Slide the Side Anti-Water Strip (9) to the Stationary Glass (7), remove the flapper that interferes with the Upper Guide Rail (1)

Before installing the Side Anti-Water Strip(9) and Bumper Strip(10) , lubricate the surface with water avoid damaging the explosion-proof film.

Please see Fig 11 for details:

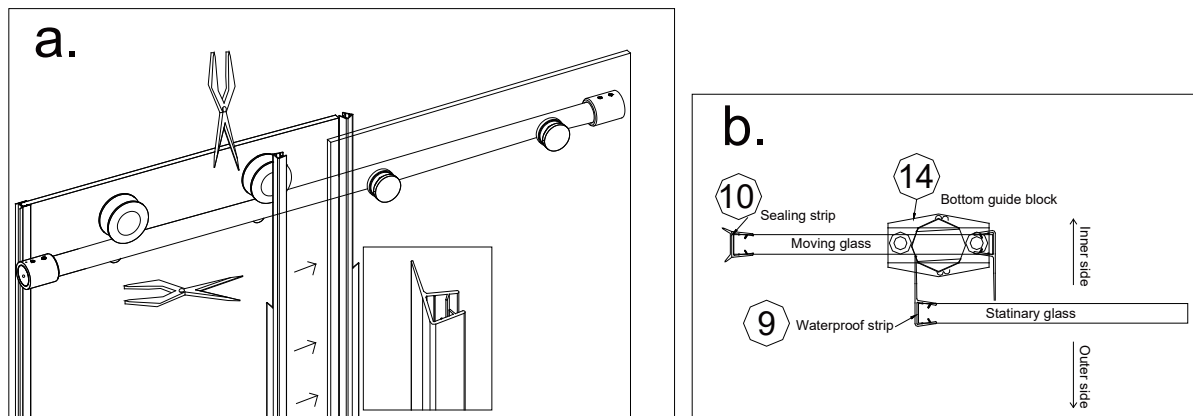
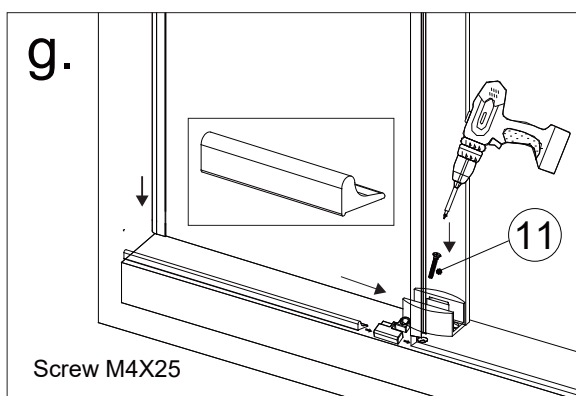
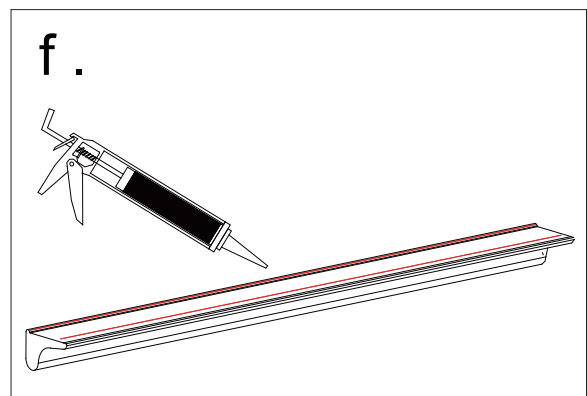
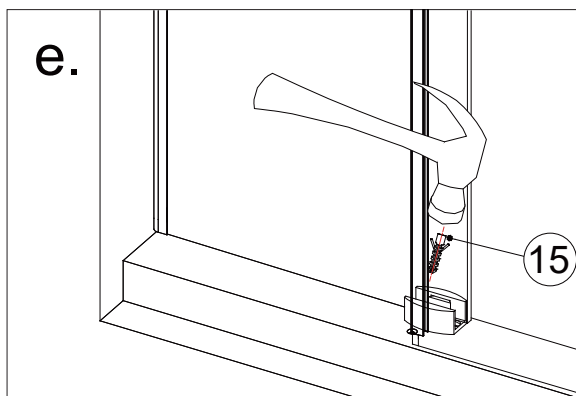
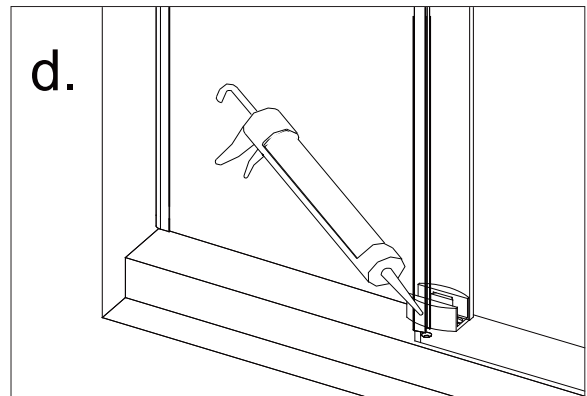
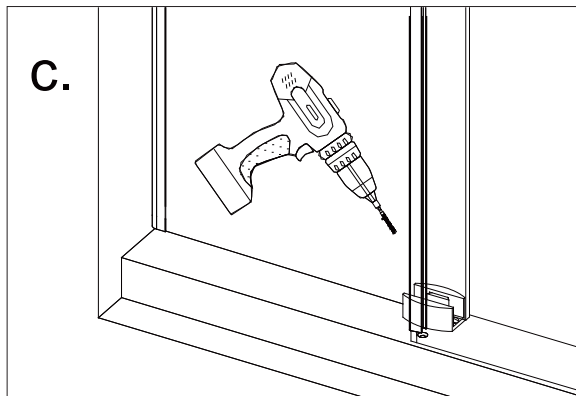
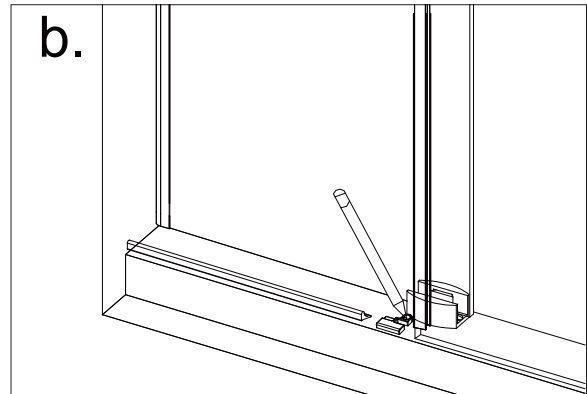
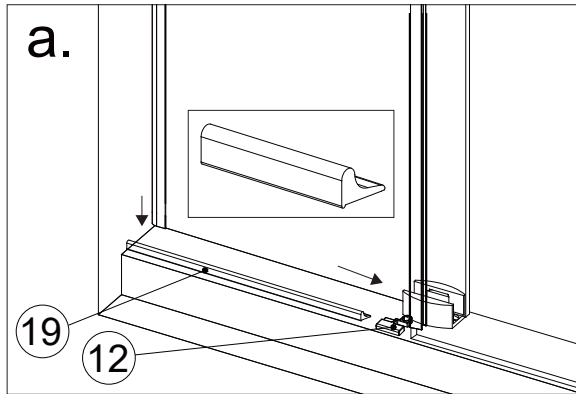

Fig 11

10. Install the Anti-Splash Threshold (10) in front of the Glass Door (8): Put the Anti-splash threshold (19) in front of the sliding Glass Door (8), and then put the Cover (12) with slot on head of the Anti-splash threshold (19), slot corresponds to the end of the Stationary Glass and inserts the Stationary Glass into the slot.

Mark down the predrilled holes, drill the holes with drill bit, put the wall anchor (15).

Use M4x25 Screw (11) to install the Cover (12) at the drilling position then put silicone sealant to the bottom of the Anti-splash threshold (19), secure it to the floor



### Note:

Only one is needed. According to the installation direction of the shower room, select the left or right part and install it between the Stationary glass and the Anti-splash Threshold as shown in the exploded views (Because there are two accessories on the left and right, two screws and two expansions are provided. Only one screw and one expansion are needed in using)

11. Install the Safety Pin(6) to the GlassDoor (8). Make sure that the clear gasket will be between the glass and the metal parts of the safety pin.

Please see Fig 12 for details:

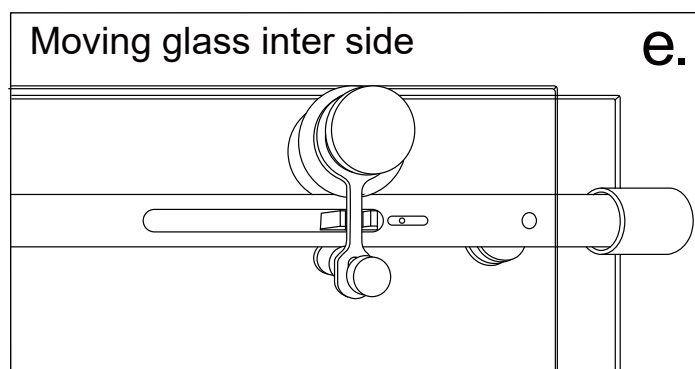
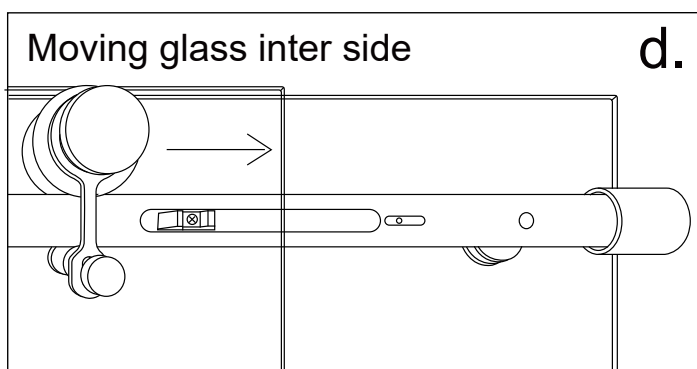
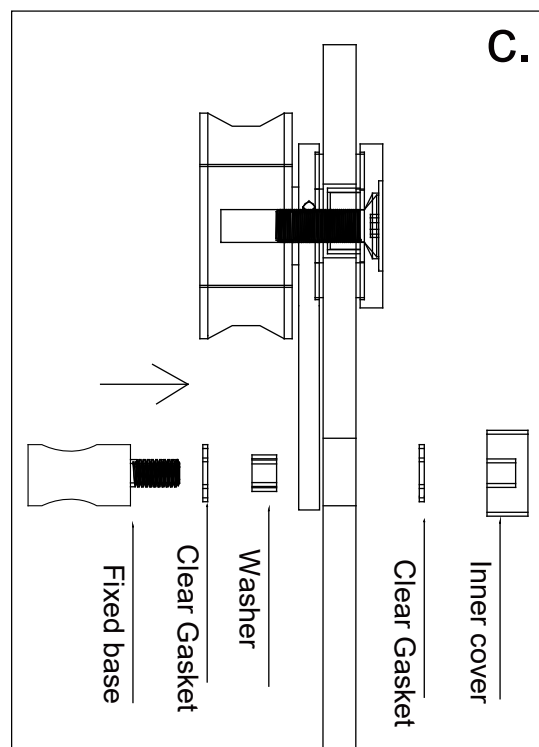
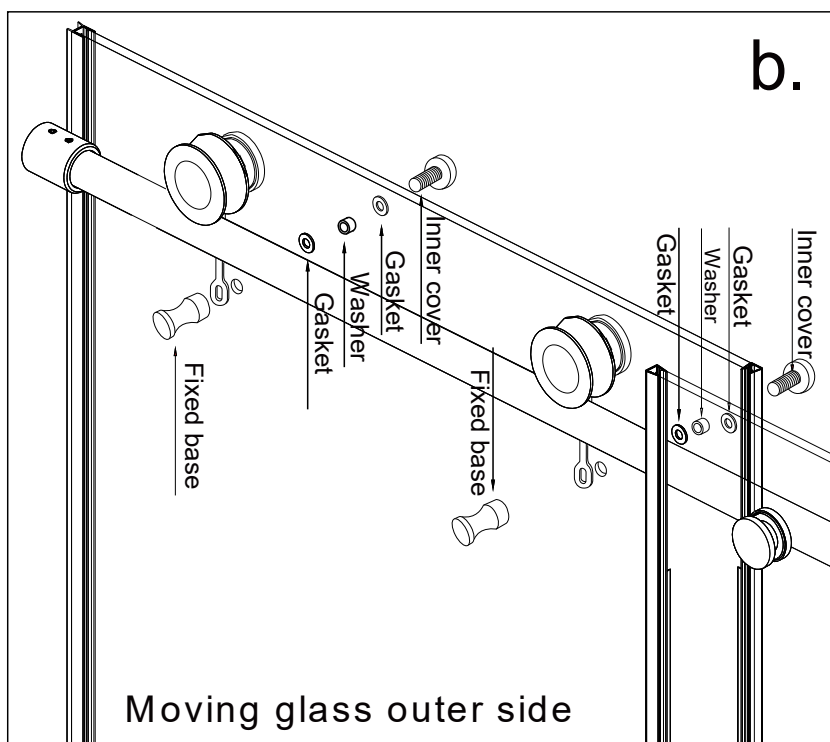
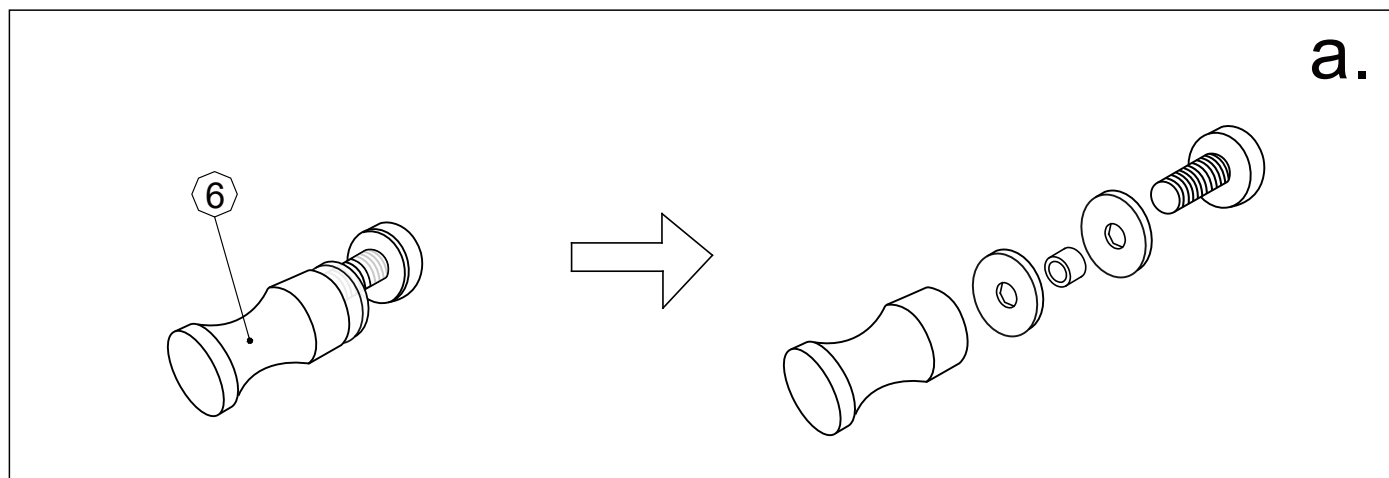

Fig 12



12. Adjust the buffer on the Upper Guide Rail (1) to fix the buffer speed and position of the Roller (4) moving to the leftmost or rightmost end.

Adjust the fasteners on both Rollers (4) to ensure that the bottom edge of the Glass door (8) will not touch the bottom of the guide block (14). Please make sure that the Glass Door (8) especially the door corners will not hit the walls when closed and opened.

Please see Fig 13 for details:

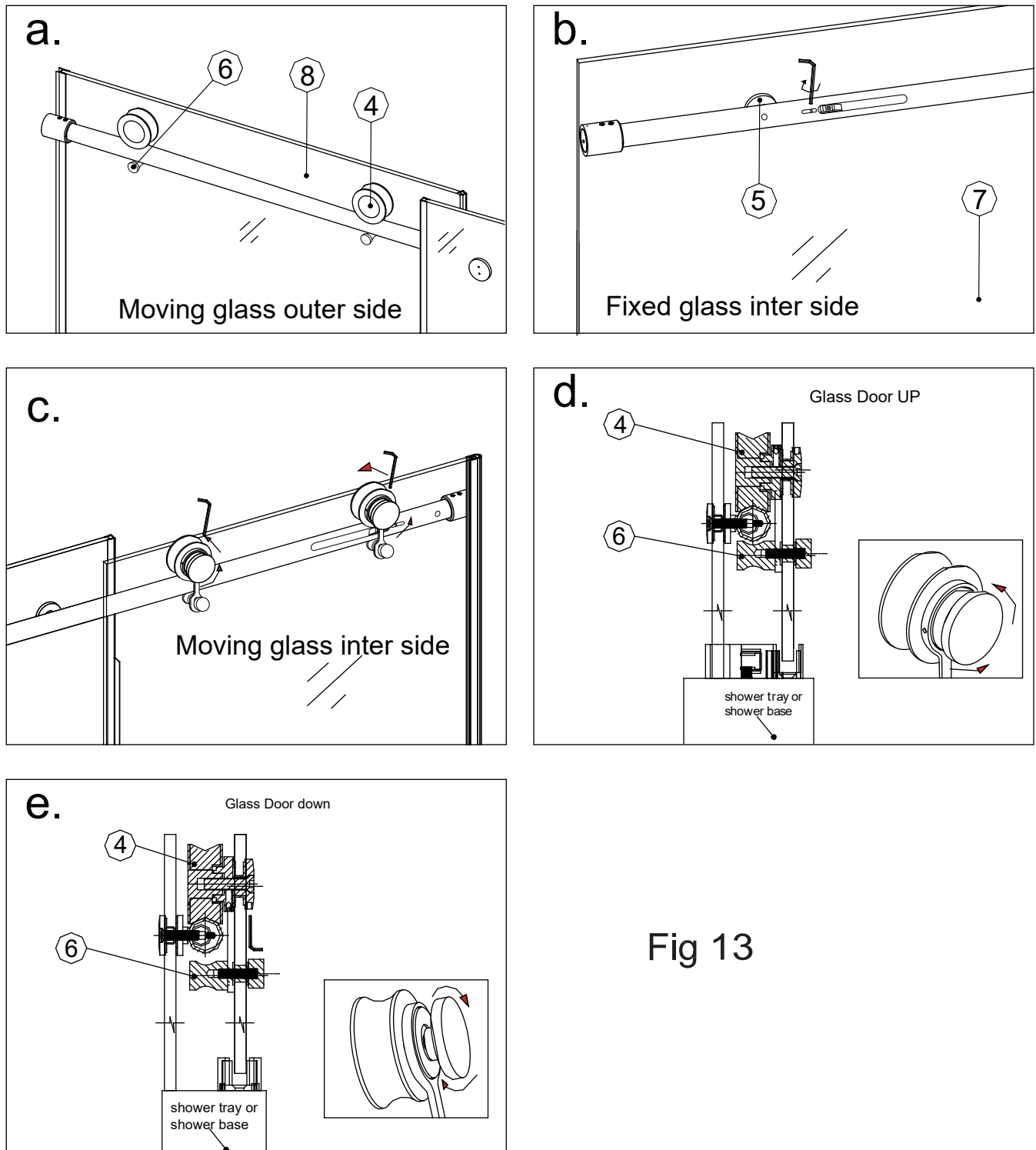

Fig 13

13. Install the anti-splash threshold

Put the Anti-splash Threshold (19) in front of the Door Glass (08) on the shower base/threshold, seal it to the shower base/threshold with silicone.

Please see Fig 14 for details:

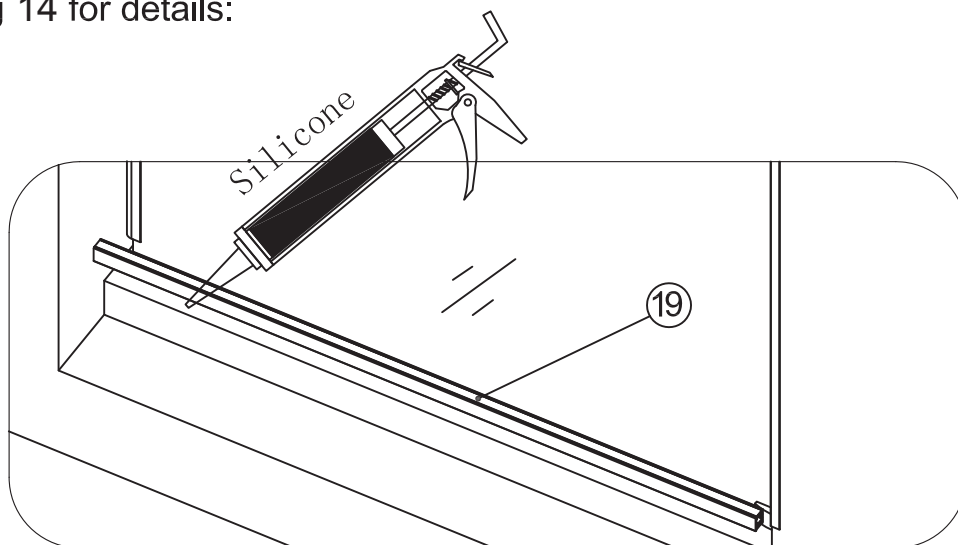

Fig 14

14. Apply the sealant on the seams between the bottom sealing strip and the shower base/threshold; and between the Fixed glass and wall.

Please see Fig 15 for details

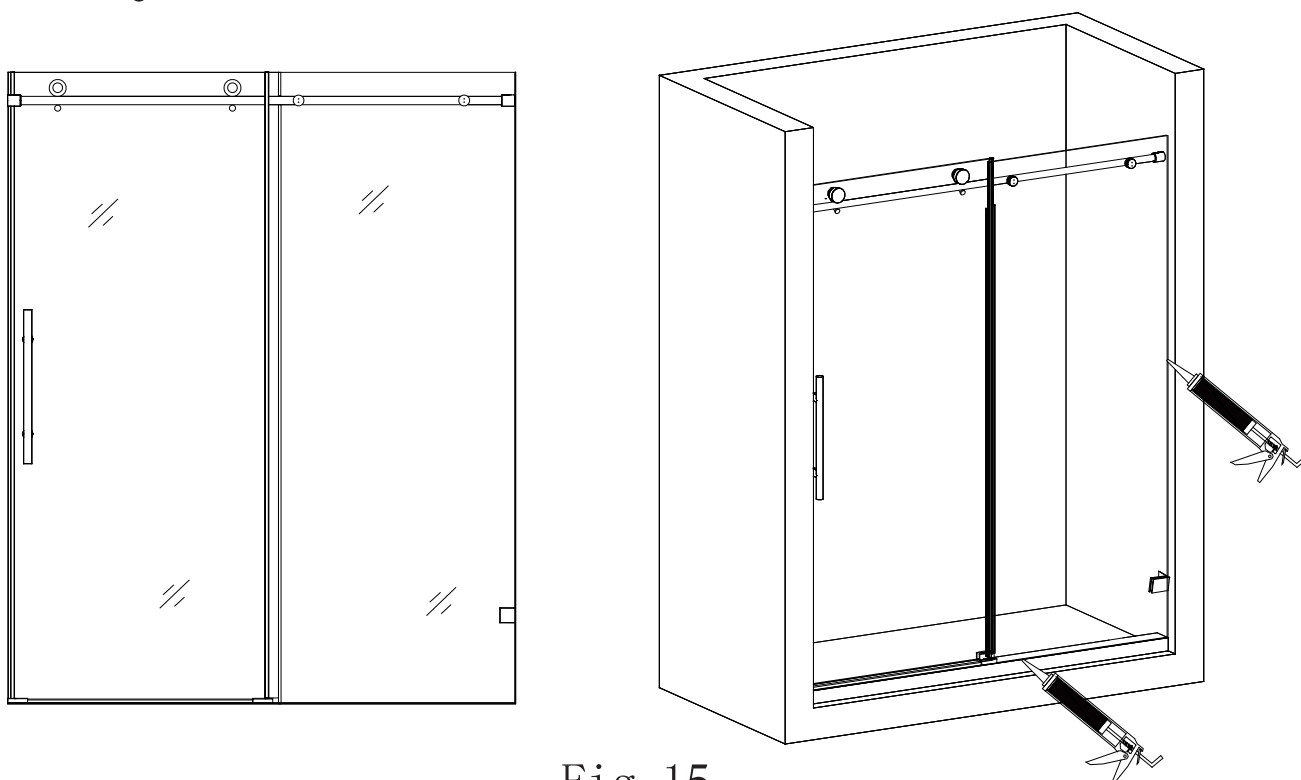

Fig 15

**IMPORTANT:**

**MUST ALLOW SILICONE TO DRY FOR 24 HOURS BEFORE STARTING USING THE SHOWER ENCLOSURE**