

**Model :** E027013-RDesigned By: **DANELONMERONI** | UNITED KINGDOM

- Features :**
- 2 fixed glass shelves
  - Can stack two, 33" Tall Brit Wall Cabinets on top of each other for additional storage
  - Cabinets have finished top panel
  - 1 soft-close door with Hettich brand hardware
  - Door opens from right to left; can be inverted so door opens from left to right
  - Door finger pull
  - Fully finished interiors
  - Solid wood construction (no MDF)
  - Multi-step polyurethane finish resists moisture and scratches
  - Wall hung hardware included

All Ronbow cabinets are made of solid hardwood or hardwood plywood and meet strict CARB II Standards. No particle board or Micro-Density Fiberboard (MDF) are used.

**Available Finish :** Bristol Beige (E40)

Top

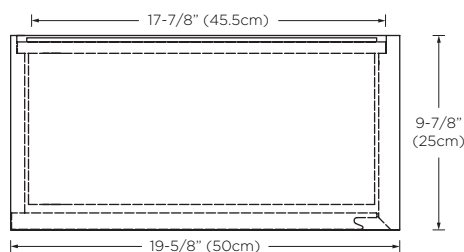

Front

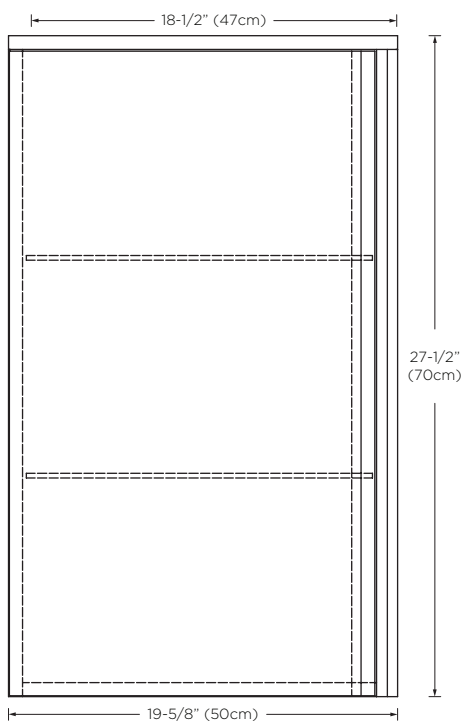

Side

