

Lima Rectangular Resin Counter Top Sink Colorful Wash Basin

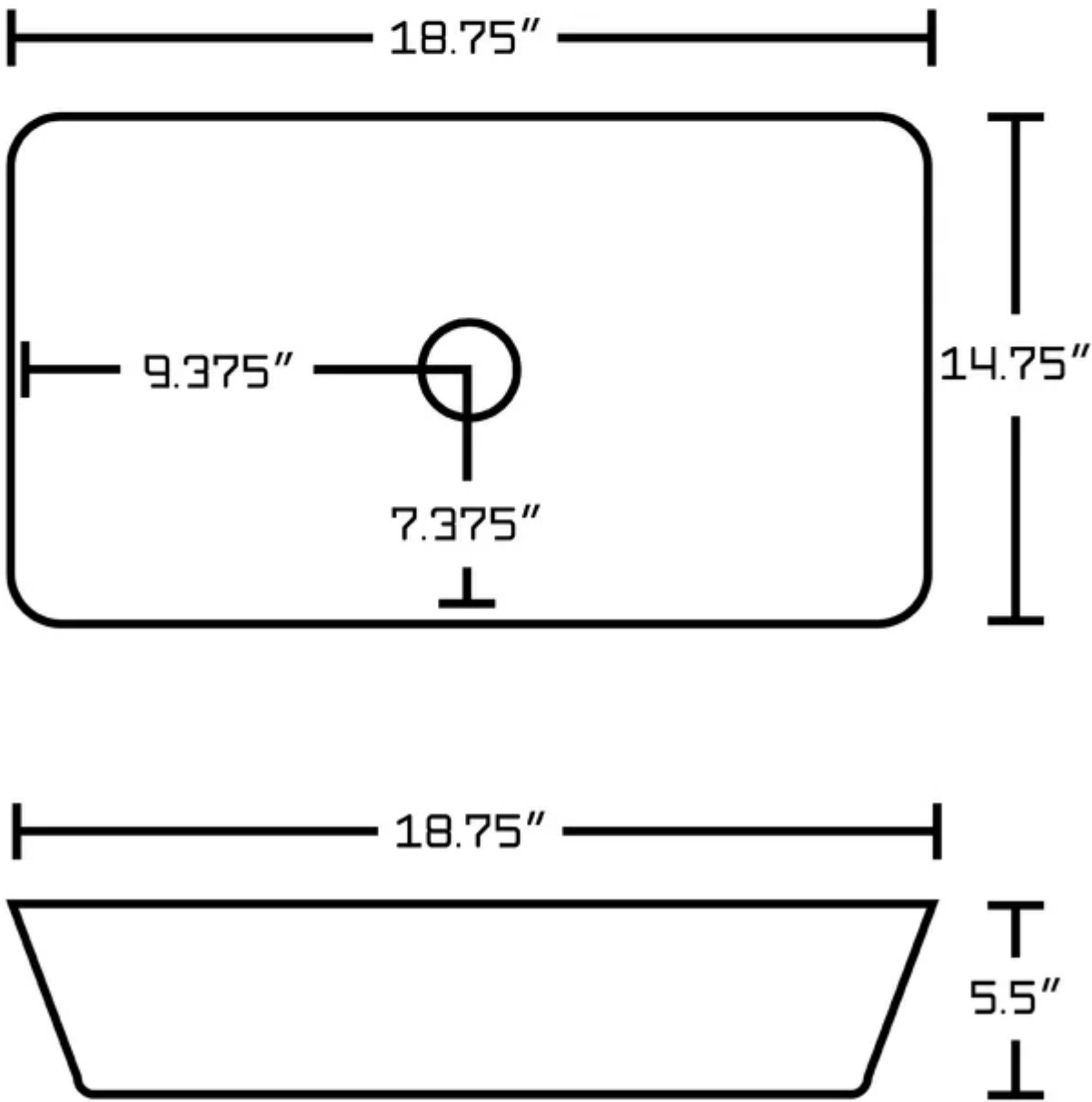

INSTALLATION INSTRUCTIONS



RECOMMENDED TOOLS



Tape Measure



Drill



Plumber's Putty
or Caulking



Pencil

STEP #1

- o Prepare countertop by making a cutout in the counter top using the supplied cutout template.
- o Make sure you leave enough room in between the wall and the vessel for faucet placement
- o Put a little bit of sealant or plumbers putty on the bottom side of vessel, this is to keep the vessel from turning or moving once drain is installed.
- o Line up the cutout in the countertop and the drain hole in the vessel. Place the vessel on the countertop and press firmly.
- o Install Drain, Trap and faucet according to manufactures specifications

Figure A

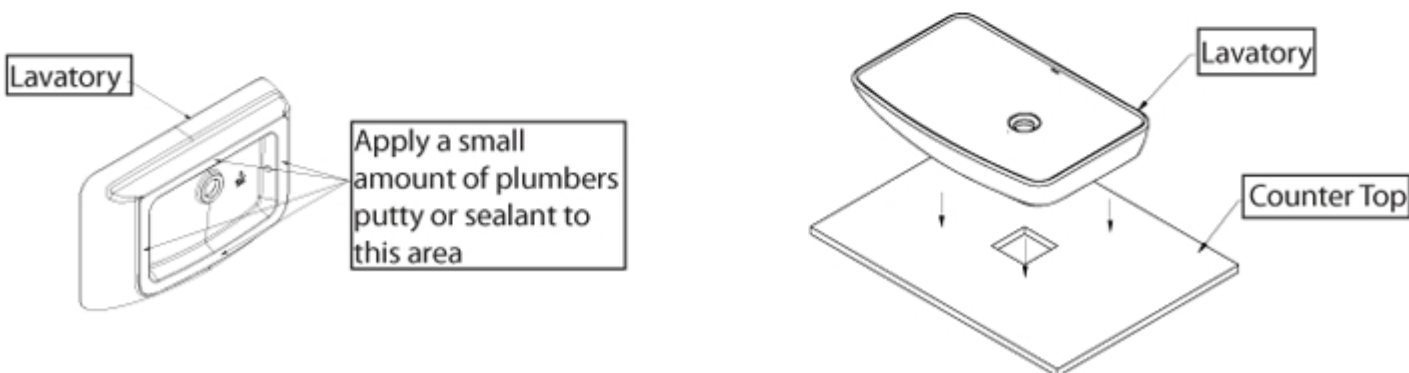

This General diagram and installation instructions are not intended for any specific model, but is presented as a general guideline for Installations!