

4-1 Instant Hot Water and Drink Water Faucet

WESTBRASS
Fine Decorative Plumbing Since 1935

USER MANUAL

KH41A

NO.	Description	QTY
A	Faucet	1
B	Spray Head	1
C	Counter Weight	1
D	O-ring	1
E	Rubber Washer	1
F	Metal Washer	1
G	Mounting Nut	1
H	Boiled water Supply Hose 1	1
I	Boiled water Supply Hoes 2	1
J	Drinking Water Supply Hose	1
K	Cross Fitting	1
L	Wall Mount with screw	1
M	Outlet Hose	1
N	Stem	1
O	Boiling water outlet hose	1
P	Drinking water outlet hose	1
Q	Hot & cold supply lines	1
R	Pull-down hose	1

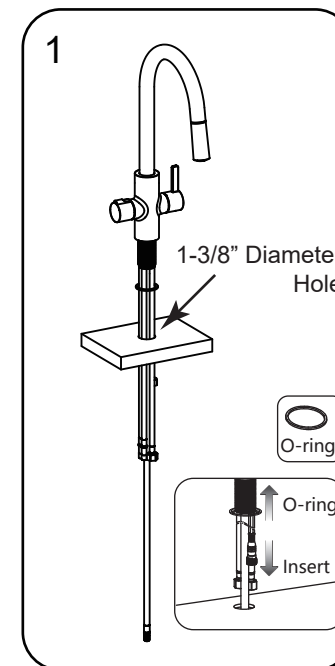
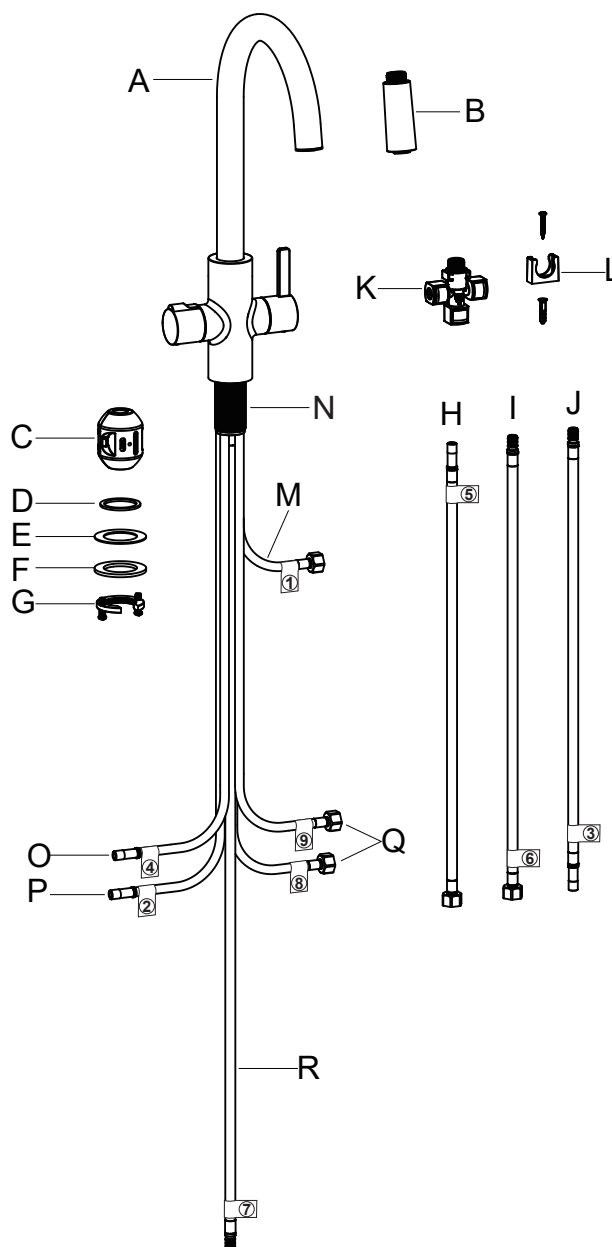

1. Insert the O-ring (D) over the hoses into faucet shank, and mount the faucet on the basin. See Fig.1

Please note: Pass the 3 hoses with nuts FIRST and then pass 3 tubes without nuts to facilitate installation.

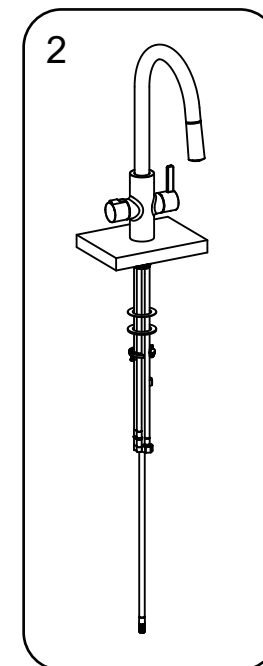

2. First slide the rubber gasket (E), then the metal washer (F) and the mounting nut (G) over the hoses onto the stem (N). Hand tighten them firmly. See Fig.2

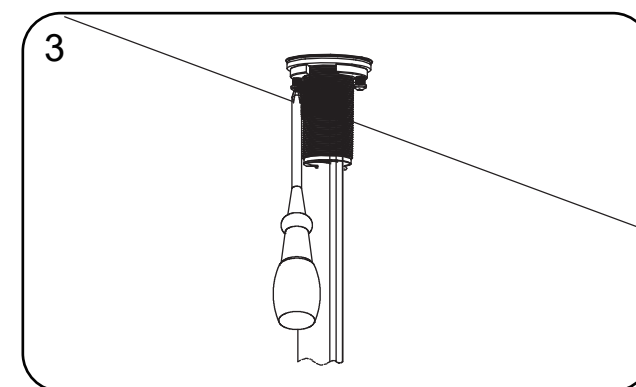

3. Use a Phillips head screwdriver to tighten the 2 screws. Do not over tighten.

WESTBRASS • 2429 E. Olympic Blvd., Los Angeles, CA 90021
(213)-627-8441 • (213) 627-2844 • orders@westbrass.com • www.westbrass.com

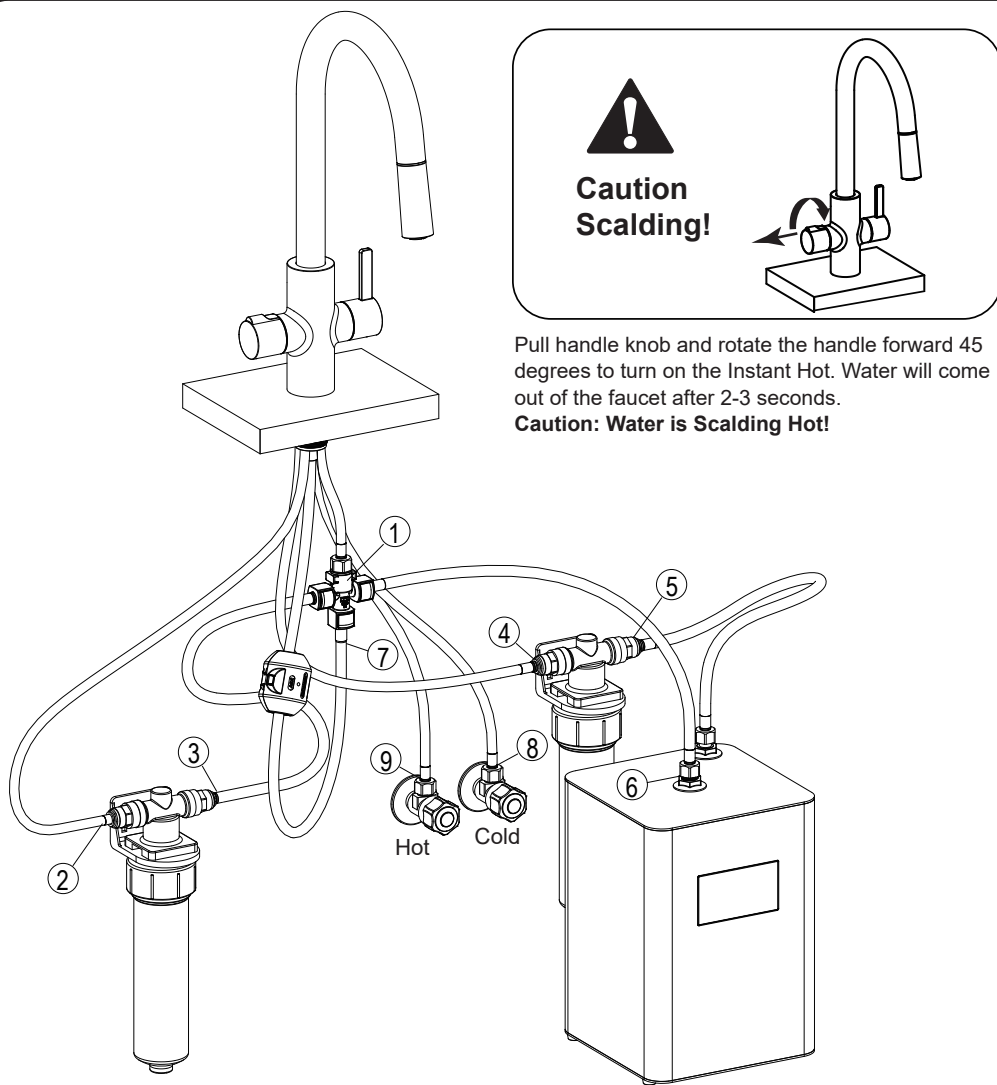

**Caution
Scalding!**

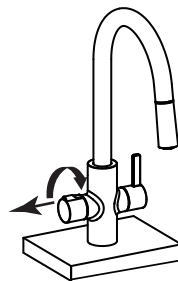

Pull handle knob and rotate the handle forward 45 degrees to turn on the Instant Hot. Water will come out of the faucet after 2-3 seconds.

Caution: Water is Scalding Hot!

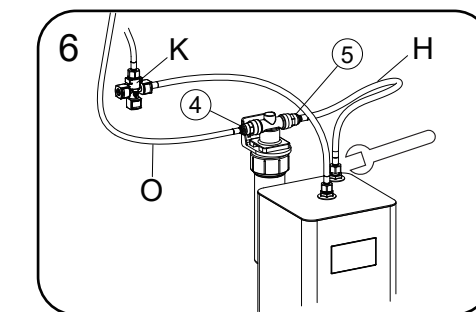

6. Remove the release ring retainers from the filter and save. Fit boiling water outlet hose (O) (label 4/ Blue Color) into the filter housing inlet. Fit boiling water supply hose (H) (label 5/ Green Color) into the filter housing outlet, using the washer under the cap. Connect the other end of the hose (H) onto the inlet of the hot water tank, indicated with blue. Secure the connection with an adjustable wrench. Replace retainer rings. Mount filter according to instructions included in the filter box. See Fig.6

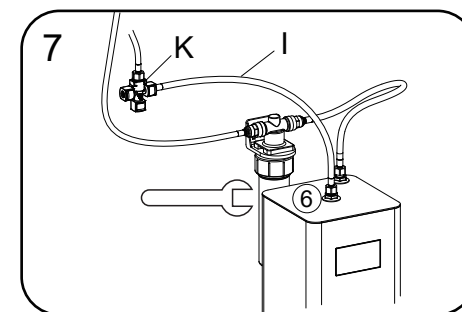

7. Connect boiling water supply hose 2 (I) (with label 6/ Red Color) onto the outlet of boiling water in the center of the tank. Indicated with red. Make sure to use the washer under the cap, then tighten with an adjustable wrench to secure the connection. Connect the other end of the hose (I) to the cross fitting adapter (K) until it snaps in place. See Fig.7

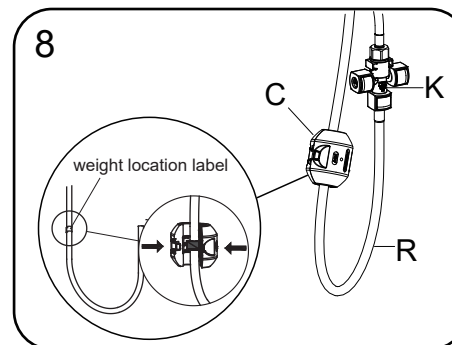

8. Attach the pull-down hose (R) (with label 7/ White Color) to the adapter at the bottom of the Cross fitting (K). Install the counterweight (C) on the pull-down hose at the marked position. It should be placed on the pull out spray hose. See Fig.8

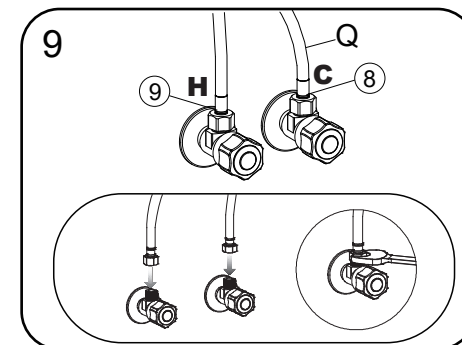

9. Remove the Hand Spray from the faucet. Connect the hot water line (label 9/ Red Tracer) & cold water line (label 8/ Blue Tracer) onto the matching 3/8 in. compression water valves. Secure the connection with an adjustable wrench. Turn on the water supply and check the water connections for leaks. Purge the system and fill the hot water tank by operating the hot water handle until several gallons runs out of the faucet. Purge hot and cold dishwasher. Purge pure water faucet. See Fig.9

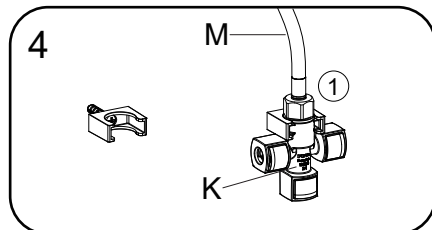

4. Connect the Cross fitting (K) to the Outlet Hose M (Hose 1/ White Color) , and hand tighten onto the cross fitting. Use the mounting bracket to fix the cross fitting against the back wall. See Fig.4

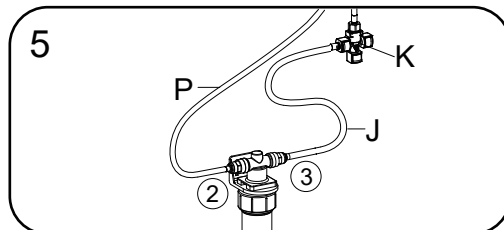

5. Remove the release ring retainers from the filter and save. Fit water Drinking water outlet hose (P) (label 2/ Blue Color) into the filter housing inlet. Fit Drinking Water Supply hose (J) (with label 3/ Green Color) into the filter housing outlet, and attach the another end of the hose to the left (or right) adapter of Cross fitting (K). Mount fitting on wall and assemble according to instructions inside the filter box. See Fig.5

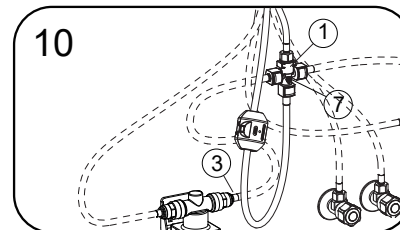

10. Tidy up all the hoses, so they don't get tangled up. Please leave enough space for the pull-down hose with counter-weight to move up and down without interference, to ensure the integrity of the pull down function.

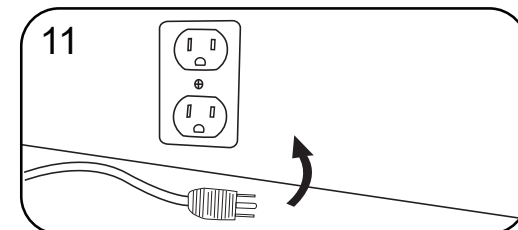

11. Now, plug tank into electrical outlet. Press and hold the start button for 3 seconds to switch unit on. Power indicator will flash and show temperature. Follow the instructions included with the tank to adjust temperature.