

ITEM: BA-LMDFVCB007AL
ANZZI LED MIRROR
INSTALLATION & OPERATION MANUAL
V1.1
03/28/2025

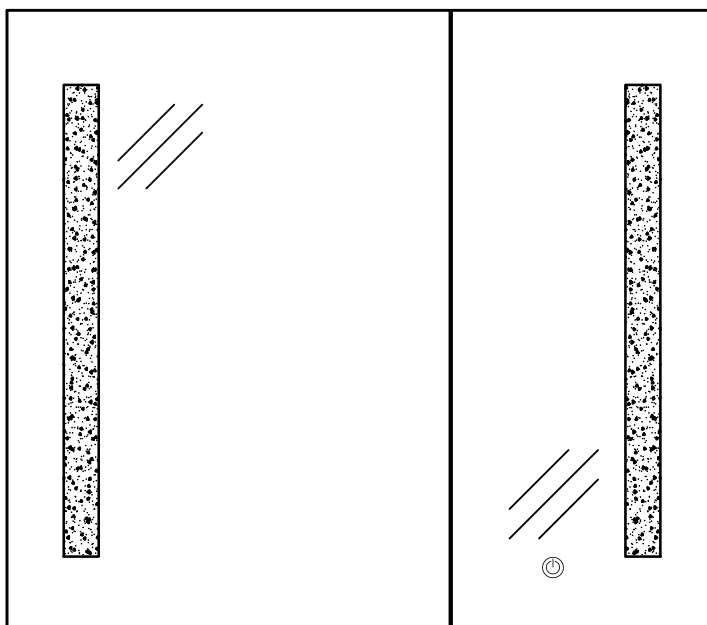

DON'T WAIT! REGISTER NOW!

Register your product within 90 days to ensure it is recognized as a purchase and covered under warranty.

Register online at <https://anzzi.com/pages/register> or scan the QR code on PG. 2.



PRODUCT REGISTRATION*

IMPORTANT: Warranty will not be recognized unless product is registered.

Register online at <https://anzzi.com/pages/register> or Scan the QR code below.

Registering your product maximizes your warranty benefits and ensures prompt service and support.

1

USE YOUR PHONE CAMERA
TO SCAN THE QR CODE

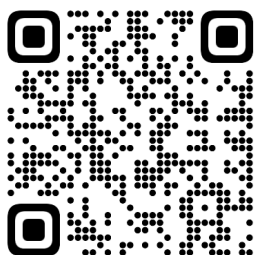

2

FILL IN A QUICK
REGISTRATION FORM

A smartphone screen displaying a registration form. At the top, it says "Thank you for your purchase!" followed by a message: "Registering your products ensures you maximize your warranty benefits and receive prompt service and support." The form contains several input fields: "Name*", "Email*", "City*", "Order #*", "Installer Name", "Model Purchased*", "Installer Phone Number", and "Customer Age Range". Each field has a light gray border and a small asterisk for required fields. At the bottom of the form is a blue "Submit" button. A dashed oval highlights the "Submit" button on the phone screen, and a curved arrow points from this oval to a larger "Submit" button in step 3.

3

CLICK SUBMIT AND
ENJOY PEACE OF MIND

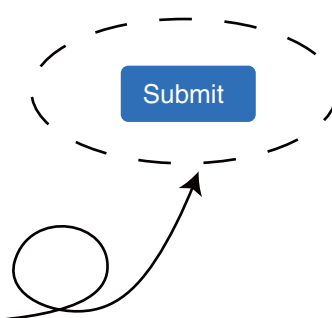

Need help? For technical support call **305-614-4070** or visit us at www.ANZZI.com

BA-LMDFVCB007AL

32"*28"

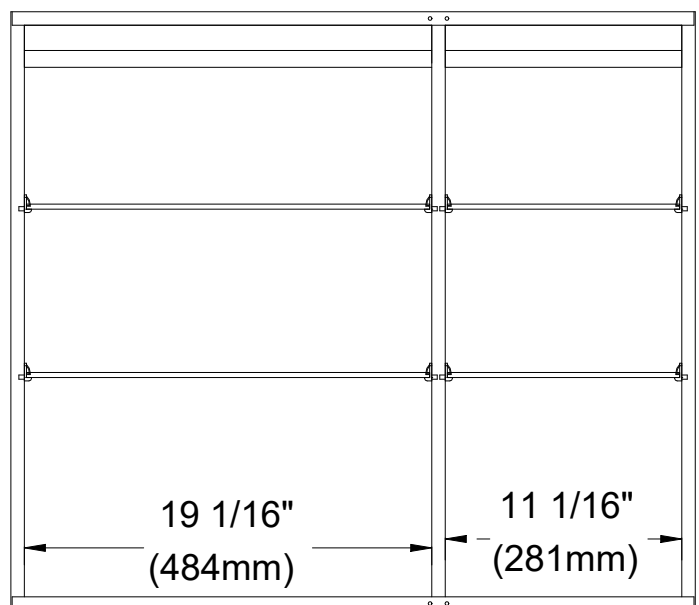
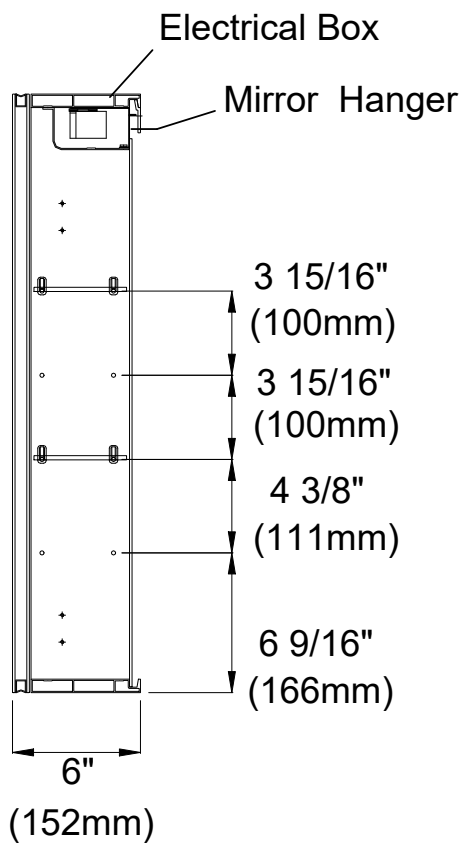
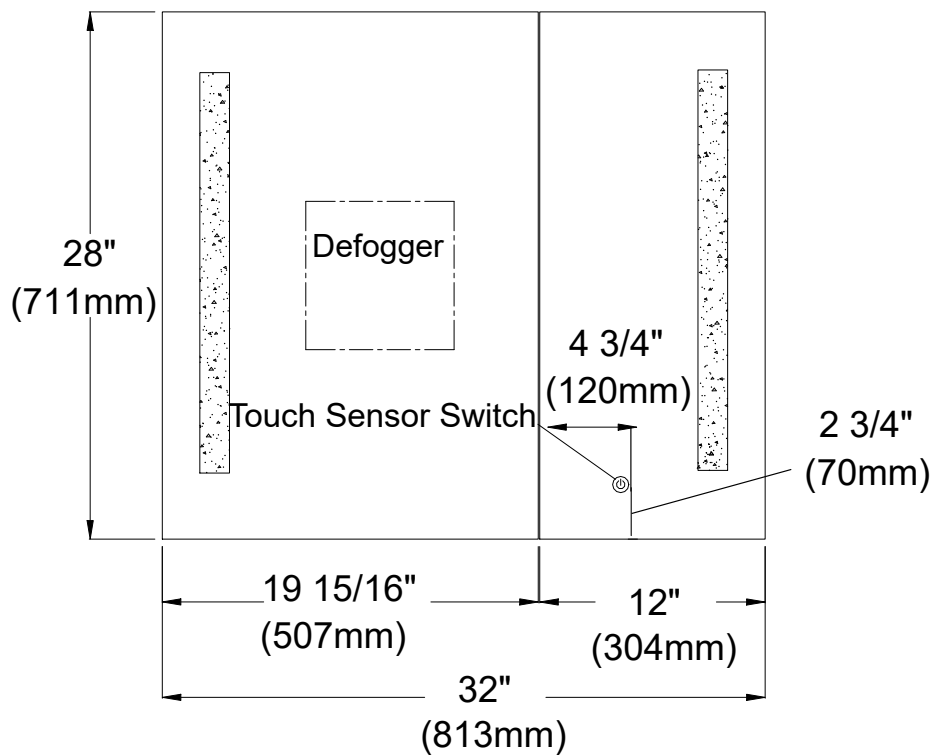

INSTALLATION INSTRUCTIONS

Apply to the below style of LED medicine cabinet

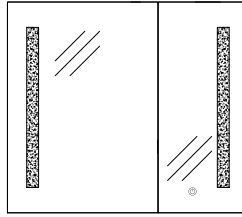

Please read carefully and save these instructions.

Don't discard any of the packaging until you are sure that you have all of the parts and the fittings.

Make sure power to the junction box is off before commencing installation.

IMPORTANT

- Unpack LED cabinet. DO NOT lay cabinet on tiled or concrete surface prior to installation. Cabinet must be on protected surface to prevent chipping of the corners.
- Care must be taken before drilling pilot holes to avoid any existing wiring or pipe work that may be concealed.
- A certified electrician must perform all work. The mirror must be connected to a GFI.

INSTALLATION

Please refer the installation diagram on next two installations manual.

- 1) Unpack the LED medicine mirror and prepare tools needed. (See Pic.1)
- 2) Make sure the measurement on the cardboard screw holes are matching up with aluminum base on the mirror back, then mark the screw holes according from the cardboard with pencil.(See Pic.2)
- 3) Drill holes, and put in the plastic expansion bolt, then fix the aluminum bar by screws. (See Pic.3&Pic.4);
- 4) Connect hardwire to power line. Make sure the power off(Voltage:AC110-120V, 50/60Hz).(See Pic.5)
- 5) Hang the cabinet on the wall; don't remove your hands until its safety. (See Pic.6)
- 6) According to your needs, put metal buckles into cabinet holes in suitable height, then install the glass shelves. (See Pic.7&Pic.8)
- 7) Find the correct door panels by referring to drawings.Place the door panel on the side panel of the cabinet. Secure the hinges on the system holes of the side panels of the cabinet , then install a buffering hinge on each of the two cabinet panels.(See Pic.9&Pic.10)
- 8) Connect the DC line of the cabinet door panel to the electrical box .(See Pic .9)
- 9) Connect the lower end of wall with the cabinet body by using the corner brace.(Pic .11)

FUNCTION DESCRIPTION

Turn the light and anti-fog function by the touch sensor switch, see details as below:

Button:

- a) Touch the button for LED light and anti-fog control;
- b) Long press for color temperature control, 3000K~6000K adjusting. It will change gradually (3000K~6000K); level(warm yellow 3000K-warm white 4000K-cold white 6000K) .

MAINTENANCE

Wipe clean with a soft damp cloth. Apply glass cleaner to cloth and do not apply directly to mirror. **Never use abrasive cleaners as these could damage the finish or exposed LED strips.**

INSTALLATION DIAGRAM

1

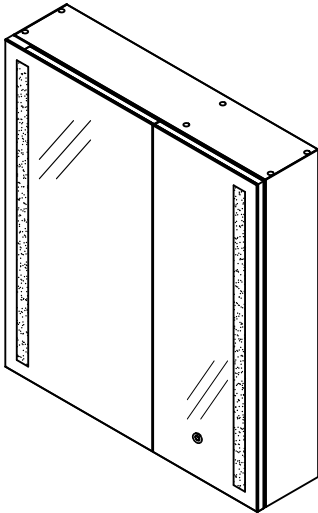

2

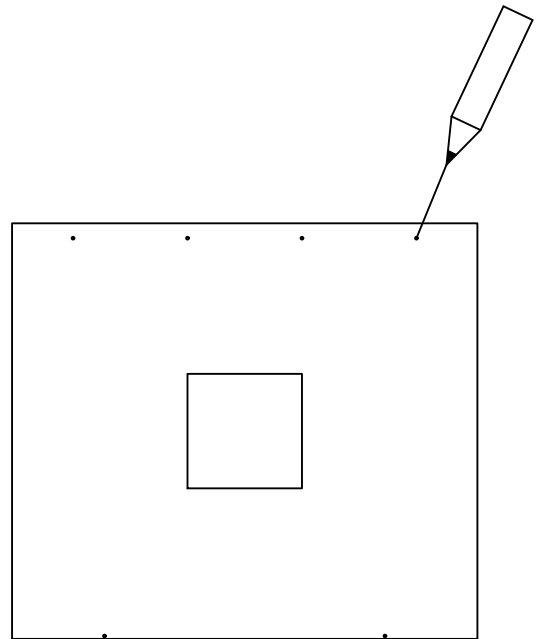

3

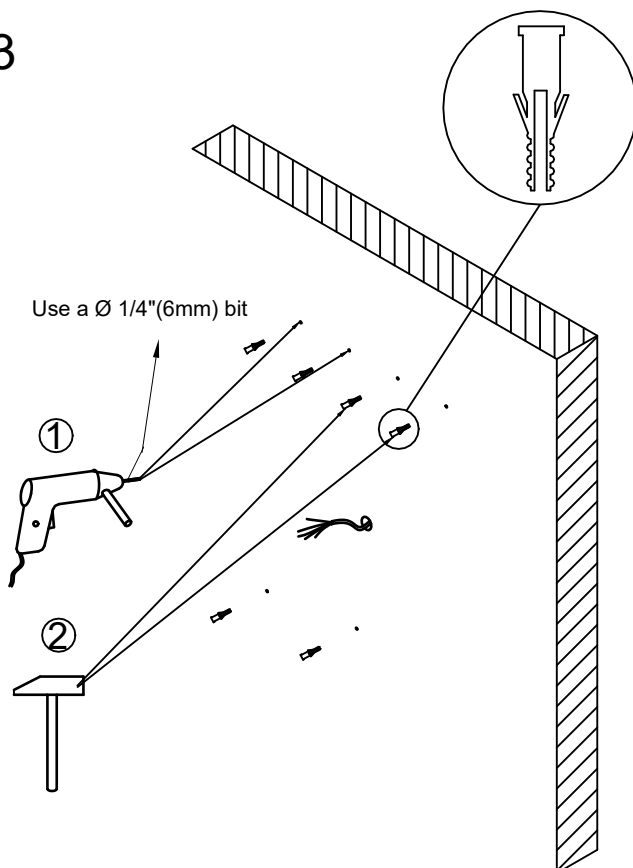

4

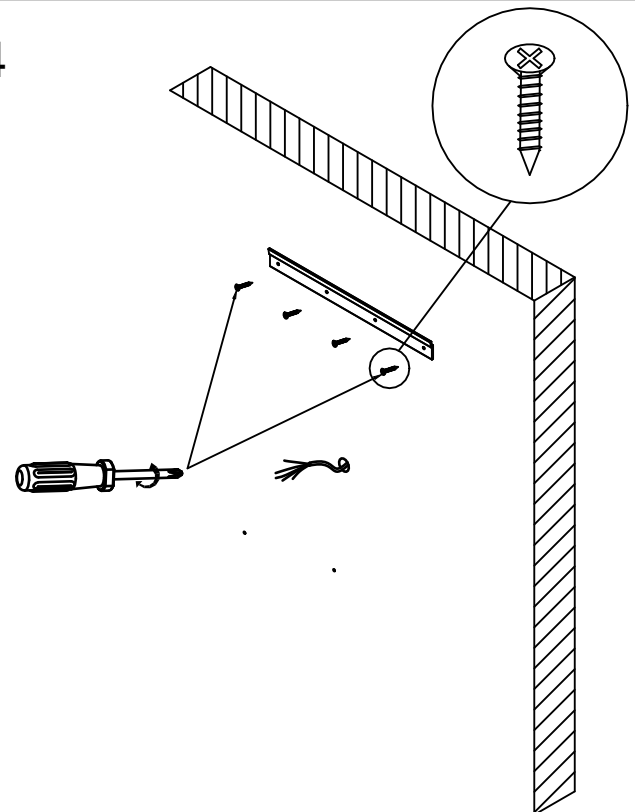

5

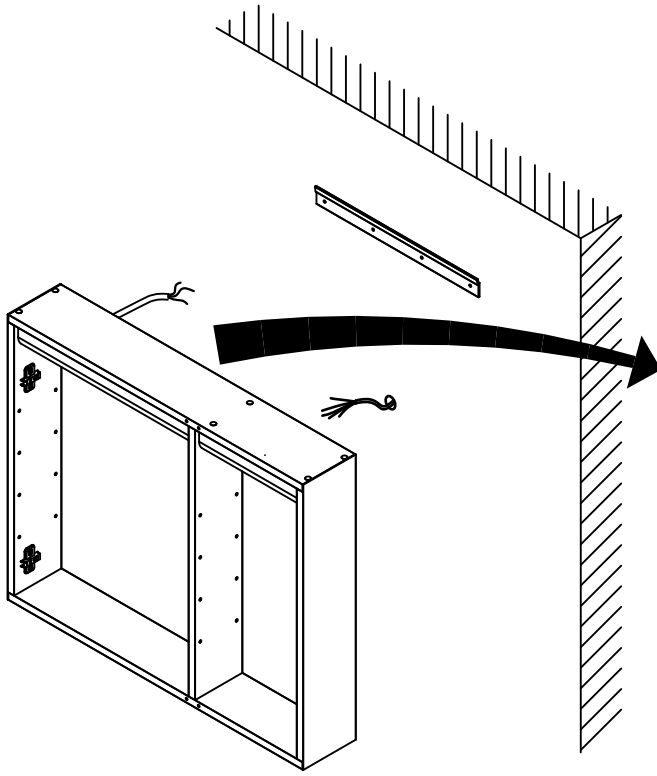

WIRING DETAILS

INCOMING SUPPLY

SWITCHED LIVE

EARTH(GREEN/YELLOW
SLEEVED COPPER)

NEUTRAL

— L —
— —
— N —

MIRROR WIRING

BLACK or LABELED - L

GREEN - E

WHITE or LABELED - N

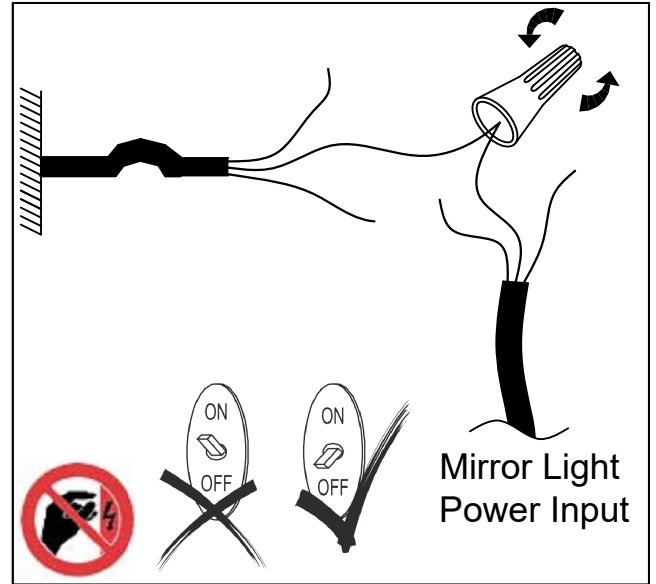

6

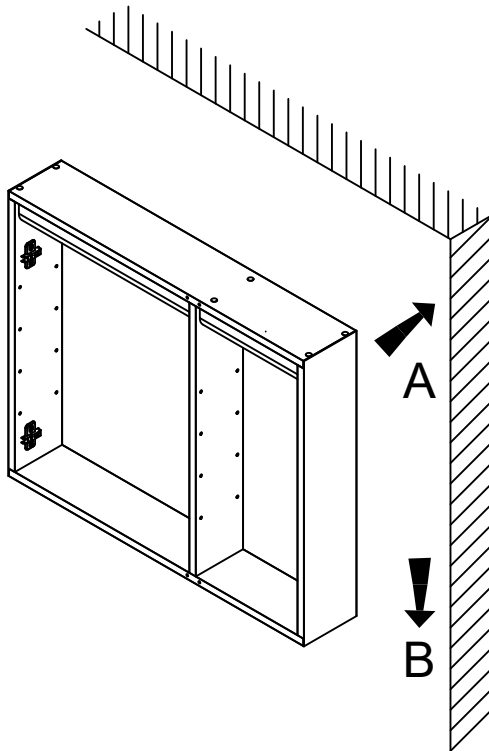

A

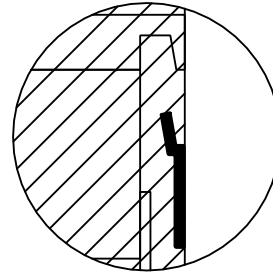

B

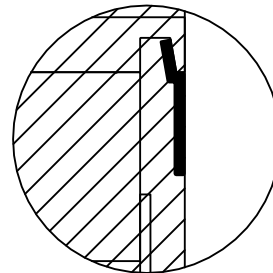

7

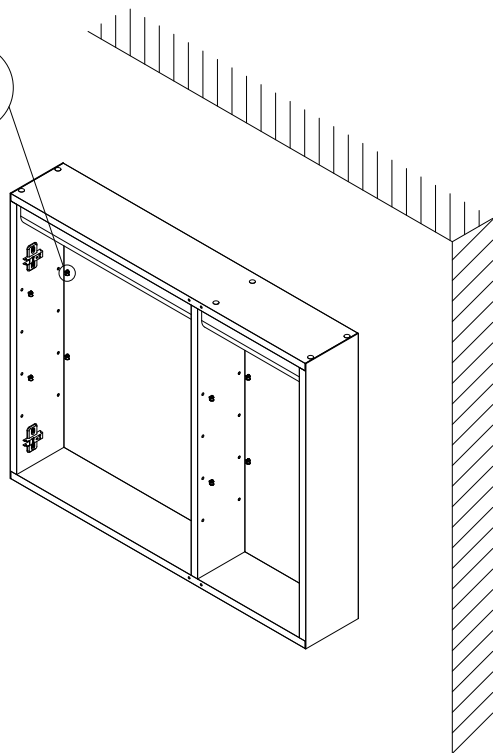

8

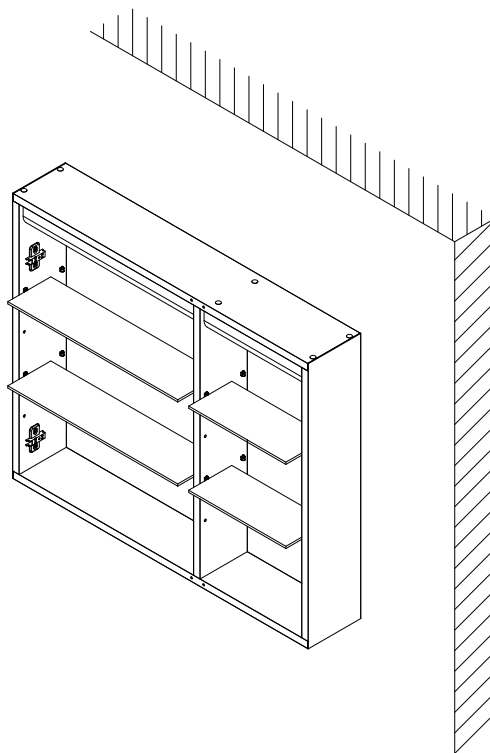

9

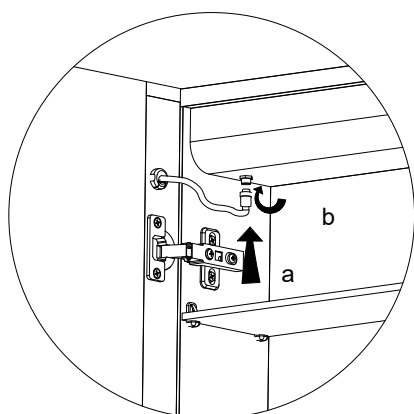
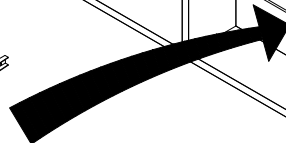
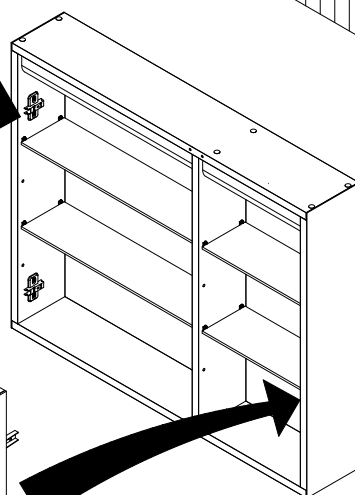
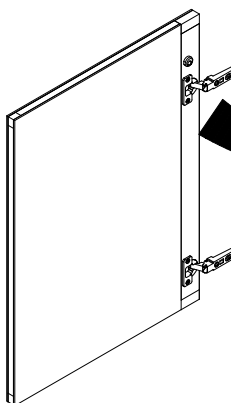
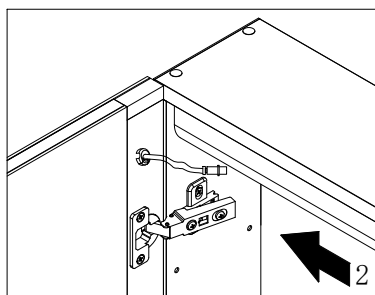

10

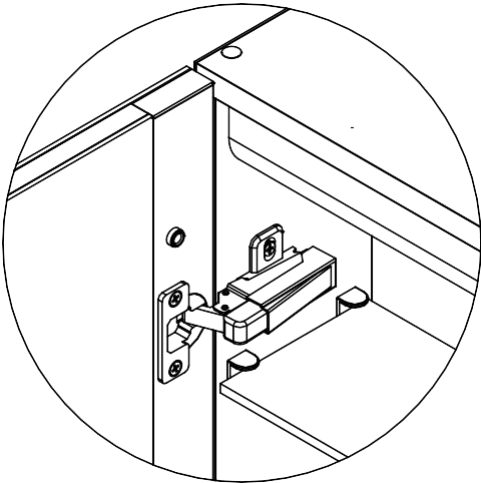

11

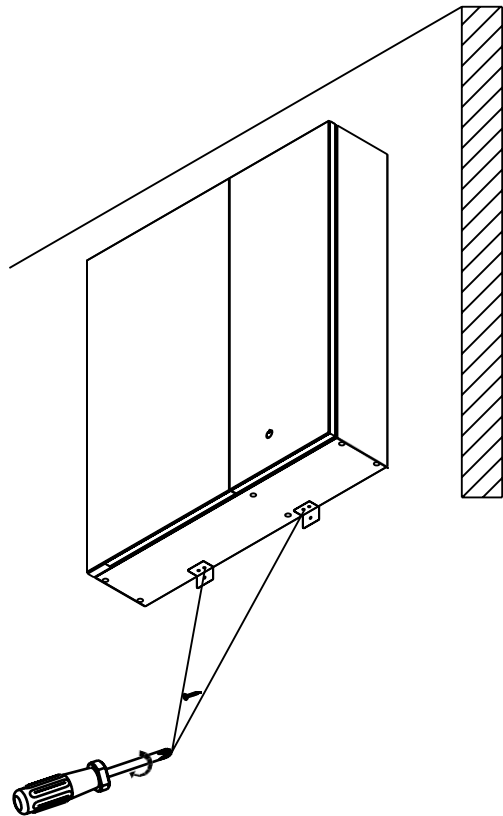

Mirror Cabinet Door

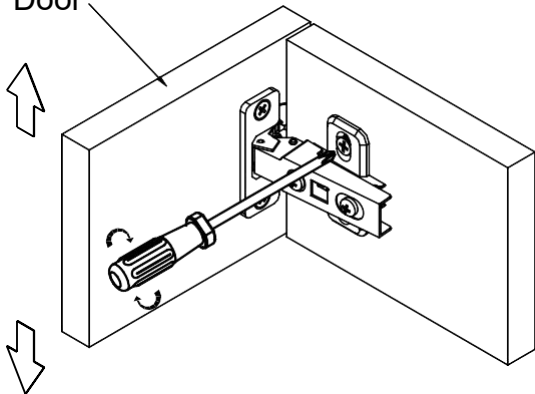

Mirror Cabinet Door

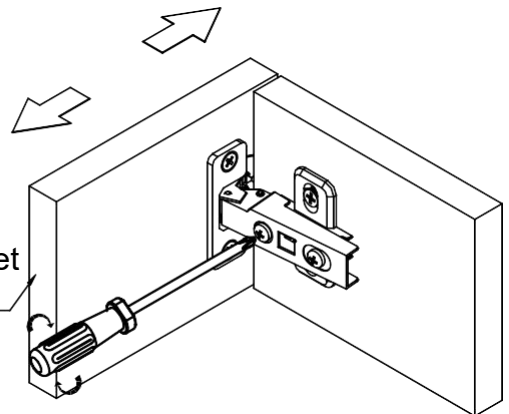

Mirror Cabinet Door

