

ASSEMBLY INSTRUCTION FOR ACME FURNITURE

MODEL#97834

Thank you for purchasing the quality product. Be sure to check all packing material carefully for small parts which may have come loose inside the carton during shipment. Separate, identify and count all parts and metal hardware. Compare with all parts are present. If any part(s) are missing or damaged, please contact your local furniture dealer. For efficient and speedy service, please indicate the model number and code letter of part(s) needed.

*****Do not fully tighten screws until fully assembled.*****

CABINET

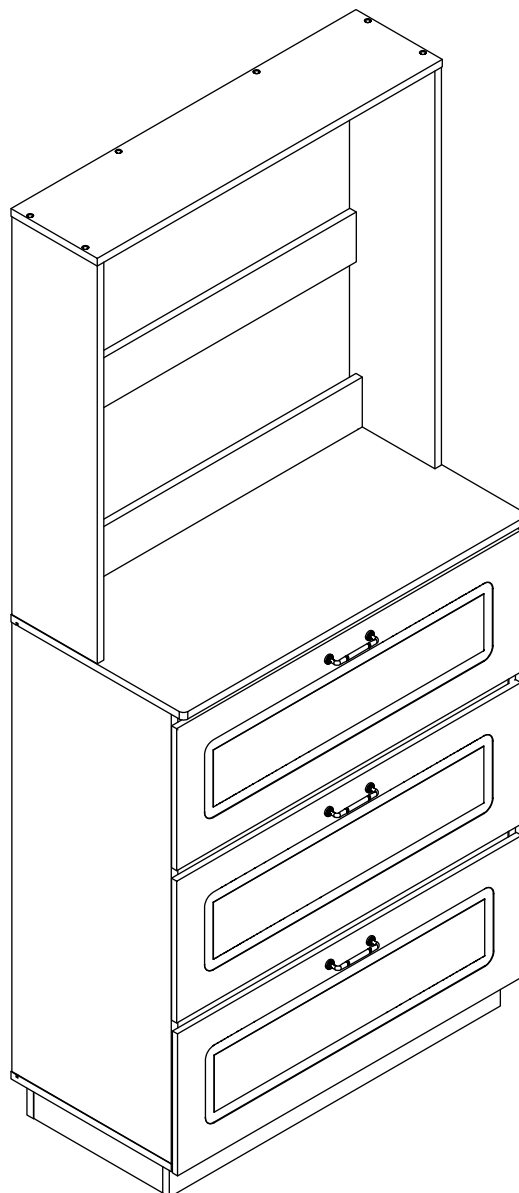

DIMENSIONS

Width - 31.5"
Depth - 15.75"
Height - 71.58"

97834

PARTS LIST

A X1 Top

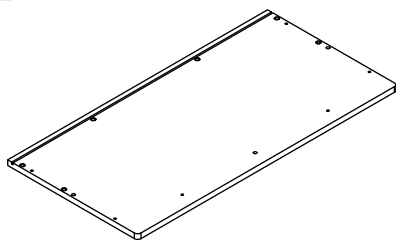

G X3 Top support

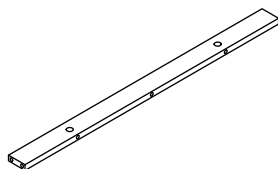

M X1 Middle baffle

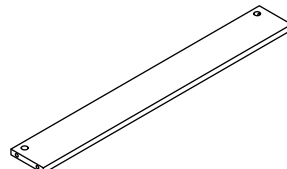

B X1 Bottom

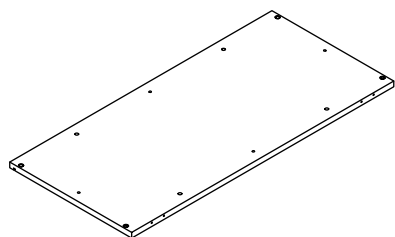

H X2 Front support

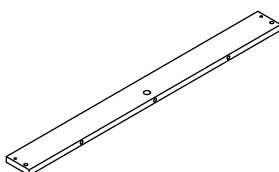

N X1 Bottom baffle

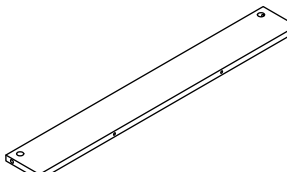

C X1 Left side

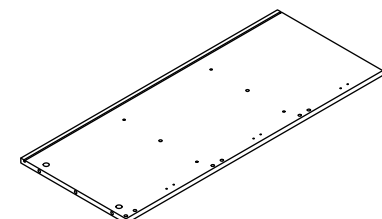

I X2 Left support

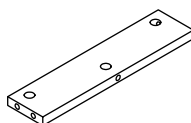

O X3 Door

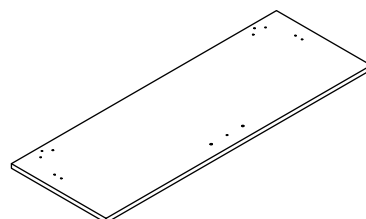

D X1 Right side

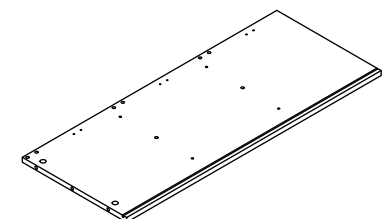

J X1 Left baffle

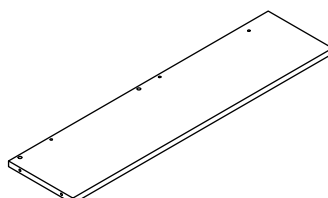

P X3 Back

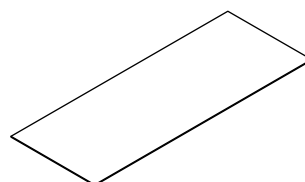

E X1 Roof

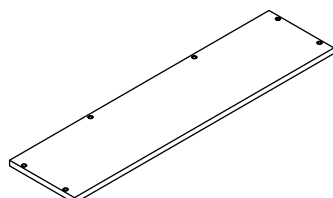

K X1 Right baffle

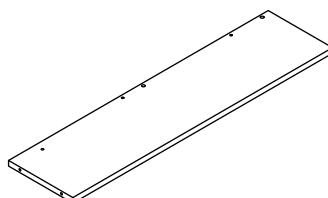

F X2 Middle top

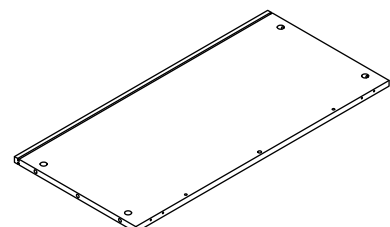

L X1 Top baffle

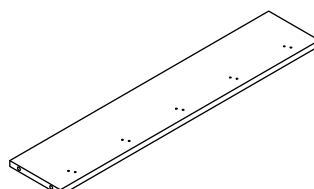

HARDWARE LIST

① X32 Cam bolt 7*35*12.5mm



② X32 Cam lock 15*12mm



③ X33 Dowel 8*30mm



④ X16 Coarse screw 7*11*50mm

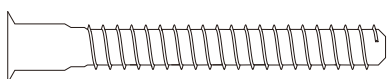

⑤ X3 Magnet

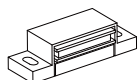

⑥ X6 Magnet screw 3*15mm



⑦ X3 Iron sheet

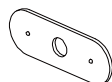

⑧ X3 Wood screw 3*10mm

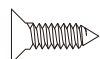

⑨ X3 Handle

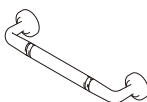

⑩ X6 Handle screw M4*16mm

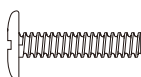

⑪ X5 Hook

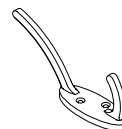

⑫ X6 Hinge

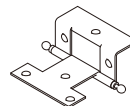

⑬ X3 Door closer

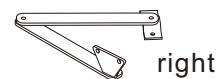
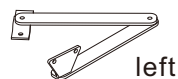

⑭ X70 Wood screw 3*12mm

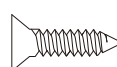

⑮ X4 Fixative plate



⑯ X4 Wood screw 3*19mm



⑰ X4 Foot nail



⑱ X1 Glue



⑲ X1 Allen wrench

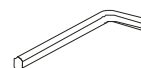

Attention

Some number parts listed on the instruction sheet may not be in parts bag as they may already be assembled. Carefully check parts and packing materials prior to ordering replacements.

ASSEMBLY INSTRUCTIONS

Step 1.

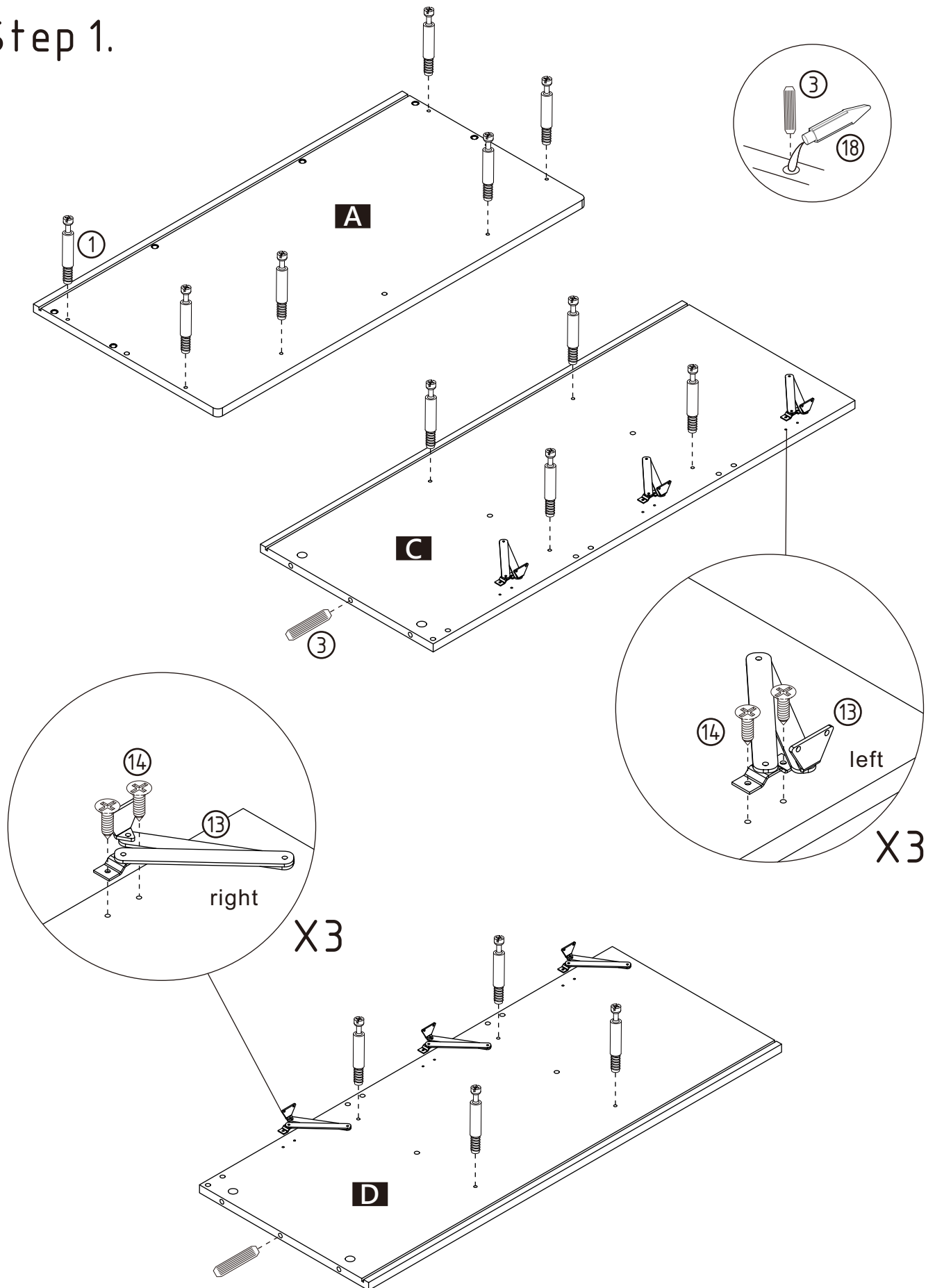

ASSEMBLY INSTRUCTIONS

Step 2.

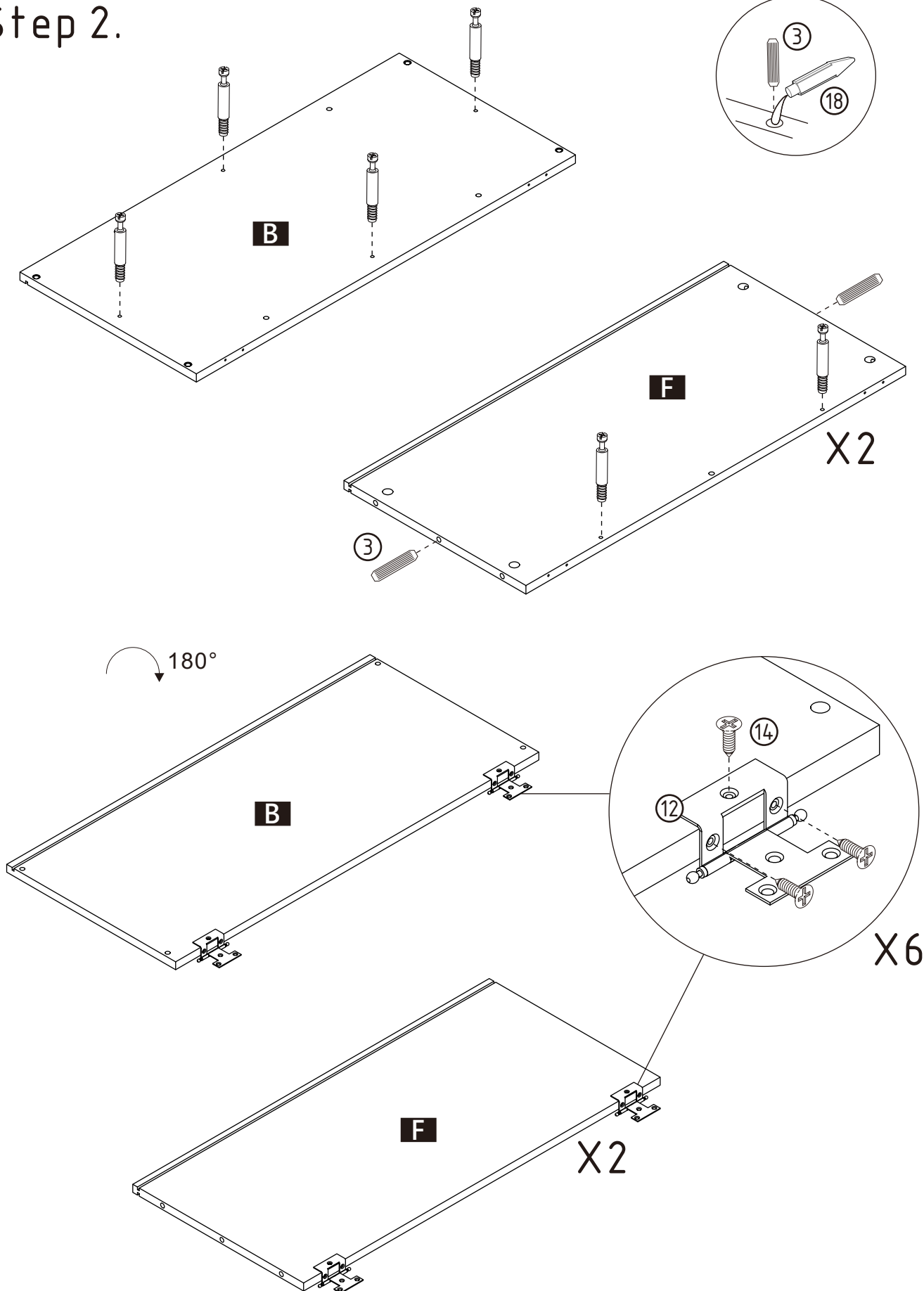

ASSEMBLY INSTRUCTIONS

Step 3.

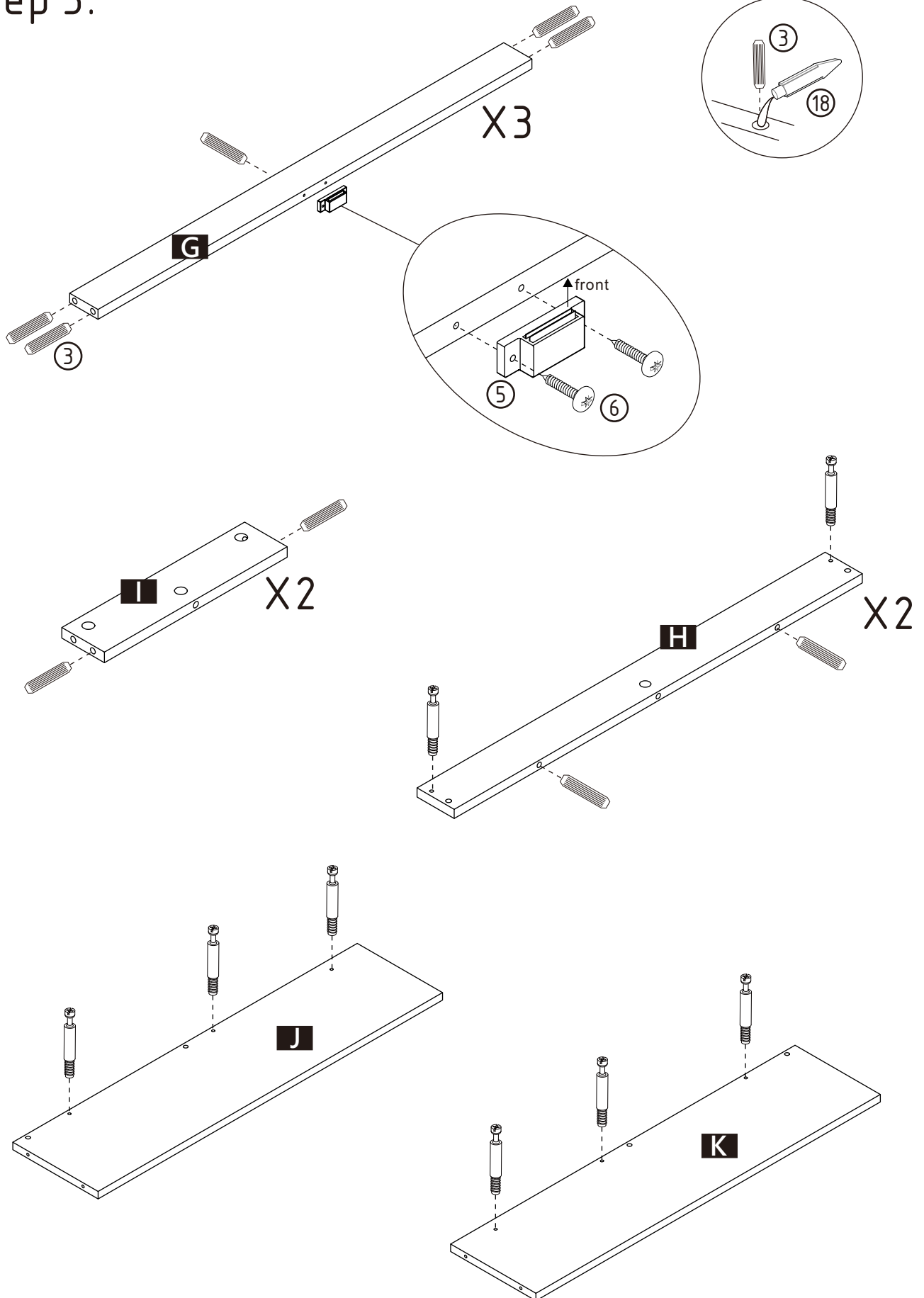

ASSEMBLY INSTRUCTIONS

Step 4.

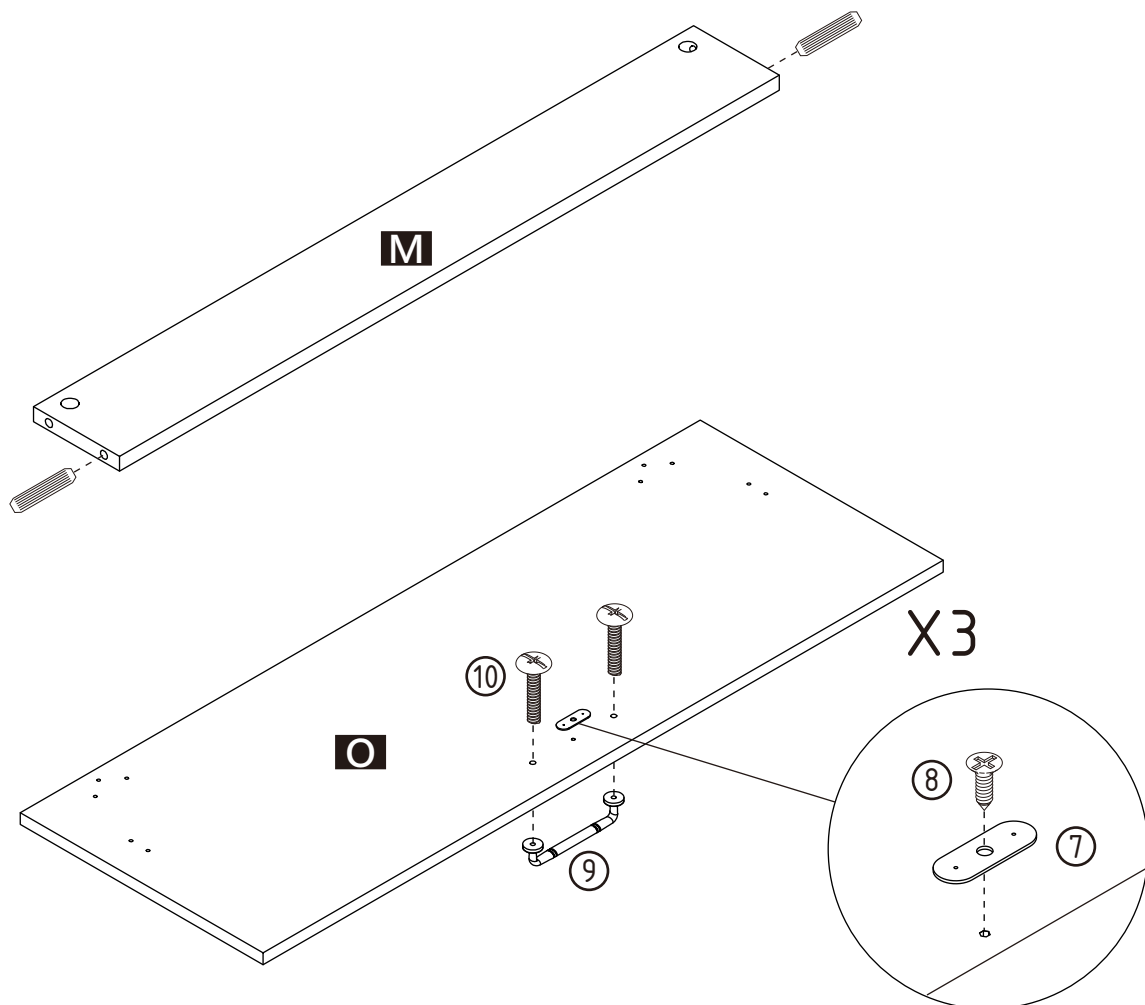
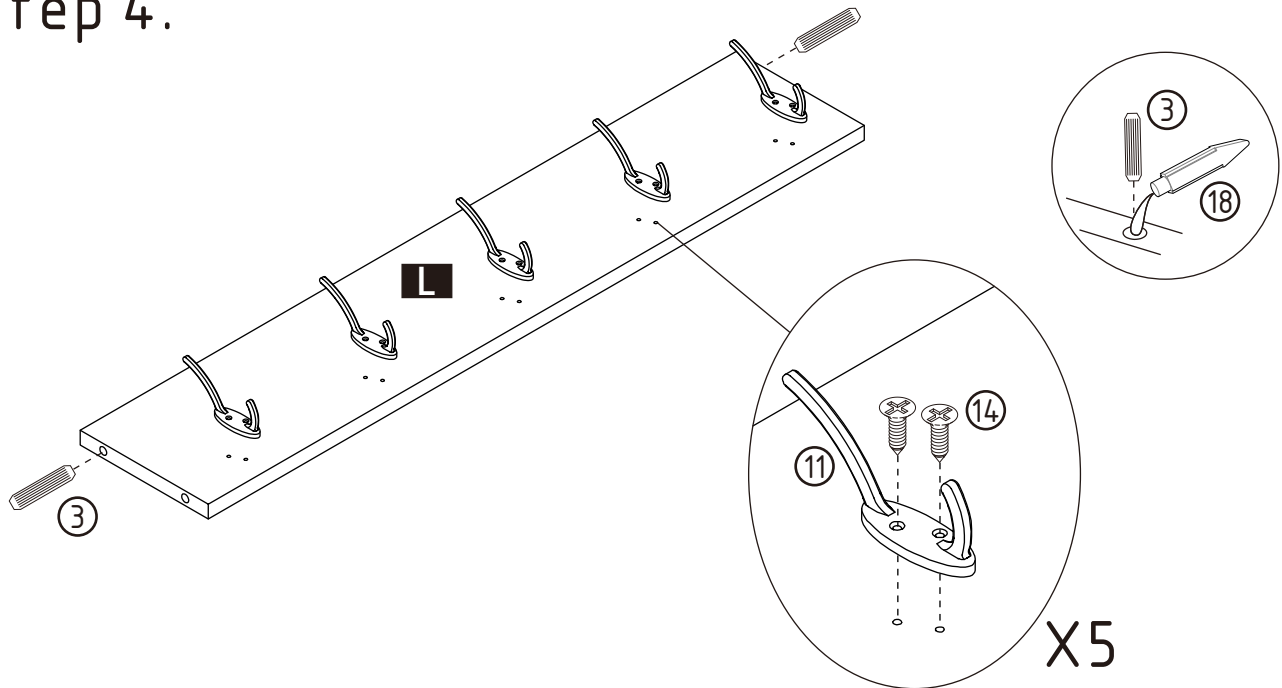

ASSEMBLY INSTRUCTIONS

Step 5.

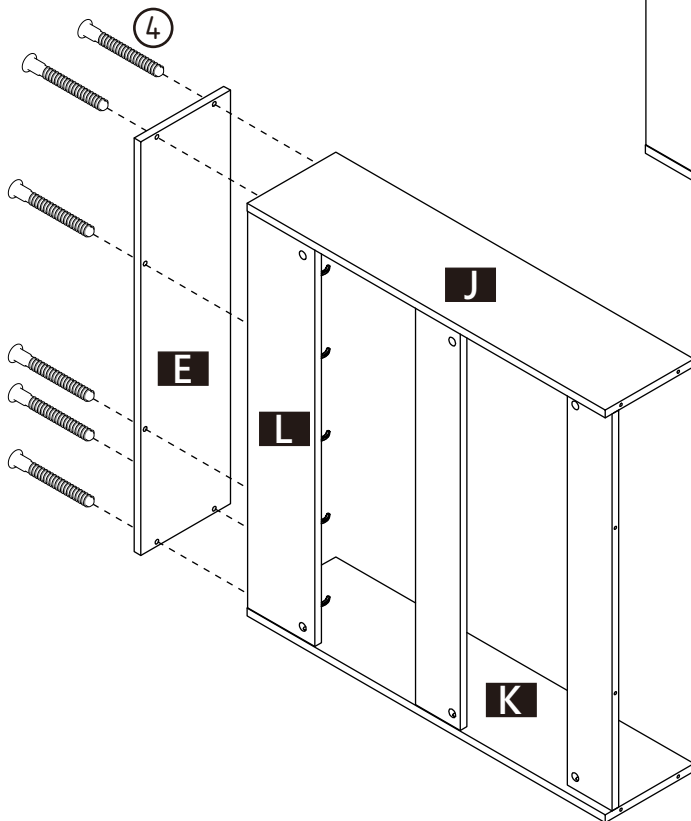
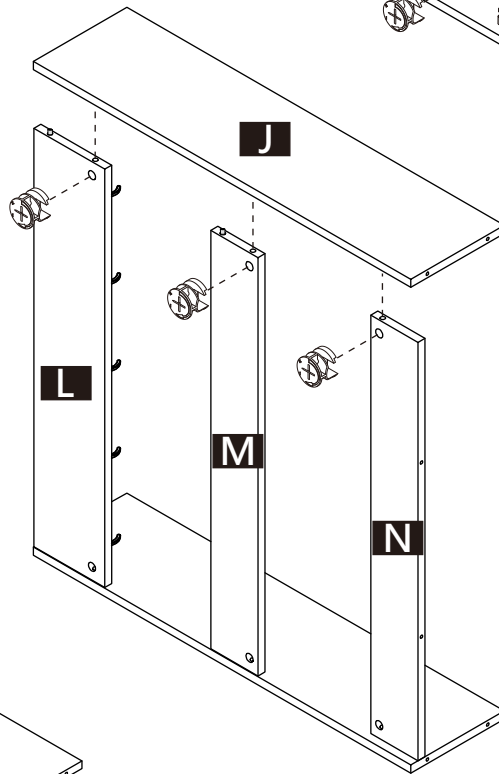
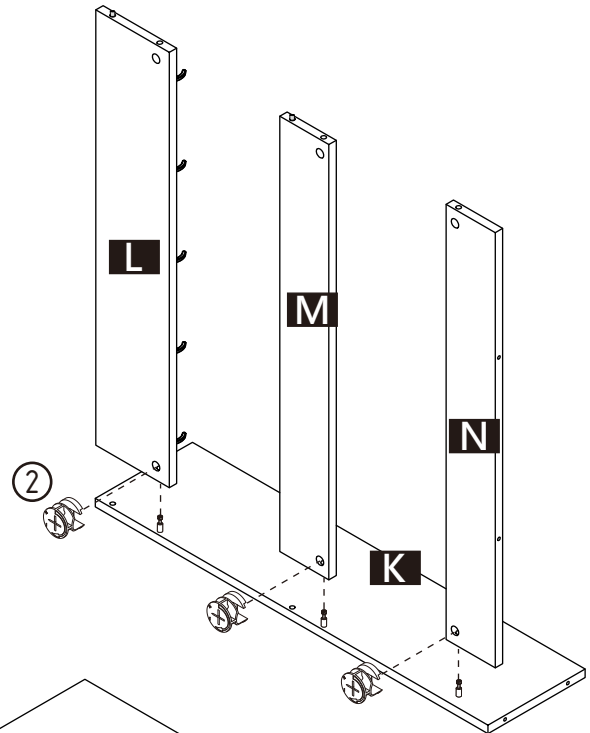
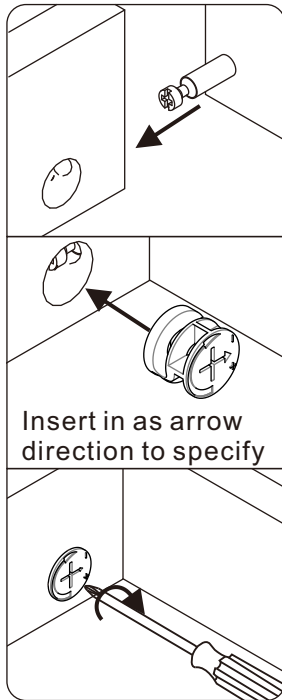

ASSEMBLY INSTRUCTIONS

Step 6.

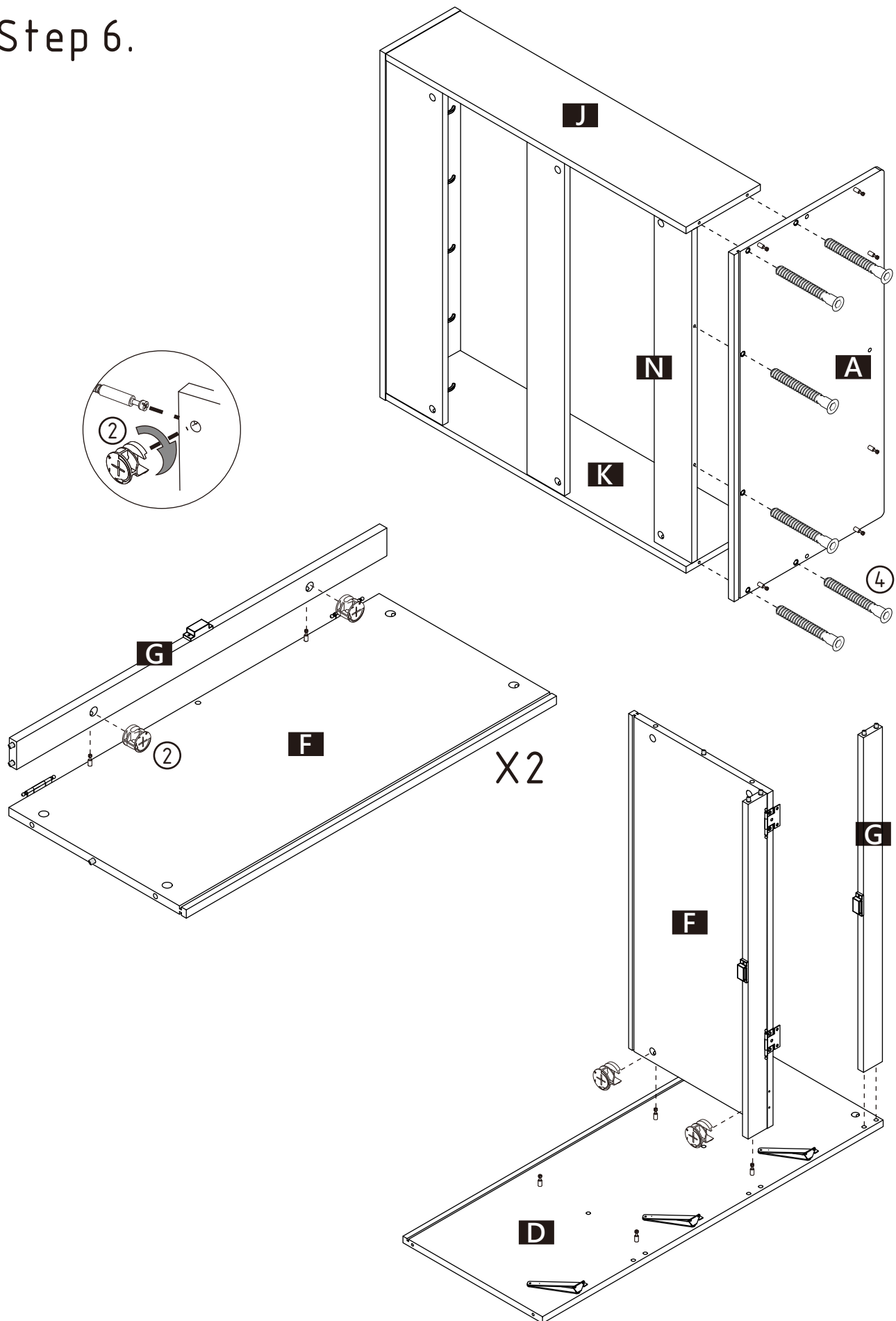

ASSEMBLY INSTRUCTIONS

Step 7.

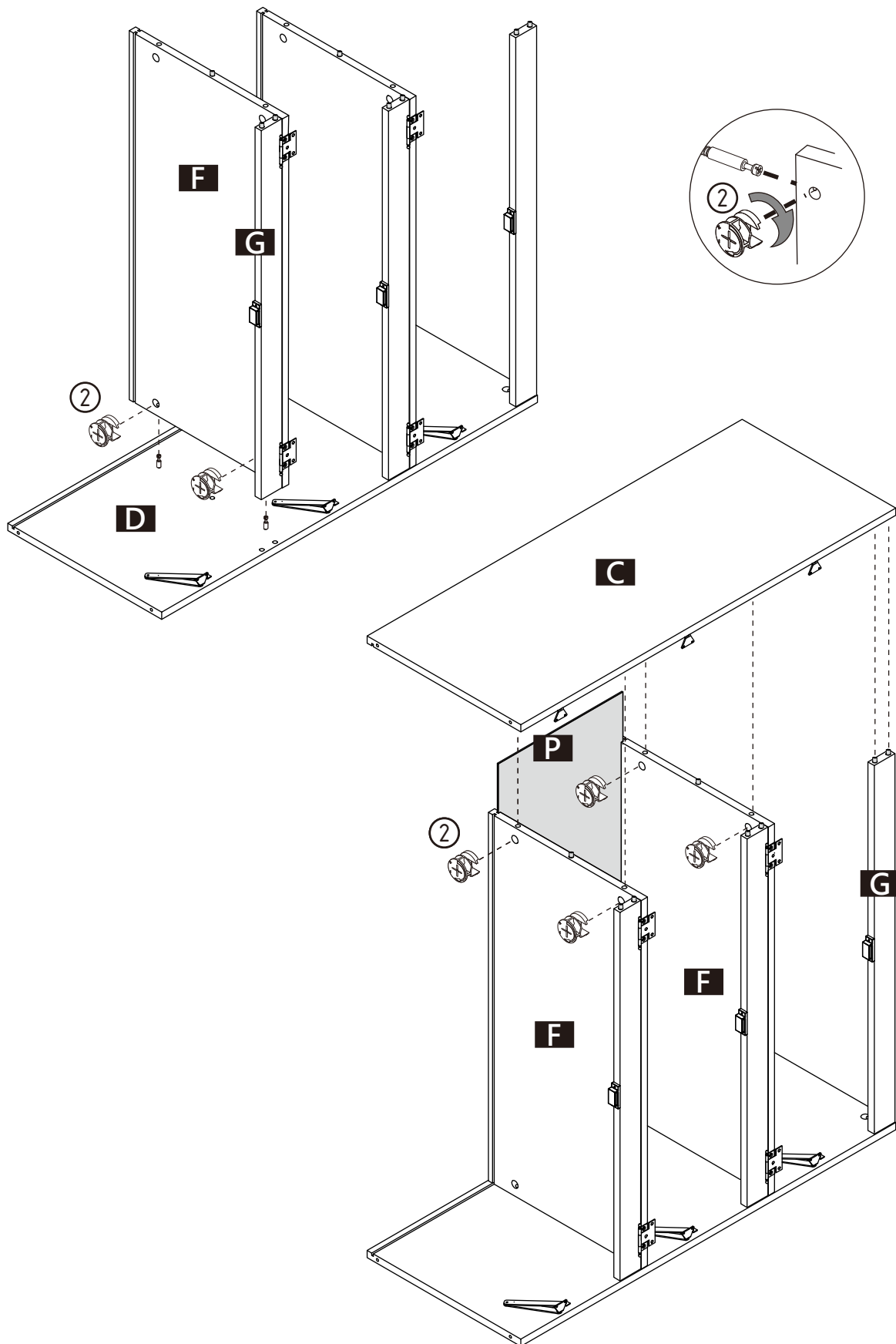

ASSEMBLY INSTRUCTIONS

Step 8.

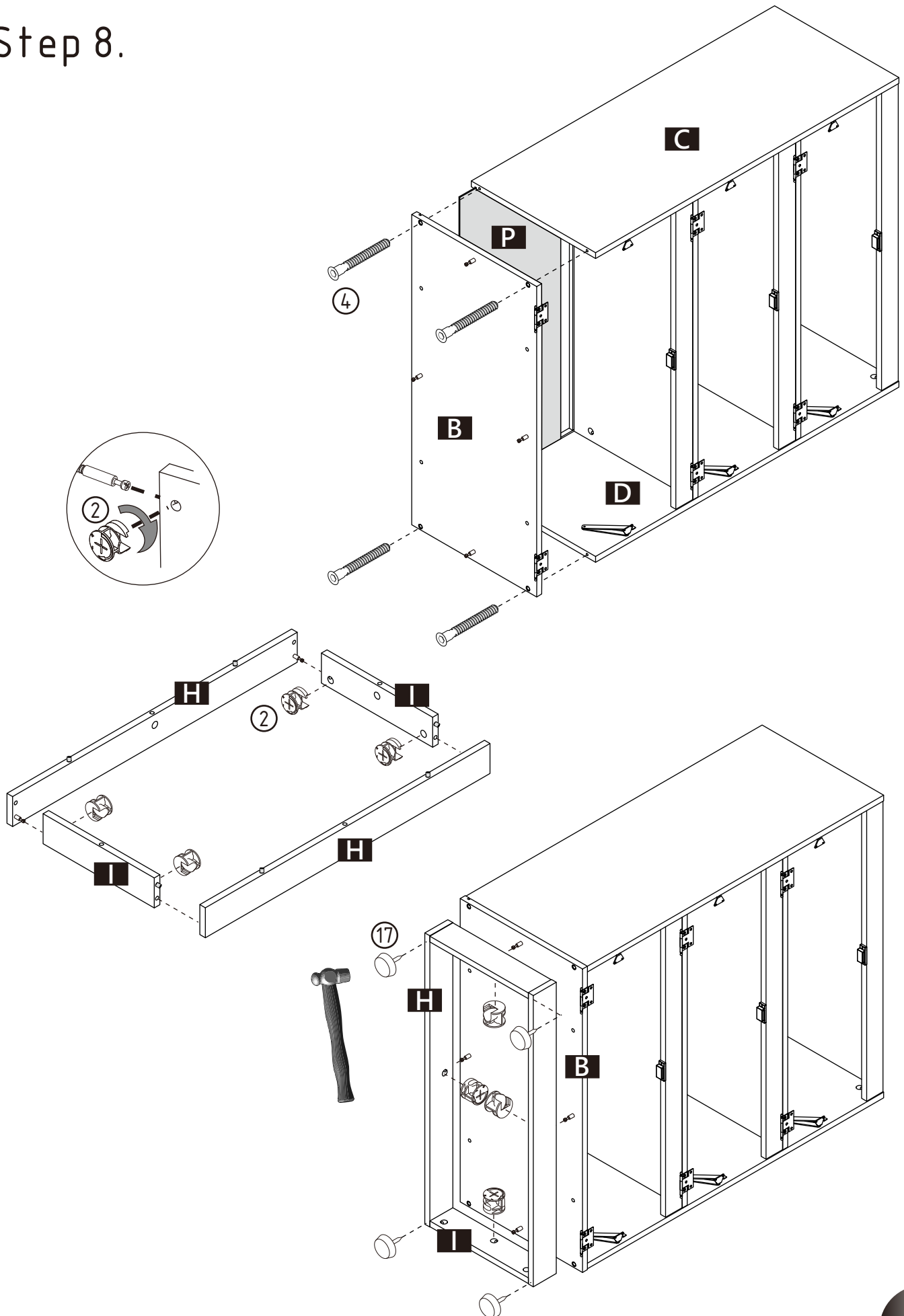

ASSEMBLY INSTRUCTIONS

Step 9.

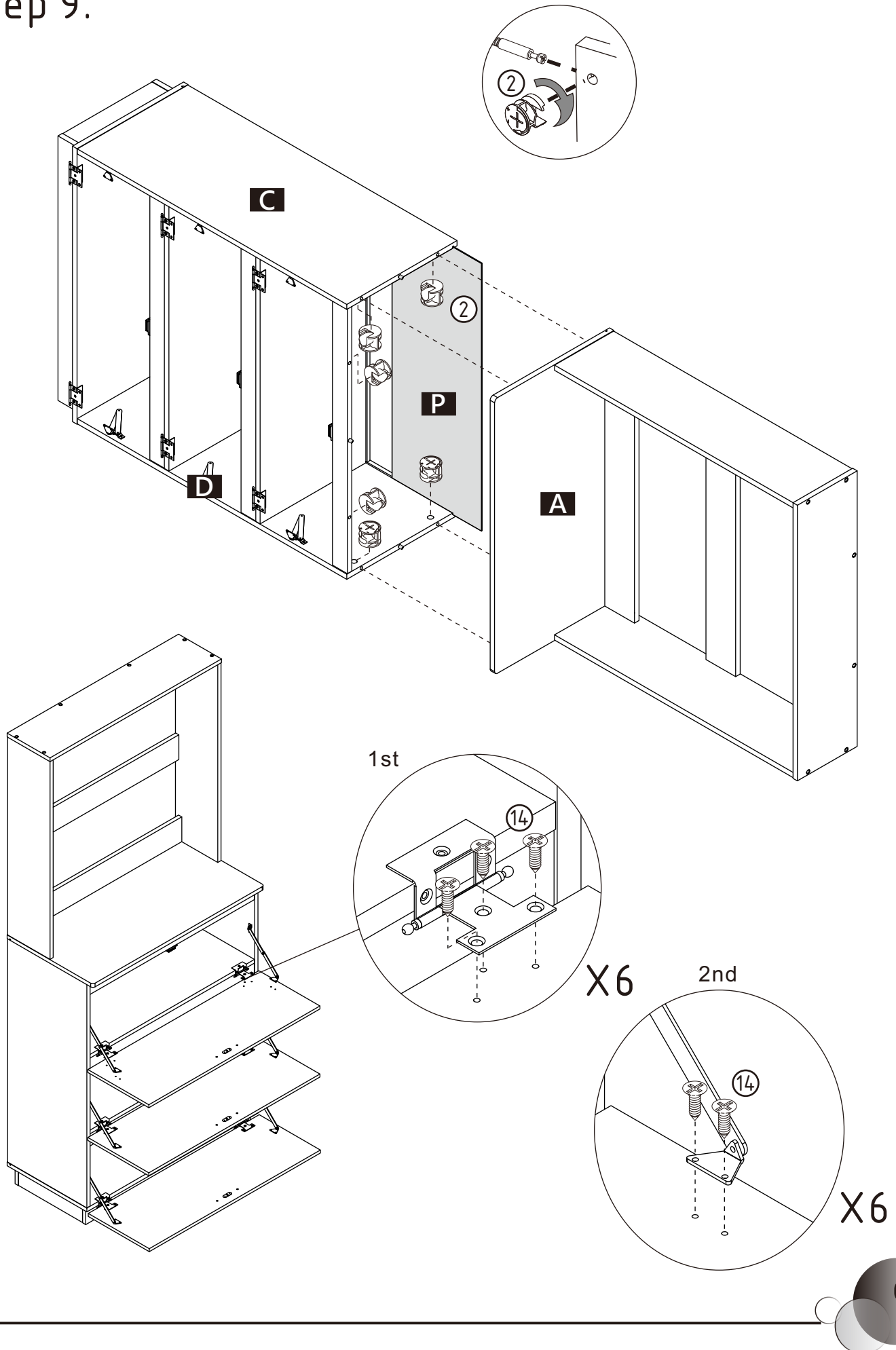

ASSEMBLY INSTRUCTIONS

Step 10.

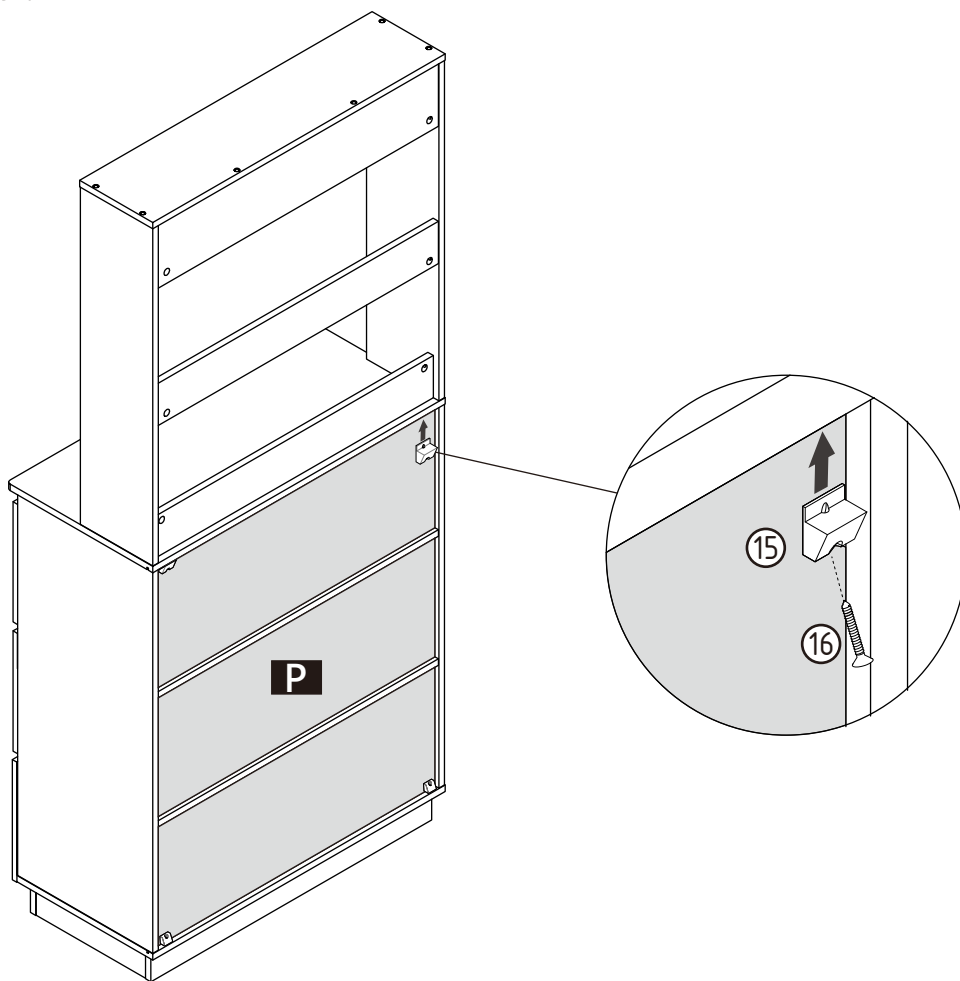

ASSEMBLY IS COMPLETED.

Make sure the product is rested on a flat surface and does not feel loose or wobbly. If it does, double check that the bolts/screws are secured and properly tightened.