

# Maykke

[www.maykke.com](http://www.maykke.com)

## Installation Guide



**8" Widespread Sink Faucet**

**Notice:** Before beginning please read all installation instructions and observe all local safety and building codes.

**Notice:** Inspect all products before installing.

**Notice:** Consult a professional if you are unfamiliar with faucet installation. We accept no liability for damages to property or person during installation.

**Notice:** Insure that the waterline is clean and clear of debris before beginning.

**Notice:** Make sure water is turned off before beginning.

### TOOLS NEEDED:



Glue



Plier



Monkey Wrench

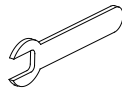

Wrench

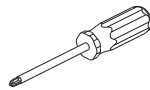

Screwdriver

### PARTS INCLUDED:

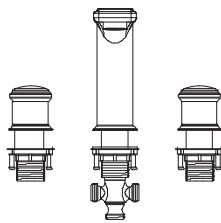
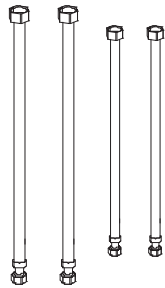

### RECOMMEND TOOL:

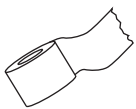

PLUMBER'S TAPE



PLUMBER'S PUTTY (IF DRAIN IS INCLUDED)

1. Remove the locknuts from all faucet trim pieces.

Notice:

a. If your model has the diverter built into the spout, you will need to unscrew the diverter from the back of the spout before proceeding.

b. If your model has set screws on the back of faucet handles, please remove the set screws.

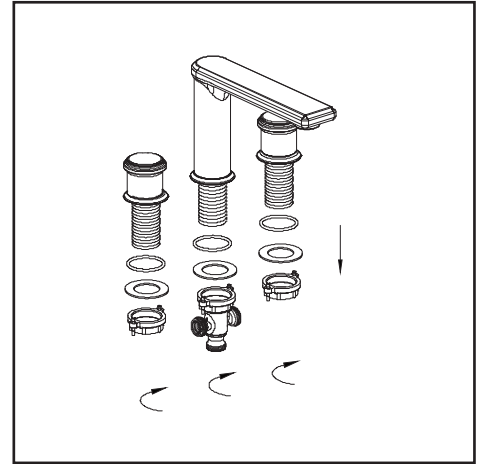

2. Insert the faucet components through the mounting holes and secure by tightening the nuts. Making sure the cold valve is on the right, hot valve is on the left. (replace the diverter and screws from step one)

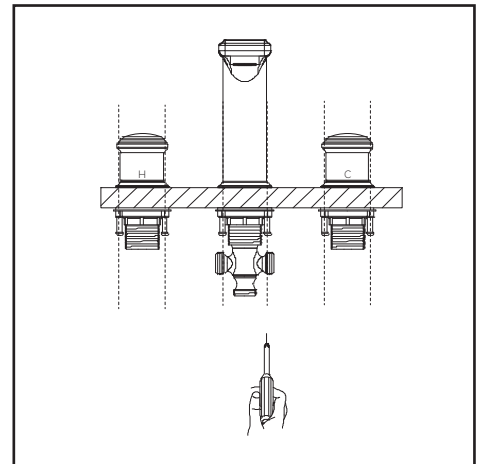

3. Connect the supply lines, using plumber's tape, to both the hot and cold valve connectors, then to the main faucet connector. Tighten using a wrench.

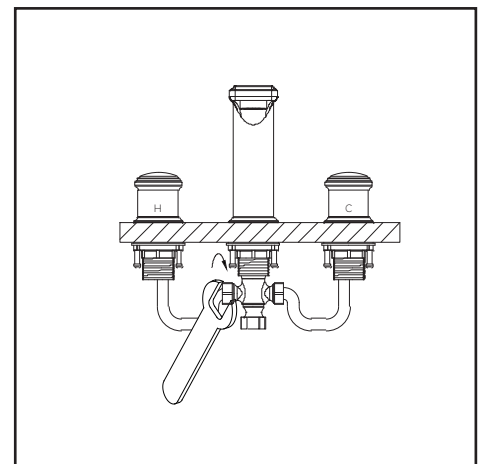

4. Using the other two supply lines connect the water lines, cold to cold and hot to hot. Insuring to use plumber's tape on all threads.

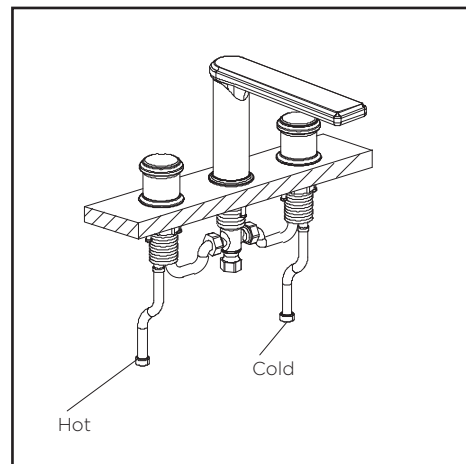

### Option: Faucet with lift rod

5.1. Remove the drain flange and stopper from drain body.

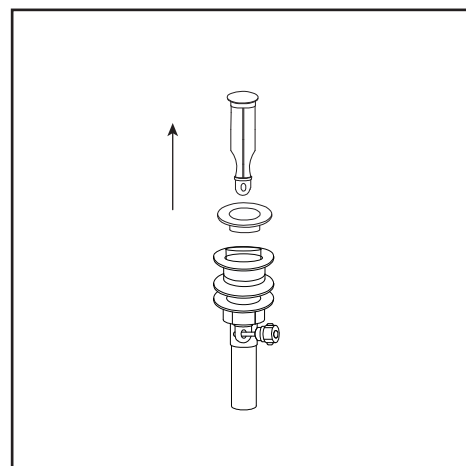

5.2. Place plumber's putty on the underside of flange.

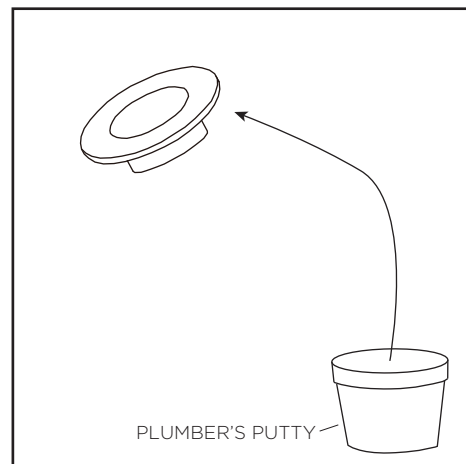

5.3. Push the drain flange into the sink drain hole, and insert the stopper. (Be sure to wipe away excess plumber's putty with a damp cloth.)

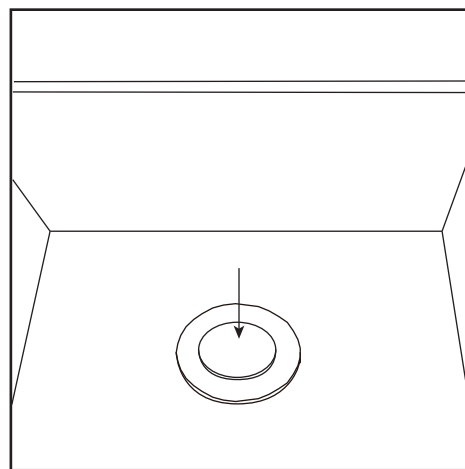

5.4. Under the sink, thread drain body to the bottom of the flange, tighten nuts using a wrench.

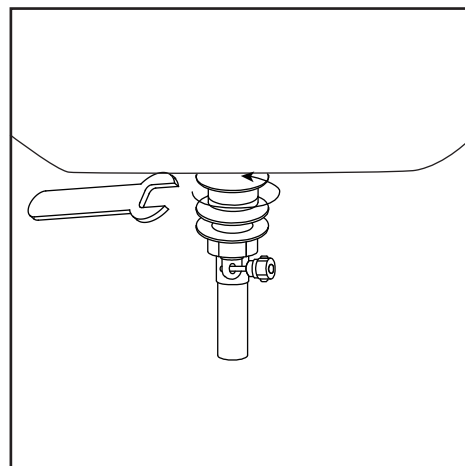

5.5. Insert the shorter end of the ball rod into the back of the drain body, tighten the ball rod nut.

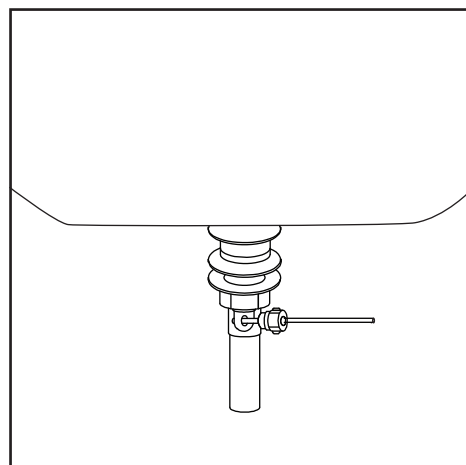

5.6. Insert the spring clip, strap connection onto the end of the ball rod ( Adjust by trying different hole on the strap connection).

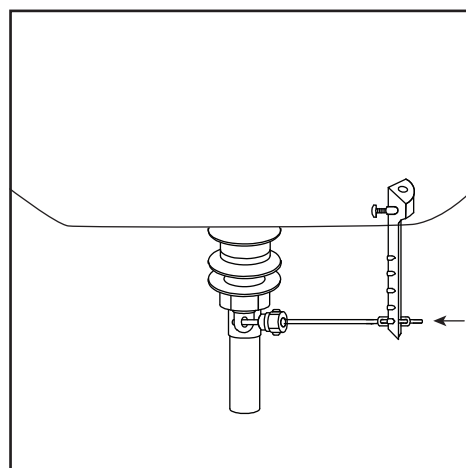

5.7. Insert the rod into the hole at top of strap connection, secure by tighten the screw.

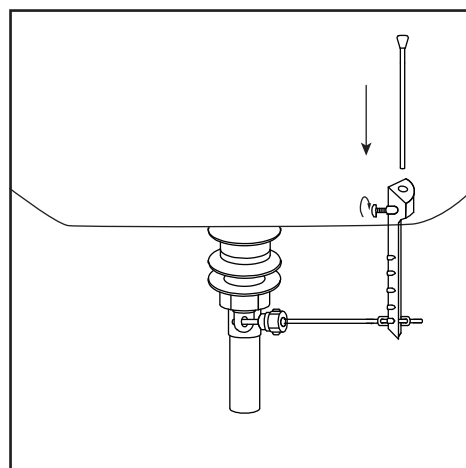

6. Turn water on to test.

### Option: Faucet with pop up drain

#### Note: For sinks with Overflow

**Step 1:** Position and drill a 1-3/4" hole for the drain on the counter-top (see fig 1)

Fig 1

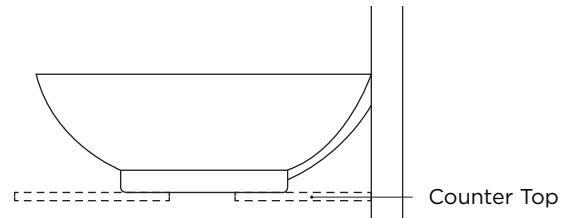

**Step 2:** Place a generous portion of plumbers' putty under drain cap and insert whole drain body inside the bowl and through the countertop. (see fig 1)

(There may be a small beveled rubber washer packaged with your drain, please discard this and use plumbers' putty instead.)

Fig 2

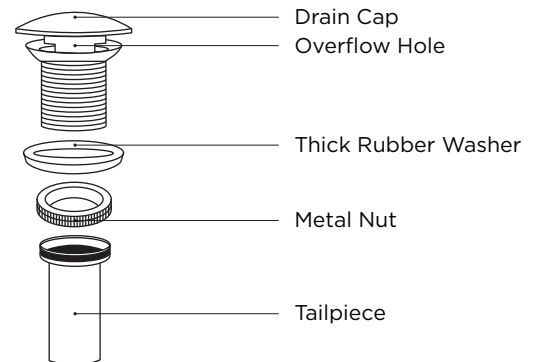

**Step 3:** From under the drain, insert the thick rubber washer and screw on and tighten the metal nut. Remove excess plumbers' putty. (see fig 3)

Fig 3

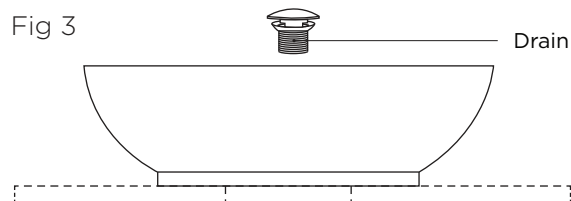

**Step 4:** Attach p-trap to tailpiece.

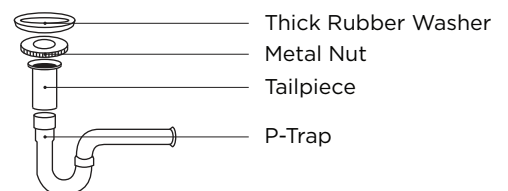

For warranty information please check [www.maykke.com](http://www.maykke.com)

For customer service concerns or support please email: [support@maykke.com](mailto:support@maykke.com)