

Quick Setup Guide

1

UNPACK

- Find the package of (4) casters and remove
- Lay box on its side and carefully open the bottom of the box - DO NOT STAND UPSIDE DOWN
- Install (4) casters
- Stand unit up on casters and remove box



2

FILL UP

- Attach the garden hose
- Turn on water supply (float valve will shut off water once filled)



3

PLUG IN

- Plug power cord into a standard electrical outlet



4

COOL DOWN

- Turn on Pump switch
- Allow water to saturate cooling media
- Turn on fan and adjust to desired speed



User Tips

The FLURRY is designed for portable, personal cooling. Unlike A/C units that use chemical refrigerants to reduce the ambient temperature of entire homes and rooms, the FLURRY uses air and water to cool the areas and people that need cooling. Increased humidity levels should be expected.

Placement

- Use in an open space with air circulation.
- Place on a level surface
- Place the unit at least 3 feet (0.9m) from you and do not block the cool breeze; as the maximum cooling effect is felt directly in the airflow.
- DO NOT use in an enclosed space (small room with closed windows and doors), as this will increase the humidity/moisture and reduce the cooling effect.

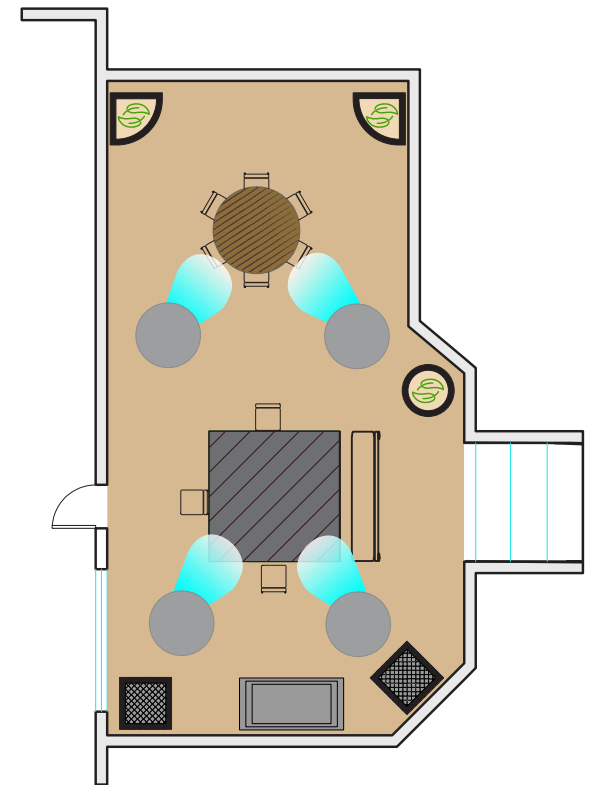

Suggested Applications

- Garages
- Decks or Patios
- Workshops
- Restaurants
- Nurseries and Garden Centers
- Outdoor Markets and Festivals
- Cooling Stations
- Summer Camps

REGISTER YOUR FLURRY ONLINE

www.COOL-SPACE.com

DO NOT RETURN TO STORE

For questions regarding warranty or returns please contact COOL-SPACE customer support

800-557-5716

support@cool-space.com



IMPORTANT

Evaporative coolers are designed for outdoor and well-ventilated indoor applications. Water is evaporated to cool the air. Evaporative cooling requires plenty of fresh air and ventilation.

The temperature change of the projected airflow will vary depending on the temperature, humidity and other variables in your location/application.