

ASSEMBLY INSTRUCTION

6200-75410-GRY

Artemis Side Chair

Thank you for purchasing this quality product. Be sure to unpack carefully looking for small parts which may have come loose during shipment.

Read all instruction and study the drawing carefully before starting the assembly process.

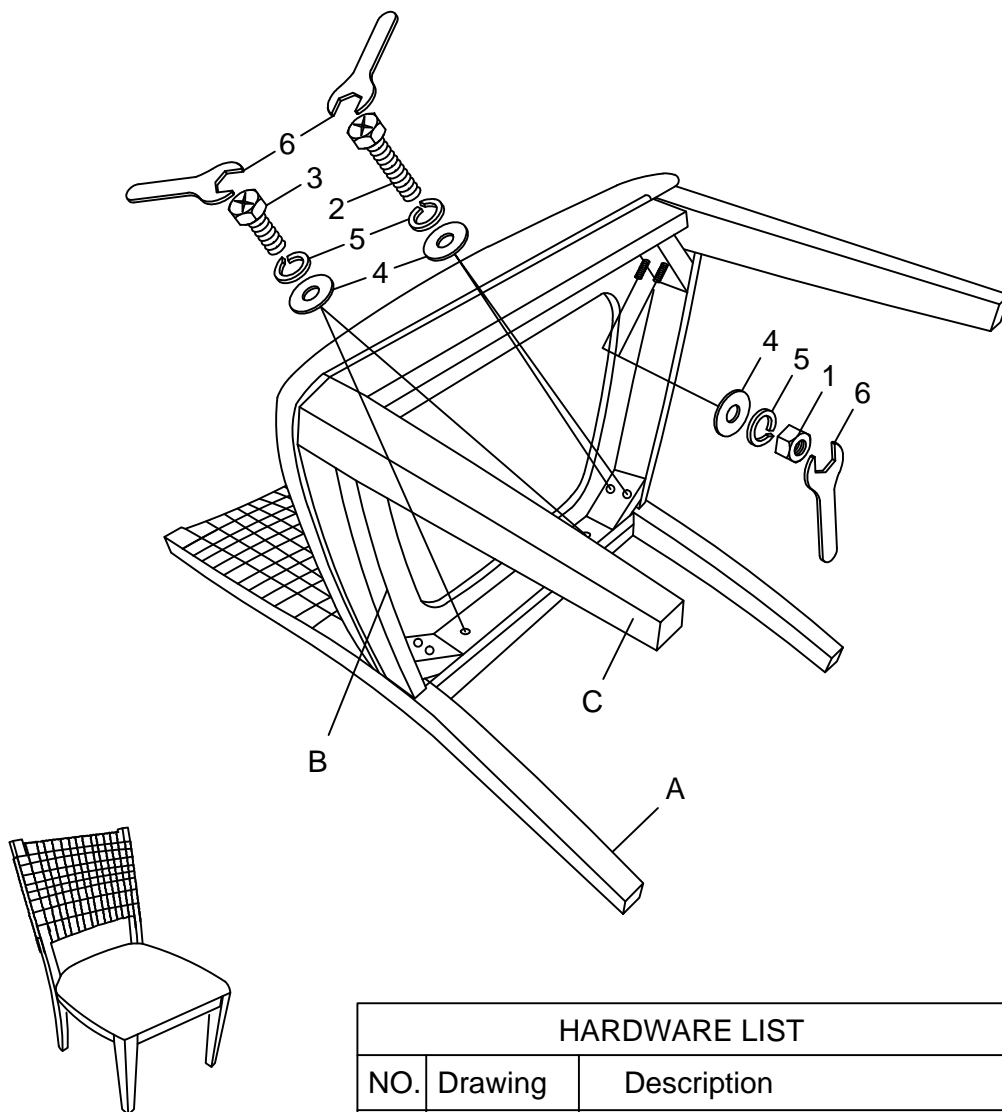

PART LIST		
NO.	Description	Q'ty
A	Chair Back	1 pc
B	Seat Frame	1 pc
C	Leg	2 pcs

HARDWARE LIST			
NO.	Drawing	Description	Q'ty
1		Hex Nut $\Phi 5/16"$	4 pcs
2		Hexagonal Bolt $\Phi 5/16"$ x2-3/4"L	4 pcs
3		Hexagonal Bolt $\Phi 5/16"$ x2"L	2 pcs
4		Flat Washer $\Phi 5/16"$ x19mm	10 pcs
5		Spring Washer $\Phi 5/16"$	10 pcs
6		Allen Wrench $\Phi 5/16"$	1 pc

Before fully tightening the legs, ensure the chair is level.